

Exhibit 12 Millington, TN											
REFERENCE 35 23 55 N 89 53 21 W		CH# 288D - 105.5 MHz, Pwr= 0.038 kw, HAAT=75.1 M, COR= 154 M Average Protected F(50-50)= 6.96 km Ave. F(50-10) 40 dBu= 23.3 54 dBu= 10.0 80 dBu= 2.2 100 dBu= .4							DISPLAY DATES DATA 08-01-03 SEARCH 08-11-03		
CH CITY	CALL	TYPE STATE	AZI. <--	DIST FILE #	LAT. LNG.	Pwr(kw) HAAT(M)	COR(M) INT(km)	PRO(km) LICENSEE	*IN* (Overlap in km)	*OUT*	
290C Memphis	WGKX	LIC TN	CN 167.3 347.3	27.73 BLH19891221KC	35 09 17 89 49 20	100.000 309	393 0.4	73.1 Kix Broadcasting, Inc.	10.61	-45.75*	
288D Millington	AP288	APP TN	C 354.2 174.2	0.25 BNPFT20030314BGX	35 24 03 89 53 22	0.027 95	174 19.4	7.2 Educational Media Foundati	-29.81*	-26.43*	
287D Bartlett	AP287	APP TN	C 160.5 340.5	23.02 BNPFT20030317ELJ	35 12 11 89 48 16	0.010 257	340 9.8	9.4 Educational Media Foundati	3.04	3.85	
286D Bartlett	AP286	APP TN	C 143.3 323.3	17.00 BNPFT20030317MFP	35 16 33 89 46 38	0.010 347	435 0.4	10.9 Edgewater Broadcasting Inc	10.19	5.70	
288D Dyersburg	AP288	APP TN	C 30.9 210.9	83.88 BNPFT20030317IUE	36 02 43 89 24 32	0.019 112	190 17.4	7.2 New Harmony Baptist Church	54.37	59.29	
288A Piggott	KBOAFM	LIC AR	CN 348.9 168.9	105.32 BMLH19920714KA	36 19 47 90 06 58	6.000 104	180 19.6	28.8 Pollack Broadcasting Co.	12.08	56.92	
288A Piggott	KBOAFM	CP AR	NCX 348.6 168.6	105.54 BPH20010109AAS	36 19 50 90 07 24	6.000 103	180 19.6	28.7 Pollack Broadcasting Co.	12.44	57.25	
286D Germantown	AP286	APP TN	C 166.2 346.2	28.88 BNPFT20030312BBW	35 08 45 89 48 48	0.250 100	186 0.4	12.8 Community Broadcasting, In	20.91	15.61	
288A Selmer	WXOQ	LIC TN	C 99.9 279.9	112.37 BLH19990208KG	35 13 11 88 40 23	6.000 106	237 17.2	29.0 Gerald W. Hunt	19.49	66.13	
286D West Memphis	AP286	APP AR	C 218.1 38.1	36.21 BNPFT20030314BGD	35 08 31 90 08 06	0.120 87	148 0.4	10.1 Educational Media Foundati	28.43	25.67	
285C3 Lake City	KDXY	LIC AR	CN 308.0 128.0	77.36 BLH19940705KE	35 49 29 90 33 54	13.500 146	212 0.4	40.2 Saga Communications Of Ark	66.59	36.75	
288A Water Valley	WTNM	LIC MS	CN 174.3 354.3	132.22 BLH20001211ACG	34 12 45 89 44 49	4.700 97	213 23.3	26.5 Telesouth Communications,	42.88	82.49	
288A Water Valley	WTNM.C	CP MS	CX 174.3 354.3	132.22 BPH20000426AAP	34 12 45 89 44 49	4.700 97	213 23.3	26.5 Telesouth Communications,	42.88	82.49	
286A Caruthersville	KCRVFM	LIC MO	NCN 11.1 191.1	92.23 BLH19990219KE	36 12 50 89 41 25	4.800 101	178 0.4	27.1 Pollack Broadcasting Co.	84.05	64.74	
287A Humboldt	WLSZ	LIC TN	CN 60.6 240.6	102.20 BLH19890126KA	35 50 41 88 54 08	3.000 112	215 6.7	25.6 Boyd Enterprises, Inc.	58.63	69.96	
287A Marianna	KAKJ	LIC AR	CN 229.9 49.9	104.95 BLH19950713KA	34 47 14 90 46 03	6.000 108	163 9.7	29.4 L.t. Simes Ii & Raymond Si	52.84	65.89	
287A Marianna	KAKJ.A	APP AR	CX 230.5 50.5	106.10 BPH20030702AAL	34 47 20 90 47 08	6.000 109	163 9.6	29.4 L.t. Simes Ii & Raymond Si	54.00	67.08	

***Affixed to 'IN' or 'Out' values = site inside protected contour.
ERP and HAAT are on direct line to and from reference station.

Exhibit 12 (Compliance with CFR 74.1204)

The proposed FM Translator is located within the protected 60 dBu contour of second adjacent channel station WGKX, channel 290C, Memphis, TN. The predicted F(50-50) field strength of WGKX at the proposed translator site is 82.4 dBu, see Exhibit 12A. Therefore, the respective predicted interfering contour generated by the proposed FM Translator is 122.4 dBu. This interfering contour extends less than 33 meters from the proposed transmit antenna, and the area of overlap does not reach the ground.

Therefore, EMF respectfully requests a waiver of C.F.R. 74.1204 based on no population within the area of predicted interference.

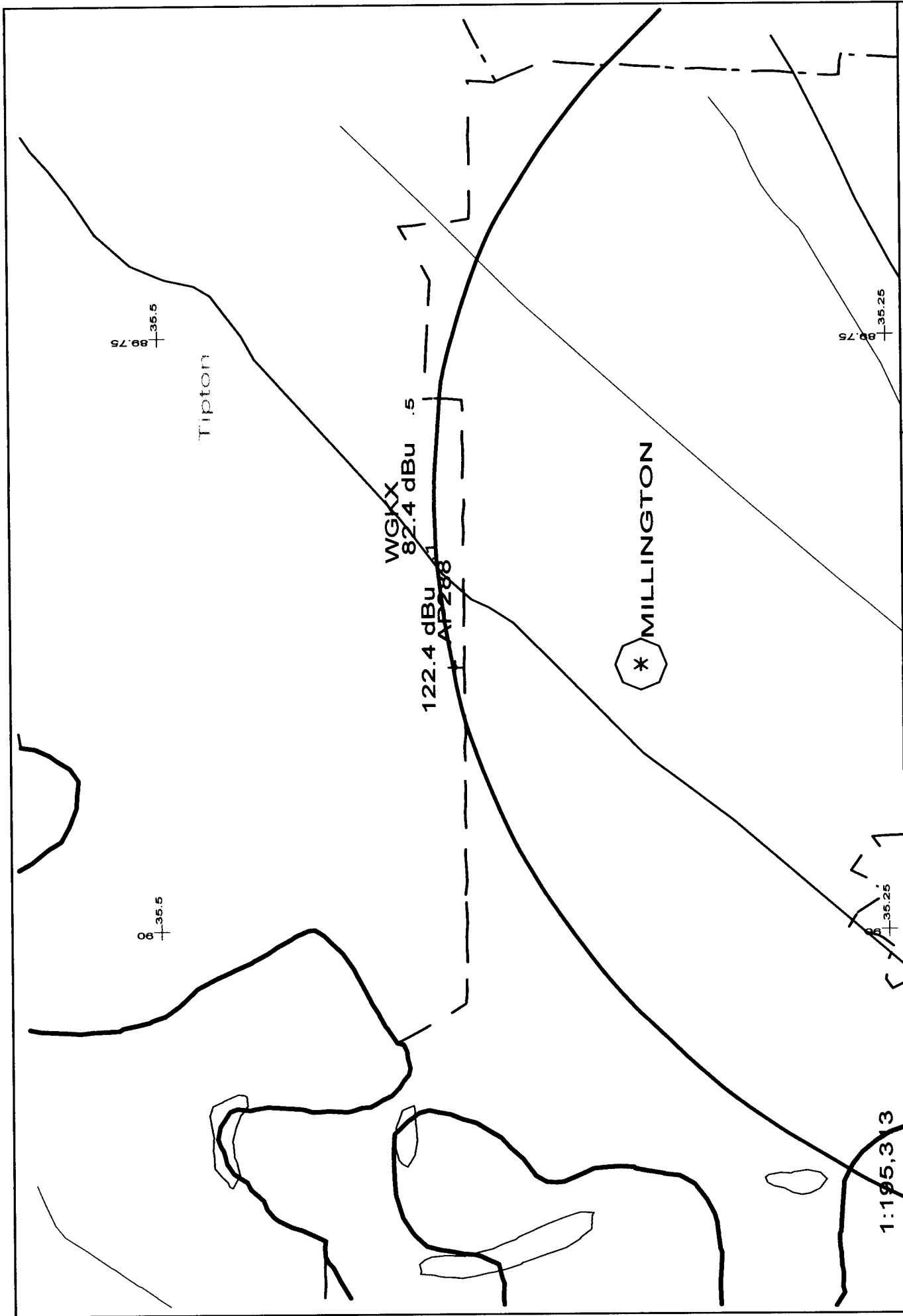

<p>Scale in km</p> <p>0 10</p>	<p>AP288 288D .038kW 154M AMSL</p> <p>N. Lat. 35 23 55 W. Lng. 89 53 21</p>	<p>Exhibit 12A</p> <p>- 07/03</p>
--------------------------------	---	-----------------------------------

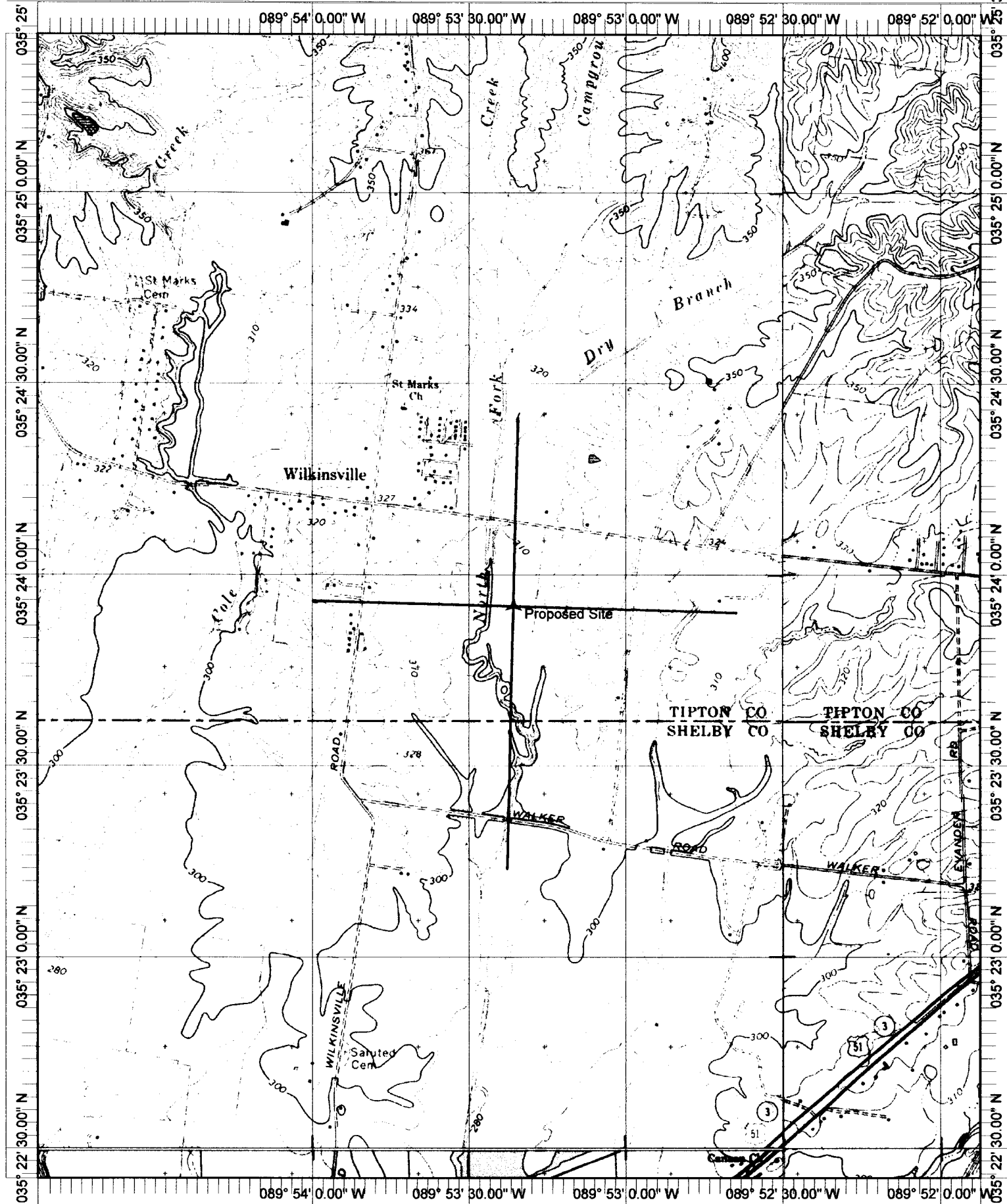

Name: DRUMMONDS
 Date: 8/13/2003
 Scale: 1 inch equals 2000 feet

Location: 035° 23' 55.1" N 089° 53' 22.3" W
 Caption: Exhibit 12 Topo Map