



THE ABONMARCHE GROUP

341 Airport North Office Park, Fort Wayne, IN 46825 • T 260.497.8823 F 260.497.8555 W
www.abonmarche.com

South Bend, IN
Indianapolis, IN
Benton Harbor, MI
Manistee, MI
Grand Haven, MI
St. Clair, MI

December 28, 2004

Broadcast Technical Engineering
2602 Eastbrook Drive
Fort Wayne, Indiana

Attention: Greg Case

Project: M4-1157-00 – Radio Antenna @ 3632 Butler Road, Fort Wayne, Indiana

Dear Greg,

On December 15, 2004, our survey crew measured the direction of the antenna boom at the above location and found it at an azimuth of 186 degrees and 00 minutes clockwise from True North.

Please call if you have any further questions or concerns.

Sincerely,

ABONMARCHE CONSULTANTS, LLC

Sam L. Faust
Vice President of Land Surveying

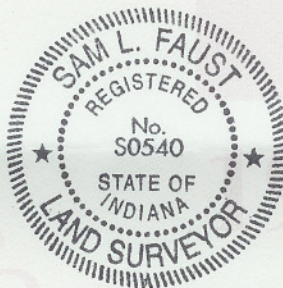

SLF:df
Attachment (drawing)

This document is a record of a resurvey of land and real estate prepared in conformity with established rules of surveying and made in accordance with the records or plat on file in the Recorder's office of SUBJECT County, State of Indiana. The land described exists in full dimensions as shown hereon in feet. It is free from encroachments by adjoining land owners unless specifically stated below. Corners were perpetuated as indicated. I hereby certify that the survey was wholly performed under my supervision, that I am a registered Land Surveyor in Indiana, and to the best of my knowledge and belief, this Survey was executed according to the survey requirements in 865 IAC 1-12-13, as amended.

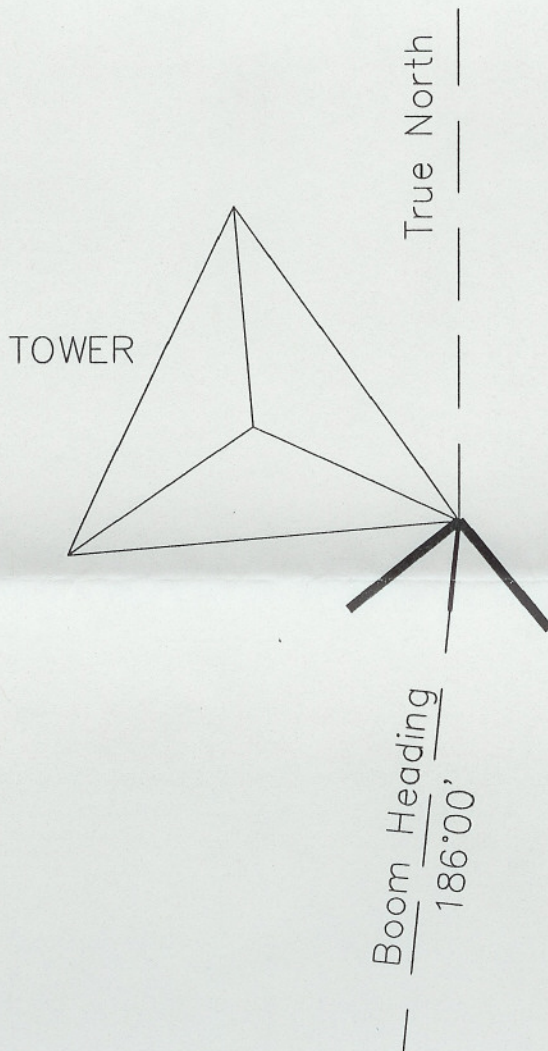

WLAB Radio Tower @ 3632 Butler Road, Fort Wayne, Indiana.

Fieldwork completed on December 15, 2004.

SURVEY NO. M4-1157-00

SURVEYED FOR: Broadcast Technical
Engineering

DATE: December 27, 2004

Sam L. Faust

SAM L. FAUST
REGISTERED LAND SURVEYOR NO. S0540



ENGINEERS

/

LAND SURVEYORS

/

CONSTRUCTION MANAGEMENT