

Exhibit 12 Columbus, IN											
REFERENCE 39 17 37 N 85 57 40 W		CH# 271D - 102.1 MHz, Pwr= 0.038 kw, HAAT=81.3 M, COR= 268 M Average Protected F(50-50)= 7.25 km Ave. F(50-10) 40 dBu= 24.3 54 dBu= 10.3 80 dBu= 2.2 100 dBu= .4								DISPLAY DATES DATA 06-18-03 SEARCH 06-21-03	
CH CITY	CALL	TYPE STATE		AZI. <--	DIST FILE #	LAT. LNG.	Pwr(kw) HAAT(M)	COR(M) INT(km)	PRO(km) LICENSEE	*IN* (Overlap in km)	*OUT*
271D Columbus	AP271	APP IN	C	0.0 180.0	0.00 BNPFT20030317AXK	39 17 37 85 57 40	0.038 67	268 20.2	6.6 Educational Media Foundati	-28.04*	-26.73*
268B Columbus	WKKG	LIC IN	CN	175.4 355.4	11.91 BLH19890619KA	39 11 12 85 57 00	50.000 150	354 0.9	65.1 white River Broadcasting C	-0.91	-54.03*
269D Columbus	AP269	APP IN	C	175.4 355.4	11.91 BNPFT20030310AOV	39 11 12 85 57 00	0.050 26	230 0.4	4.7 Indiana Community Radio Co	4.56	6.77
271D Coatsville	AP271	APP IN	C	304.9 124.9	77.28 BNPFT20030313BCL	39 41 19 86 42 03	0.050 70	314 16.9	7.2 Hoosier Broadcasting Corpo	48.03	53.22
272A Martinsville	WCBKFM	LIC IN	CN	290.5 110.5	46.39 BMLH19980128KD	39 26 18 86 27 58	6.000 92	310 6.7	27.2 Mid-america Radio Group, I	-0.38	12.49
273D Norristown	AP273	APP IN	C	65.0 245.0	19.59 BNPFT20030312AYD	39 22 04 85 45 18	0.010 53	259 0.4	4.2 Indiana Community Radio Co	13.01	14.91
271D Noblesville	AP271	APP IN	C	358.7 178.7	80.11 BNPFT20030317AXU	40 00 54 85 58 58	0.019 111	355 20.1	7.2 Educational Media Foundati	50.05	52.80
271D Pendleton	AP271	APP IN	C	12.5 192.5	83.04 BNPFT20030314AJR	40 01 25 85 45 01	0.055 47	318 20.0	6.0 Horizon Christian Fellowsh	56.95	57.03
272D Greensburg	AP272	APP IN	C	82.9 262.9	41.36 BNPFT20030311ABA	39 20 18 85 29 06	0.050 55	315 9.2	6.4 Indiana Community Radio Co	25.72	25.76
272D Greensburg	AP272	APP IN	C	83.1 263.1	41.46 BNPFT20030317ENI	39 20 14 85 29 01	0.120 41	301 9.2	6.9 The Trustees Of Indiana Un	25.21	25.43
271D Arcadia	AP271	APP IN	C	1.2 181.2	95.01 BNPFT20030310ATV	40 08 57 85 56 15	0.010 24	268 20.2	3.2 Indiana Community Radio Co	78.80	71.68
270A Brownsburg	WKLU	LIC IN	CN	328.7 148.7	68.41 BLH19960716KA	39 49 07 86 22 40	3.700 93	335 8.3	24.5 Quinn Broadcasting, Inc.	25.34	35.58
273B New Castle	WMDHFM	LIC IN	CN	30.0 210.0	97.94 BLH19790912AC	40 03 18 85 23 05	50.000 145	468 0.9	64.3 Citadel Broadcasting Compa	87.13	32.74
270D Bloomington	AP270	APP IN	C	249.7 69.7	59.30 BNPFT20030317FLV	39 06 26 86 36 16	0.010 96	326 6.3	5.7 Radio Assist Ministry Inc.	46.92	47.32
272D Mt Comfort	AP272	APP IN	C	4.0 184.0	59.88 BNPFT20030312AZL	39 49 54 85 54 45	0.010 40	283 8.6	3.7 Indiana Community Radio Co	48.67	47.61
272D Indianapolis	AP272	APP IN	C	344.2 164.2	61.31 BNPFT20030310AVK	39 49 29 86 09 23	0.001 81	312 8.9	2.9 Indiana Community Radio Co	50.97	49.57
269D Oaklandon	AP269	APP IN	C	0.3 180.3	64.21 BNPFT20030312AZU	39 52 19 85 57 24	0.010 39	283 0.4	3.6 Indiana Community Radio Co	57.95	60.19
273A Mitchell	WWEG	LIC IN	CN	210.4 30.4	84.37 BLH19910826KA	38 38 16 86 27 11	6.000 93	289 0.4	27.4 Mitchell Community Broadca	76.29	56.57
271B Danville	WDNL	LIC IL	CN	304.3 124.3	171.51 BLH19871016KD	40 08 58 87 37 35	50.000 118	309 23.9	60.4 Neuhoff Broadcasting - Dan	33.04	87.23
273D Danville	AP273	APP IN	C	316.9 136.9	69.94 BNPFT20030310BDS	39 45 06 86 31 10	0.010 71	305 0.4	4.9 Indiana Community Radio Co	64.32	64.60
270B Cincinnati	WKRQ	LIC OH	C	98.4 278.4	127.57 BLH19991004ABU	39 06 59 84 30 07	16.000 249	483 13.3	63.8 Infinity Radio Operations	45.91	50.51
272L2 Madison	AP272	APP IN		139.0 319.0	76.60 BNPL20010611ADI	38 46 20 85 22 54	0.000 -247	0 10.4	0.0 Timothy Pablo Meijome	69.33	66.24
269D Coatesville	AP269	APP IN	C	304.8 124.8	73.82 BNPFT20030317KRE	39 40 12 86 40 06	0.170 32	275 0.4	6.6 Covenant Network	67.72	66.76
273D Coatsville	AP273	APP IN	C	304.9 124.9	77.28 BNPFT20030313BCP	39 41 19 86 42 03	0.050 70	314 0.4	7.2 Hoosier Broadcasting Corpo	71.59	69.66
269D Coatsville	AP269	APP IN	C	304.9 124.9	77.28 BNPFT20030313BCJ	39 41 19 86 42 03	0.050 70	314 0.4	7.2 Hoosier Broadcasting Corpo	71.59	69.66

CH CITY	CALL	TYPE STATE	AZI. <--	DIST FILE #	LAT. LNG.	Pwr(kw) HAAT(M)	COR(M) INT(km)	PRO(km) LICENSEE	*IN* (Overlap in km)	*OUT*
274B Cincinnati	WEBN	LIC NCN OH	98.4 278.4	127.57 BLH19981112KL	39 06 59 84 30 07	16.000 249	483 0.9	63.8 Jacor Broadcasting Corpora	115.48	62.95
274D North Manchester	AP274	APP C IN	12.0 192.0	81.46 BNPFT20030313AKO	40 00 40 85 45 45	0.250 4	275 0.4	7.1 Public Broadcasting Of Nor	74.36	73.94

"\*"Affixed to 'IN' or 'Out' values = site inside protected contour.  
 ERP and HAAT are on direct line to and from reference station.  
 "«" = Station meets FCC minimum distance spacing for its class.

## **Exhibit 12 (Compliance with CFR 74.1204)**

---

The proposed FM Translator is located within the protected 60 dBu contour of second adjacent channel station WKKG, channel 269B, Dillon, IN. The predicted F(50-50) field strength of WKKG at the proposed translator site is 87.8 dBu, see Exhibit 12A. Therefore, the respective predicted interfering contour generated by the proposed FM Translator is greater than 127.8 dBu. This interfering contour extends less than 18 meters from the proposed transmit antenna, and the area of overlap does not reach the ground.

Therefore, EMF respectfully requests a waiver of C.F.R. 74.1204 based on no population within the area of predicted interference.

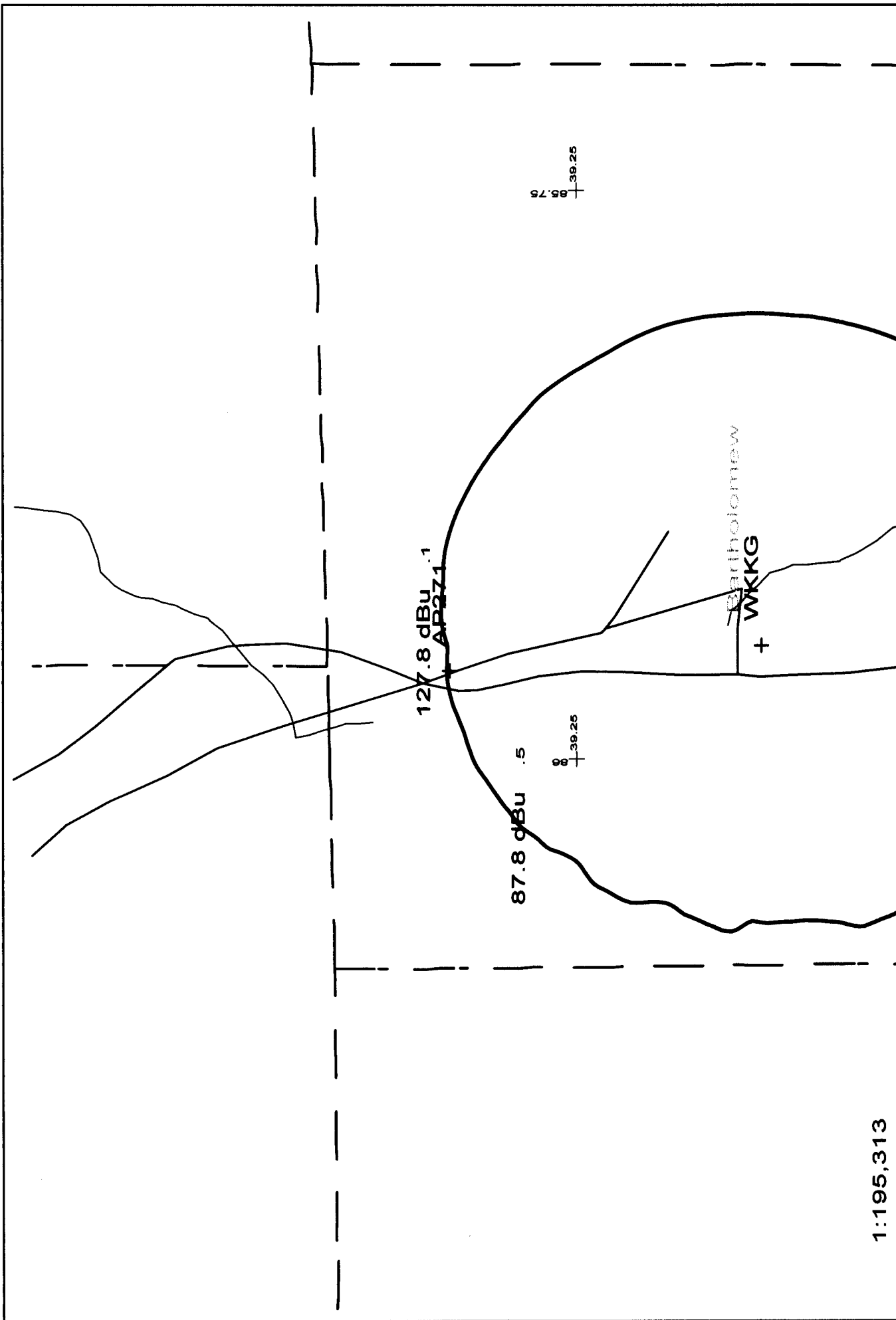

1:195,313

Scale in km



AP271 271D .038kW 268M AMSL

N. Lat. 39 17 37 W. Lng. 85 57 40

Exhibit 12A

EMF - 05/03