

Exhibit12
Albertville, MN

REFERENCE	CH#	221D - 92.1 MHz, Pwr= 0.25 kW, HAAT=51.1 M, COR= 329 M	DISPLAY DATES
45 14 26 N		Average Protected F(50-50)= 9.38 km	DATA 08-12-04
93 41 10 W		Ave. F(50-10) 40 dBu= 31.1 54 dBu= 13.1 80 dBu= 2.9 100 dBu= 1.1	SEARCH 08-26-04

CH CITY	CALL	TYPE STATE	AZI. <--	DIST FILE #	LAT. LNG.	Pwr (kW) HAAT (M)	COR (M) INT (km)	PRO (km) LICENSEE	*IN* (Overlap	*OUT* in km)
221D Albertville	K221ES	CP MN	C	205.2 25.2	0.20 BNPFT20030821AHN	45 14 20 93 41 14	0.010 117	405 21.0	6.3	-27.91* Educational Media Foundati
223C Golden Valley	KQRSFM	LIC MN	CN	114.5 294.5	48.61 BLH19910814KB	45 03 30 93 07 27	100.000 328	593 10.6	74.4	29.24 Kqrs, Inc.
221D Waite	W221BS	CP MN	C	123.0 303.0	57.41 BNPFT20030819ADX	44 57 30 93 04 31	0.055 -1	287 15.5	4.8	33.67 Educational Media Foundati
221A Little Falls	WYRQFM	LIC MN	CN	329.1 149.1	92.05 BLH19800516AF	45 56 57 94 17 48	3.000 95	431 75.0	23.6	9.04 Little Falls Radio Corpora
220D Medina	K220IQ	CP MN	DV	156.6 336.6	22.88 BNPFT19991104AAD	45 03 06 93 34 13	0.004 109	404 6.8	4.8	7.82 Pensacola Christian Colleg
218C3 St. Cloud	KCFB	LIC MN	C	303.9 123.9	52.26 BLED19991213AAH	45 30 02 94 14 31	15.000 129	435 4.0	38.9	41.08 Minnesota Christian B/cast
221D Mora	W221BL	CP MN	C	26.5 206.5	82.96 BNPFT20030826AFX	45 54 26 93 12 29	0.019 105	403 23.4	7.0	51.22 Radio Assist Ministry, Inc
275C0 Minneapolis	WLTE«	LIC MN	CN	114.5 294.5	48.61 BLH19910814KD	45 03 30 93 07 27	100.000 328	593 88.6	74.4	25.0R Infinity Media Corporation
220D Minneapolis	AP220	APP MN	DC	135.4 315.4	42.59 BNPFT20000316AAE	44 58 03 93 18 23	0.000 13	287 0.0	0.0	33.71 Minnesota Public Radio
220D Bloomington	K218DK	APP MN	C	147.9 327.9	50.39 BPFT20021220AAY	44 51 22 93 20 49	0.216 27	312 9.8	6.8	31.89 North-central Christian Br
221C3 Waseca	KRUE	LIC MN	CX	169.7 349.7	134.88 BLH20020625AAQ	44 02 46 93 23 03	9.800 172	515 105.4	40.5	21.51 Main Street Broadcasting,
218D Bloomington	K218DK	LIC MN	C	147.9 327.9	50.39 BLFT20021118AAA	44 51 22 93 20 49	0.216 27	312 1.0	6.8	40.65 Refuge Media Group
219D St. Paul	WMCN	LIC MN	CX	129.3 309.3	52.83 BLED20030213AAT	44 56 19 93 10 04	0.005 54	314 1.6	3.6	42.44 Macalester College
220C3 Willmar	KBHZ	LIC MN	CN	255.4 75.4	98.77 BLED19960228KB	45 00 40 94 53 56	25.000 91	445 58.5	37.6	32.86 Christian Heritage Broadca
220D North Branch	K221DX	CP MN	C	64.9 244.9	65.07 BMPFT20040212AAY	45 29 10 92 55 56	0.038 61	334 9.0	6.3	46.73 Refuge Media Group

ERP and HAAT are on direct line to and from reference station.
 ""Affixed to 'IN' or 'Out' values = site inside protected contour.
 "«" = Station meets FCC minimum distance spacing for its class.

Exhibit 12 (Compliance with CFR 74.1204)

The proposed FM Translator is located within the protected 60 dBu contour of second adjacent channel station KQRS, channel 223C, Golden Valley, CA. The predicted F(50-50) field strength of KQRS at the proposed translator site is 71.5 dBu, see Exhibit 12A. Therefore, the respective predicted interfering contour generated by the proposed FM Translator is 111.5.dBu. This interfering contour extends less than 295 meters from the proposed transmit antenna, and the area of overlap is unpopulated.

Two factors have been investigated to determine this absence of population:

- 1) Computer software which uses the centroid method of determining population centers, based on the 2000 census data, has determined that there are no persons within the area of overlap.

- 2) Examination of the USGS topographic map reveals no regularly occupied structures within the area of overlap.

Therefore, EMF respectfully requests a waiver of C.F.R. 74.1204 based on no population within the area of predicted interference.

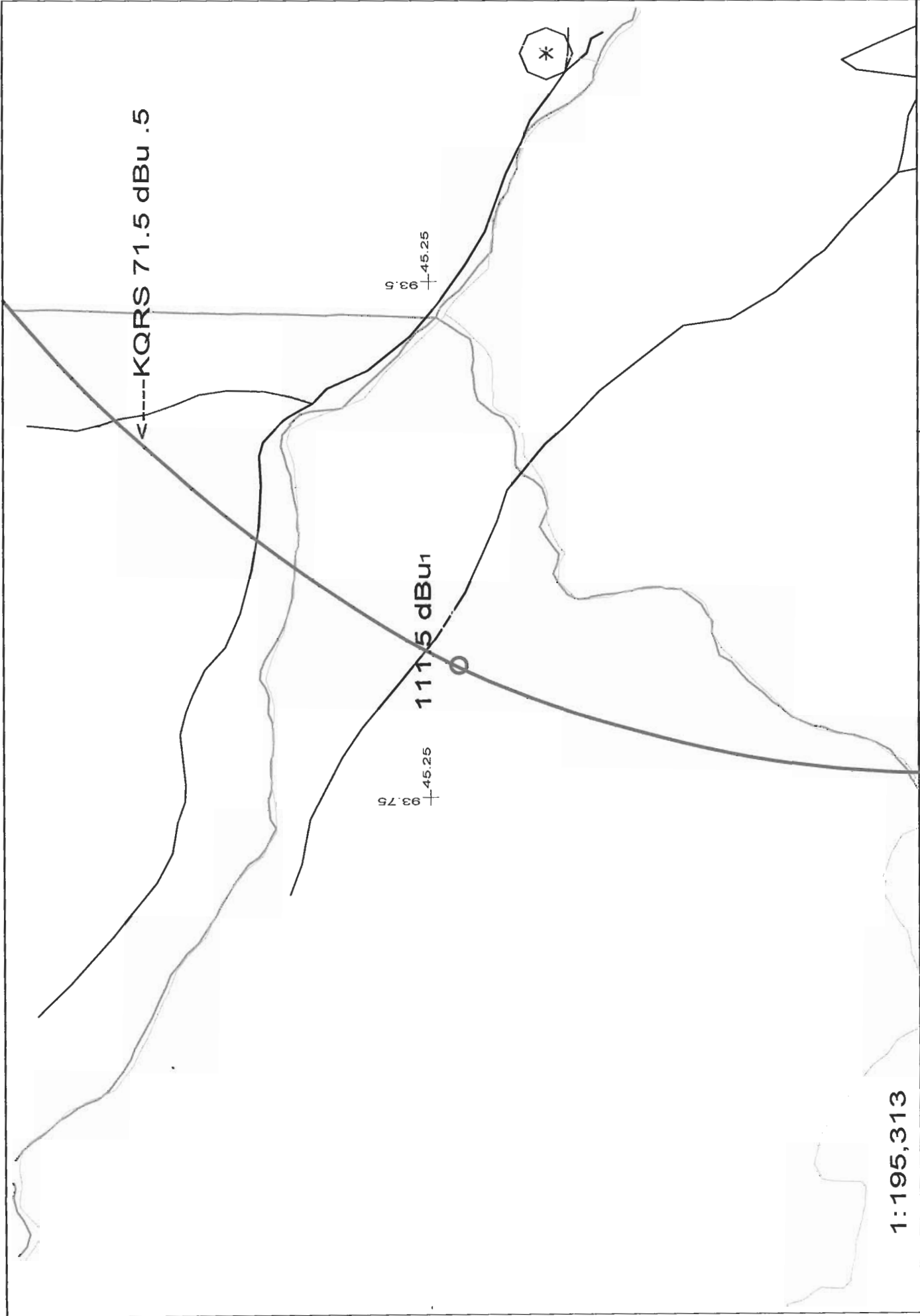

1:195,313

Scale in km



K221ES 221D	.25kW	329M AMSL	Exhibit 12A
N. Lat. 45 14 26	W. Lng. 93 41 10	EMF - 09/04	

► Site Name: **ST. MICHAEL** ► Site Number: **81425**

Close

Image: ENTIRE TOWER

F



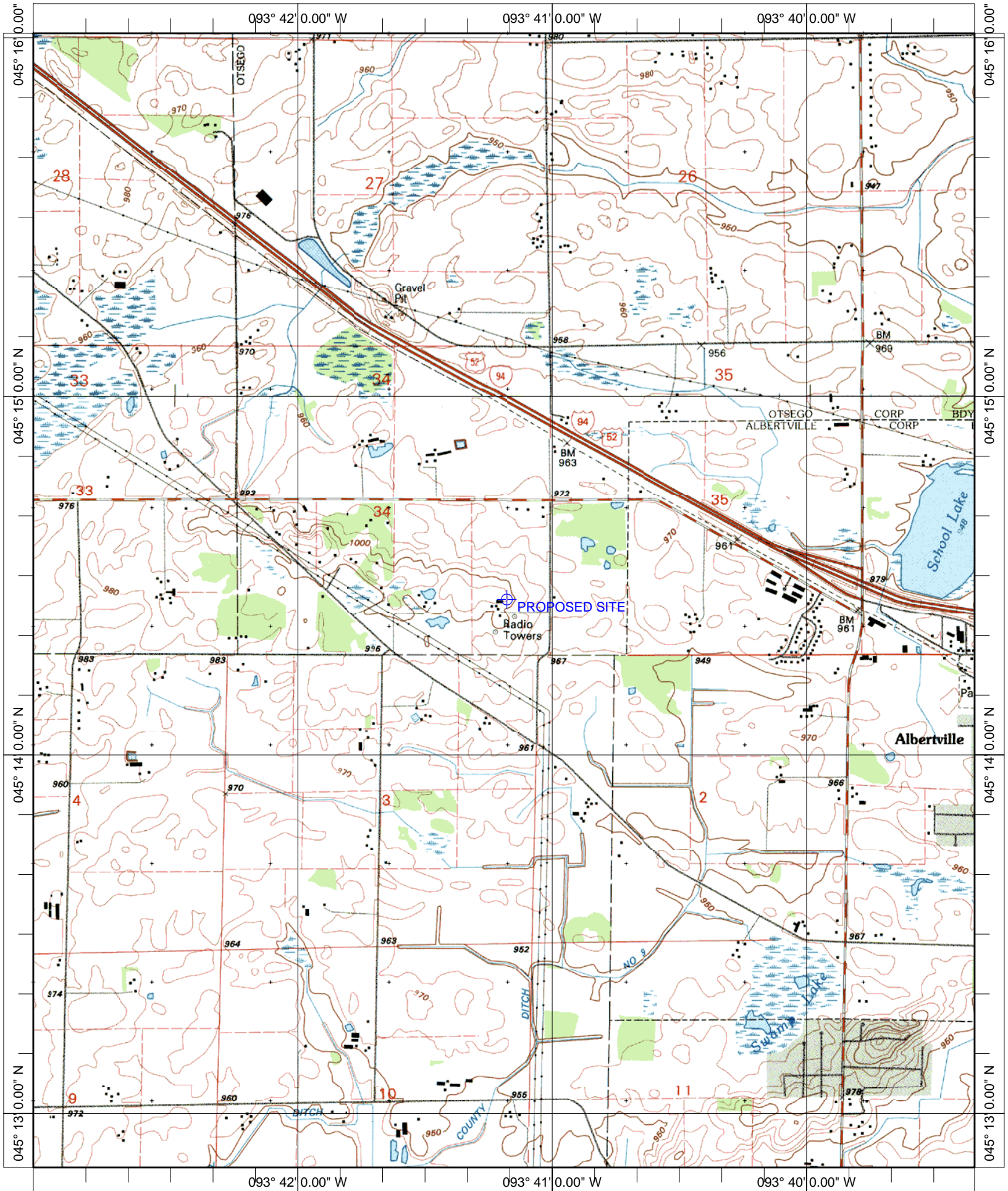

Name: ST MICHAEL
Date: 9/9/2004
Scale: 1 inch equals 2000 feet

Location: 045° 14' 25.8" N 093° 41' 11.3" W
Caption: Exhibit 12
Site 45-14-26 / 93-41-10