

Exhibit 12
Holly, MI

REFERENCE 42 40 59 N 83 33 11 W	CH# 232D - 94.3 MHz, Pwr= 0.008 kW, HAAT=147.1 M, COR= 434 M Average Protected F(50-50)= 6.65 km Ave. F(50-10) 40 dBu= 22.3 54 dBu= 9.4 80 dBu= 1.6 100 dBu= .2	DISPLAY DATES DATA 08-28-03 SEARCH 08-29-03
---------------------------------------	---	---

CH CITY	CALL	TYPE STATE	AZI. <--	DIST FILE #	LAT. LNG.	Pwr(kw) HAAT(M)	COR(M) INT(km)	PRO(km) LICENSEE	*IN* (Overlap in km)	*OUT*
232D Holly	AP232	APP MI	C 303.2 123.2	11.19 BNPFT20030317DZM	42 44 17 83 40 03	0.010 126	442 20.2	6.5 Educational Media Foundati	-16.72	-15.54
234B Birmingham	WCSX	LIC MI	CN 128.5 308.5	40.87 BMLH19981008KA	42 27 13 83 09 50	13.500 268	488 0.4	63.6 Greater Boston Radio, Inc.	29.06	-23.14*
230C1 Windsor	CIDR	OPE ON	DCN 140.8 320.8	73.29	42 10 15 82 59 29	100.000 -176	0 2.6	41.5	62.25	29.16
232B Chatham	ALLO«	ON	105.2 285.2	116.80	42 24 00 82 11 00	50.000 -171	0 30.2	36.1	-36.42	50.48
232L1 Flint	CP232	CP MI	340.4 160.4	38.59 BNPL20000901ACI	43 00 36 83 42 45	0.094 12	264 21.5	5.5 Kettering University	13.91	11.55
235B East Lansing	WMMQ	LIC MI	CN 267.5 87.5	82.70 BLH19911106KF	42 38 45 84 33 38	50.000 149	421 0.4	64.9 Citadel Broadcasting Compa	70.80	17.38
231D Romeo	AP231	APP MI	C 74.4 254.4	42.73 BNPFT20030317HSP	42 47 07 83 03 00	0.013 36	318 8.7	3.7 Radio Assist Ministry Inc.	31.34	30.36
229D Sterling Heights	AP229	APP MI	C 96.8 276.8	38.94 BNPFT20030317HTV	42 38 26 83 04 54	0.080 -22	238 0.2	5.3 Radio Assist Ministry Inc.	31.95	33.42
231B Jackson	WVIC	LIC MI	CN 250.9 70.9	97.02 BLH19830711AJ	42 23 32 84 40 00	40.000 168	457 12.0	65.1 Rubber City Radio Group	13.26	19.89
231D Warren	AP231	APP MI	C 111.2 291.2	52.32 BNPFT20030317HSV	42 30 41 82 57 34	0.019 84	273 9.1	6.2 Radio Assist Ministry Inc.	37.07	36.98
229D Detroit	AP229	APP MI	C 130.3 310.3	47.51 BNPFT20030317HOI	42 24 22 83 06 44	0.010 135	340 0.2	6.7 Radio Assist Ministry Inc.	40.74	40.57
229A Frankenmuth	WRCL	LIC MI	C 0.1 180.1	69.03 BLH20010510AAG	43 18 16 83 33 07	3.500 119	355 0.2	27.1 Regent Broadcasting Of Fli	60.39	41.73
231D Imlay City	AP231	APP MI	C 41.1 221.1	56.89 BNPFT20030317HQF	43 04 03 83 05 35	0.010 95	375 8.3	5.7 Radio Assist Ministry Inc.	43.01	42.91
231D Imlay City	AP231	APP MI	C 41.1 221.1	56.89 BNPFT20030822AIW	43 04 03 83 05 35	0.010 95	375 8.3	5.7 Radio Assist Ministry Inc.	43.01	42.91
231D Richmond	AP231	APP MI	C 82.7 262.7	67.08 BNPFT20030317HSB	42 45 24 82 44 25	0.019 86	278 8.8	6.3 Radio Assist Ministry Inc.	51.89	51.97
229D Southgate	AP229	APP MI	C 154.0 334.0	63.61 BNPFT20030317HTI	42 10 05 83 12 54	0.010 206	391 0.2	8.4 Radio Assist Ministry Inc.	56.74	55.06
229D New Baltimore	AP229	APP MI	C 86.4 266.4	66.93 BNPFT20030317HRL	42 43 03 82 44 15	0.019 93	278 0.2	6.6 Radio Assist Ministry Inc.	60.41	60.15
233C1 Mount Pleasant	RDEL	DEL MI	324.1 144.1	144.03	43 43 36 84 36 16	100.000 -205	0 8.9	31.0	78.63	104.13
233C1 Hemlock	RADD	ADD MI	324.1 144.1	144.03	43 43 36 84 36 16	100.000 -205	0 8.9	31.0	78.63	104.13
233C1 Hemlock	WCENFM	LIC MI	DCX 324.1 144.1	144.03 BMLH20011121AAX	43 43 36 84 36 16	99.776 314	519 8.9	73.4 Nm Licensing Llc	31.22	61.68
232D Tedrow	AP232	APP OH	C 204.3 24.3	131.90 BNPFT20030312AXS	41 36 00 84 12 26	0.250 11	250 21.7	7.1 Pittsford Educational Broa	101.65	103.06
233B Port Clinton	WXKR	LIC OH	ZCN 169.9 349.9	133.75 BLH19920629KD	41 29 51 83 16 12	3.309 197	374 13.0	45.2 Cumulus Licensing Corp.	76.68	75.58

***Affixed to 'IN' or 'Out' values = site inside protected contour.
ERP and HAAT are on direct line to and from reference station.
"x" = Station meets FCC minimum distance spacing for its class.

Exhibit 12 (Compliance with CFR 74.1204)

The proposed FM Translator is located within the protected 60 dBu contour of second adjacent channel station WCSX, channel 234B, Birmingham, AL. The predicted F(50-50) field strength of WCSX at the proposed translator site is 64.5 dBu, see Exhibit 12A. Therefore, the respective predicted interfering contour generated by the proposed FM Translator is 104.5 dBu. This interfering contour extends less than 113 meters from the proposed transmit antenna, and the area of overlap is unpopulated.

Examination of the USGS topographic map reveals no regularly occupied structures within the 113 meter interference aperture. The antenna will be mounted at 115 meters.

Therefore, EMF respectfully requests a waiver of C.F.R. 74.1204 based on no population within the area of predicted interference.

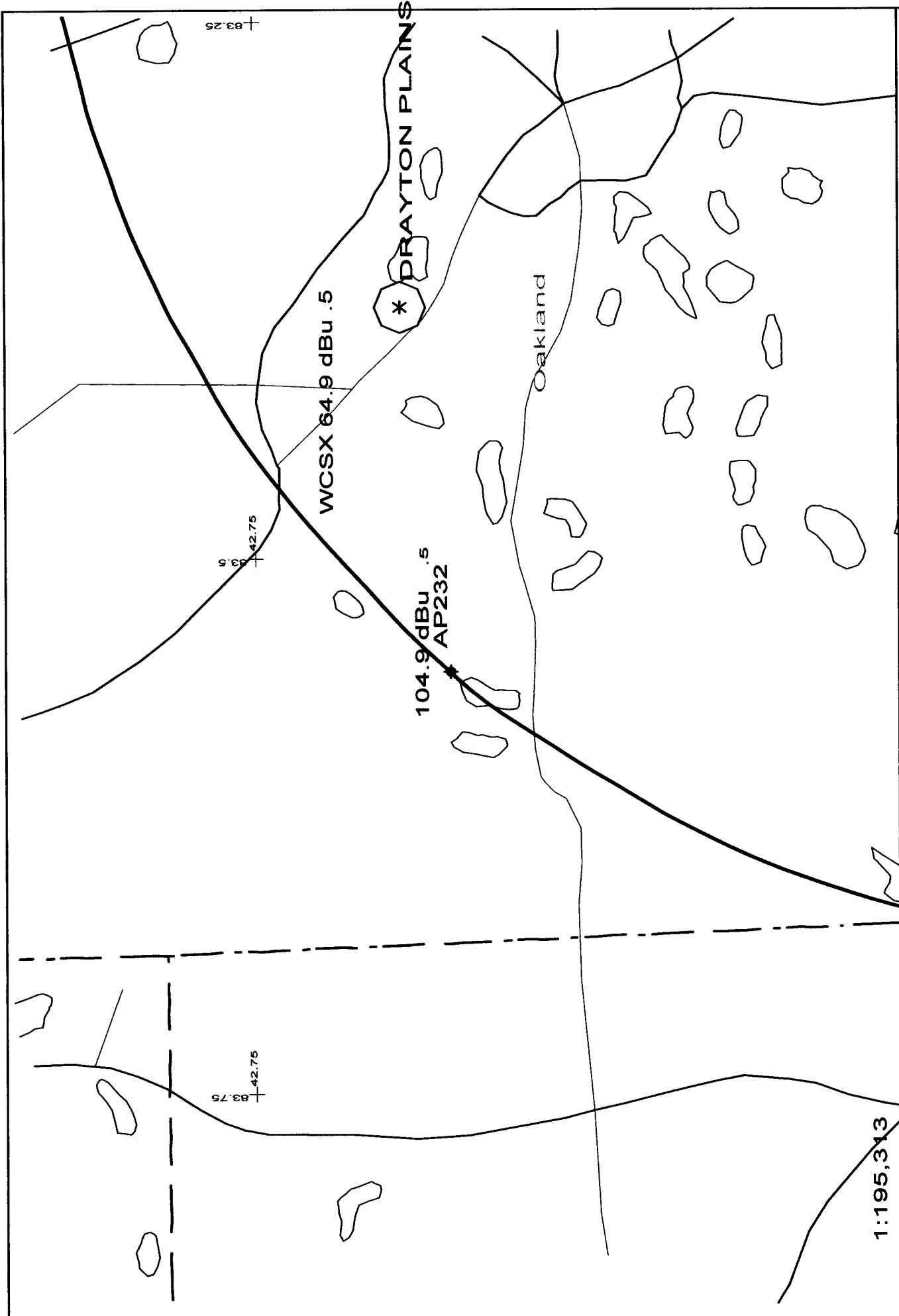

Scale in km 0 10	AP232 232D .01kW 434M AMSL N. Lat. 42 40 59 W. Lng. 83 33 11	Exhibit 12A - 08/03
---------------------	---	------------------------

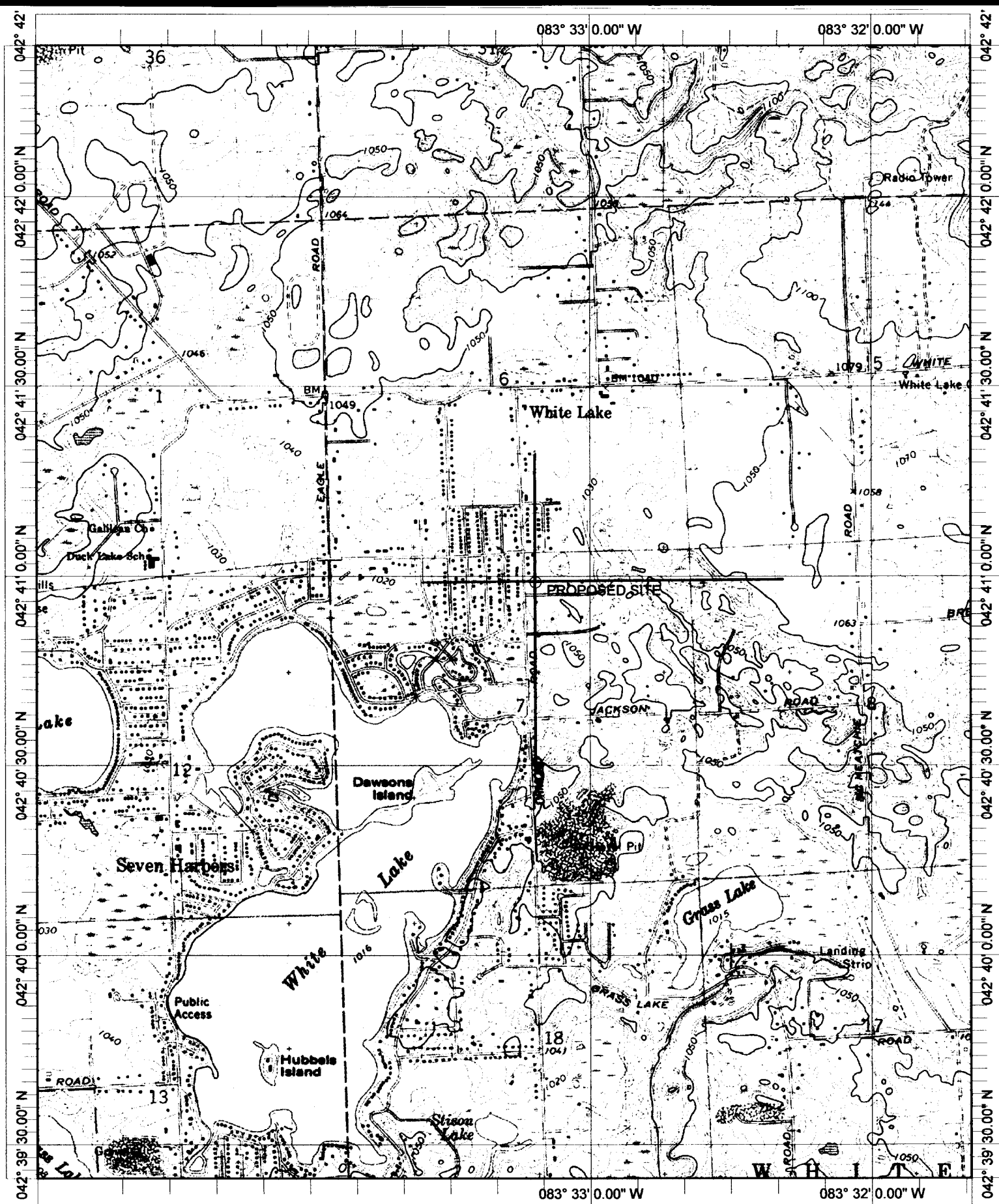

Name: HIGHLAND
 Date: 8/29/2003
 Scale: 1 inch equals 2000 feet

Location: 042° 40' 54.4" N 083° 33' 18.4" W
 Caption: Exhibit 12
 Site 42-40-59 / 83-33-11