

EDGEWATER BROADCASTING
SYLVESTER GEORGIA

REFERENCE
31 33 07 N
83 51 08 W

CH# 273D - 102.5 MHz, Pwr= 0.01 kw, HAAT=183.4 M, COR= 264 M
Average Protected F(50-50)= 7.86 km
Ave. F(50-10) 40 dBu= 26.5 54 dBu= 11.2 80 dBu= 1.9 100 dBu= .2

DISPLAY DATES
DATA 08-20-03
SEARCH 08-22-03

CH CITY	CALL	TYPE STATE	AZI. <--	DIST FILE #	LAT. LNG.	Pwr(kw) HAAT(M)	COR(M) INT(km)	PRO(km) LICENSEE	*IN* (Overlap in km)	*OUT*
273D Sylvester	AP273	APP GA C	0.0 180.0	0.00 BNPFT20030317DVM	31 33 07 83 51 08	0.010 157	264 25.5	7.3 Edgewater Broadcasting Inc	-32.00*	-32.71*
273D Albany	W273AE	LIC GA CN	284.6 104.6	33.68 BLFT19970528TF	31 37 40 84 11 45	0.055 63	121 26.3	7.0 Bible Broadcasting Network	2.36	0.37
271A Sylvester	WZBN.C	CP GA ZCX	155.7 335.7	2.94 BPH20010618AAL	31 31 40 83 50 22	6.000 90	188 0.2	26.9 Cumulus Licensing Corp.	-7.09*	-24.17*
271A Sylvester	WZBN	LIC GA NC	155.7 335.7	2.94 BLH20010227AAG	31 31 40 83 50 22	6.000 90	188 0.2	26.9 Cumulus Licensing Corp.	-7.09*	-24.17*
274L1 Ashburn	CP274	CP GA	50.9 230.9	29.69 BNPL20000607ABC	31 43 12 83 36 31	0.021 60	172 9.6	5.4 Turner County Council For	15.27	14.62
276D Tifton	WPLH	LIC GA HN	104.3 284.3	31.86 BLED19940426KA	31 28 51 83 31 38	0.029 46	150 0.2	5.1 Abraham Baldwin Agricultur	24.32	26.50
275C Columbus	WVRK	LIC GA HN	314.7 134.7	122.51 BLH2614	32 19 25 84 46 46	100.000 433	589 0.2	82.2 Clear Channel Broadcasting	102.78	40.12
273A Warner Robins	WELVFM	LIC GA NCN	8.5 188.5	114.43 BLH19940902KC	32 34 20 83 40 13	4.000 104	206 25.0	26.3 Cleveland Radio Licenses,	26.02	63.15
274L1 Moultrie	AP274	APP GA	171.7 351.7	42.92 BNPL20000608AFF	31 10 08 83 47 13	0.100 18	112 10.4	5.6 Sunrise Broadcasting Corpo	27.60	26.86
272A Jacksonville	ALLO	VAC GA	63.6 243.6	78.93 RM9855	31 51 54 83 06 16	6.000 -64	0 9.8	15.8	48.55	53.42
273C3 Dothan	WESP	LIC AL CX	257.3 77.3	141.97 BLH20020522AAB	31 15 48 85 18 24	16.500 129	205 26.5	39.7 Gulf South Communications,	25.02	75.77
273C1 Waycross	WYNR	LIC GA CN	103.4 283.4	184.21 BLH19971215KH	31 09 22 81 58 19	97.000 299	319 24.1	72.0 Qantum Of Brunswick Licens	6.00	88.15
270C3 Pearson	WPNG.A	APP GA CX	104.7 284.7	97.12 BPH20010312AAH	31 19 36 82 51 54	12.900 140	203 0.2	39.1 Km Radio Of Pearson, L.L.C	86.02	57.80
270C3 Pearson	WPNG	LIC GA ZCN	104.7 284.7	97.12 BLH20011009ABD	31 19 36 82 51 54	12.900 140	203 0.2	39.1 Km Radio Of Pearson, L.L.C	86.02	57.80
274C3 Madison	WXHT.C	CP FL CX	159.1 339.1	108.25 BPH20010529AAU	30 38 23 83 26 52	19.000 110	158 10.4	38.4 Magnum Broadcasting, Inc.	42.36	59.44
275D Nashville	AP275	APP GA C	122.3 302.3	69.57 BNPFT20030310ACC	31 12 59 83 14 03	0.250 33	106 0.2	7.4 David Allen Taylor	61.29	61.99
272C2 Cairo	WWLD	LIC GA NC	199.4 19.4	124.51 BLH20021030ABE	30 29 32 84 17 02	27.000 173	219 10.1	49.4 Cumulus Licensing Corp.	44.38	64.97
276C2 Tallahassee	WAIB	LIC FL CN	197.3 17.3	122.79 BLH19970530KB	30 29 39 84 14 00	42.000 164	201 0.2	52.4 Monterey Licenses, Llc	109.71	70.21
274C3 Madison	WXHT	LIC FL NC	155.8 335.8	120.74 BLH20001030AAX	30 33 29 83 20 06	15.000 103	134 10.5	35.5 Magnum Broadcasting, Inc.	58.68	74.72
270A Bainbridge	WBGE	LIC GA C	223.6 43.6	98.21 BLH20010518AAK	30 54 36 84 33 45	5.300 116	149 0.2	29.4 John H. Wiggins	88.05	68.56
270D Thomasville	W216BQ	APP GA V	190.4 10.4	80.36 BPFT20030501AAE	30 50 21 84 00 19	0.015 92	151 0.2	6.2 Calvary Chapel of Twin Fal	73.00	73.95
274A Mcrae	WYSC	LIC GA CN	58.7 238.7	108.93 BMLH19940214KD	32 03 25 82 51 56	3.000 83	155 9.7	22.2 Cinecom Broascasting Syste	69.04	77.08

"*"Affixed to 'IN' or 'Out' values = site inside protected contour.
 ERP and HAAT are on direct line to and from reference station.

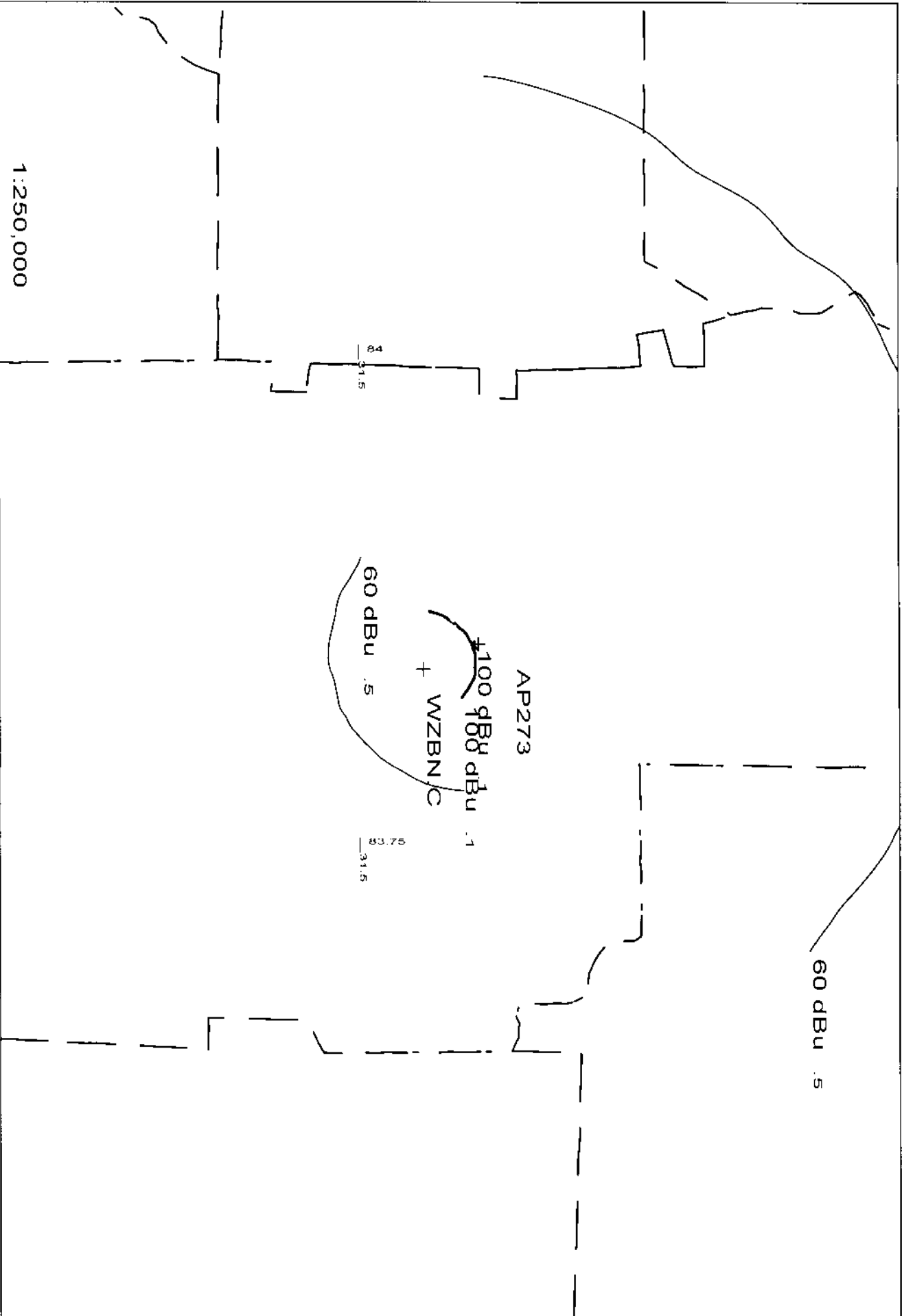

1:250,000

Scale in km

10.

20

AP273 273D .01KW 264M AMSL
WZBN.C 271A 6KW 188M AMSL

SYLVESTER
- 08/03