

Exhibit 12
Lake Charles, LA

REFERENCE 30 10 48 N CH# 281D - 104.1 MHz, Pwr= 0.17 kw, HAAT=120.0 M, COR= 120 M DISPLAY DATES
93 01 52 W Ave. F(50-10) 40 dBu= 43.6 54 dBu= 19.1 80 dBu= 4.0 100 dBu= .9 DATA 08-01-03
SEARCH 08-15-03

CH CITY	CALL	TYPE STATE	AZI. <--	DIST FILE #	LAT. LNG.	Pwr(kw) HAAT(M)	COR(M) INT(km)	PRO(km) LICENSEE	*IN* (Overlap in km)	*OUT*
281D Lake Charles	AP281	APP LA	276.2 96.2	18.29 BNPFT20030313BJV	30 11 51 93 13 12	0.019 103	104 43.4	6.9 Educational Media Foundati	-17.60	-32.07
279C1 Lake Charles	KBIU	LIC LA	283.5 103.5	30.96 BLH19971208KB	30 14 41 93 20 38	100.000 150	150 0.9	58.5 Cumulus Licensing Corp.	11.10	-28.42*
283C1 Orange	KKMY	LIC TX	266.6 86.6	78.48 BMLH19980721KC	30 08 07 93 50 39	100.000 123	123 0.9	54.7 Capstar Tx Limited Partner	59.25	22.89
284C3 Washington	KNEKFM	LIC LA	72.8 252.8	92.20 BLH19960223KB	30 25 17 92 06 50	25.000 102	113 0.9	39.4 Citadel Broadcasting Compa	75.38	51.93
279C La Port	ALLO	RSV TX	261.2 81.2	145.50 RM10035	29 58 19 94 31 16	100.000 -9	0 0.9	31.0	129.62	113.62
279C La Porte	KVST.C	CP TX	264.6 84.6	147.22 BPH20010612AEF	30 02 45 94 33 03	100.000 589	601 0.9	91.4 New Wavo Communication Gro	120.89	54.90
281C0 Gonzales	RADD	ADD LA	98.8 278.8	204.84	29 52 55 90 56 07	100.000 0	0 43.6	31.0	61.36	130.32
282C3 Bunkie	KEZP	LIC LA	32.3 212.3	119.42 BLH19910930KE	31 05 14 92 21 34	18.000 120	137 18.6	39.4 Owensville Communications	47.36	61.47
281C Houma	KSTEFM	LIC LA	95.9 275.9	223.91 BLH19880224KB	29 57 13 90 43 25	100.000 594	594 43.5	91.6 Clear Channel Broadcasting	13.77	88.78
281C Houma	RDEL	DEL LA	95.9 275.9	223.91	29 57 13 90 43 25	100.000 0	0 43.5	31.0	80.43	149.40
279A Opelousas	RADD	ADD LA	70.7 250.7	99.39	30 28 18 92 03 14	6.000 -12	0 0.9	15.8	85.09	82.72

***Affixed to 'IN' or 'Out' values = site inside protected contour.
ERP and HAAT are on direct line to and from reference station.

Exhibit 12 (Compliance with CFR 74.1204)

The proposed FM Translator is located within the protected 60 dBu contour of third adjacent channel station KBIU, channel 279C1, Lake Charles, LA. The predicted F(50-50) field strength of KBIU at the proposed translator site is 73.9 dBu, see Exhibit 12A. Therefore, the respective predicted interfering contour generated by the proposed FM Translator is 113.9 dBu. This interfering contour extends less than 185 meters from the proposed transmit antenna, and the area of overlap is unpopulated.

Two factors have been investigated to determine this absence of population:

1) Computer software which uses the centroid method of determining population centers, based on the 2000 census data, has determined that there are no persons within the area of overlap.

2) Examination of the USGS topographic map reveals no regularly occupied structures or highways within the area of overlap.

Therefore, EMF respectfully requests a waiver of C.F.R. 74.1204 based on no population within the area of predicted interference.

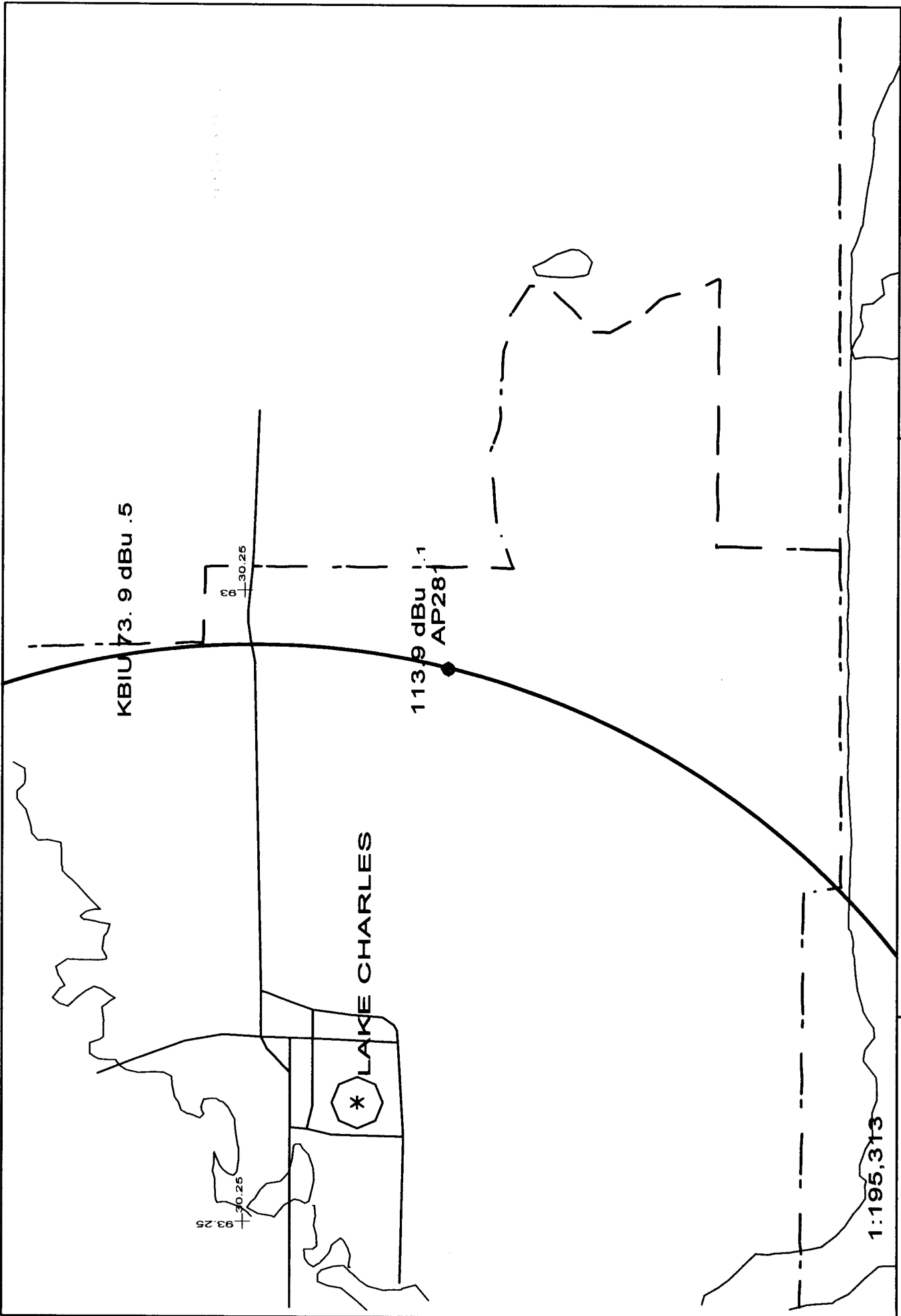

Scale in km

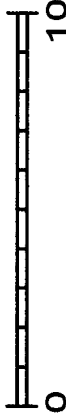

AP281 281D .17kW 120M AMSL

N. Lat. 30 10 48 W. Lng. 93 01 52

Exhibit 12A

- 08/03

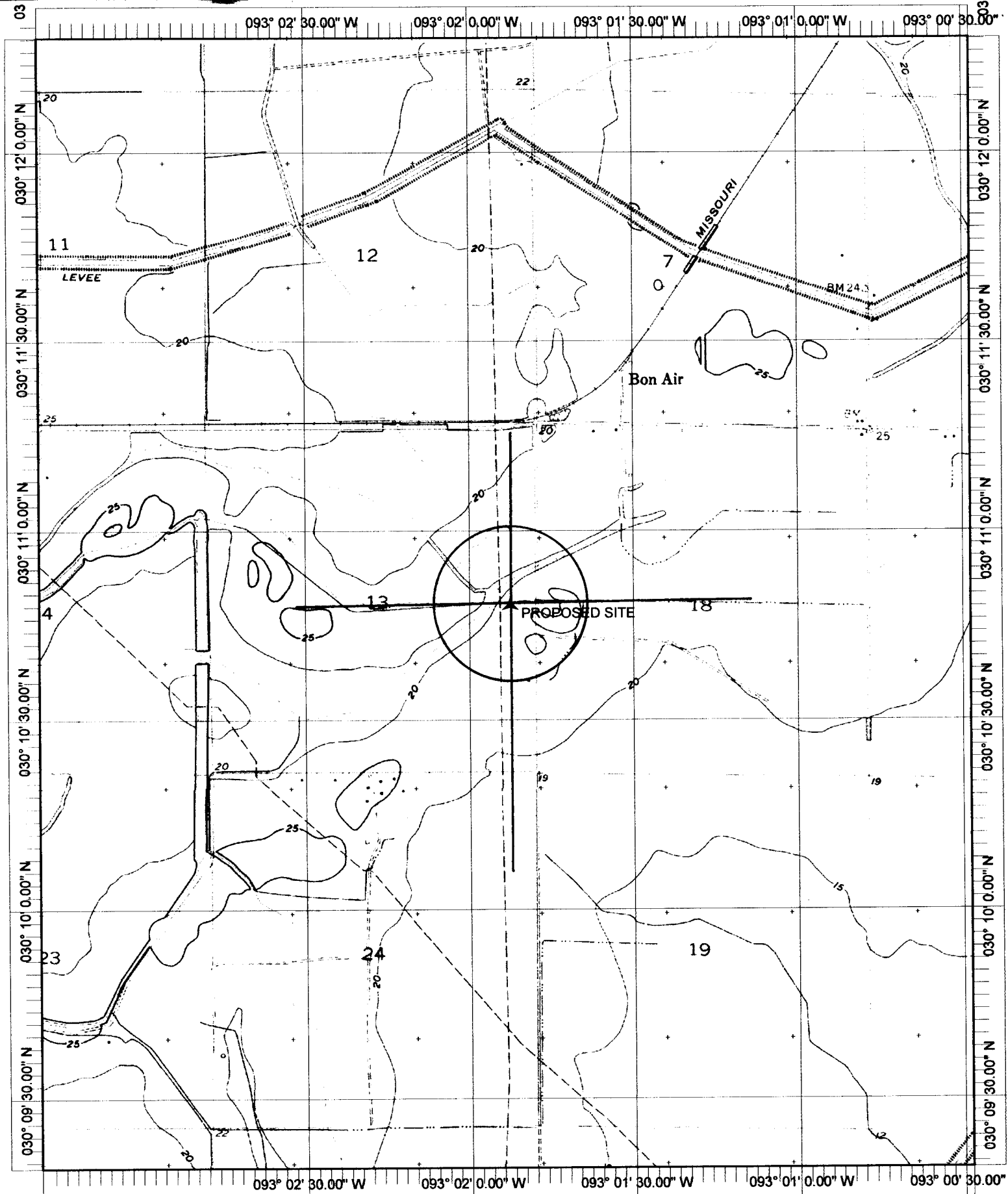

Name: IOWA
 Date: 8/16/2003
 Scale: 1 inch equals 2000 feet

Location: 030° 10' 48.6" N 093° 01' 53.5" W
 Caption: Exhibit 12 - Topo Map