

## **Page #1, Waiver Request of Section 74.1204**

W203AY Golden Lakes, FL 19 Watts ERP

Calvary Chapel of Twin Falls, Inc. 10/04

The proposed site is contained entirely inside the service contour of second-adjacent station WAYF, West Palm Beach, FL

### **WAYF.LIC**

The proposed site is contained entirely inside the service contour of second-adjacent Station WAYF.LIC, Channel 201, Class C2, 50 kW, West Palm Beach, FL. As shown by the map on **page #2** of this waiver request, the level of the second-adjacent station WAYF arriving protected F(50,50) signal at the proposed transmitter site 82-dBu. Using the Undesired-to-Desired method for calculating proposed interference (the basis of the FCC current contour overlap regulations and an acceptable method for the purposes of determining lack of interference for an FM Translator), the proposed interfering contour with respect to WAYF is 122-dBu (free-space contour method employed). This means that the 122-dBu interfering signal would, in the worst case at the maximum radial, extend 25 meters from the center of radiation, which is proposed at 100 meters AGL. This interference area begins 75 meters AGL and does not touch the ground. A portion of the Riviera Beach Quad is attached which shows that this tower is located in a less populated area where the buildings are not as tall as the interference area. Because there will be no population affected by this interference area, Calvary Chapel of Twin Falls, Inc. respectfully requests a waiver of the FM translator contour overlap regulations with respect to second-adjacent channel station WAYF.

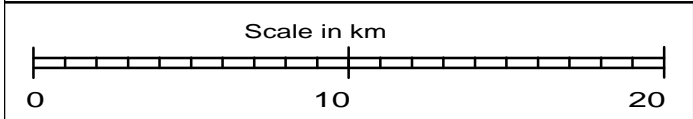
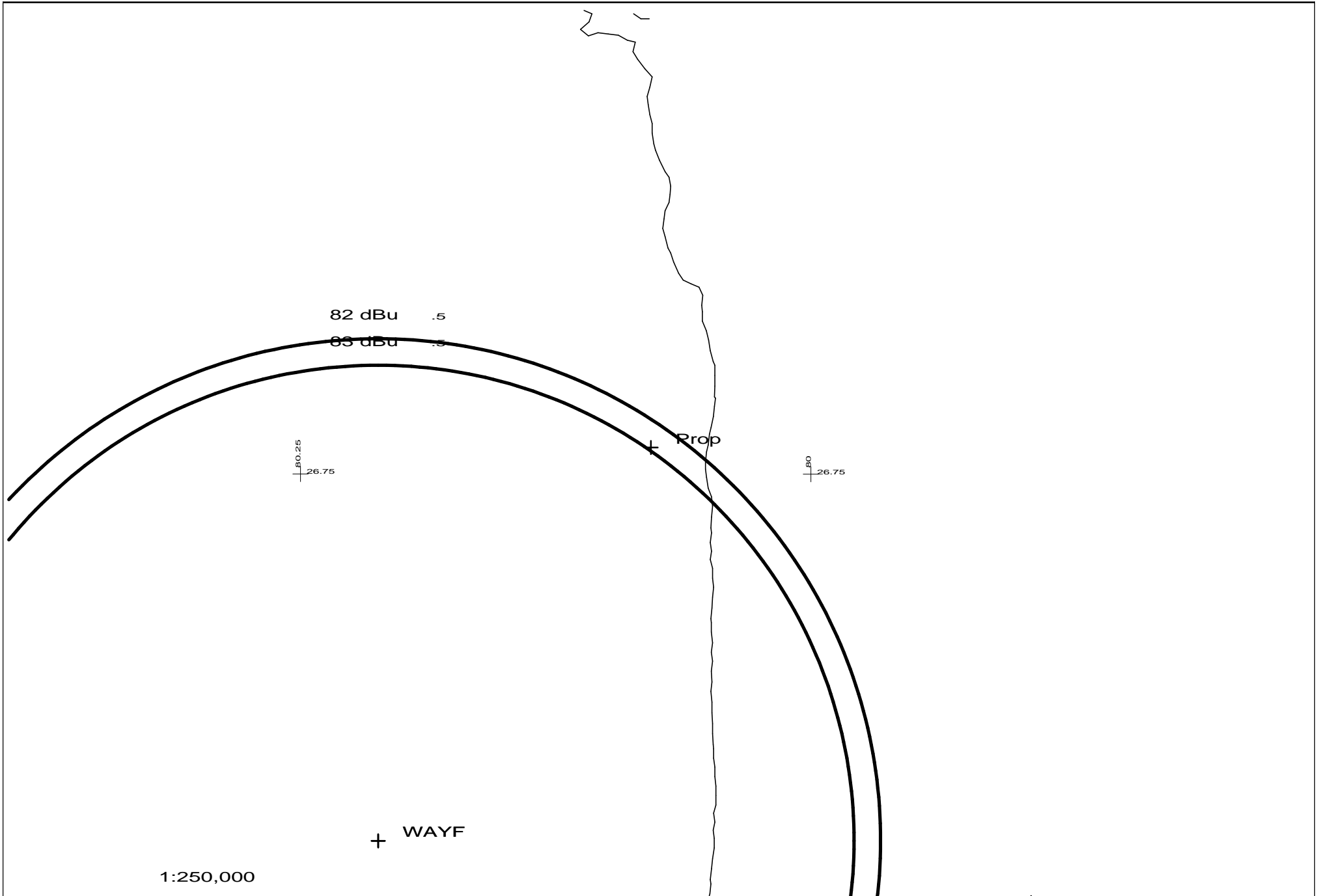

Prop 203D .019kW 105M AMSL  
N. Lat. 26 45 42 W. Lng. 80 04 42

Golden Lakes, FL  
CCTF - 10/04

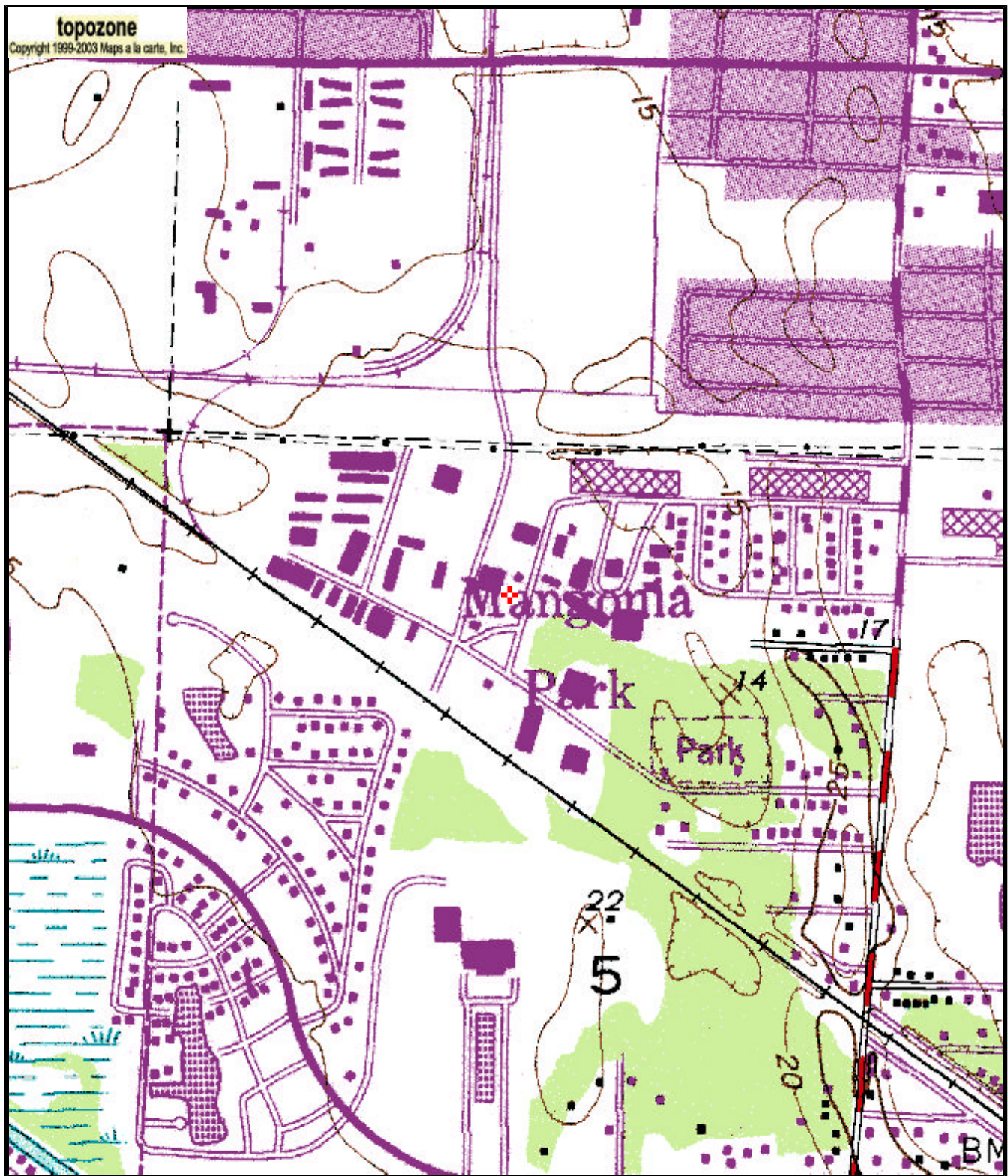

0 0.1 0.2 0.3 0.4 0.5 km  
0 0.09 0.18 0.27 0.36 0.45 mi  
Map center is 26° 45' 42"N, 80° 04' 42"W (NAD27)  
**Riviera Beach** quadrangle  
Projection is UTM Zone 17 NAD83 Datum

Mpk  
G  
M=-5.876  
G=0.415

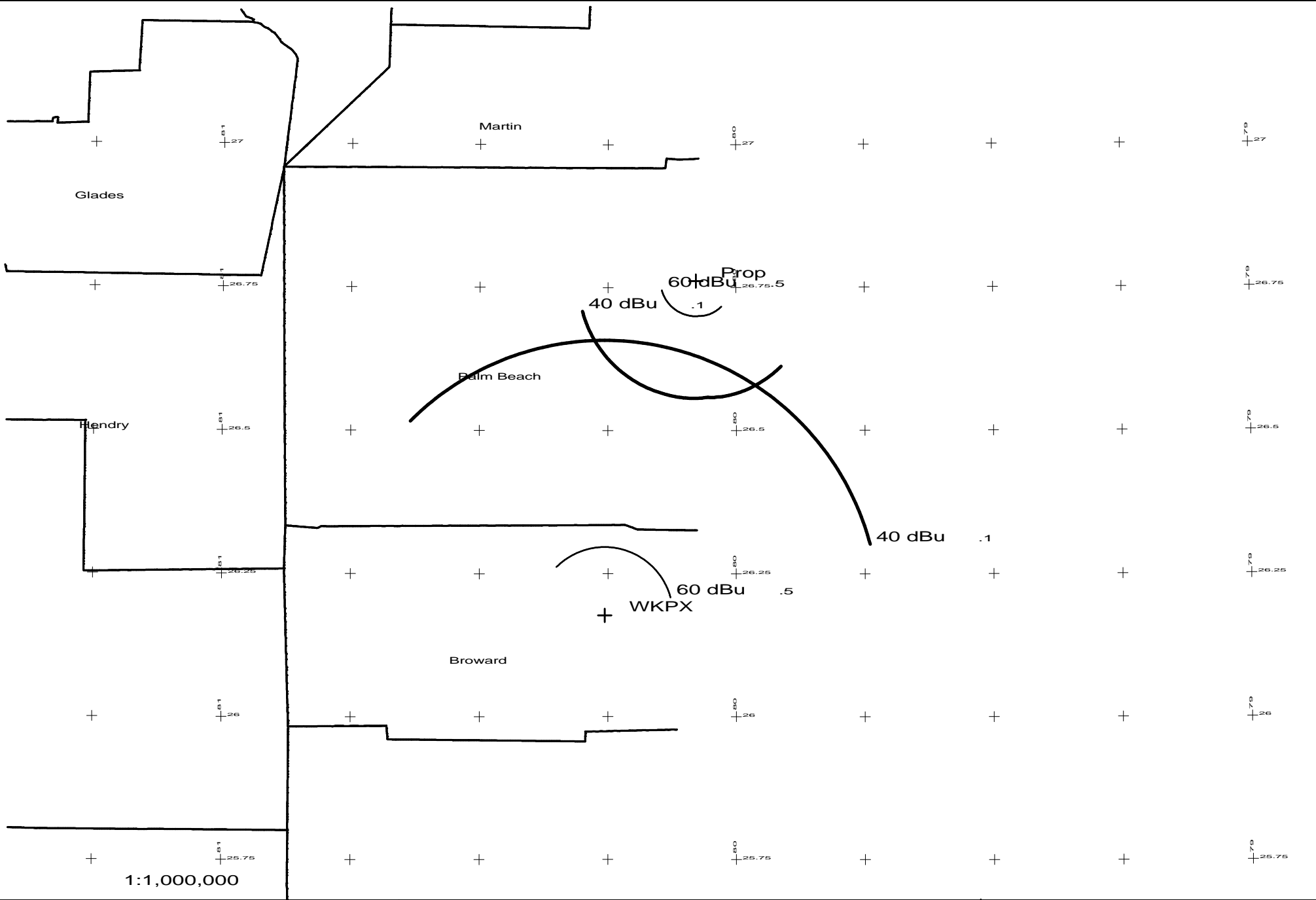

<p>Scale in km</p>  <p>0 10 20 30 40 50 60 70</p>	<p>Prop 203D .019kW 105M AMSL</p> <p>WKPX 203A 3kW 33M AMSL</p>	<p>Prop vs WKPX</p> <p>CCTF - 10/04</p>
---	---	---

Contour.Out

10/19/2004

TERRAIN AND CONTOUR DATA  
GOLDEN LAKES, FL W203AY  
19 WATTS ERP

N. Lat. = 26 45 42 W. Lng. = 80 04 42  
HAAT and Distance to Contour - FCC Method - 03 Arc Sec.

W203AY, Calvary Chapel Of Twin Falls,, BLFT20010815AAS  
Azi. AV EL HAAT ERP kW dBk Field 60-F5  
-----  
000 4.3 100.7 0.0190 -17.21 1.000 6.85  
030 0.4 104.6 0.0190 -17.21 1.000 6.99  
060 0.0 105.0 0.0190 -17.21 1.000 7.00  
090 0.0 105.0 0.0190 -17.21 1.000 7.00  
120 0.0 105.0 0.0190 -17.21 1.000 7.00  
150 1.0 104.0 0.0190 -17.21 1.000 6.97  
180 5.4 99.6 0.0190 -17.21 1.000 6.82  
210 5.4 99.6 0.0190 -17.21 1.000 6.82  
240 5.4 99.6 0.0190 -17.21 1.000 6.82  
270 5.6 99.4 0.0190 -17.21 1.000 6.81  
300 6.0 99.0 0.0190 -17.21 1.000 6.80  
330 6.0 99.0 0.0190 -17.21 1.000 6.80

Ave El= 3.28 M HAAT= 101.72 M AMSL= 105M