

# Exhibit 27.1 - Copy of USGS Topographic Map of Proposed Site

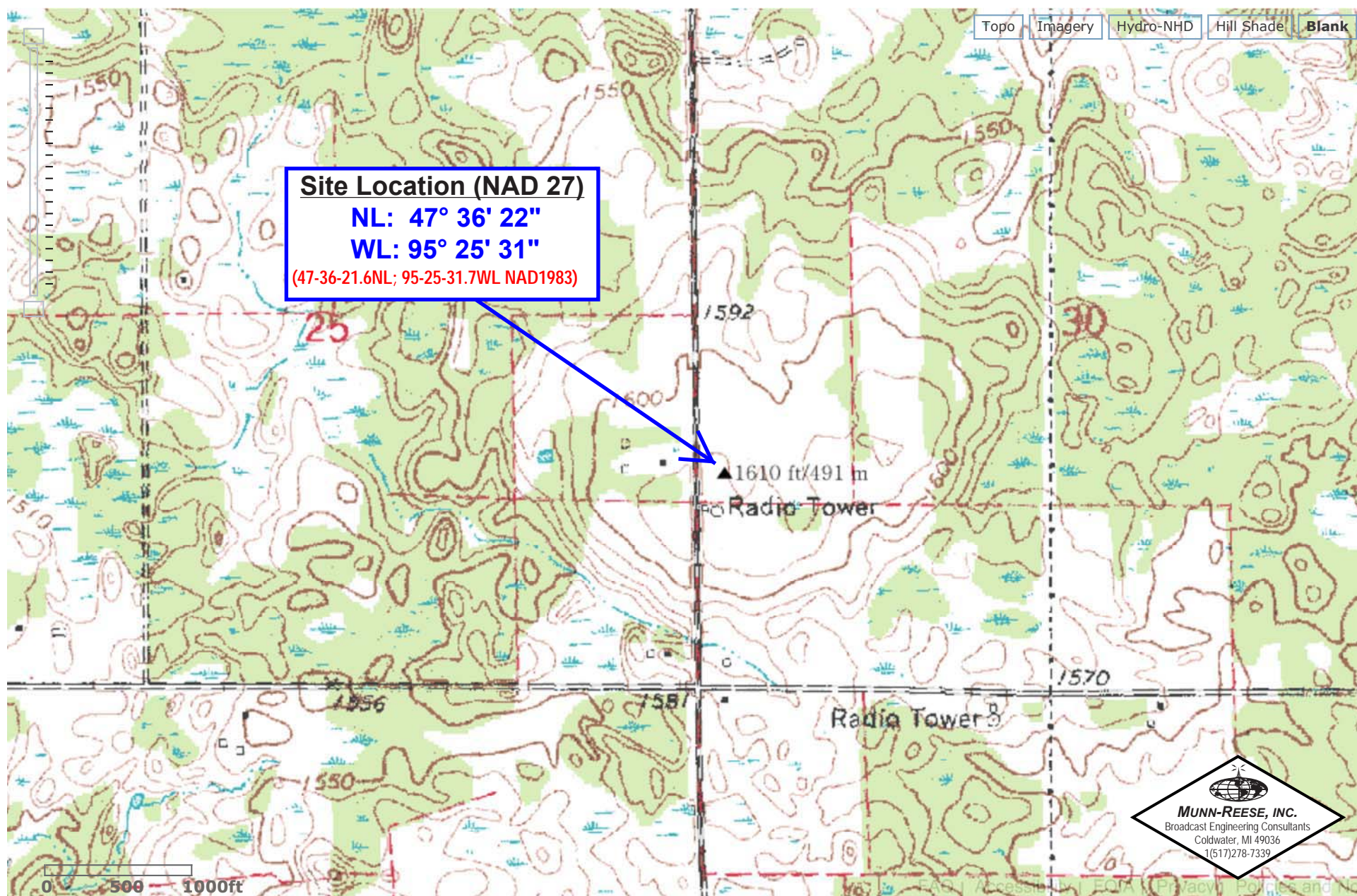



## Exhibit 27.2 - Copy of USGS Aerial Photo of Proposed Site



# Exhibit 27.3

## Vertical Plan of Antenna System

The site is located 0.45 km north of the "T" Intersection of State Route 92 and 410th Street, the city of Bagley, Clearwater County, Minnesota.

### Site Location (NAD 27)

NL: 47° 36' 22"

WL: 95° 25' 31"

(47-36-21.6NL; 95-25-31.7WL NAD1983)

### NOTE: Proposed New Tower Construction

Antenna Structure Registration No.

**1289307**

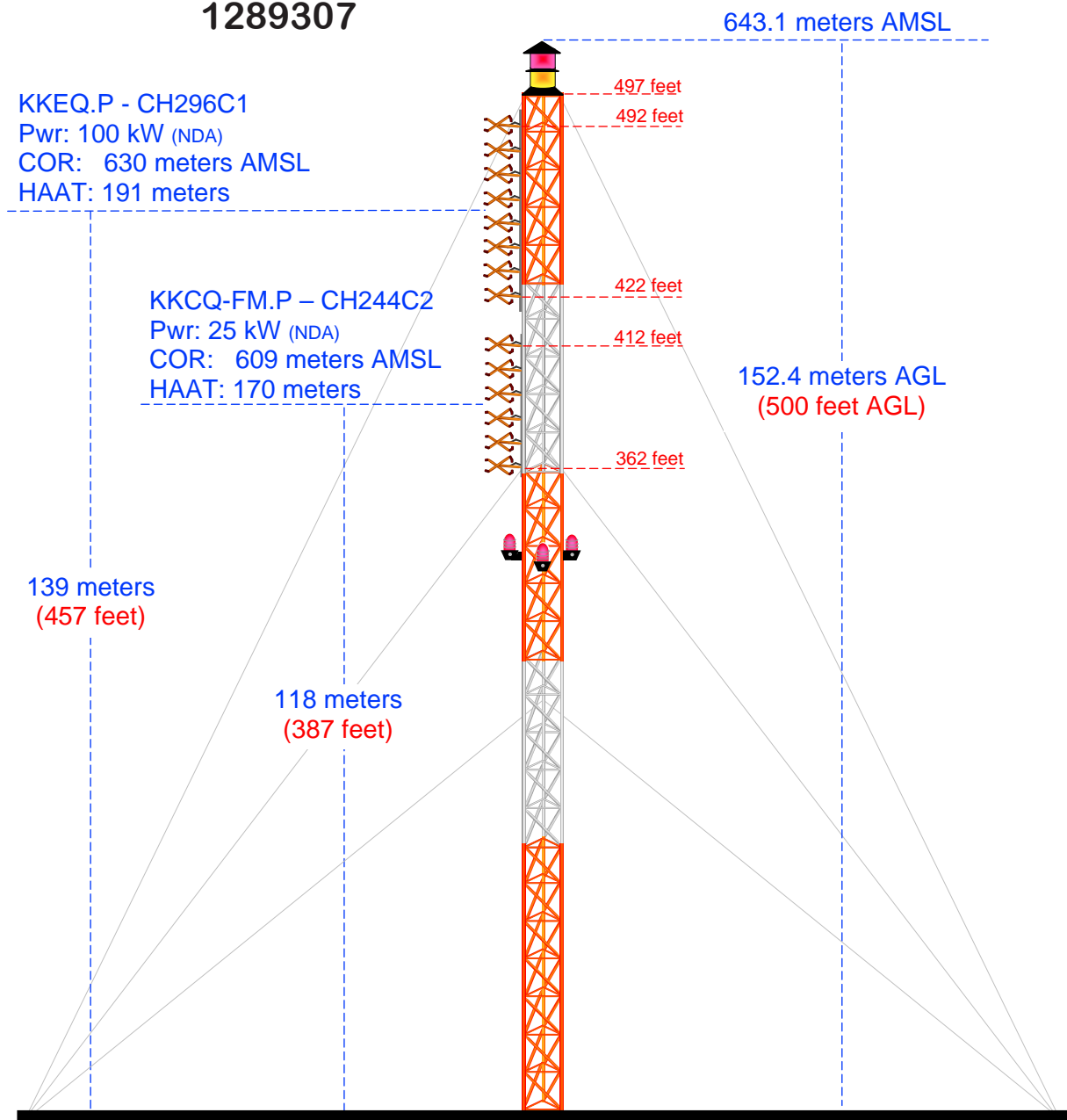

Ground Elevation = 490.7 m AMSL

Drawing is not to Scale

**MUNN-REESE, INC.**

Broadcast Engineering Consultants  
Coldwater, MI 49036

## Exhibit 27.4

### Proposed FM Operating Specifications

---

**Applicant:** Pine to Prairie Broadcasting, Inc.

**Call:** KKEQ(FM)

**City of License:** Fosston, MN

**Frequency:** 107.1 MHz   **Channel:** 296C1   **ERP:** 100.0 kW   **HAAT:** 191 m

**Transmitter Location:** The site is located 0.45 km north of the "JL" Intersection of State Route 92 and 410th Street.

**City:** Bagley

**County:** Clearwater

**State:** Minnesota

**Site Coordinates:** NL: 47° 36' 22"   /   WL: 95° 25' 31"

**Tower Registration Number:** 1289307

**Proposed Operation:** Class C1

**Effective Radiated Power:** 100.0 kW (H)                      100.0 kW (V)

**Height of Antenna Radiation Center Above:**

	<u>Average Terrain</u>	<u>Mean Sea Level</u>	<u>Ground</u>
Horizontal	191 meters	630 meters	139 meters
Vertical	191 meters	630 meters	139 meters

**Elevation of Tower Site :** 490.7 Meters AMSL

**Overall Height of Structure Above Ground :** 152.4 Meters AGL

**Overall Height of Structure Above Mean Sea Level:** 643.1 Meters AMSL



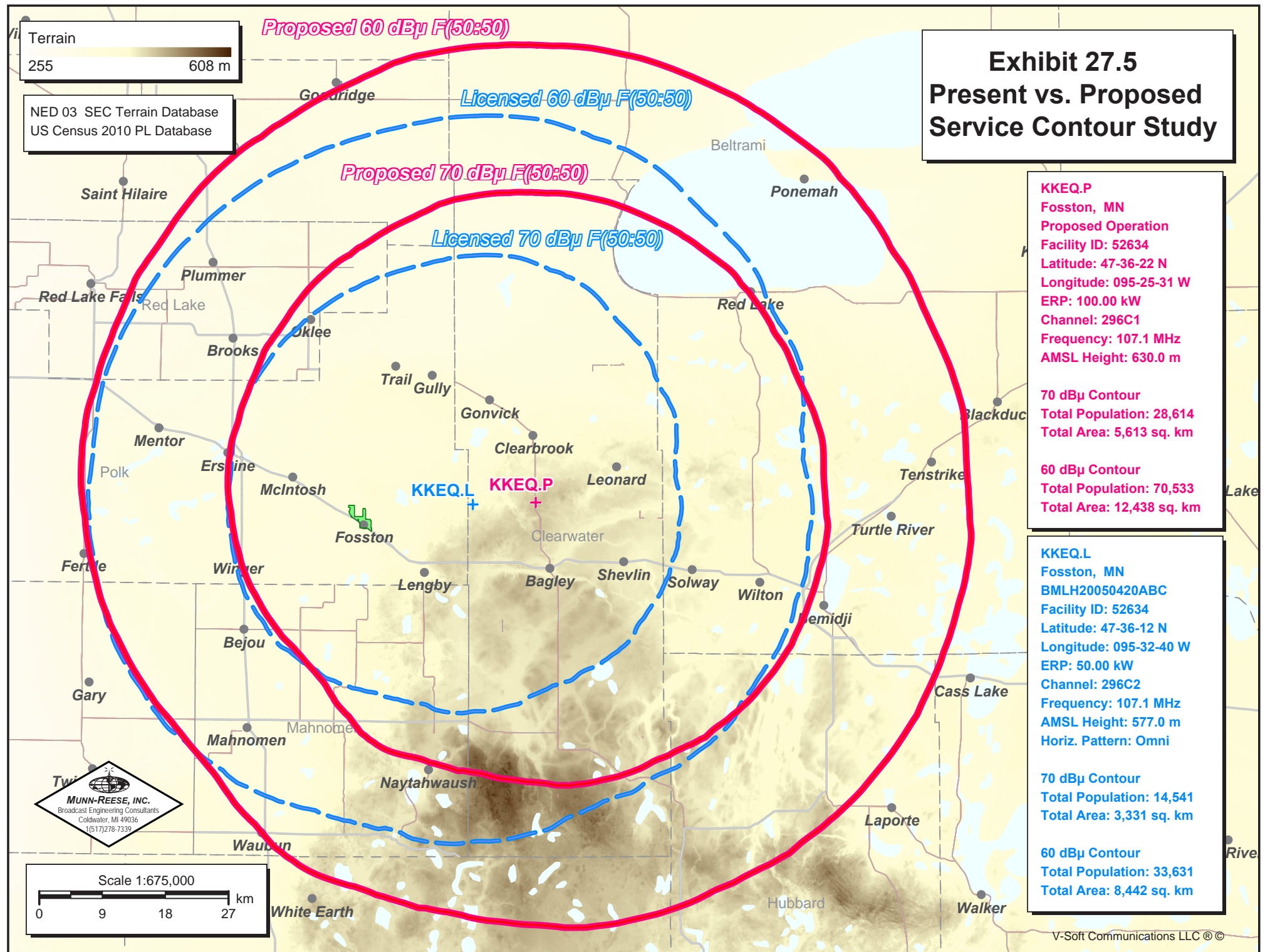

# Exhibit 27.6 - Copy of Existing Antenna Structure Registration



## Registration Detail

Reg Number	1289307	Status	Granted
File Number	A0844054	Constructed	
EMI	No	Dismantled	
NEPA			

## Antenna Structure

Structure Type GTOWER - Guyed Structure Used for Communication Purposes

### Location (in NAD83 Coordinates)

Lat/Long	47-36-21.6 N 095-25-31.7 W	Address	East side of County Highway 92, approximately 6 miles north of Bagley, MN.
City, State	Bagley , MN		
Zip	56652	County	CLEARWATER
Center of AM Array		Position of Tower in Array	

## Heights (meters)

Elevation of Site Above Mean Sea Level	Overall Height Above Ground (AGL)
490.7	152.4
Overall Height Above Mean Sea Level	Overall Height Above Ground w/o Appurtenances
643.1	151.5

## Painting and Lighting Specifications

FAA Chapters 12, 3, 4, 5  
Paint and Light in Accordance with FAA Circular Number 70/7460-1K

## FAA Notification

FAA Study	2013-AGL-6356-OE	FAA Issue Date	07/17/2013
-----------	------------------	----------------	------------

## Owner & Contact Information

FRN	0022457162	Owner Entity Type	Limited Liability Company
-----	------------	-------------------	---------------------------

### Owner

Clearwater Tower L.L.C.  
Attention To: Jim Birkemeyer  
312 West Main Street  
Ada , MN 56510

P: (218)784-2844  
F:  
E: jimkrjbkrjm@loretel.net

### Contact

Birkemeyer , Jim  
312 West Main Street  
Ada , MN 56510

P: (218)784-2844  
F:  
E: jimkrjbkrjm@loretel.net

## Last Action Status

Status	Granted	Received	11/07/2013
Purpose	Amendment	Entered	11/07/2013
Mode	Interactive		

## Related Applications

11/07/2013 A0844054 - Amendment (AM)

## Comments

### Comments

11/08/2013 NEPA resolved per FONSI letter dated 11/6/13; File number A0844054.

11/08/2013 Special Condition: The FAA has approved the absence of steady burning red obstruction (L-810) lights on this structure. Accordingly, this tower will use red flashing lights (L-864) only.

11/08/2013 Refer to the Technical Report (Technical Note DOT/FAA/TC-TN12/9 Evaluation of New Obstruction Lighting Techniques to Reduce Avian Fatalities).

All comments (4)

## History

Date	Event
11/09/2013	Registration Printed

## Automated Letters

11/09/2013 Authorization, Reference