

Exhibit 12
Perrysburg, OH

REFERENCE CH# 236D - 95.1 MHz, Pwr= 0.01 kW, HAAT=88.6 M, COR= 269 M
41 33 30 N Average Protected F(50-50)= 5.49 km
83 33 34 W Ave. F(50-10) 40 dBu= 17.9 54 dBu= 7.7 80 dBu= 1.6 100 dBu= .2

DISPLAY DATES
DATA 08-16-03
SEARCH 08-19-03

CH CITY	CALL	TYPE STATE	AZI. <--	DIST FILE #	LAT. LNG.	Pwr(kw) HAAT(M)	COR(M) INT(km)	PRO(km) LICENSEE	*IN* (Overlap in km)	*OUT*
236D Perrysburg	AP236	APP C OH	0.0 180.0	0.00 BNPFT20030313BCH	41 33 30 83 33 34	0.010 77	269 17.6	5.1 Educational Media Foundati	-21.80*	-22.67*
233B Port Clinton	WXKR	LIC ZCN OH	105.6 285.6	25.09 BLH19920629KD	41 29 51 83 16 12	29.533 191	374 0.4	64.5 Cumulus	13.90 Licensing Corp.	-39.82*
236D Monroe	AP236	APP DV MI	24.6 204.6	41.05 BNPFT20030317APK	41 53 38 83 21 10	0.016 85	256 17.9	6.0 Calvary Chapel Of Twin Fal	15.66	17.15
236D Monroe	AP236	APP DV MI	24.6 204.6	41.05 BNPFT20030811AEP	41 53 38 83 21 10	0.002 95	266 17.9	3.7 Calvary Chapel Of Twin Fal	23.67	19.44
236A Windsor	ALLO	ON	30.7 210.7	101.12	42 20 20 82 55 53	6.000 -186	0 25.7	22.4	-3.22	53.04
236A Windsor	NEW	PRO DHN ON	30.7 210.7	101.12	42 20 20 82 55 53	2.000 67	253 25.7	25.0	10.37	50.42
239A Gibsonburg	WIMX	LIC ZCN OH	129.2 309.2	15.21 BLH19931020KA	41 28 19 83 25 05	3.277 134	321 0.2	28.1 Riverside Broadcasting, In	7.39	-13.06*
237A Adrian	WQTE	LIC CN MI	302.0 122.0	51.95 BLH7225	41 48 15 84 05 25	3.000 111	329 7.5	25.5 Friends Communications Of	7.90	19.00
236B Fort Wayne	WAJI	LIC CN IN	250.2 70.2	145.63 BLH19900226KE	41 06 13 85 11 28	39.000 211	453 24.9	69.1 Sarkes Tarzian, Inc.	0.44	51.67
236A Mount Gilead	WVXG	LIC DCN OH	149.4 329.4	125.05 BLED19940304KB	40 35 15 82 48 20	4.534 129	460 16.5	29.7 Xavier University	32.89	78.81
236B Chatham	CKSYFM	OPE CN ON	50.4 230.4	157.33	42 27 00 82 05 00	35.000 -174	0 25.5	33.4	13.48	98.40
237A Norwalk	WLKRFM	LIC C OH	112.0 292.0	81.48 BMLH20000615AFD	41 16 49 82 39 27	3.300 96	312 7.5	24.2 Elyria-Iorain Broadcasting	39.45	49.77
236B Flint	WFBE	LIC DCN MI	356.6 176.6	162.68 BMLH19970808KC	43 01 13 83 40 40	32.967 61	311 25.3	44.7 Citadel Broadcasting Compa	44.13	92.67
234B Birmingham	WCSX	LIC CN MI	18.0 198.0	104.70 BMLH19981008KA	42 27 13 83 09 50	13.500 298	488 0.4	66.0 Greater Boston Radio, Inc.	93.60	38.29
238D Baird	AP238	APP C OH	186.9 6.9	58.48 BNPFT20030313BEM	41 02 08 83 38 36	0.120 35	269 0.2	6.3 Educational Media Foundati	52.63	51.93
238D Baird	AP238	APP C OH	186.9 6.9	58.48 BNPFT20030807AGT	41 02 08 83 38 36	0.120 35	269 0.2	6.3 Educational Media Foundati	52.63	51.93
238B Detroit	WKQI	LIC C MI	16.2 196.2	105.88 BLH19990920ABM	42 28 23 83 11 59	100.000 146	338 0.4	71.6 Amfm Radio Licenses, L.L.c	93.28	33.80
235A Ada	WONB	LIC CN OH	194.9 14.9	91.02 BLED19911023KC	40 45 58 83 50 14	3.000 117	381 7.1	26.0 Ohio Northern University	46.40	57.93
237A Kenton	WKTN	LIC CN OH	180.3 0.3	101.46 BMLH19981218KA	40 38 41 83 33 59	3.500 103	381 7.1	25.5 Radio General, Ltd.	57.57	68.86

*****Affixed to 'IN' or 'Out' values = site inside protected contour.
ERP and HAAT are on direct line to and from reference station.

Exhibit 12 (Compliance with CFR 74.1204)

The proposed FM Translator is located within the protected 60 dBu contour of third adjacent channel station WXKR, channel 233B, Port Clinton, OH. The predicted F(50-50) field strength of WXKR at the proposed translator site is 74.7 dBu, see Exhibit 12A. Therefore, the respective predicted interfering contour generated by the proposed FM Translator is 114.7 dBu. This interfering contour extends less than 41 meters from the proposed transmit antenna, and the area of overlap does not reach the ground.

The proposed FM Translator is located within the protected 60 dBu contour of third adjacent channel station WIMX, channel 239A, Gibsonburg, OH. The predicted F(50-50) field strength of WIMX at the proposed translator site is 70.8 dBu, see Exhibit 12A. Therefore, the respective predicted interfering contour generated by the proposed FM Translator is 110.8 dBu. This interfering contour extends less than 63 meters from the proposed transmit antenna, and the area of overlap does not reach the ground.

Therefore, EMF respectfully requests a waiver of C.F.R. 74.1204 based on no population within the area of predicted interference.

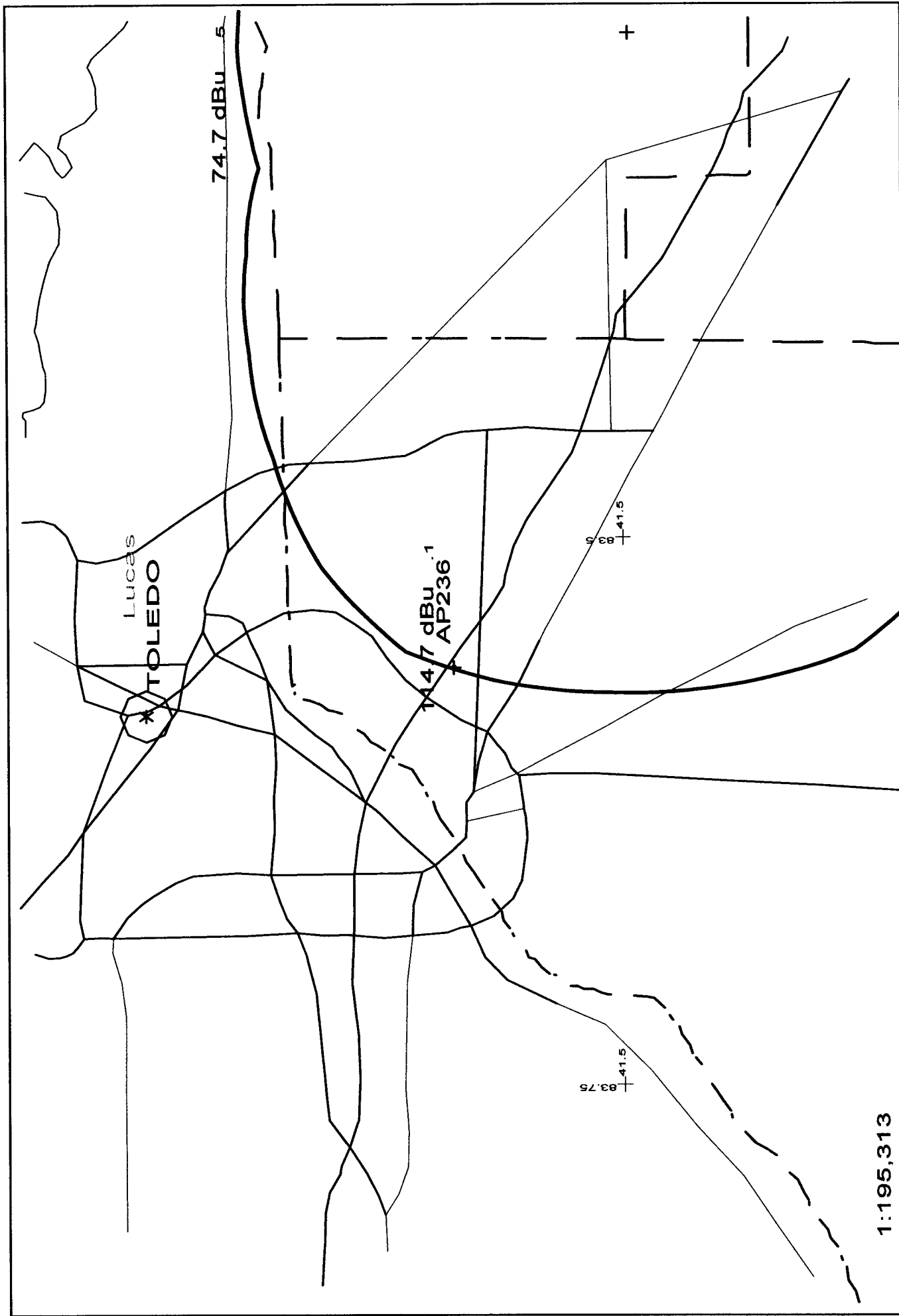

<p>1:195,313</p> <p>Scale in km</p> <p>0 10</p>	<p>AP236 236D .01kW 269M AMSL</p> <p>N. Lat. 41 33 30 W. Lng. 83 33 34</p>	<p>Exhibit 12A</p> <p>- 08/03</p>
---	--	-----------------------------------

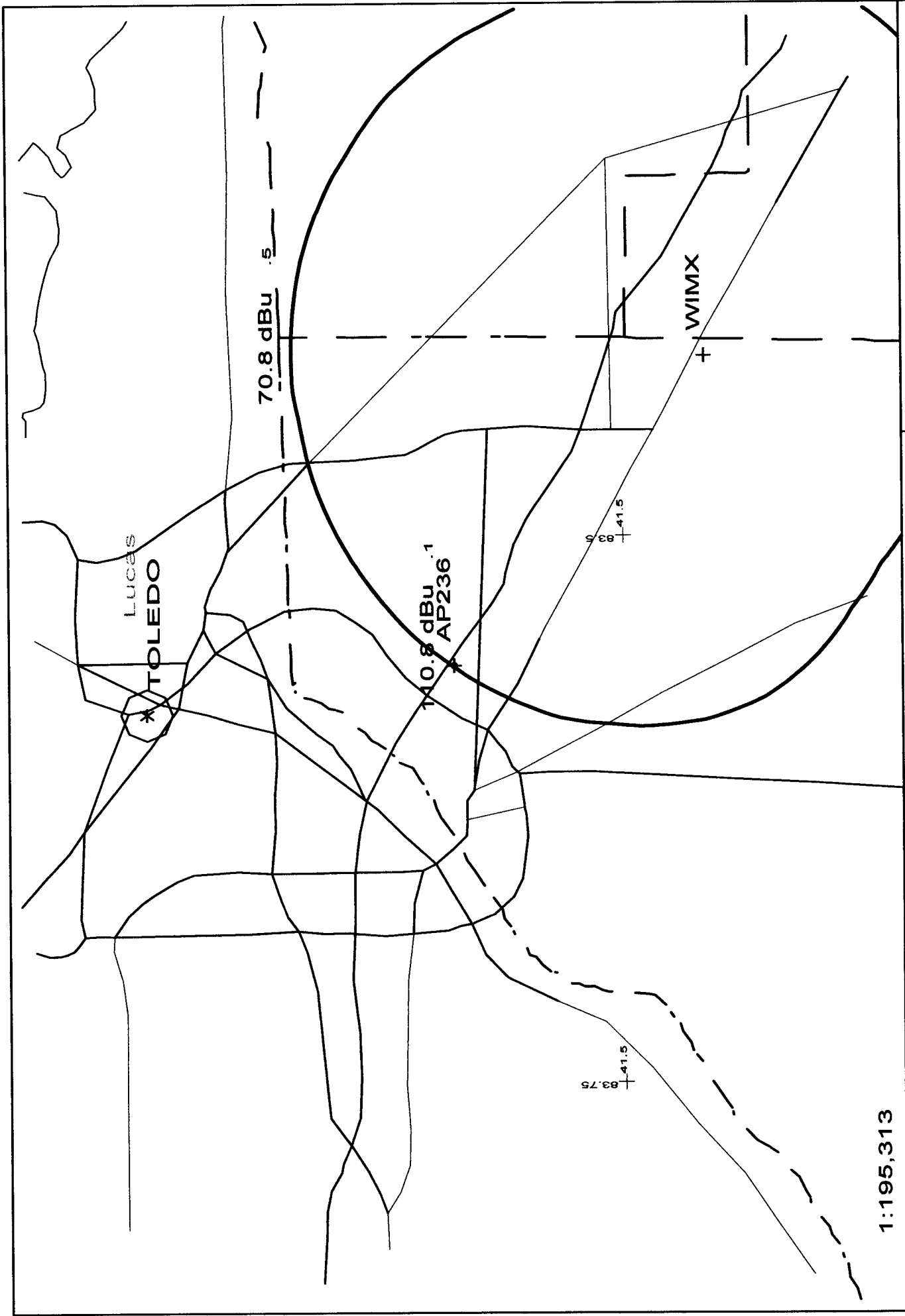

1:195,313

Scale in km



AP236 236D .01kW 269M AMSL

N. Lat. 41 33 30 W. Lng. 83 33 34

Exhibit 12B

- 08/03

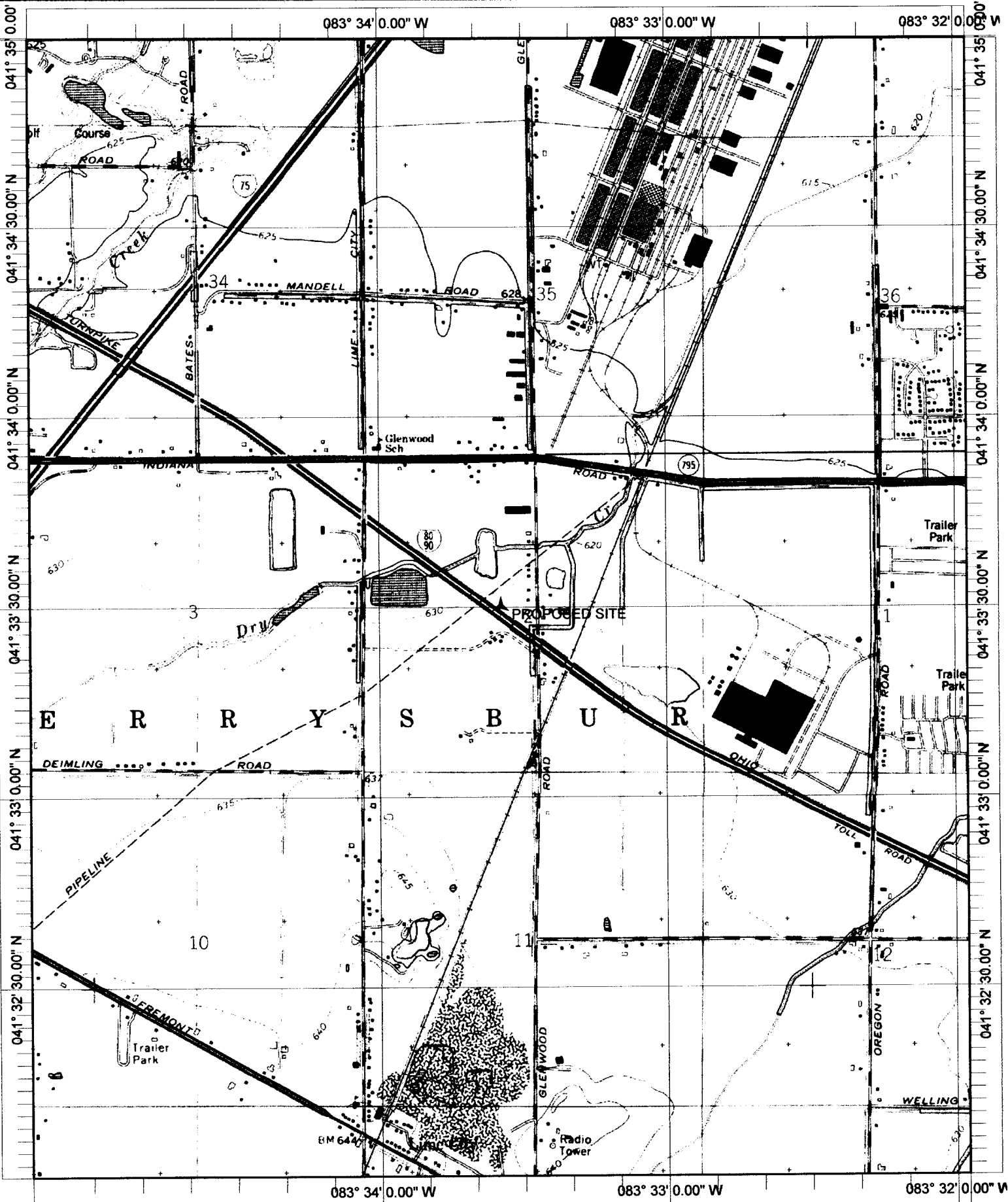

Name: ROSSFORD
Date: 8/19/2003
Scale: 1 inch equals 2000 feet

Location: 041° 33' 30.0" N 083° 33' 35.0" W
Caption: Exhibit 12 - Topo map