

MINOR CHANGE APPLICATION /
ONE STEP UPGRADE
CUMULUS LICENSING LLC
KDVV (FM) RADIO STATION
CH 262C - 100.3 MHZ - 100.0 KW
TOPEKA, KANSAS
September 2010

EXHIBIT A

Clear Allocation Reference Site

This application proposed to upgrade KDVV to Class C at its proposed/existing site at Topeka, Kansas. As the proposed/existing implementation site does not meet §73.207 spacing requirements to all other facilities, a designated allocation reference site has been identified.¹

As denoted on Exhibit A1, from the proposed allocation reference site, Channel 262C meets the Commission's minimum distance separation requirements to all licensed, proposed or applied for facilities with the exception of the present licensed KDVV, Channel 262C0, Topeka, Kansas. From the proposed allocation reference site, a maximum Class C would place a theoretical 70 dBu signal over 100% of the community of Topeka, Kansas, as shown on Exhibit A2. Further, as shown on Exhibit A3, the proposed site is not located offshore or on airport property and is, consequently, suitable for tower construction. Therefore, this proposal meets the Commission's allocation criteria.

1) The shortage from the proposed implementation site is addressed under §73.215 of the rules.

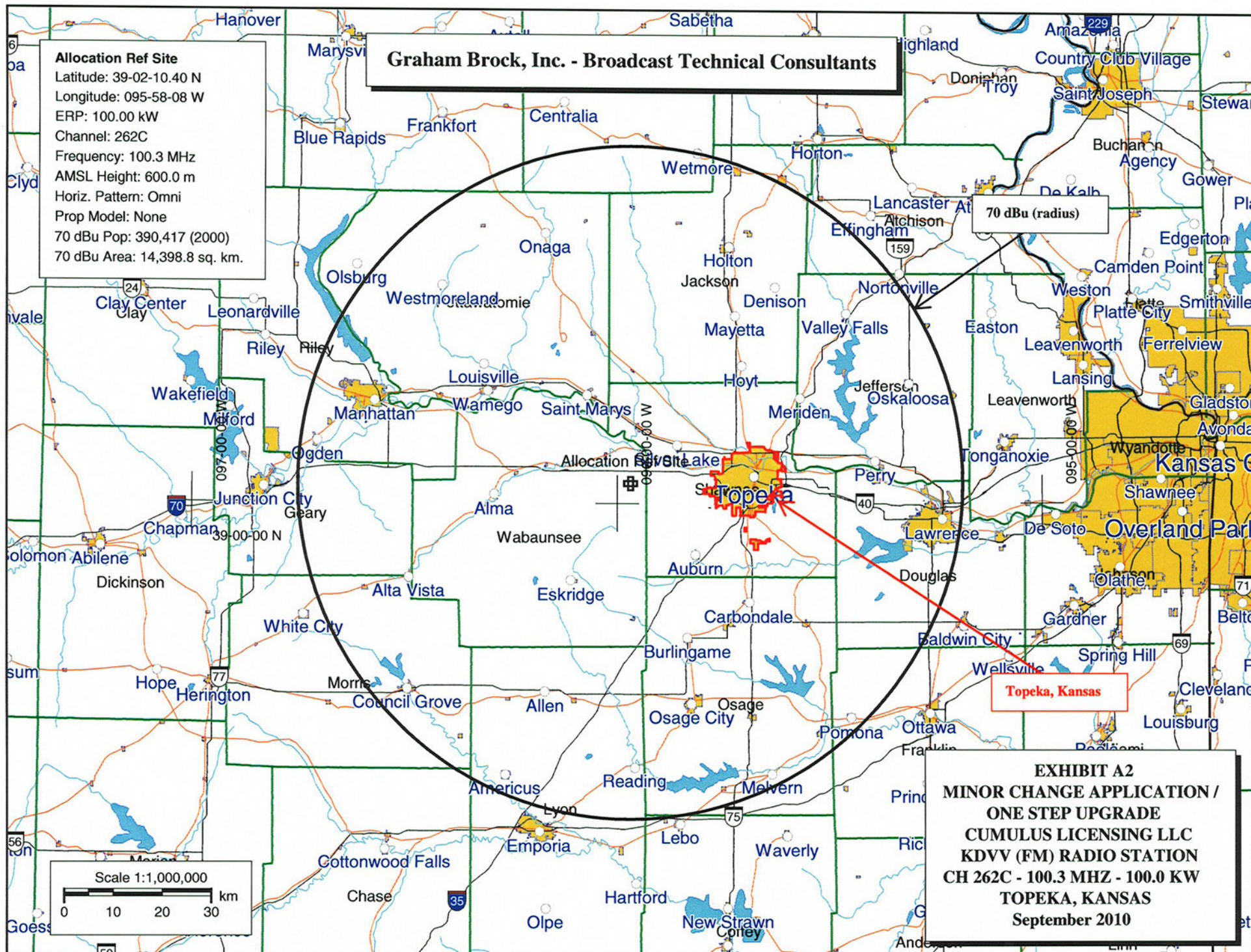

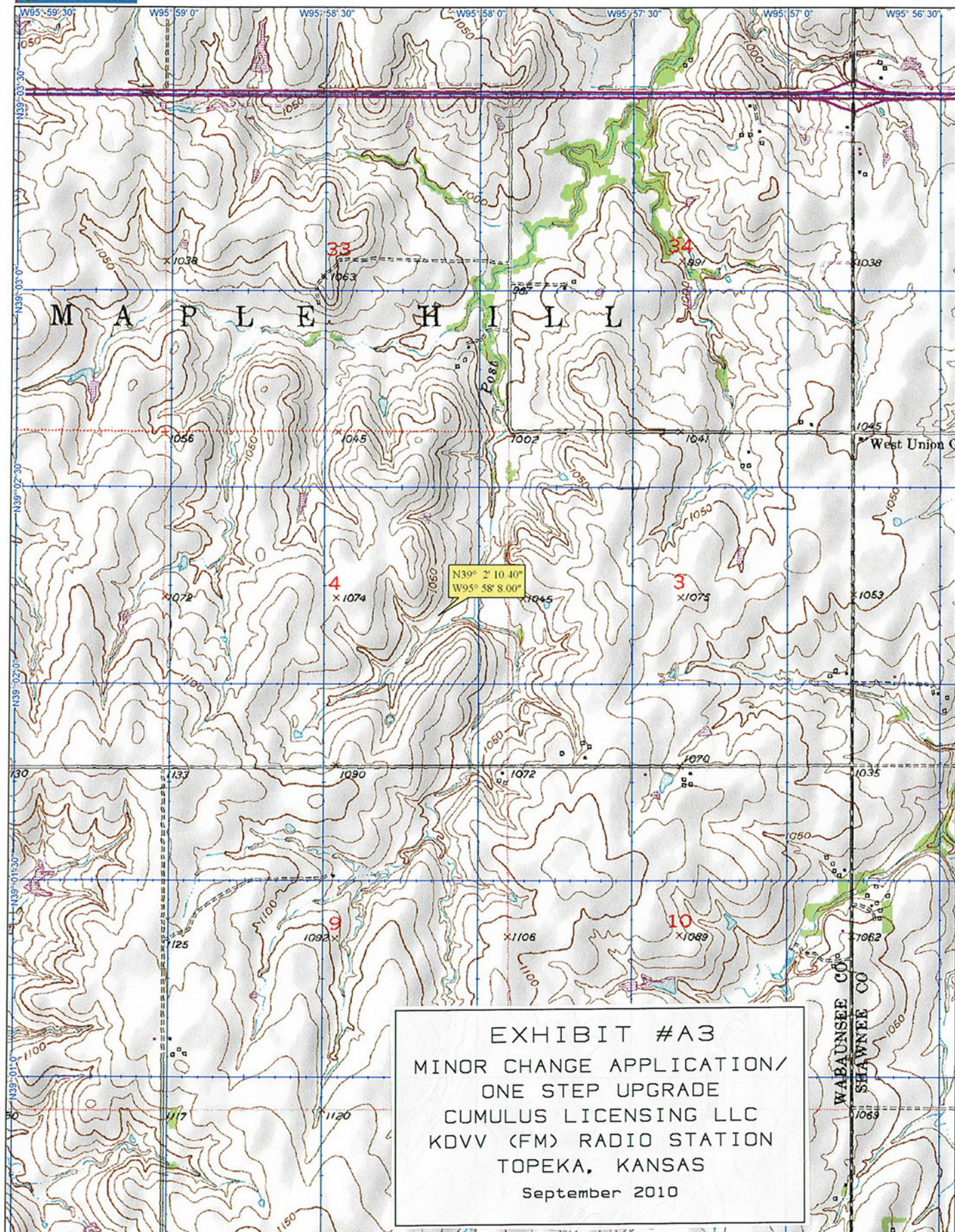

EXHIBIT #A3
MINOR CHANGE APPLICATION/
ONE STEP UPGRADE
CUMULUS LICENSING LLC
KDVV (FM) RADIO STATION
TOPEKA, KANSAS
September 2010