

Exhibit 25 – Statement A  
**NATURE OF THE PROPOSAL**

prepared for

**Citadel Broadcasting Company**

WHOM(FM)(Aux) Mt. Washington, New Hampshire

Facility ID 49687

Ch. 235C 20.5 kW 1149 m

*Citadel Broadcasting Company (“Citadel”)*, licensee of FM radio station WHOM(FM), Mount Washington, NH recently commissioned a site survey of the WHOM transmitter site. *Citadel* now seeks minor corrections to the WHOM auxiliary antenna authorization (file number BXLH-20051107AFN) in order to incorporate the recently acquired survey data in the station license. No physical or operational changes were made to the WHOM facility in this process.

Accurate locations and elevations of the WHOM antenna and tower were determined by Mr. Richard C. Boulanger, a licensed surveyor in the State of New Hampshire. Using the surveyed data (see **Exhibit 25 - Attachment 1**) as a reference, the following corrections are required to the WHOM auxiliary antenna authorization. The current and corrected data<sup>1</sup> is shown below.

<u>Current</u>	<u>Revised</u>	
44° 16' 12"	44° 16' 11"	N. Latitude
71° 18' 16"	71° 18' 16"	W. Longitude
1930 m	1932 m	Antenna C/R AMSL
23 m	24 m	Antenna C/R AGL
1160 m	1149 m	Antenna C/R HAAT
27 m	28 m	Overall Antenna Support Structure

The antenna height above average terrain (“HAAT”) was calculated using the terrain elevations in BMPH-5164, a previous WHOM Application for Construction Permit. These terrain elevations were derived from topographic maps, and therefore take precedence over digitized terrain data.

**Exhibit 25 - Figure 1** demonstrates that the 60 dBμ (1 mV/m) contour of the proposed auxiliary facility does not extend beyond the bounds of the 60 dBμ contour of the main facility, in compliance with §73.1675(a)(1)(ii) of the FCC Rules. Because minimum distance spacing and contour protection rules do not apply to auxiliary facilities, the instant proposal is believed to comply with all pertinent FCC allocations requirements.

<sup>1</sup> Because the surveyed locations are expressed in NAD83, a conversion to NAD27 datum is provided herein. Elevations are shown rounded to the nearest meter, pursuant to §73.212(b).

*Boulanger Consulting*  
*Professional Forestry & Land Surveying*

Certification to location & elevations of the  
Mount Washington Summit Radio Towers  
WPKQ and WHOM Main & Auxillary Towers  
Sargents Purchase, Coos County, New Hampshire

WPKQ TOWER

I certify that the above site is at Latitude 44° 16' 13.578" N, and Longitude 71° 18' 14.895" W, that the Site ground elevation is 6263.9' feet AMSL, that the tower structure top elevation is 6394.7' feet AMSL, that the upper antenna top elevation is 6394.8' feet AMSL and bottom elevation is 6345.2' feet AMSL, that the lower antenna top elevation is 6315.7' feet AMSL and bottom elevation is 6301.5' feet AMSL. These coordinates are accurate within 1' feet horizontally; and the elevations are accurate to within 1' feet vertically. The horizontal datum (coordinates) are in terms of the North American Datum of 1983 (NAD 83) and are expressed as degrees, minutes and seconds, to the nearest hundredth of a second. The vertical datum (heights) are in terms of the National American Vertical Datum of 88 (NAVD 88) and are determined to the nearest foot.

WHOM AUXILLARY TOWER

I certify that the above site is at Latitude 44° 16' 11.453" N, and Longitude 71° 18' 13.783" W, that the Site ground elevation is 6257.7' feet AMSL, that the tower structure top elevation is 6350.1' feet AMSL, that the antenna top elevation is 6345.1' feet AMSL and bottom elevation is 6330.1' feet AMSL. These coordinates are accurate within 1' feet horizontally; and the elevations are accurate to within 1' feet vertically. The horizontal datum (coordinates) are in terms of the North American Datum of 1983 (NAD 83) and are expressed as degrees, minutes and seconds, to the nearest hundredth of a second. The vertical datum (heights) are in terms of the National American Vertical Datum of 88 (NAVD 88) and are determined to the nearest foot.

WHOM MAIN TOWER

I certify that the above site is at Latitude 44° 16' 10.927" N, and Longitude 71° 18' 12.792" W, that the Site ground elevation is 6264.4' feet AMSL, that the tower structure top elevation is 6337.6' feet AMSL, that the antenna top elevation is 6339.2' feet AMSL and bottom elevation is 6295.4' feet AMSL. These coordinates are accurate within 1' feet horizontally; and the elevations are accurate to within 1' feet vertically. The horizontal datum (coordinates) are in terms of the North American Datum of 1983 (NAD 83) and are expressed as degrees, minutes and seconds, to the nearest hundredth of a second. The vertical datum (heights) are in terms of the National American Vertical Datum of 88 (NAVD 88) and are determined to the nearest foot.

Signature & Date

8/31/06

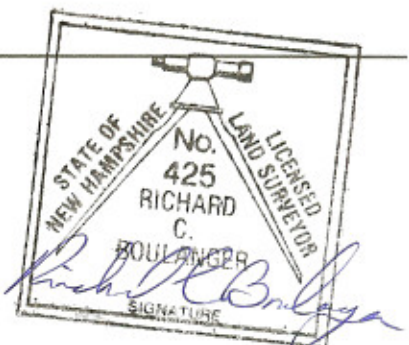

# EXHIBIT 25 - FIGURE 1 WHOM(FM)(AUX) COVERAGE CONTOURS

prepared October 2006 for  
**Citadel Broadcasting Company**  
 Mount Washington, New Hampshire  
 Ch. 235C 20.5 kW 1149 m

Cavell, Mertz & Davis, Inc.  
 Manassas, Virginia

