

Standard Horizontal Pattern

Theoretical Pattern RMS = 351.87

Standard Pattern RMS = 369.69

RSS = 457.5976

Q = 12.247

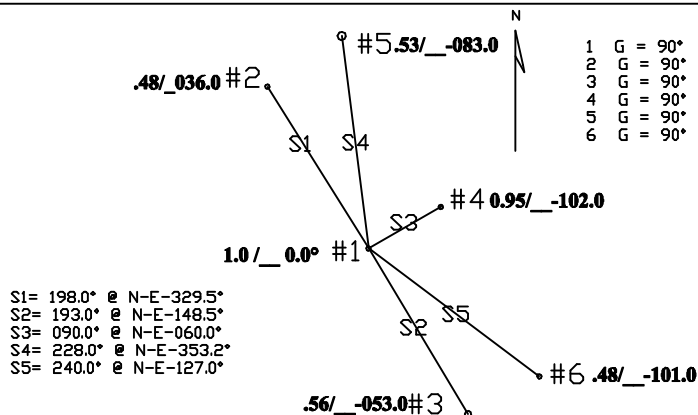

Exhibit EE-4A

Proposed Standard
Nighttime

Horizontal Pattern
Proposed NEW

Sweetwater, Florida

880 KHz DA-2-U 4/1.5 kW

N.Lat 25°42'25"

W.Lon 80°29'35"

(NAD 1927)

