

Exhibit12  
Portales, NM

|             |   |                 |
|-------------|---|-----------------|
| REFERENCE   | CH# 217D - 91.3 MHz, Pwr= 0.045 kW, HAAT=87.8 M, COR= 1284 M    | DISPLAY DATES   |
| 34 11 52 N  | Average Protected F(50-50)= 7.87 km                             | DATA 06-16-04   |
| 103 19 24 W | Ave. F(50-10) 40 dBu= 26.3 54 dBu= 11.2 80 dBu= 2.4 100 dBu= .5 | SEARCH 06-30-04 |

| CH<br>CITY          | CALL   | TYPE<br>STATE | AZI.<br><--    | DIST<br>FILE #            | LAT.<br>LNG.          | Pwr (kW)<br>HAAT (M) | COR (M)<br>INT (km) | PRO (km)<br>LICENSEE                          | *IN*<br>(Overlap in km) | *OUT*  |
|---------------------|--------|---------------|----------------|---------------------------|-----------------------|----------------------|---------------------|---|-------------------------|--------|
| 216A<br>Clovis      | KAQF   | LIC C<br>NM   | 25.9<br>205.9  | 25.14<br>BLED19981112KG   | 34 24 05<br>103 12 12 | 1.350<br>76          | 1347<br>25.5        | 17.3<br>American Family Associatio            | -5.11                   | 1.14   |
| 214D<br>Portales    | K214DH | LIC C<br>NM   | 217.9<br>37.9  | 1.99<br>BLFT19990716UA    | 34 11 01<br>103 20 12 | 0.099<br>-6          | 1237<br>0.7         | 5.6<br>Educational Media Foundati             | -3.97*                  | -4.10* |
| 220D<br>Portales    | K220FT | LIC C<br>NM   | 97.7<br>277.7  | 4.13<br>BLFT20020514AAU   | 34 11 34<br>103 16 44 | 0.180<br>24          | 1259<br>0.9         | 6.5<br>Calvary Chapel Of Twin Fal             | -3.70*                  | -2.86* |
| 217C1<br>Lovington  | 990317 | APP CX<br>NM  | 200.0<br>20.0  | 134.81<br>BPED19990317MB  | 33 03 20<br>103 49 12 | 6.000<br>442         | 1779<br>130.1       | 53.7<br>Your Christian Companion,             | -0.65                   | 63.50  |
| 214C3<br>Cannon Afb | KKCJ.C | CP CX<br>NM   | 336.3<br>156.3 | 52.99<br>BNPED20000118AAJ | 34 38 04<br>103 33 25 | 10.000<br>121        | 1512<br>3.4         | 34.8<br>Csn International                     | 44.97                   | 17.72  |
| 219D<br>Clovis      | K219DR | LIC DC<br>NM  | 24.3<br>204.3  | 21.19<br>BLFT20000828AOC  | 34 22 18<br>103 13 41 | 0.004<br>188         | 1447<br>0.1         | 6.2<br>Paulino Bernal Evangelism              | 16.43                   | 14.47  |
| 217D<br>Quay        | K217BY | LIC DHN<br>NM | 332.6<br>152.6 | 79.38<br>BLFT19940906TB   | 34 49 54<br>103 43 28 | 0.002<br>103         | 1549<br>12.3        | 3.9<br>Eastern New Mexico Univers             | 62.46                   | 60.90  |
| 216A<br>Morton      | AP216  | APP CX<br>TX  | 135.8<br>315.8 | 72.70<br>BNPED20000127AAL | 33 43 41<br>102 46 29 | 0.250<br>31          | 1198<br>10.3        | 7.2<br>American Family Associatio             | 54.45                   | 54.25  |
| 216D<br>Morton      | K216DO | LIC CN<br>TX  | 135.8<br>315.8 | 72.70<br>BLFT19980316TH   | 33 43 41<br>102 46 29 | 0.250<br>31          | 1198<br>10.3        | 7.2<br>La Promesa Foundation                  | 54.45                   | 54.25  |
| 06-2C<br>Carlsbad   | KOCT   | LI HN<br>NM   | 208.0<br>28.0  | 176.03<br>BLCT2553        | 32 47 39<br>104 12 27 | 100.000<br>340       | 1437                | 106.6<br>To Grd B= Koat Hearst-argyle Televis |                         | 69.47  |

ERP and HAAT are on direct line to and from reference station.  
 "\*\*Affixed to 'IN' or 'Out' values = site inside protected contour.

## Exhibit 12 (Compliance with CFR 74.1204)

---

The proposed FM Translator is located within the protected 60 dBu contour of third adjacent channel station K220FT, channel 220D, Portales, NM. The predicted F(50-50) field strength of K220FT at the proposed translator site is 67.4 dBu, see Exhibit 12A. Therefore, the respective predicted interfering contour generated by the proposed FM Translator is 107.4 dBu. This interfering contour extends less than 210 meters from the proposed transmit antenna, and the area of overlap is unpopulated.

Two factors have been investigated to determine this absence of population:

- 1) Computer software which uses the centroid method of determining population centers, based on the 2000 census data, has determined that there are no persons within the area of overlap.
- 2) Examination of the USGS topographic map reveals no regularly occupied structures within the area of overlap.
- 3) Confirmation email from land lord stating closest home is 700 feet. See attachment.

Therefore, EMF respectfully requests a waiver of C.F.R. 74.1204 based on no population within the area of predicted interference.



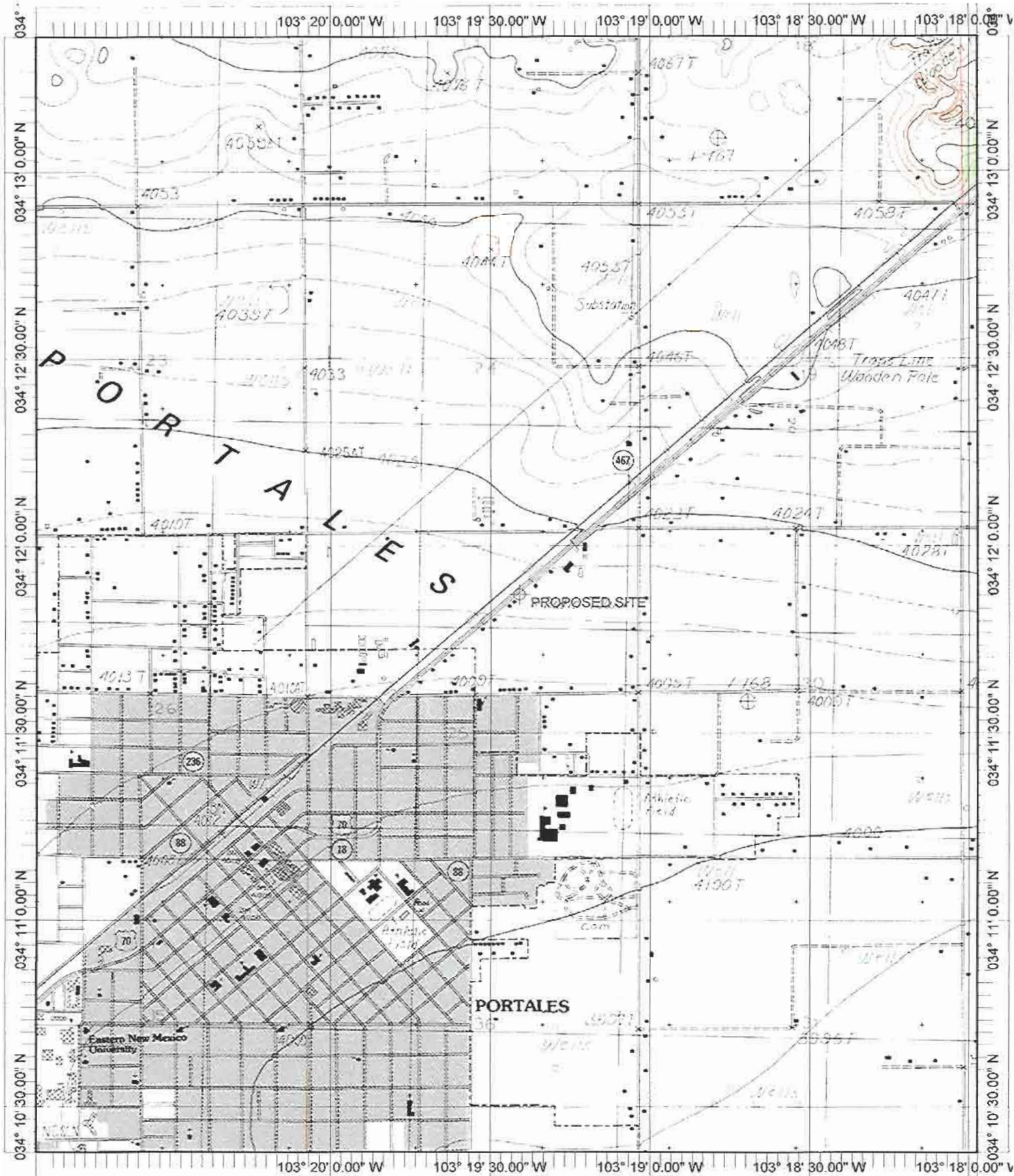

Name: PORTALES  
 Date: 6/30/2004  
 Scale: 1 inch equals 2000 feet

Location: 034° 11' 52.1" N 103° 19' 26.8" W  
 Caption: Exhibit 12  
 Site at 34-11-52 / 103-19-24

## Jeff Wall

**From:** Steve Rooney [steve.rmb@yucca.net]  
**Sent:** Wednesday, June 30, 2004 9:46 AM  
**To:** Jeff Wall  
**Subject:** Re: colo

Yeah....I'd say maybe 700-800 feet away.

Steve Rooney  
KSEL AM/FM, KSMX FM, KRMQ-FM  
Clovis/Portales, NM.  
Rooney Moon Broadcasting... Quality radio that works!  
(505)763-0338 / (505)359-1759

Confidentiality Notice: This e-mail message, including any attachments, is for the sole use of the intended recipient(s) and may contain confidential and privileged information. Any unauthorized review, use, disclosure or distribution is prohibited. If you are not the intended recipient, please contact the sender by reply e-mail and destroy all copies of original message

----- Original Message -----

**From:** Jeff Wall  
**To:** steve.rmb@yucca.net  
**Sent:** Wednesday, June 30, 2004 10:20 AM  
**Subject:** colo

Hey Steve, great talking with you yesterday. About your site, are there any homes within 1000 feet of the tower, thanks, jw

Jeff Wall  
Signal Expansion

5700 West Oaks Bl  
Rocklin, CA 95765

Phone 916-251-2230  
Fax 916-251-2231

[www.klove.com](http://www.klove.com)  
[www.air1.com](http://www.air1.com)  
[www.christianmusicplanet.com](http://www.christianmusicplanet.com)

6/30/2004