

Radio 74 Internationale
1209 W. Robert Ave.
Ridgecrest, CA 93555

I was asked by the WQQA (FM) construction engineer, Ron Myers, to mark a line on the ground at the base of a tower along an axis of 100° and 280° true to be used for the orientation of an FM broadcasting antenna to be pointed at 10° true. I confirm that I created this line which is accurate to within 1° .

Here is a copy of my field notes that I performed on Sunday, November 11, 2012.

I calibrated or orientated my GPS unit to the West $\frac{1}{4}$ Corner and the Northwest Corner of Section 8 of T24N, R25E in the Town of Pierce in Kewaunee County Wisconsin. That line having a published bearing of $N01^\circ21'15''W$ or and azimuth of $358^\circ38'45''$.

From that line I then set a base point for your use $\sim 5'$ North of the base of the wind mill. Then calculated a bearing at 10° greater than Due East which turned out to be $S80^\circ00'00''E$ or an azimuth of 100° . I then extended that line in an Easterly and Westerly direction $25'$ as a baseline to follow. I placed hubs with flags at the $25'$ interval and painted a dashed line at $\sim 2'$ spacing on the ground.

The Horizontal Datum is based on the Wisconsin State Plane Coordinate System Grid, Central Zone. All bearings are referred to grid north.

Sincerely,

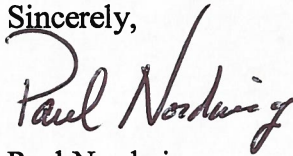

Paul Nordwig
Wisconsin Registered Land Surveyor

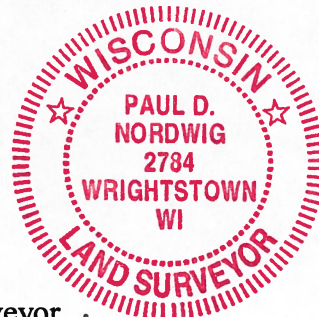

Nov. 11, 2012