

Non-Ionizing Radiation Survey Engineering Statement

The following engineering statement and attached exhibits have been prepared for Infinity Broadcasting East Inc., licensee of FM stations WXRT-FM and WBBM-FM at Chicago, Illinois, Infinity Holdings Corporation of Orlando, licensee of FM station WCKG(FM) at Elmwood Park, Illinois, Infinity Broadcasting Corp. of Illinois, licensee of WJMK(FM) at Chicago, Illinois, and Infinity Broadcasting Corporation of Chicago, licensee of WUSN(FM) at Chicago, Illinois, and contain a non-ionizing radiation survey of the Belmont site rooftop in Chicago.

All data contained in this report was acquired through the use of a Narda 8718 electromagnetic radiation survey system with the appropriate probes. A complete survey of the rooftop of the Belmont site was performed with all of the FM transmitters at the site operational at full power. This survey of the rooftop was performed in both the E-field and H-field. The levels of non-ionizing radiation at the rooftop were found to no exceed the applicable safety standards in either component.

Attached to this text is a drawing depicting the rooftop of the facility with the measured E-field radiation levels indicated in their approximate measurement locations. The values indicated are in terms of a percentage of the controlled

environment limits of the IEEE C95.1-1991 standard. In order to determine the uncontrolled environment limits, the measured values are to be multiplied by 5.

As this drawing indicates, with all of the FM transmitters fully operational, the measured power density at the rooftop, which is a controlled access area not available to the general public, would be in compliance with both the uncontrolled and controlled environment conditions of the IEEE C95.1-1991 standard. Since the measured radiation levels at the rooftop are within the limits imposed by the safety standards, it is respectfully submitted that the levels of radiation within the building itself and on the sidewalk and other adjacent public areas would not exceed the measured values indicated. It is therefore respectfully submitted that the FM facilities at the site would not constitute an RF exposure hazard to persons at the facility.

The preceding statement and attached exhibits have been prepared by me, or under my direction, and are true and accurate to the best of my belief and knowledge.

4/4/2005
Date

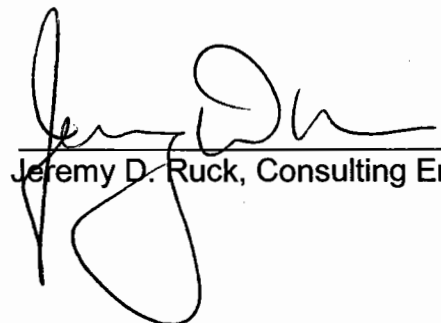

Jeremy D. Ruck, Consulting Engineer

4 1 3 2

1

REVISIONS			
ZONE	REV	DESCRIPTION	DATE
			APPROVED

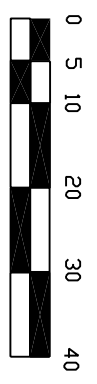

Scale in Feet

Notes:

- Indicated values are depicted at approximate measurement locations.
- Indicated values are E-Field component only.
- Indicated values are in % of IEEE C95.1-1991 Controlled Environment.
- Multiple indicated values by 5 to obtain Uncontrolled Environment Levels.
- Measurements were made with all FM transmitters at site operational.
- Maximum measured value inside tower indicated by large "2.8".
- H-Field values checked. Values are well below IEEE C95.1-1991 limits.
- Building rooftop is a secured area with no public access.

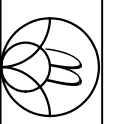
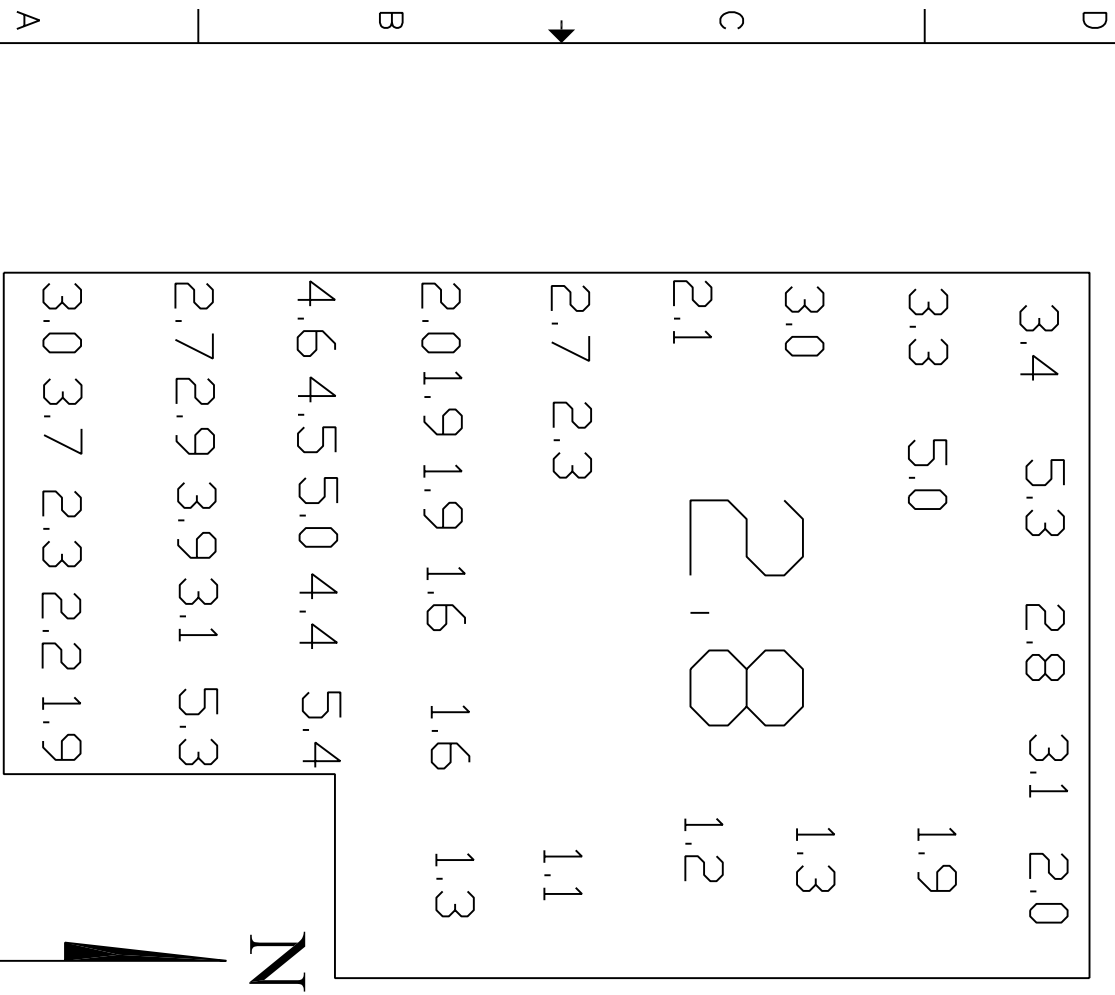

Belmont Site - RFR Survey Infinity Broadcasting			
D.L. Markley & Associates, Inc. Consulting Engineers, 2104 West Moss Ave. Peoria, Illinois 61604			
DRAWN: JDR	SITE	FIELD NO.	DATE
APPROVED: JDR	SCALE	NTS	1 OF 1