

I, Justin D. Drury, hereby state that I am a Professional Land Surveyor P.L.S. # 3843, licensed by the state of Kentucky.

On December 10 2011, 2020 Land Surveying conducted an "as built" field survey of the type 6810 antenna (Freq. MHz; 89.3), in Owingsville Kentucky. Method of survey was, Geodetic control set with Topcon Hiper Lite Plus GPS network rover, and CORS reference station KYTI as base control, to establish geodetic coordinates for the center of the tower and the True North Azimuth of 45 degrees. Reference points were then set along the 45 degree azimuth at an acceptable distance, to sight back to the top of the tower with a Topcon Total Station and confirm the correct orientation of both upper and lower mounted antenna.

Justin D. Drury  
P.L.S. # 3843  
December 12, 2011

A handwritten signature in black ink, appearing to read "Justin D. Drury", with a long, sweeping underline.

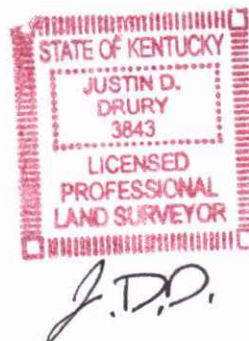

Justin D. Drury  
2020 Land Surveying  
2216 Young Drive Suite 7-B  
Lexington Kentucky 40505