

Exhibit 12											
Enid, OK											
CH# 288D - 105.5 MHz, Pwr= 0.25 kW, HAAT=90.2 M, COR= 443 M											
Average Protected F(50-50)= 12.24 km											
DISPLAY DATES											
DATA 01-04-06											
SEARCH 01-10-06											
Ave. F(50-10) 40 dBu= 42.1 54 dBu= 18.0 80 dBu= 3.9 100 dBu= 1.1											
CH	CALL	TYPE		AZI	DIST	LAT	Pwr(kW)	COR(M)	PRO(km)	*IN*	*OUT*
CITY		STATE		<--	FILE #	LNG.	HAAT(M)	INT(km)	LICENSEE	(Overlap in km)	
288A	KGfy	LIC	CN	107.4	81.33	36 10 31	4.900	404	25.2	-11.48	15.39
Stillwater		OK		287.4	BMLH19980618KA	97 00 51	86	80.9	Stillwater	Broadcasting, L	
291D	K291AV	CP	C	199.1	4.02	36 21 45	0.250	418	7.8	-7.40*	-4.87*
North Enid		OK		19.1	BNPFT20030819AEA	97 53 31	37	1.1	Educational	Media Foundati	
285A	RADD	ADD		280.2	25.63	36 26 13	6.000	501	29.8	13.26	-5.23*
Ringwood		OK		100.2		98 09 31	111	2.9	Charles	Crawford	
290A	AL290	VAC		107.4	33.11	36 18 26	6.000	438	25.8	18.71	6.23
Covington		OK		287.4	RM11168	97 31 31	82	2.5	Charles	Crawford	
289C2	KTTL.C	CP	CN	305.9	74.06	36 47 06	50.000	558	53.2	-13.82	8.73
Alva		OK		125.9	BMPH19870831IE	98 33 01	158	79.3	W.h.a.m.	For Better Broadc	
288A	AL288	VAC		231.5	100.86	35 49 46	6.000	624	26.1	6.19	38.31
Thomas		OK		51.5	RM10538	98 45 09	84	83.9	Robert	Fabian	
286A	KOSB	LIC	CN	111.0	49.16	36 14 15	6.000	436	25.7	34.66	22.30
Perry		OK		291.0	BMLH19900427KA	97 21 59	82	2.5	Team Radio,	L.I.C.	
287A	KINB	LIC	CX	179.8	74.28	35 43 38	0.930	618	29.2	18.88	28.97
Kingfisher		OK		359.8	BLH20030307ABR	97 52 30	271	44.2	Citadel	Broadcasting Compa	
288D	K288CT	LIC	HN	161.0	120.86	35 22 00	0.320	404	7.5	83.52	72.07
Del City		OK		341.0	BLFT19870306TE	97 26 30	30	25.3	Brian	Dodge	
289D	AP289	APP	C	62.4	71.04	36 41 25	0.250	392	13.1	40.22	41.81
Ponca City		OK		242.4	BNPFT20030312AHI	97 10 20	103	19.6	Communi ty	Broadcasting, In	
289A	KROU	LIC	NCN	158.4	96.32	35 35 22	4.000	446	26.8	43.22	51.83
Spencer		OK		338.4	BLED19930708KA	97 29 03	109	41.1	Uni versi ty	Of Okl ahoma	
289A	KROU.A	APP	CX	158.4	96.33	35 35 22	6.000	446	29.4	38.97	49.30
Spencer		OK		338.4	BPED20011210ACR	97 29 02	108	45.3	The Uni versi ty	Of Okl ahoma	
289D	AP289	APP	C	64.6	78.56	36 41 46	0.250	350	10.3	52.94	52.01
Ponca City		OK		244.6	BNPFT20030317HQN	97 04 56	62	14.3	E-string	Wireless, Ltd	
287C0	KFBZ	LIC	C	11.2	158.89	37 48 01	100.000	729	72.3	43.03	71.16
Haysville		KS		191.2	BLH20041007ACP	97 31 29	299	105.0	Entercom	Wichi ta Li cense,	
234C	KHBZFM	LIC	NCY	158.4	95.29	35 35 52	100.000	718	78.6	29.0R	66.3M
Oklahoma City		OK		338.4	BLH20000105AAN	97 29 22	384	94.2	Clear	Channel	Broadcasting
234C	KHBZFM	CP	CX	158.4	95.29	35 35 52	100.000	824	86.1	29.0R	66.3M
Oklahoma City		OK		338.4	BPH20041104ARX	97 29 22	490	105.3	Clear	Channel	Broadcasting
288A	KWCOFM	LIC	CN	181.8	153.87	35 00 38	3.300	481	29.6	57.33	86.38
Chickasha		OK		1.8	BLH19940418KG	97 55 54	151	85.4	Kenny	Communi cations, Inc.	

ERP and HAAT are on direct line to and from reference station.
 "***affixed to 'IN' or 'Out' values = site inside protected contour.

Tower ID: 1236261

Coordinates (NAD27): 36-23-47.98 N, 097-52-37.99 W

Coordinates (NAD83): 36-23-48.10 N, 097-52-39.20 W

Status: Constructed

Structure Type: BPOLE

Action Date: 09/24/2005

Construction Date: 01/01/1990

Location: 114 E. Broadway, Enid, OK

Height (AG): 91.40 m, Elevation: 380.70 m, Structure Height: 91.40 m

Circular Number: N/A

FAA Number: 88-ASW-1946-OE FAA Chapter: 1, 3, 11, 21

Owner: The Broadway Tower

Address:

114 E. Broadway

Enid, OK 73701

Phone: (580) 237-1373

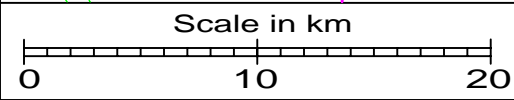
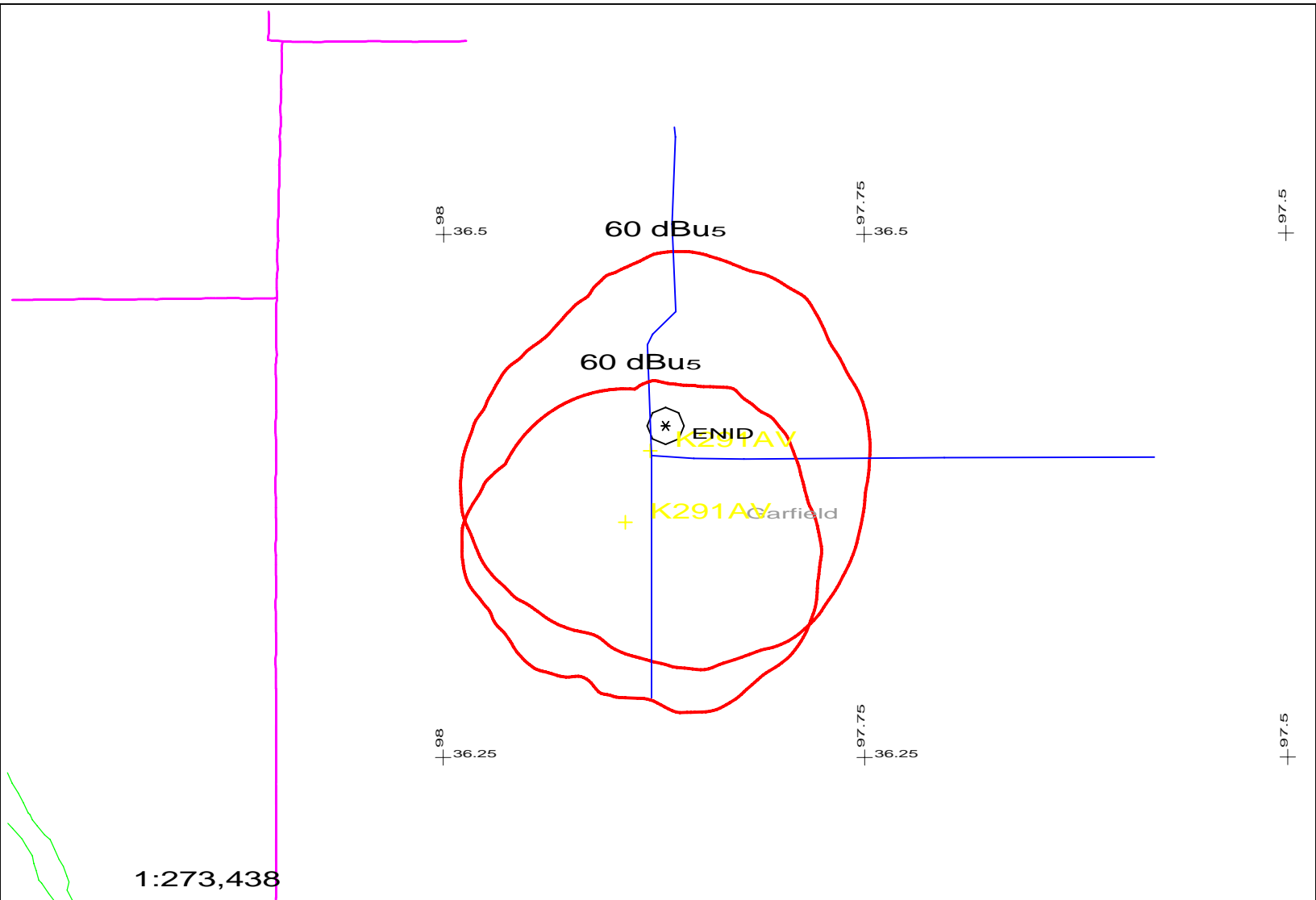

K291AV 291D .25kW 442M AMSL
N. Lat. 36 23 48 W. Lng. 97 52 38

K291AV
EMF - 12/05