

Educational Media Foundation

5700 West Oaks Boulevard ♦ Rocklin ♦ California ♦ 95765

Exhibit 15

Laytonville, CA

Allocation Study

REFERENCE		CH# 220B1- 91.9 MHz, Pwr= 0.1 kW, HAAT=723.1M, COR= 1309 M								DISPLAY DATES	
39 41 38 N		Average Protected F(50-50)= 28.3 km								DATA	03-25-04
123 34 43 W		Ave. F(50-10) 40 dBu= 86.0 54 dBu= 44.1 80 dBu= 6.2 100 dBu= .7								SEARCH	03-25-04
CH CITY	CALL	TYPE STATE	AZI. <--	DIST FILE #	LAT. LNG.	Pwr(kW) HAAT (M)	COR(M) INT (km)	PRO(km) LICENSEE	*IN* (Overlap in km)	*OUT*	
220B1 Laytonville	KHKL.C	CP CX CA	0.0 180.0	0.00 BPED20031223AAZ	39 41 38 123 34 43	0.11 733	1292 84.9	27.8 Educational Media Foundati	-115.52	-114.08*	
220B1 Laytonville	KHKL	LIC CX CA	60.9 240.9	0.19 BLED20021002ABG	39 41 41 123 34 36	0.125 798	1256 86.5	28.6 Educational Media Foundati	-120.54	-117.98*	
220B Santa Rosa	KLVR	LIC ZCN CA	144.1 324.1	140.14 BLED19920806KA	38 40 09 122 37 53	0.83 524	1331 80.4	26.0 Educational Media Foundati	8.50	19.94	
218B Willits	KZYZ.C	CP CX CA	146.9 326.9	48.70 BPED20020322ADI	39 19 35 123 16 10	1.7 527	1021 0.7	25.5 Mendocino County Public Br	20.45	1.63	
218B1 Willits	KZYZ	LIC CN CA	146.9 326.9	48.70 BLED19950901KA	39 19 35 123 16 10	0.6 540	1034 0.7	25.5 Mendocino County Public Br	21.53	10.32	
219B Chico	KCHO	LIC CN CA	78.9 258.9	162.37 BLED19860514KD	39 57 30 121 42 48	7.7 661	1119 40.6	26.1 Univ. Foundation/ca. St. U	37.32	54.58	
222C1 Eureka	KREDFM	LIC CN CA	343.8 163.8	119.53 BLH19910531KB	40 43 37 123 58 25	25 287	855 0.7	23.0 Bicoastal Media Llc	89.88	61.12	
221A Redding	RADD	ADD CA	45.9 225.9	142.17	40 34 35 122 22 12	6 -202	0 42.4	27.2	91.47	83.97	
220A Mccloud	960503	APP CN CA	32.1 212.1	210.65 BPED19960503MG	41 17 30 122 14 21	0.1 377	1500 77.4	24.7 Fatima Response Inc Dba	121.84	113.12	
220A Mccloud	950210	APP CN CA	32.0 212.0	217.66 BPED19950210MA	41 20 43 122 11 42	0.035 1189	2434 77.4	24.7 Southern Oregon State Coll	107.15	112.76	
06-2C Eureka	KVIQ	LI HN CA	343.9 163.9	119.46 BLCT1115	40 43 36 123 58 18	100 343	920 247.2	185.3 Ackerley Media Group, Inc.	To Grd B=	12.68	

***Affixed to 'IN' or 'Out' values = site inside protected contour.
ERP and HAAT are on direct line to and from reference station.

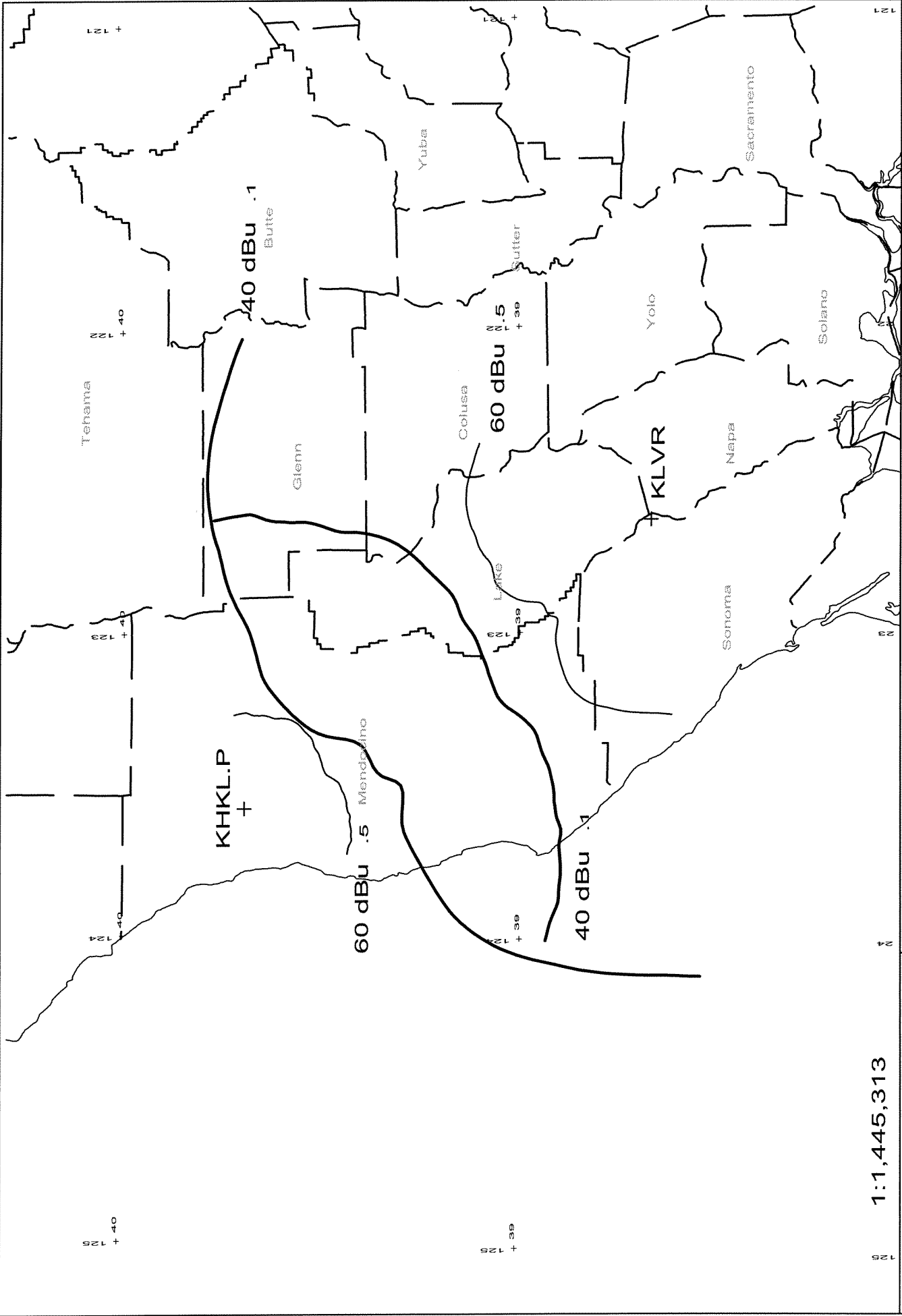

1:1,445,313

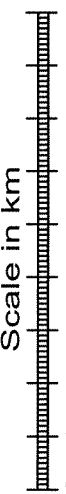

KHKL.P 220B1 .1kW 1309M AMSL
KLVR 220B .83kW 1331M AMSL

Exhibit 15-A
EMF - 03/04

Educational Media Foundation

5700 West Oaks Boulevard ♦ Rocklin ♦ California ♦ 95765

Exhibit 15-A

Laytonville, CA

KLVR vs. KHKL.P

EMF
03-25-2004 30 Sec. Terrain Data

KHKL.P
Channel = 220B1
Max ERP = 0.1 kw
RCAMSL = 1309 M
N. Lat = 394138
W. Lng = 1233443

KLVR BLED19920806KA
Channel = 220B
Max ERP = 0.83 kw
RCAMSL = 1331 M
N. Lat = 38 40 09
W. Lng = 122 37 53

Protected
60 dBu

Interfering
40 dBu

Azimuth (degrees)	ERP (kw)	HAAT (m)	Dist (km)	Azimuth (degrees)	ERP (kw)	HAAT (m)	Dist (km)	Actual (dBu)
110.0	000.1000	0662.7	027.1	331.9	000.8300	0667.4	118.8	38.9
111.0	000.1000	0674.6	027.3	331.8	000.8300	0667.4	118.3	39.1
112.0	000.1000	0686.0	027.6	331.7	000.8300	0667.4	117.8	39.2
113.0	000.1000	0694.9	027.7	331.6	000.8300	0667.4	117.4	39.3
114.0	000.1000	0702.0	027.9	331.4	000.8300	0654.4	116.9	39.3
115.0	000.1000	0708.7	028.0	331.3	000.8300	0654.4	116.5	39.4
116.0	000.1000	0714.9	028.1	331.1	000.8300	0654.4	116.2	39.5
117.0	000.1000	0719.7	028.2	331.0	000.8300	0654.4	115.8	39.6
118.0	000.1000	0723.0	028.3	330.8	000.8300	0654.4	115.5	39.7
119.0	000.1000	0724.9	028.3	330.6	000.8300	0654.4	115.2	39.8
120.0	000.1000	0725.5	028.3	330.4	000.8300	0640.5	114.9	39.7
121.0	000.1000	0724.0	028.3	330.1	000.8300	0640.5	114.7	39.7
122.0	000.1000	0721.2	028.3	329.9	000.8300	0640.5	114.5	39.8
123.0	000.1000	0717.6	028.2	329.7	000.8300	0640.5	114.4	39.8
124.0	000.1000	0713.6	028.1	329.4	000.8300	0624.9	114.2	39.7
125.0	000.1000	0708.5	028.0	329.2	000.8300	0624.9	114.1	39.7
126.0	000.1000	0702.6	027.9	328.9	000.8300	0624.9	114.0	39.7
127.0	000.1000	0696.7	027.8	328.7	000.8300	0624.9	114.0	39.7
128.0	000.1000	0692.0	027.7	328.5	000.8300	0606.7	113.9	39.5
129.0	000.1000	0689.0	027.6	328.2	000.8300	0606.7	113.8	39.5
130.0	000.1000	0686.8	027.6	328.0	000.8300	0606.7	113.7	39.6
131.0	000.1000	0685.2	027.5	327.7	000.8300	0606.7	113.6	39.6
132.0	000.1000	0683.8	027.5	327.5	000.8300	0606.7	113.5	39.6
133.0	000.1000	0681.1	027.5	327.3	000.8300	0587.1	113.4	39.3
134.0	000.1000	0675.6	027.3	327.0	000.8300	0587.1	113.4	39.3
135.0	000.1000	0667.0	027.2	326.8	000.8300	0587.1	113.5	39.3
136.0	000.1000	0655.5	026.9	326.5	000.8300	0587.1	113.6	39.3
137.0	000.1000	0641.9	026.7	326.3	000.8300	0566.4	113.8	38.9
138.0	000.1000	0630.1	026.4	326.0	000.8300	0566.4	114.0	38.8
139.0	000.1000	0622.3	026.3	325.8	000.8300	0566.4	114.1	38.8
140.0	000.1000	0618.6	026.2	325.5	000.8300	0566.4	114.1	38.8

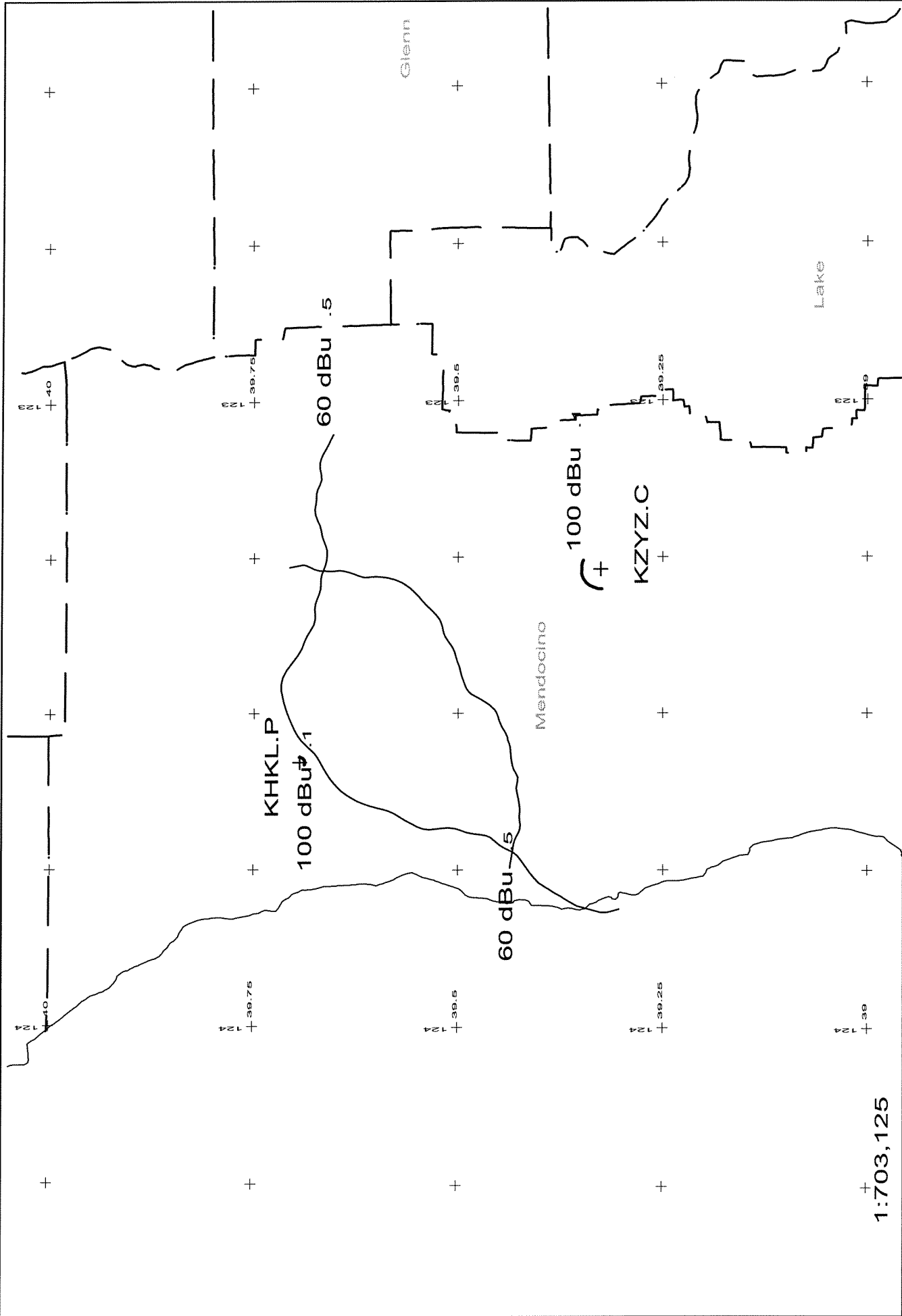

1:703,125

Scale in km

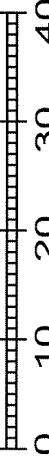

KHKL.P 220B1 .1kW 1309M AMSL
KYZZ.C 218B 1.7kW 1021M AMSL

Exhibit 15-B
EMF - 03/04