

## **Exhibit 12 (Compliance with CFR 74.1204)**

---

The proposed FM Translator is located within the protected 60 dBu contour of second adjacent channel station KCFN.C, channel 216C1, Wichita, KS. The predicted F(50-50) field strength of KCFN.C at the proposed translator site is 78 dBu, see Exhibit 12a. Therefore, the respective predicted interfering contour generated by the proposed FM Translator is greater than 118 dBu. This interfering contour extends less than 88 meters from the proposed transmit antenna, and the area of overlap does not reach the ground.

The proposed FM Translator is located within the protected 60 dBu contour of second adjacent channel station KCFN, channel 216C1, Wichita, KS. The predicted F(50-50) field strength of KCFN at the proposed translator site is 78 dBu, see Exhibit 12b. Therefore, the respective predicted interfering contour generated by the proposed FM Translator is greater than 118 dBu. This interfering contour extends less than 88 meters from the proposed transmit antenna, and the area of overlap does not reach the ground.

Therefore, EMF respectfully requests a waiver of C.F.R. 74.1204 based on no population within the area of predicted interference.

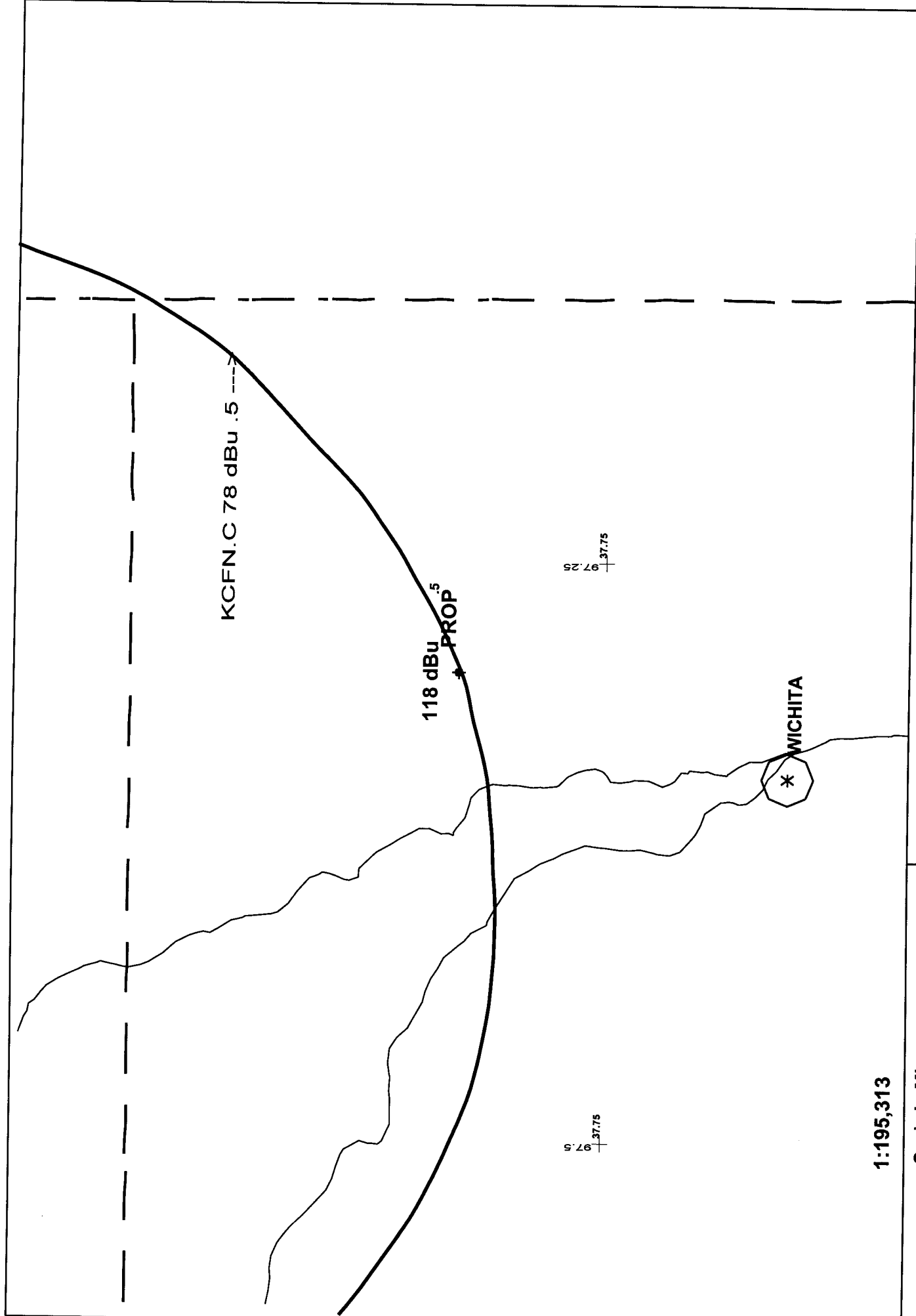

1:195,313

Scale in Mi



PROP 218D .099kW 526M AMSL

N. Lat. 37 48 01 W. Lng. 97 17 50

EXHIBIT 12a

EMF - 10/02

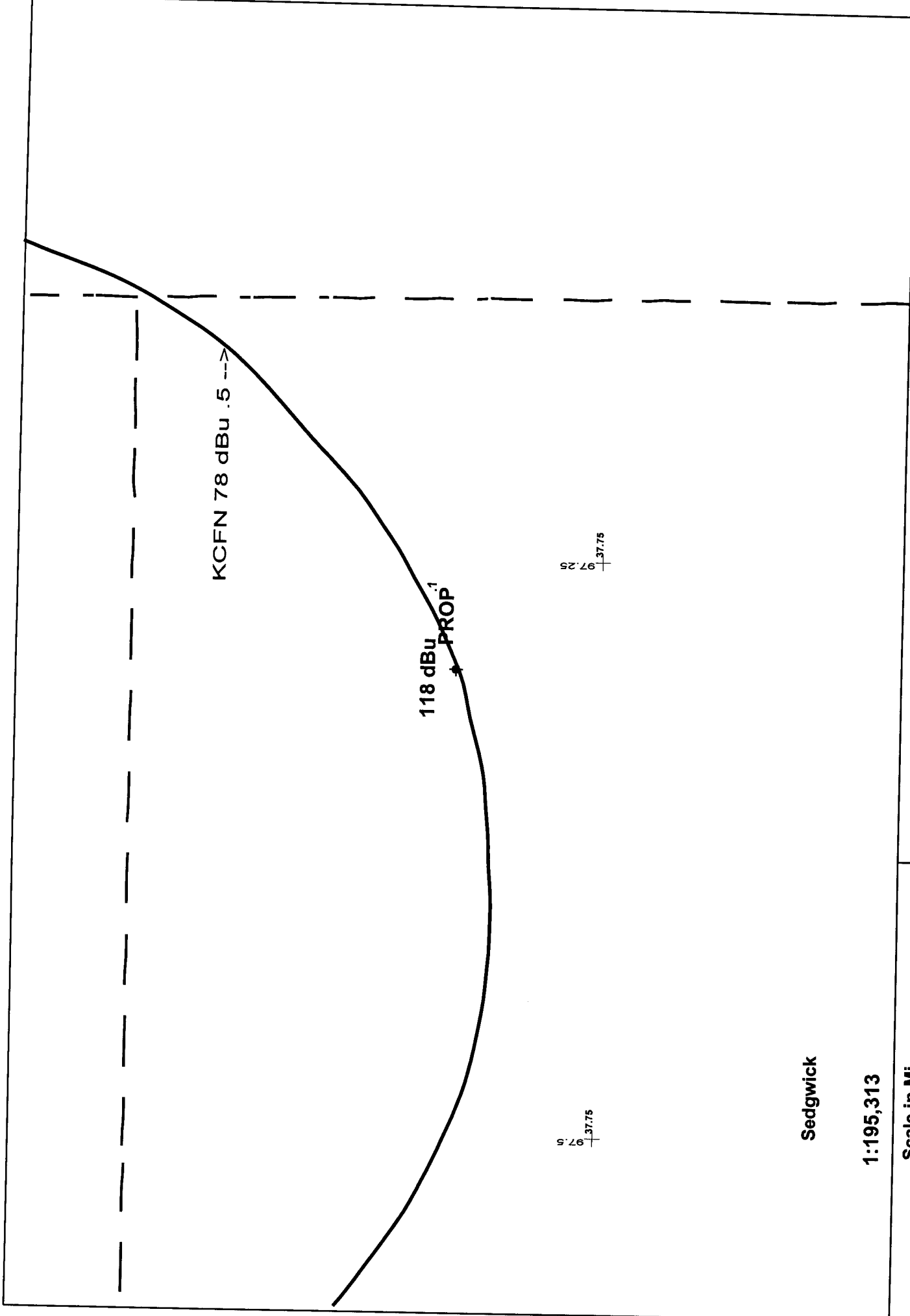

Sedgwick

1:195,313

Scale in Mi



PROP 218D .099kW 526M AMSL  
N. Lat. 37 48 01 W. Lng. 97 17 50

EXHIBIT 12b  
EMF - 11/02