

KESSLER AND GEHMAN ASSOCIATES, INC.

507 NW 60th St. Ste C, Gainesville, FL 32607

Minor Modification of a Licensed Television Broadcast Station

WPBY-TV
Huntington, WV

TECHNICAL STATEMENT OF RYAN WILHOOR OF THE FIRM OF
KESSLER AND GEHMAN ASSOCIATES, INC., CONSULTING ENGINEERS
IN CONNECTION WITH AN APPLICATION FOR MINOR MODIFICATION OF A
TELEVISION BROADCAST STATION WPBY-TV FCC FILE NUMBER BLEDT-
20040211AAL FCC FACILITY IDENTIFICATION NUMBER 71657

ATTACHED FIGURES

In carrying out the engineering studies, the following attached figures were prepared:

- 1) Proposed engineering specifications Exhibit 37.1
- 2) Elevation drawing of the antenna system Exhibit 37.2
- 3) USGS topographic map showing the transmitter site Exhibit 37.3
- 4) Proposed transmitting antenna azimuth and elevation patterns Exhibits 37.4 – 37.8
- 5) OET69 allocation studies Exhibits 37.9
- 6) Map showing the proposed and licensed coverage contours Exhibit 37.10

APPLICATION SUMMARY

Upon approval, the instant application will make the following technical modifications:

- Decrease the effective antenna height by 17.9 meters
- Increase the Maximum ERP from 60.1 KW to 76.3 KW
- Change the antenna from a Dielectric 881-24 to a PSI PSILPD18D88C-34¹

¹ The antenna patterns share identical relative field azimuth values

KESSLER AND GEHMAN ASSOCIATES, INC.

507 NW 60th St. Ste C, Gainesville, FL 32607

Minor Modification of a Licensed Television Broadcast Station

WPBY-TV
Huntington, WV

AREA AND POPULATION ANALYSIS

Exhibit 37.10 was generated by a computer which calculates and plots the distances to the contour. The population served by the proposed noise limited contour was determined by using 2000 census data and a computer program which added the population of all census blocks whose centroids fall within the contour. The total population within the proposed noise limited contour is 781,292 persons or 738,365 persons not affected by terrain losses or incoming interference.

ALLOCATION STUDIES

The applicant accepts full responsibility for the elimination of any objectionable interference including that caused by intermodulation to facilities in existence or authorized prior to the grant of this application. Exhibit 37.9 is a full OET69 allocation analysis which finds the following:

Evaluation toward Class A Stations

No Spacing violations or contour overlap to Class A stations

Evaluation toward Landmobile Stations

No landmobile spacing violations exist.

FCC Monitoring Stations

The proposed station is compliant with regard to FCC Monitoring Stations.

West Virginia quiet zone

The proposed station is compliant with regard to West Virginia quiet zone.

KESSLER AND GEHMAN ASSOCIATES, INC.

507 NW 60th St. Ste C, Gainesville, FL 32607

Minor Modification of a Licensed Television Broadcast Station

WPBY-TV
Huntington, WV

Table Mountain

The proposed station is compliant with regard to Table Mountain.

Canadian coordination distance

Proposed facility is within the Canadian coordination distance. The distance to border is 354.1km

Mexican coordination distance

Proposed facility is beyond the Mexican coordination distance.

AM broadcast stations

The proposed station is compliant with regard to AM broadcast stations.

TV studies

No Spacing violations were found from the proposed facility to the following NTSC facilities:

The following stations were analyzed for potential OET69 interference as demonstrated in Exhibit 37.9:

Chan	Call	City/State	Dist(km)	Status	Application.	Ref. No.
33	WSTR-TV	CINCINNATI OH	215.7	LIC	BLCDT	20091117ACS
34	WSOC-TV	CHARLOTTE NC	382.5	LIC	BLCDT	20040526ANW
34	WCET	CINCINNATI OH	212.8	LIC	BLEDT	20061031AAR
34	WQHS-DT	CLEVELAND OH	323.8	LIC	BLCDT	20031030AGJ
34	WQHS-DT	CLEVELAND OH	323.8	CP	BPCDT	20090629ACU
34	WJAC-TV	JOHNSTOWN PA	346.2	LIC	BLCDT	20051123AKN
34	WJAC-TV	JOHNSTOWN PA	346.2	CP	BPCDT	20080619ADU
34	WTNZ	KNOXVILLE TN	316.9	LIC	BMLCDT	20040706ABG
34	WTNZ	KNOXVILLE TN	316.9	CP	BPCDT	20080619ABZ
35	WOUC-TV	CAMBRIDGE OH	194.1	LIC	BLEDT	20050427AAB
35	WLWT	CINCINNATI OH	212.8	LIC	BLCDT	20050502ABC

KESSLER AND GEHMAN ASSOCIATES, INC.

507 NW 60th St. Ste C, Gainesville, FL 32607

Minor Modification of a Licensed Television Broadcast Station

WPBY-TV
Huntington, WV

The proposed facility is not predicted to cause interference to any of the stations listed above. As indicated in the study, the proposed facility is fully compliant.

CERTIFICATION

The foregoing statement and the report regarding the aforementioned engineering work are true and correct to the best of my knowledge. Executed on December 21, 2011.

KESSLER AND GEHMAN ASSOCIATES, INC.



Ryan Wilhour

Consulting Engineer

ENGINEERING SPECIFICATIONS

	Licensed Parameters	Proposed Parameters		
Transmitter Site				
N. Latitude (NAD 27)	38 ° 29 ' 41.0 "	38 ° 29 ' 41.0 "		
W. Longitude (NAD 27)	82 ° 12 ' 03.0 "	82 ° 12 ' 03.0 "		
FAA Study Number:	2001-AEA-4381-OE	2001-AEA-4381-OE		
ASR Study Number:	1045615	1045615		
Emission Characteristics				
Channel:	34	34		
Frequency:	590 - 596 MHz	590 – 596 MHz		
Antenna and Other Elevations				
Height of Site Above Mean Sea Level (AMSL)	286.6 m	286.6 m		
Overall Height of Structure Above Ground (AGL)	311.0 m	311.0 m		
(including all appurtenances)	323.0 m	323.0 m		
Overall Height of Structure Above Mean Sea Level	597.6 m	597.6 m		
(including all appurtenances)	609.6 m	609.6 m		
Average Terrain	224.8 m	224.8 m		
Effective Height of Antenna Above Ground	316.6 m	298.7 m		
Effective Height of Antenna Above Average Terrain	378.3 m	360.5 m		
Effective Height of Antenna Above Mean Sea Level	603.2 m	585.3 m		
Antenna Parameters				
	H Polarization	V Polarization	H Polarization	V Polarization
Maximum Antenna Gain in Beam Maximum	17.70 dB		16.21 dB	
Maximum Effective Radiated Power	17.8 dBkW	-----	18.83 dBkW	-----
In Beam Maximum	60.1 kW	-----	76.3 kW	-----
Antenna Make / Model	Dielectric / 881-24		PSI / PSILPD18D88C-34	

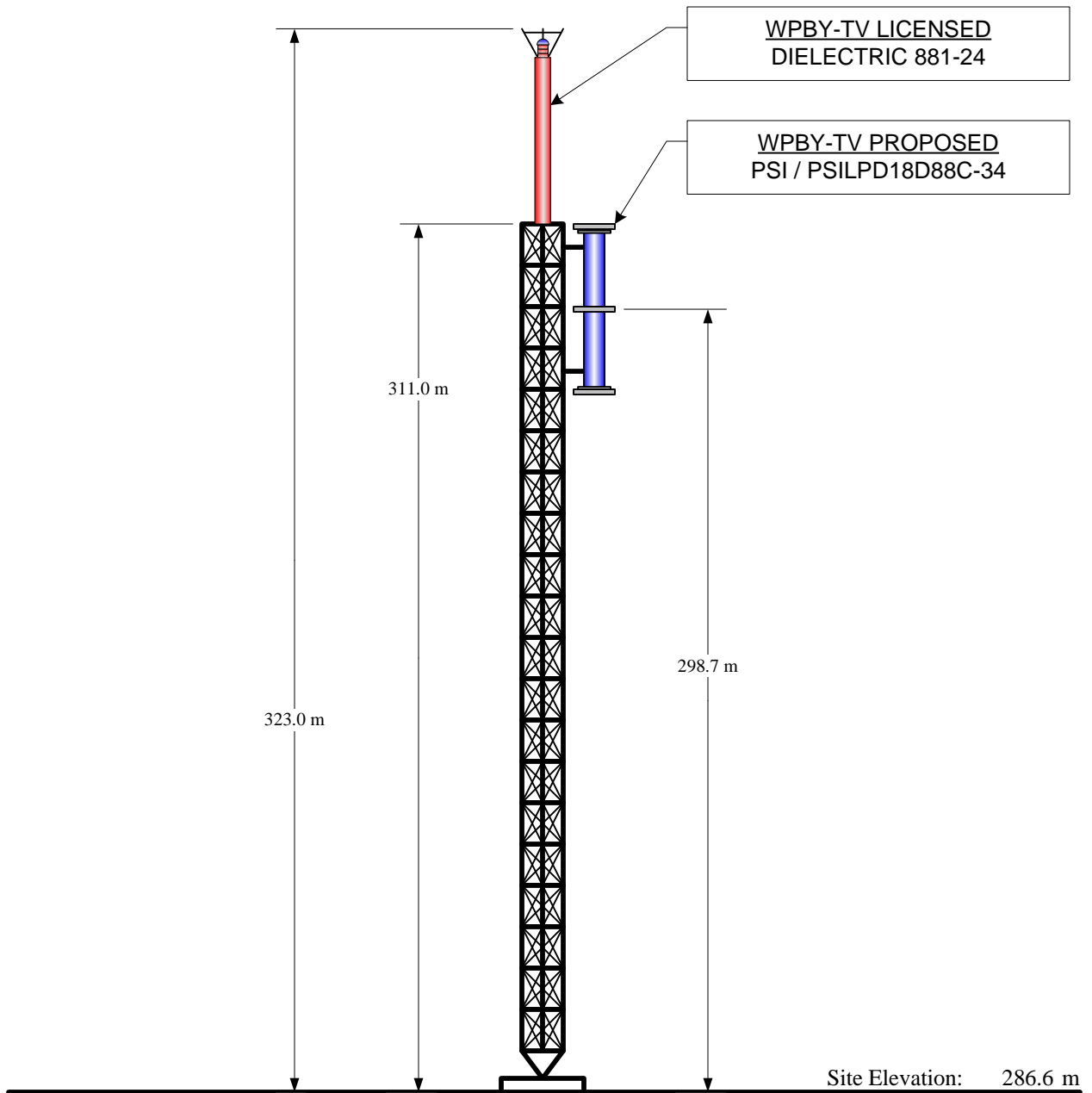

Overall Height AGL:	323.0 m
Overall Height AMSL:	609.6 m
Radiation Center AGL:	298.7 m
Radiation Center AMSL:	585.3 m
Radiation Center HAAT:	360.5 m
Average Terrain:	224.8 m

NAD 27 Coordinates:	
N. Latitude:	38° 29' 41"
W. Longitude:	82° 12' 03"

FCC Tower Registration Number:	1045615
FAA Aeronautical Study Number:	01-AEA-4391-OE

NOTE: NOT TO SCALE

KESSLER & GEHMAN
 TELECOMMUNICATIONS CONSULTING ENGINEERS
 507 N.W. 60th Street, Suite C
 Gainesville, Florida 32607

WPBY-TV
 HUNTINGTON, WV

20111221

EXHIBIT 37.2

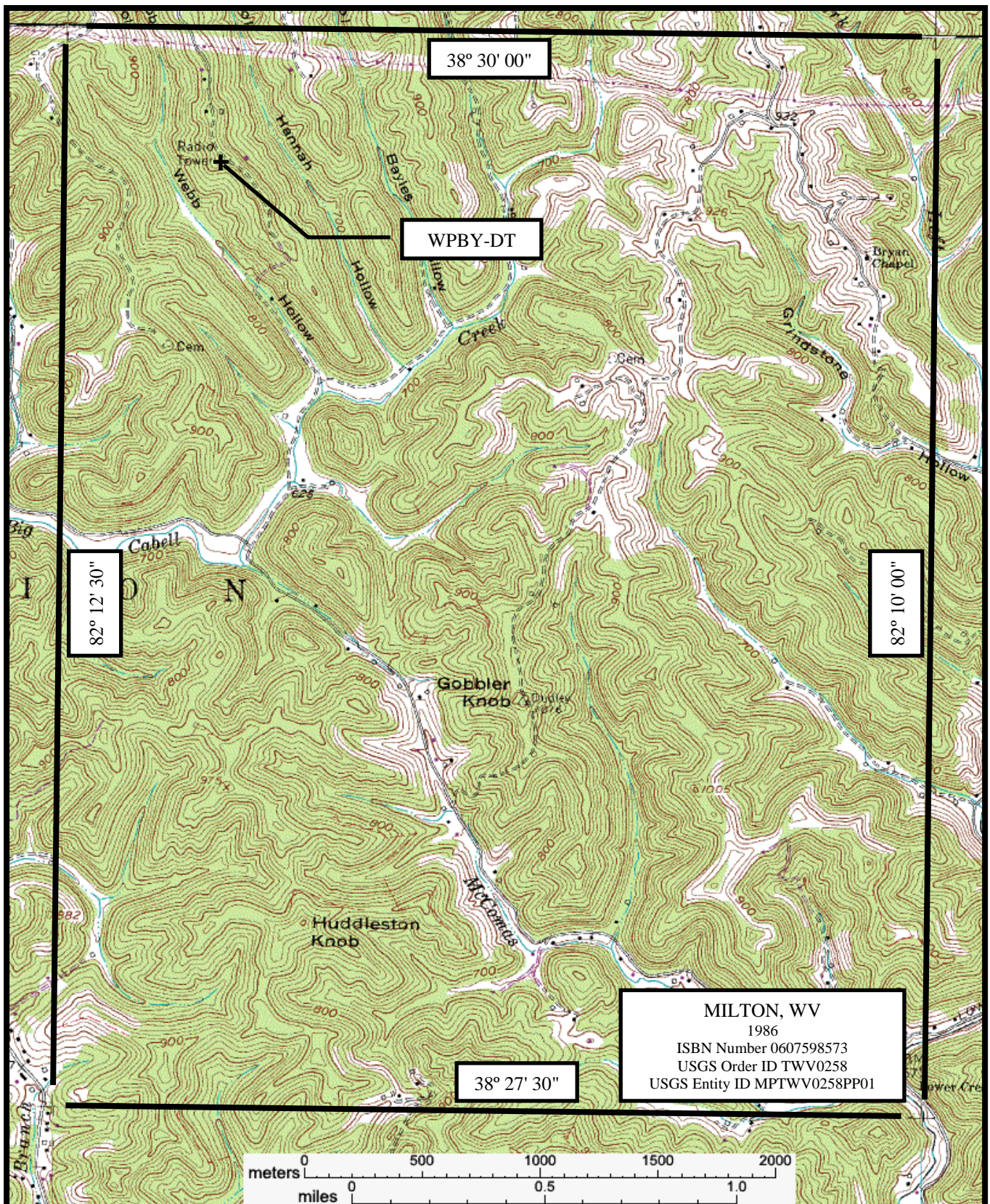

KESSLER & GEHMAN
TELECOMMUNICATIONS CONSULTING ENGINEERS
507 N.W. 60th Street, Suite C
Gainesville, Florida 32607

WPBY-TV
HUNTINGTON, WV
20111221
EXHIBIT 37.3

WPBY-TV

HUNTINGTON, WEST VIRGINIA

TABULATION OF RELATIVE FIELD FOR PROPOSED DIRECTIONAL ANTENNA

<u>AZIMUTH</u>	<u>RELATIVE FIELD</u>	<u>AZIMUTH</u>	<u>RELATIVE FIELD</u>
N000°E	0.254	N180°E	0.970
N010°E	0.200	N190°E	0.931
N020°E	0.229	N200°E	0.879
N030°E	0.328	N210°E	0.816
N040°E	0.433	N220°E	0.751
N050°E	0.515	N230°E	0.691
N060°E	0.571	N240°E	0.645
N070°E	0.609	N250°E	0.609
N080°E	0.645	N260°E	0.571
N090°E	0.691	N270°E	0.515
N100°E	0.751	N280°E	0.433
N110°E	0.816	N290°E	0.328
N120°E	0.879	N300°E	0.229
N130°E	0.931	N310°E	0.200
N140°E	0.970	N320°E	0.254
N150°E	0.992	N330°E	0.317
N160°E	1.000	N340°E	0.341
N170°E	0.992	N350°E	0.317

MAXIMUM OF 1.000 AT N160°E
MINIMUM OF 0.200 AT N10°E AND N310°E

RELATIVE FIELD AZIMUTH PATTERN

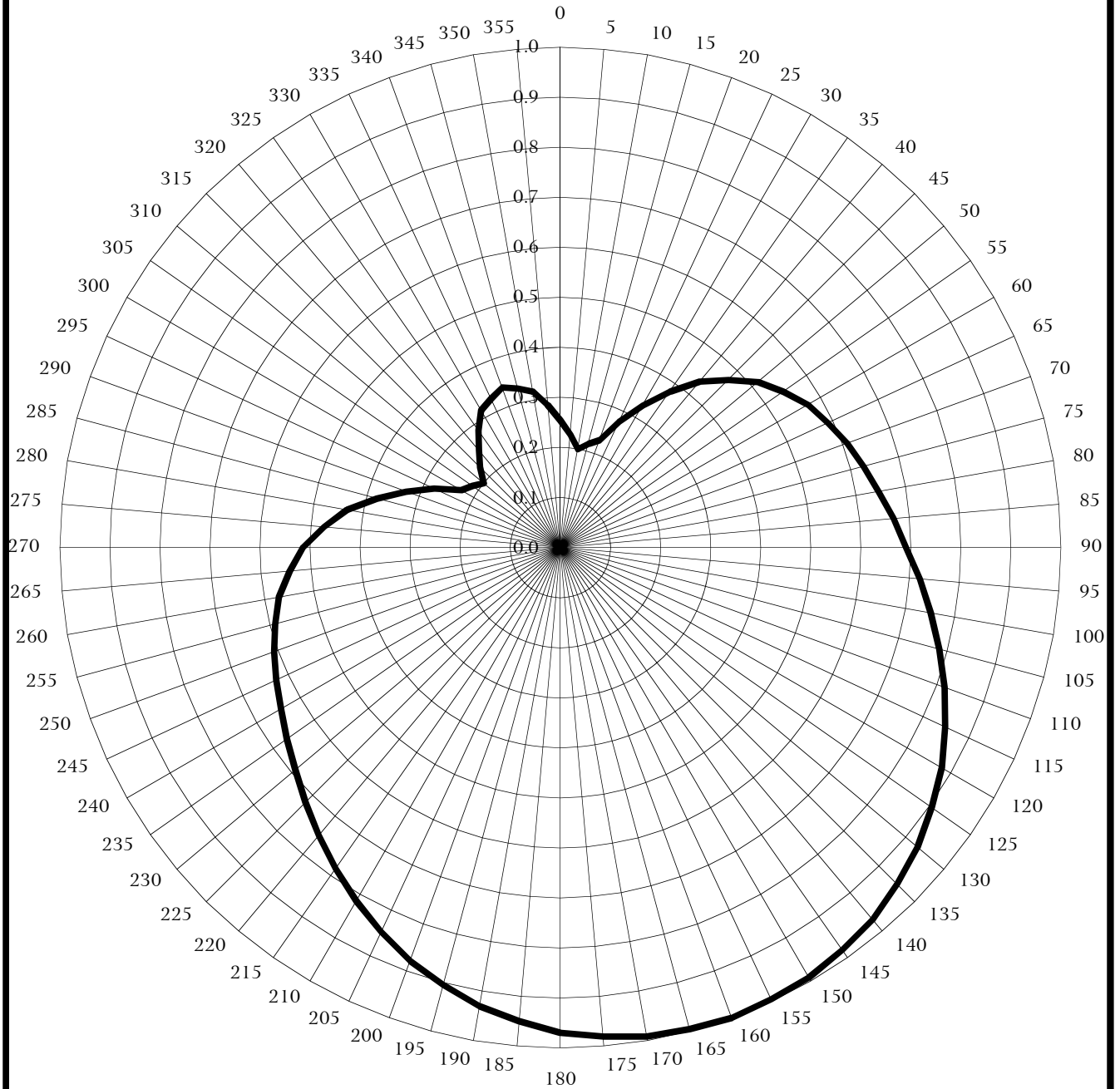

PSI - PSILPD18D88C-34 DIRECTIONAL ANTENNA
ORIENTED WITH BEAM MAXIMA AT 160 DEGREES
MAXIMUM AZIMUTH GAIN: 2.32 (3.65 DB)

KESSLER & GEHMAN
TELECOMMUNICATIONS CONSULTING ENGINEERS
507 N.W. 60th Street, Suite C
Gainesville, Florida 32607

WPBY-TV
HUNTINGTON, WV

20111221

EXHIBIT 37.5

ERP - dBk

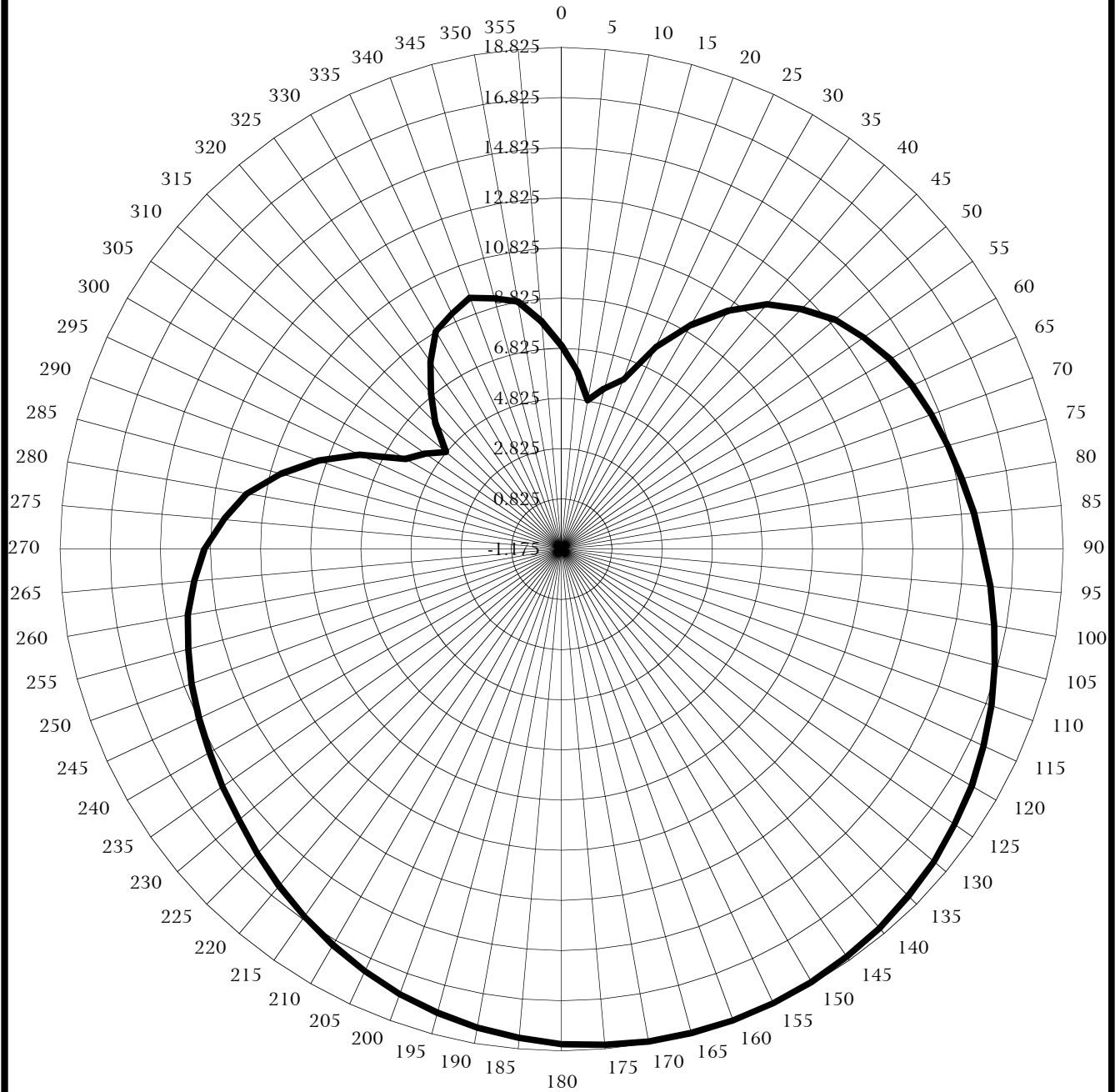

PSI - PSILPD18D88C-34 DIRECTIONAL ANTENNA
 ORIENTED WITH BEAM MAXIMA AT 160 DEGREES
 MAXIMUM AZIMUTH GAIN: 2.32 (3.65 DB)

KESSLER & GEHMAN
 TELECOMMUNICATIONS CONSULTING ENGINEERS
 507 N.W. 60th Street, Suite C
 Gainesville, Florida 32607

WPBY-TV
 HUNTINGTON, WV

20111221

EXHIBIT 37.6

ELEVATION PATTERN

PSI - PSILPD18D88C-34

RMS Gain at Main Lobe 18.0 (12.55 dB)
RMS Gain at Horizontal 11.73 (10.69 dB)

Beam Tilt 1.2 deg down
Frequency 590-596 MHz

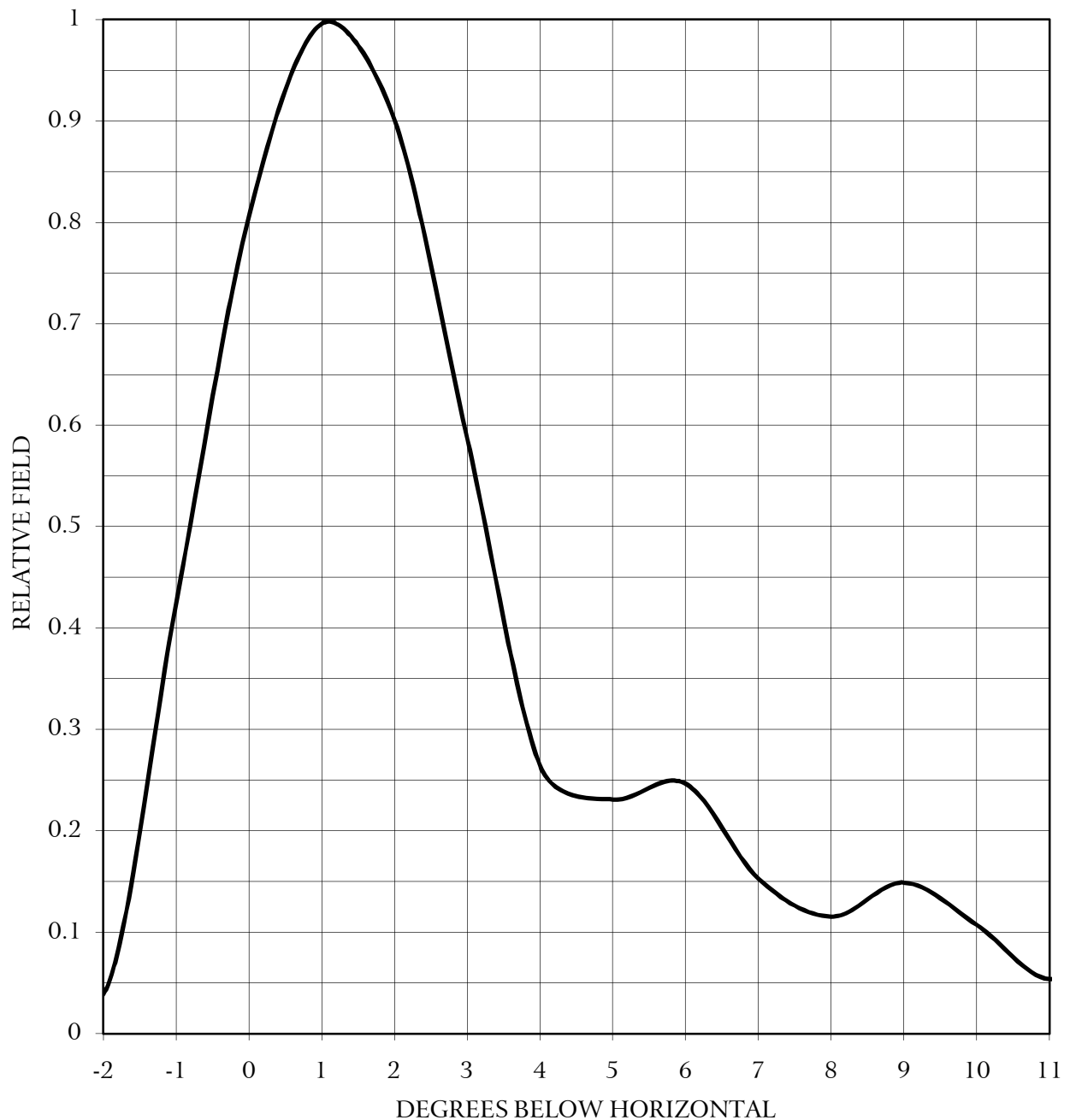

KESSLER & GEHMAN
TELECOMMUNICATIONS CONSULTING ENGINEERS
507 N.W. 60th Street, Suite C
Gainesville, Florida 32607

WPBY-TV
HUNTINGTON, WV

20111221

EXHIBIT 37.7

ELEVATION PATTERN

PSI - PSILPD18D88C-34

RMS Gain at Main Lobe 18.0 (12.55 dB)
RMS Gain at Horizontal 11.73 (10.69 dB)

Beam Tilt 1.2 deg down
Frequency 590-596 MHz

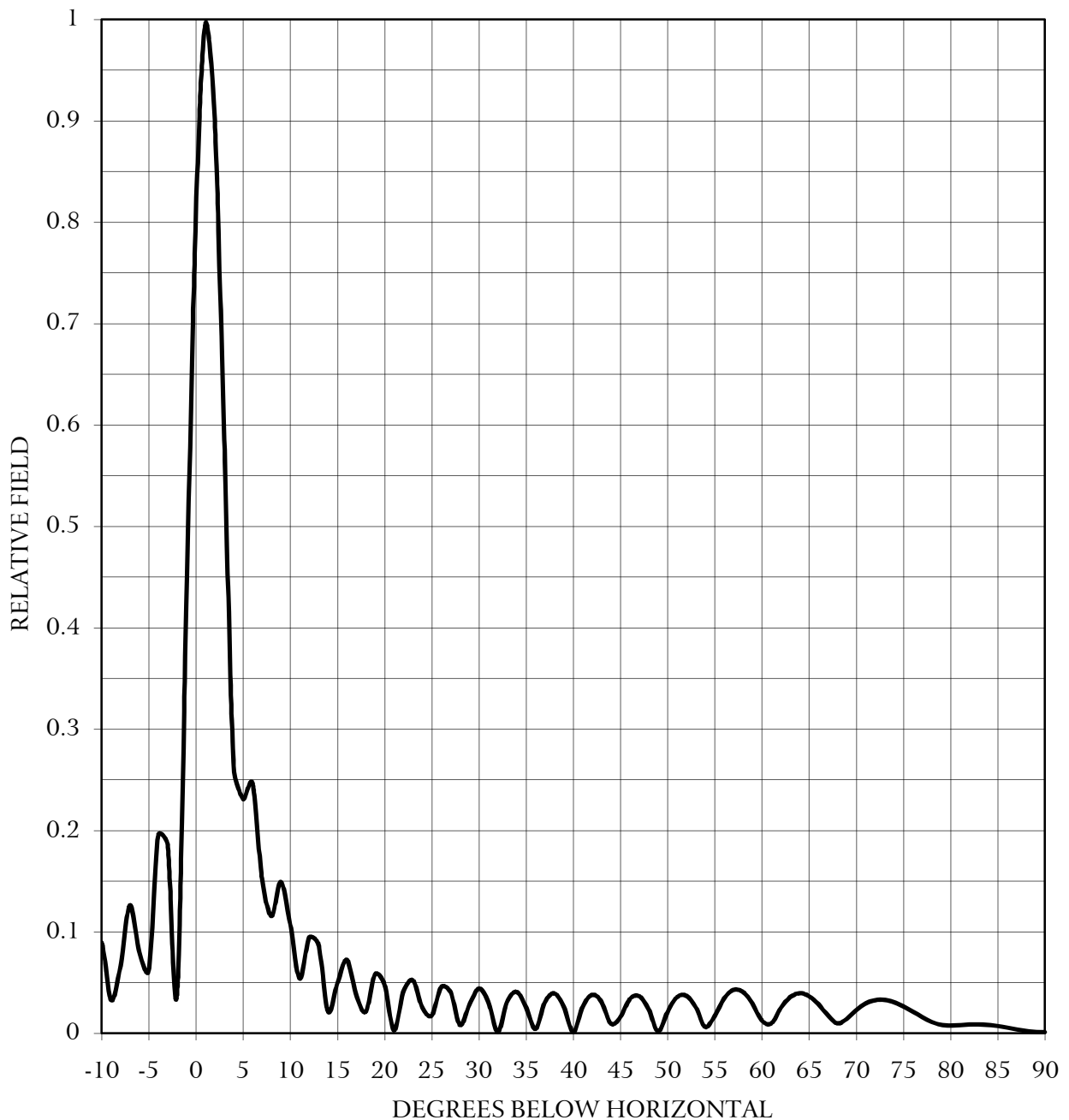

KESSLER & GEHMAN
TELECOMMUNICATIONS CONSULTING ENGINEERS
507 N.W. 60th Street, Suite C

WPBY-TV
HUNTINGTON, WV

20111221

EXHIBIT 37.8

KESSLER AND GEHMAN ASSOCIATES, INC.

507 NW 60th St. Ste C, Gainesville, FL 32607

OET69 Allocation Study

WPBY-TV
Huntington, WV

Percent allowed new interference: 0.500
Percent allowed new interference to non Class A LPTV: 2.000
Census data selected 2000
Data Base Selected
./data_files/pt_tvdb.sff
TV INTERFERENCE and SPACING ANALYSIS PROGRAM

Date: 12-21-2011 Time: 11:00:22

Record Selected for Analysis

WPBY-PRO USERRECORD-01 HUNTINGTON WV US
Channel 34 ERP 76.3 kW HAAT 360. m RCAMSL 00585 m
Latitude 038-29-41 Longitude 0082-12-03
Status APP Zone 1 Border Site number: 01
Dir Antenna Make usr Model USRPAT01 Beam tilt N Ref Azimuth 160.
Last update Cutoff date Docket
Comments
Applicant

Cell Size for Service Analysis 2.0 km/side

Distance Increments for Longley-Rice Analysis 1.00 km

Facility (site # 01) meets maximum height/power limits

Site number	1			
Azimuth	ERP	HAAT	41.0 dBu F(50,90)	
(Deg)	(kW)	(m)	(km)	
0.0	4.923	370.5	65.7	
45.0	17.143	362.5	72.9	
90.0	36.432	336.3	75.5	
135.0	68.933	375.2	83.1	
180.0	71.791	351.8	81.3	
225.0	39.664	376.5	79.5	
270.0	20.237	363.0	74.0	
315.0	3.932	345.1	63.0	

Evaluation toward Class A Stations from site # 01

No Spacing violations or contour overlap
to Class A stations from site # 01

Class A Evaluation Complete

SPACING VIOLATION FOUND BETWEEN STATION

WPBY-PRO 34 HUNTINGTON WV USERRECORD01 Site # 01

and station

KESSLER AND GEHMAN ASSOCIATES, INC.

507 NW 60th St. Ste C, Gainesville, FL 32607

OET69 Allocation Study

WPBY-TV
Huntington, WV

SHORT TO: WPBY-TV 34 HUNTINGTON WV DTVPLN DTVPL1271
38 -29-41 82 -12-03
Req. separation 196.3 Actual separation 0.0 Short 196.3 km

LANDMOBILE SPACING VIOLATIONS FOUND

NONE from Site # 01

Checks to Site Number 01

Proposed facility OK to FCC Monitoring Stations

Proposed facility OK toward West Virginia quiet zone

Proposed facility OK toward Table Mountain

Proposed facility is within the Canadian coordination distance
Distance to border = 354.1km

Proposed facility is beyond the Mexican coordination distance

Proposed station is OK toward AM broadcast stations

Start of Interference Analysis

Channel	Proposed Station Call	City/State	ARN
34	WPBY-PRO	HUNTINGTON WV	USERRECORD01

Stations Potentially Affected by Proposed Station

Chan	Call	City/State	Dist(km)	Status	Application	Ref. No.
33	WSTR-TV	CINCINNATI OH	215.7	LIC	BLCDT	20091117ACS
34	WSOC-TV	CHARLOTTE NC	382.5	LIC	BLCDT	20040526ANW
34	WCET	CINCINNATI OH	212.8	LIC	BLEDT	20061031AAR
34	WQHS-DT	CLEVELAND OH	323.8	LIC	BLCDT	20031030AGJ
34	WQHS-DT	CLEVELAND OH	323.8	CP	BPCDT	20090629ACU
34	WJAC-TV	JOHNSTOWN PA	346.2	LIC	BLCDT	20051123AKN
34	WJAC-TV	JOHNSTOWN PA	346.2	CP	BPCDT	20080619ADU
34	WTNZ	KNOXVILLE TN	316.9	LIC	BMLCDT	20040706ABG
34	WTNZ	KNOXVILLE TN	316.9	CP	BPCDT	20080619ABZ
35	WOUC-TV	CAMBRIDGE OH	194.1	LIC	BLEDT	20050427AAB
35	WLWT	CINCINNATI OH	212.8	LIC	BLCDT	20050502ABC

%%%

Analysis of Interference to Affected Station 1

Channel	Call	City/State	Application	Ref. No.
33	WSTR-TV	CINCINNATI OH	BLCDT	-20091117ACS

Stations Potentially Affecting This Station

Chan	Call	City/State	Dist(km)	Status	Application	Ref. No.
------	------	------------	----------	--------	-------------	----------

KESSLER AND GEHMAN ASSOCIATES, INC.

507 NW 60th St. Ste C, Gainesville, FL 32607

OET69 Allocation Study

WPBY-TV
Huntington, WV

32	WNDY-TV	MARION IN	160.4	LIC	BLCDT	-20110706ABJ
33	WPGD-TV	HENDERSONVILLE TN	382.3	LIC	BLCDT	-20090701AAZ
33	WPGD-DR	HENDERSONVILLE TN	382.3	APP	BPRM	-20080620AIV
33	WNPB-TV	MORGANTOWN WV	412.2	LIC	BLEDT	-20100505AGH
33	WNPB-TV	MORGANTOWN WV	412.2	CP MOD	BMPEDT	-20080619ACQ
34	WCET	CINCINNATI OH	8.5	LIC	BLEDT	-20061031AAR
34	WPBY-TV	HUNTINGTON WV	215.7	PLN	DTVPLN	-DTVP1271
34	WPBY-PRO	HUNTINGTON WV	215.7	APP	USERRECORD-01	

Proposed station is beyond the site to
nearest cell evaluation distance

#####

Analysis of Interference to Affected Station 2

Analysis of current record

Channel	Call	City/State	Application	Ref. No.
34	WSOC-TV	CHARLOTTE NC	BLCDT	-20040526ANW

Stations Potentially Affecting This Station

Chan	Call	City/State	Dist(km)	Status	Application	Ref. No.
33	WMYV	GREENSBORO NC	105.9	LIC	BLCDT	-20020430ABD
34	WPXU-TV	JACKSONVILLE NC	310.1	LIC	BLCDT	-20021029AAD
34	WPXU-TV	JACKSONVILLE NC	310.1	CP	BPCDT	-20080620AGG
34	WCIV	CHARLESTON SC	276.4	LIC	BLCDT	-20060630ADJ
34	WTNZ	KNOXVILLE TN	302.0	LIC	BMLCDT	-20040706ABG
34	WTNZ	KNOXVILLE TN	302.0	CP	BPCDT	-20080619ABZ
34	WPBY-TV	HUNTINGTON WV	382.5	PLN	DTVPLN	-DTVP1271
35	WGHP	HIGH POINT NC	100.9	LIC	BLCDT	-20100315ABW
35	WGHP-DR	HIGH POINT NC	100.9	APP	BPRM	-20091014AFK
34	WPBY-PRO	HUNTINGTON WV	382.5	APP	USERRECORD-01	

Proposal causes no interference

#####

Analysis of Interference to Affected Station 3

Analysis of current record

Channel	Call	City/State	Application	Ref. No.
34	WCET	CINCINNATI OH	BLEDT	-20061031AAR

Stations Potentially Affecting This Station

Chan	Call	City/State	Dist(km)	Status	Application	Ref. No.
33	WSTR-TV	CINCINNATI OH	8.5	LIC	BLCDT	-20091117ACS
34	WSIL-TV	HARRISBURG IL	414.6	LIC	BLCDT	-20080718AAR
34	WHTV	JACKSON MI	396.4	APP	BMPEDT	-20110420ABJ
34	WHTV	JACKSON MI	396.4	LIC	BLCDT	-20071116ABR
34	WHTV	JACKSON MI	396.4	CP MOD	BMPEDT	-20101013ADM
34	WQHS-DT	CLEVELAND OH	346.7	LIC	BLCDT	-20031030AGJ
34	WQHS-DT	CLEVELAND OH	346.7	CP	BPCDT	-20090629ACU
34	WTNZ	KNOXVILLE TN	350.6	LIC	BMLCDT	-20040706ABG
34	WTNZ	KNOXVILLE TN	350.6	CP	BPCDT	-20080619ABZ
34	WPBY-TV	HUNTINGTON WV	212.8	PLN	DTVPLN	-DTVP1271
35	WLWT	CINCINNATI OH	0.0	LIC	BLCDT	-20050502ABC
34	WPBY-PRO	HUNTINGTON WV	212.8	APP	USERRECORD-01	

Total scenarios = 2

KESSLER AND GEHMAN ASSOCIATES, INC.

507 NW 60th St. Ste C, Gainesville, FL 32607

OET69 Allocation Study

WPBY-TV
Huntington, WV

Result key: 1
Scenario 1 Affected station 3
Before Analysis

Results for: 34A OH CINCINNATI BLEDT 20061031AAR LIC
HAAT 326.0 m, ATV ERP 400.0 kW

	POPULATION	AREA (sq km)
within Noise Limited Contour	3002546	23757.9
not affected by terrain losses	2983770	23467.4
lost to NTSC IX	0	0.0
lost to additional IX by ATV	3867	92.8
lost to ATV IX only	3867	92.8
lost to all IX	3867	92.8

Potential Interfering Stations Included in above Scenario 1

33A OH CINCINNATI	BLCDT	20091117ACS	LIC
34A OH CLEVELAND	BLCDT	20031030AGJ	LIC
35A OH CINCINNATI	BLCDT	20050502ABC	LIC
34A WV HUNTINGTON	DTVPLN	DTVP1271	PLN

After Analysis

Results for: 34A OH CINCINNATI BLEDT 20061031AAR LIC
HAAT 326.0 m, ATV ERP 400.0 kW

	POPULATION	AREA (sq km)
within Noise Limited Contour	3002546	23757.9
not affected by terrain losses	2983770	23467.4
lost to NTSC IX	0	0.0
lost to additional IX by ATV	3867	92.8
lost to ATV IX only	3867	92.8
lost to all IX	3867	92.8

Potential Interfering Stations Included in above Scenario 1

33A OH CINCINNATI	BLCDT	20091117ACS	LIC
34A OH CLEVELAND	BLCDT	20031030AGJ	LIC
35A OH CINCINNATI	BLCDT	20050502ABC	LIC
34A WV HUNTINGTON	USERRECORD01		APP

Percent new IX = 0.0000%

Result key: 2
Scenario 2 Affected station 3
Before Analysis

Results for: 34A OH CINCINNATI BLEDT 20061031AAR LIC
HAAT 326.0 m, ATV ERP 400.0 kW

	POPULATION	AREA (sq km)
within Noise Limited Contour	3002546	23757.9
not affected by terrain losses	2983770	23467.4
lost to NTSC IX	0	0.0
lost to additional IX by ATV	3867	92.8
lost to ATV IX only	3867	92.8
lost to all IX	3867	92.8

Potential Interfering Stations Included in above Scenario 2

33A OH CINCINNATI	BLCDT	20091117ACS	LIC
34A OH CLEVELAND	BPCDT	20090629ACU	CP
35A OH CINCINNATI	BLCDT	20050502ABC	LIC
34A WV HUNTINGTON	DTVPLN	DTVP1271	PLN

After Analysis

KESSLER AND GEHMAN ASSOCIATES, INC.

507 NW 60th St. Ste C, Gainesville, FL 32607

OET69 Allocation Study

WPBY-TV
Huntington, WV

Results for: 34A OH CINCINNATI BLEDT 20061031AAR LIC

HAAT 326.0 m, ATV ERP 400.0 kW

	POPULATION	AREA (sq km)
within Noise Limited Contour	3002546	23757.9
not affected by terrain losses	2983770	23467.4
lost to NTSC IX	0	0.0
lost to additional IX by ATV	3867	92.8
lost to ATV IX only	3867	92.8
lost to all IX	3867	92.8

Potential Interfering Stations Included in above Scenario 2

33A OH CINCINNATI	BLCDDT	20091117ACS	LIC
34A OH CLEVELAND	BPCDDT	20090629ACU	CP
35A OH CINCINNATI	BLCDDT	20050502ABC	LIC
34A WV HUNTINGTON	USERRECORD01		APP

Percent new IX = 0.0000%

Worst case new IX 0.0000% Scenario 1

#####

Analysis of Interference to Affected Station 4

Analysis of current record

Channel	Call	City/State	Application	Ref. No.
34	WQHS-DT	CLEVELAND OH	BLCDDT	-20031030AGJ

Stations Potentially Affecting This Station

Chan	Call	City/State	Dist(km)	Status	Application	Ref. No.
34	WHTV	JACKSON MI	264.2	APP	BMPCDDT	-20110420ABJ
34	WHTV	JACKSON MI	264.2	LIC	BLCDDT	-20071116ABR
34	WHTV	JACKSON MI	264.2	CP MOD	BMPCDDT	-20101013ADM
34	WCET	CINCINNATI OH	346.7	LIC	BLEDDT	-20061031AAR
34	WJAC-TV	JOHNSTOWN PA	254.7	LIC	BLCDDT	-20051123AKN
34	WJAC-TV	JOHNSTOWN PA	254.7	CP	BPCDDT	-20080619ADU
34	WPBY-TV	HUNTINGTON WV	323.8	PLN	DTVPLN	-DTPV1271
35	WOUC-TV	CAMBRIDGE OH	147.6	LIC	BLEDDT	-20050427AAB
34	WPBY-PRO	HUNTINGTON WV	323.8	APP	USERRECORD-01	

Proposal causes no interference

#####

Analysis of Interference to Affected Station 5

Analysis of current record

Channel	Call	City/State	Application	Ref. No.
34	WQHS-DT	CLEVELAND OH	BPCDDT	-20090629ACU

Stations Potentially Affecting This Station

Chan	Call	City/State	Dist(km)	Status	Application	Ref. No.
34	WHTV	JACKSON MI	264.2	APP	BMPCDDT	-20110420ABJ
34	WHTV	JACKSON MI	264.2	LIC	BLCDDT	-20071116ABR
34	WHTV	JACKSON MI	264.2	CP MOD	BMPCDDT	-20101013ADM
34	WCET	CINCINNATI OH	346.7	LIC	BLEDDT	-20061031AAR
34	WJAC-TV	JOHNSTOWN PA	254.7	LIC	BLCDDT	-20051123AKN
34	WJAC-TV	JOHNSTOWN PA	254.7	CP	BPCDDT	-20080619ADU

KESSLER AND GEHMAN ASSOCIATES, INC.

507 NW 60th St. Ste C, Gainesville, FL 32607

OET69 Allocation Study

WPBY-TV
Huntington, WV

34	WPBY-TV	HUNTINGTON WV	323.8	PLN	DTVPLN	-DTVP1271
35	WOUC-TV	CAMBRIDGE OH	147.6	LIC	BLEDT	-20050427AAB
34	WPBY-PRO	HUNTINGTON WV	323.8	APP	USERRECORD-01	

Proposal causes no interference

#####

Analysis of Interference to Affected Station 6

Analysis of current record

Channel	Call	City/State	Application	Ref. No.
34	WJAC-TV	JOHNSTOWN PA	BLCDDT	-20051123AKN

Stations Potentially Affecting This Station

Chan	Call	City/State	Dist(km)	Status	Application	Ref. No.
33	WHUT-TV	WASHINGTON DC	226.8	LIC	BLEDT	-20071018AIJ
33	WHUT-TV	WASHINGTON DC	226.8	CP	BPEDT	-20080619AGL
33	WNPB-TV	MORGANTOWN WV	100.2	LIC	BLEDT	-20100505AGH
33	WNPB-TV	MORGANTOWN WV	100.2	CP MOD	BMPEDT	-20080619ACQ
34	WIVT	BINGHAMTON NY	315.9	LIC	BLCDDT	-20090819AGR
34	WQHS-DT	CLEVELAND OH	254.7	LIC	BLCDDT	-20031030AGJ
34	WQHS-DT	CLEVELAND OH	254.7	CP	BPCDDT	-20090629ACU
34	WCAU	PHILADELPHIA PA	320.1	LIC	BLCDDT	-20090914AAX
34	WPXW-TV	MANASSAS VA	226.8	LIC	BLCDDT	-20090612AIZ
34	WPBY-TV	HUNTINGTON WV	346.2	PLN	DTVPLN	-DTVP1271
35	WDCA	WASHINGTON DC	226.2	LIC	BLCDDT	-20070411AAH
35	WDCA	WASHINGTON DC	226.2	CP	BPCDDT	-20080620ANP
35	WOUC-TV	CAMBRIDGE OH	198.1	LIC	BLEDT	-20050427AAB
34	WPBY-PRO	HUNTINGTON WV	346.2	APP	USERRECORD-01	

Total scenarios = 4

Result key: 3
Scenario 1 Affected station 6
Before Analysis

Results for: 34A PA JOHNSTOWN BLCDDT 20051123AKN LIC
HAAT 386.0 m, ATV ERP 1000.0 kW

	POPULATION	AREA (sq km)
within Noise Limited Contour	2352165	29698.4
not affected by terrain losses	2045975	25156.6
lost to NTSC IX	0	0.0
lost to additional IX by ATV	67331	774.4
lost to ATV IX only	67331	774.4
lost to all IX	67331	774.4

Potential Interfering Stations Included in above Scenario 1

33A WV MORGANTOWN	BLEDT	20100505AGH	LIC
34A NY BINGHAMTON	BLCDDT	20090819AGR	LIC
34A OH CLEVELAND	BLCDDT	20031030AGJ	LIC
34A PA PHILADELPHIA	BLCDDT	20090914AAX	LIC
34A VA MANASSAS	BLCDDT	20090612AIZ	LIC

After Analysis

Results for: 34A PA JOHNSTOWN BLCDDT 20051123AKN LIC
HAAT 386.0 m, ATV ERP 1000.0 kW

	POPULATION	AREA (sq km)
within Noise Limited Contour	2352165	29698.4
not affected by terrain losses	2045975	25156.6

KESSLER AND GEHMAN ASSOCIATES, INC.

507 NW 60th St. Ste C, Gainesville, FL 32607

OET69 Allocation Study

WPBY-TV
Huntington, WV

lost to NTSC IX	0	0.0
lost to additional IX by ATV	67331	774.4
lost to ATV IX only	67331	774.4
lost to all IX	67331	774.4

Potential Interfering Stations Included in above Scenario 1

33A WV MORGANTOWN	BLEDT	20100505AGH	LIC
34A NY BINGHAMTON	BLCDT	20090819AGR	LIC
34A OH CLEVELAND	BLCDT	20031030AGJ	LIC
34A PA PHILADELPHIA	BLCDT	20090914AAX	LIC
34A VA MANASSAS	BLCDT	20090612AIZ	LIC
34A WV HUNTINGTON	USERRECORD01		APP

Percent new IX = 0.0000%

Result key: 4
Scenario 2 Affected station 6
Before Analysis

Results for: 34A PA JOHNSTOWN BLCDDT 20051123AKN LIC
HAAT 386.0 m, ATV ERP 1000.0 kW

	POPULATION	AREA (sq km)
within Noise Limited Contour	2352165	29698.4
not affected by terrain losses	2045975	25156.6
lost to NTSC IX	0	0.0
lost to additional IX by ATV	79578	850.6
lost to ATV IX only	79578	850.6
lost to all IX	79578	850.6

Potential Interfering Stations Included in above Scenario 2

33A WV MORGANTOWN	BLEDT	20100505AGH	LIC
34A NY BINGHAMTON	BLCDT	20090819AGR	LIC
34A OH CLEVELAND	BPCDDT	20090629ACU	CP
34A PA PHILADELPHIA	BLCDT	20090914AAX	LIC
34A VA MANASSAS	BLCDT	20090612AIZ	LIC

After Analysis

Results for: 34A PA JOHNSTOWN BLCDDT 20051123AKN LIC
HAAT 386.0 m, ATV ERP 1000.0 kW

	POPULATION	AREA (sq km)
within Noise Limited Contour	2352165	29698.4
not affected by terrain losses	2045975	25156.6
lost to NTSC IX	0	0.0
lost to additional IX by ATV	79578	850.6
lost to ATV IX only	79578	850.6
lost to all IX	79578	850.6

Potential Interfering Stations Included in above Scenario 2

33A WV MORGANTOWN	BLEDT	20100505AGH	LIC
34A NY BINGHAMTON	BLCDT	20090819AGR	LIC
34A OH CLEVELAND	BPCDDT	20090629ACU	CP
34A PA PHILADELPHIA	BLCDT	20090914AAX	LIC
34A VA MANASSAS	BLCDT	20090612AIZ	LIC
34A WV HUNTINGTON	USERRECORD01		APP

Percent new IX = 0.0000%

Result key: 5
Scenario 3 Affected station 6
Before Analysis

KESSLER AND GEHMAN ASSOCIATES, INC.

507 NW 60th St. Ste C, Gainesville, FL 32607

OET69 Allocation Study

WPBY-TV
Huntington, WV

Results for: 34A PA JOHNSTOWN BLCDT 20051123AKN LIC

HAAT 386.0 m, ATV ERP 1000.0 kW

	POPULATION	AREA (sq km)
within Noise Limited Contour	2352165	29698.4
not affected by terrain losses	2045975	25156.6
lost to NTSC IX	0	0.0
lost to additional IX by ATV	74107	830.5
lost to ATV IX only	74107	830.5
lost to all IX	74107	830.5

Potential Interfering Stations Included in above Scenario 3

33A WV MORGANTOWN	BMPEDT	20080619ACQ	CP
34A NY BINGHAMTON	BLCDT	20090819AGR	LIC
34A OH CLEVELAND	BLCDT	20031030AGJ	LIC
34A PA PHILADELPHIA	BLCDT	20090914AAX	LIC
34A VA MANASSAS	BLCDT	20090612AIZ	LIC

After Analysis

Results for: 34A PA JOHNSTOWN BLCDT 20051123AKN LIC

HAAT 386.0 m, ATV ERP 1000.0 kW

	POPULATION	AREA (sq km)
within Noise Limited Contour	2352165	29698.4
not affected by terrain losses	2045975	25156.6
lost to NTSC IX	0	0.0
lost to additional IX by ATV	74107	830.5
lost to ATV IX only	74107	830.5
lost to all IX	74107	830.5

Potential Interfering Stations Included in above Scenario 3

33A WV MORGANTOWN	BMPEDT	20080619ACQ	CP
34A NY BINGHAMTON	BLCDT	20090819AGR	LIC
34A OH CLEVELAND	BLCDT	20031030AGJ	LIC
34A PA PHILADELPHIA	BLCDT	20090914AAX	LIC
34A VA MANASSAS	BLCDT	20090612AIZ	LIC
34A WV HUNTINGTON	USERRECORD01		APP

Percent new IX = 0.0000%

Result key: 6

Scenario 4 Affected station 6

Before Analysis

Results for: 34A PA JOHNSTOWN BLCDT 20051123AKN LIC

HAAT 386.0 m, ATV ERP 1000.0 kW

	POPULATION	AREA (sq km)
within Noise Limited Contour	2352165	29698.4
not affected by terrain losses	2045975	25156.6
lost to NTSC IX	0	0.0
lost to additional IX by ATV	86354	906.8
lost to ATV IX only	86354	906.8
lost to all IX	86354	906.8

Potential Interfering Stations Included in above Scenario 4

33A WV MORGANTOWN	BMPEDT	20080619ACQ	CP
34A NY BINGHAMTON	BLCDT	20090819AGR	LIC
34A OH CLEVELAND	BPCDT	20090629ACU	CP
34A PA PHILADELPHIA	BLCDT	20090914AAX	LIC
34A VA MANASSAS	BLCDT	20090612AIZ	LIC

After Analysis

KESSLER AND GEHMAN ASSOCIATES, INC.

507 NW 60th St. Ste C, Gainesville, FL 32607

OET69 Allocation Study

WPBY-TV
Huntington, WV

Results for: 34A PA JOHNSTOWN BLCDDT 20051123AKN LIC

HAAT 386.0 m, ATV ERP 1000.0 kW

	POPULATION	AREA (sq km)
within Noise Limited Contour	2352165	29698.4
not affected by terrain losses	2045975	25156.6
lost to NTSC IX	0	0.0
lost to additional IX by ATV	86354	906.8
lost to ATV IX only	86354	906.8
lost to all IX	86354	906.8

Potential Interfering Stations Included in above Scenario 4

33A WV MORGANTOWN	BMPEDT	20080619ACQ	CP
34A NY BINGHAMTON	BLCDDT	20090819AGR	LIC
34A OH CLEVELAND	BPCDDT	20090629ACU	CP
34A PA PHILADELPHIA	BLCDDT	20090914AAX	LIC
34A VA MANASSAS	BLCDDT	20090612AIZ	LIC
34A WV HUNTINGTON	USERRECORD01		APP

Percent new IX = 0.0000%

Worst case new IX 0.0000% Scenario 1

#####

Analysis of Interference to Affected Station 7

Analysis of current record

Channel	Call	City/State	Application	Ref. No.
34	WJAC-TV	JOHNSTOWN PA	BPCDDT	-20080619ADU

Stations Potentially Affecting This Station

Chan	Call	City/State	Dist(km)	Status	Application	Ref. No.
33	WHUT-TV	WASHINGTON DC	226.8	LIC	BLEDT	-20071018AIJ
33	WHUT-TV	WASHINGTON DC	226.8	CP	BPEDT	-20080619AGL
33	WNPB-TV	MORGANTOWN WV	100.2	LIC	BLEDT	-20100505AGH
33	WNPB-TV	MORGANTOWN WV	100.2	CP MOD	BMPEDT	-20080619ACQ
34	WIVT	BINGHAMTON NY	315.9	LIC	BLCDDT	-20090819AGR
34	WQHS-DT	CLEVELAND OH	254.7	LIC	BLCDDT	-20031030AGJ
34	WQHS-DT	CLEVELAND OH	254.7	CP	BPCDDT	-20090629ACU
34	WCAU	PHILADELPHIA PA	320.1	LIC	BLCDDT	-20090914AAX
34	WPXW-TV	MANASSAS VA	226.8	LIC	BLCDDT	-20090612AIZ
34	WPBY-TV	HUNTINGTON WV	346.2	PLN	DTVPLN	-DTVPLN1271
35	WDCA	WASHINGTON DC	226.2	LIC	BLCDDT	-20070411AAH
35	WDCA	WASHINGTON DC	226.2	CP	BPCDDT	-20080620ANP
35	WOUC-TV	CAMBRIDGE OH	198.1	LIC	BLEDT	-20050427AAB
34	WPBY-PRO	HUNTINGTON WV	346.2	APP	USERRECORD-01	

Proposal causes no interference

#####

Analysis of Interference to Affected Station 8

Analysis of current record

Channel	Call	City/State	Application	Ref. No.
34	WTNZ	KNOXVILLE TN	BMLCDDT	-20040706ABG

Stations Potentially Affecting This Station

Chan	Call	City/State	Dist(km)	Status	Application	Ref. No.
------	------	------------	----------	--------	-------------	----------

KESSLER AND GEHMAN ASSOCIATES, INC.

507 NW 60th St. Ste C, Gainesville, FL 32607

OET69 Allocation Study

WPBY-TV
Huntington, WV

33	WNGH-TV	CHATSWORTH GA	155.8	LIC	BLEDT	-20080509AAN
34	WSOC-TV	CHARLOTTE NC	302.0	LIC	BLCDT	-20040526ANW
34	WCET	CINCINNATI OH	350.6	LIC	BLEDT	-20061031AAR
34	WPBY-TV	HUNTINGTON WV	316.9	PLN	DTVPLN	-DTVP1271
34	WPBY-PRO	HUNTINGTON WV	316.9	APP	USERRECORD-01	

Total scenarios = 1

Result key: 7
Scenario 1 Affected station 8
Before Analysis

Results for: 34A TN KNOXVILLE BMLCDT 20040706ABG LIC

HAAT 529.0 m, ATV ERP 460.0 kW	POPULATION	AREA (sq km)
within Noise Limited Contour	1542487	37756.2
not affected by terrain losses	1347284	29725.2
lost to NTSC IX	0	0.0
lost to additional IX by ATV	2916	136.4
lost to ATV IX only	2916	136.4
lost to all IX	2916	136.4

Potential Interfering Stations Included in above Scenario 1

33A GA CHATSWORTH	BLEDT	20080509AAN	LIC
34A NC CHARLOTTE	BLCDT	20040526ANW	LIC
34A OH CINCINNATI	BLEDT	20061031AAR	LIC
34A WV HUNTINGTON	DTVPLN	DTVP1271	PLN

After Analysis

Results for: 34A TN KNOXVILLE BMLCDT 20040706ABG LIC

HAAT 529.0 m, ATV ERP 460.0 kW	POPULATION	AREA (sq km)
within Noise Limited Contour	1542487	37756.2
not affected by terrain losses	1347284	29725.2
lost to NTSC IX	0	0.0
lost to additional IX by ATV	2916	136.4
lost to ATV IX only	2916	136.4
lost to all IX	2916	136.4

Potential Interfering Stations Included in above Scenario 1

33A GA CHATSWORTH	BLEDT	20080509AAN	LIC
34A NC CHARLOTTE	BLCDT	20040526ANW	LIC
34A OH CINCINNATI	BLEDT	20061031AAR	LIC
34A WV HUNTINGTON	USERRECORD01		APP

Percent new IX = 0.0000%

Worst case new IX 0.0000% Scenario 1

#####

Analysis of Interference to Affected Station 9

Analysis of current record

Channel	Call	City/State	Application	Ref. No.
34	WTNZ	KNOXVILLE TN	BPCDT	-20080619ABZ

Stations Potentially Affecting This Station

KESSLER AND GEHMAN ASSOCIATES, INC.

507 NW 60th St. Ste C, Gainesville, FL 32607

OET69 Allocation Study

WPBY-TV
Huntington, WV

Chan	Call	City/State	Dist(km)	Status	Application	Ref. No.
33	WNGH-TV	CHATSWORTH GA	155.8	LIC	BLEDT	-20080509AAN
34	WSOC-TV	CHARLOTTE NC	302.0	LIC	BLCDT	-20040526ANW
34	WCET	CINCINNATI OH	350.6	LIC	BLEDT	-20061031AAR
34	WPBY-TV	HUNTINGTON WV	316.9	PLN	DTVPLN	-DTVP1271
34	WPBY-PRO	HUNTINGTON WV	316.9	APP	USERRECORD-01	

Total scenarios = 1

Result key: 8
Scenario 1 Affected station 9
Before Analysis

Results for: 34A TN KNOXVILLE BPCDT 20080619ABZ CP
HAAT 527.0 m, ATV ERP 930.0 kW

	POPULATION	AREA (sq km)
within Noise Limited Contour	1655659	42436.3
not affected by terrain losses	1435002	33775.8
lost to NTSC IX	0	0.0
lost to additional IX by ATV	3841	260.7
lost to ATV IX only	3841	260.7
lost to all IX	3841	260.7

Potential Interfering Stations Included in above Scenario 1

33A GA CHATSWORTH	BLEDT	20080509AAN	LIC
34A NC CHARLOTTE	BLCDT	20040526ANW	LIC
34A OH CINCINNATI	BLEDT	20061031AAR	LIC
34A WV HUNTINGTON	DTVPLN	DTVP1271	PLN

After Analysis

Results for: 34A TN KNOXVILLE BPCDT 20080619ABZ CP
HAAT 527.0 m, ATV ERP 930.0 kW

	POPULATION	AREA (sq km)
within Noise Limited Contour	1655659	42436.3
not affected by terrain losses	1435002	33775.8
lost to NTSC IX	0	0.0
lost to additional IX by ATV	3841	260.7
lost to ATV IX only	3841	260.7
lost to all IX	3841	260.7

Potential Interfering Stations Included in above Scenario 1

33A GA CHATSWORTH	BLEDT	20080509AAN	LIC
34A NC CHARLOTTE	BLCDT	20040526ANW	LIC
34A OH CINCINNATI	BLEDT	20061031AAR	LIC
34A WV HUNTINGTON	USERRECORD01		APP

Percent new IX = 0.0000%

Worst case new IX 0.0000% Scenario 1

#####

Analysis of Interference to Affected Station 10

Analysis of current record

Channel	Call	City/State	Application	Ref. No.
35	WOUC-TV	CAMBRIDGE OH	BLEDT	-20050427AAB

Stations Potentially Affecting This Station

KESSLER AND GEHMAN ASSOCIATES, INC.

507 NW 60th St. Ste C, Gainesville, FL 32607

OET69 Allocation Study

WPBY-TV
Huntington, WV

Chan	Call	City/State	Dist(km)	Status	Application	Ref. No.
34	WQHS-DT	CLEVELAND OH	147.6	LIC	BLCDDT	-20031030AGJ
34	WQHS-DT	CLEVELAND OH	147.6	CP	BPCDDT	-20090629ACU
34	WJAC-TV	JOHNSTOWN PA	198.1	LIC	BLCDDT	-20051123AKN
34	WJAC-TV	JOHNSTOWN PA	198.1	CP	BPCDDT	-20080619ADU
34	WPBY-TV	HUNTINGTON WV	194.1	PLN	DTVPLN	-DTVP1271
35	WDCA	WASHINGTON DC	382.0	LIC	BLCDDT	-20070411AAH
35	WDCA	WASHINGTON DC	382.0	CP	BPCDDT	-20080620ANP
35	WLWT	CINCINNATI OH	297.0	LIC	BLCDDT	-20050502ABC
36	WGPT	OAKLAND MD	186.9	LIC	BLEDT	-20110509ACO
36	WTTE	COLUMBUS OH	148.5	LIC	BLCDDT	-20050701ABA
36	WYTV	YOUNGSTOWN OH	121.1	LIC	BLCDDT	-20100422ABQ
34	WPBY-PRO	HUNTINGTON WV	194.1	APP	USERRECORD-01	

Proposal causes no interference

#####

Analysis of Interference to Affected Station 11

Analysis of current record

Channel	Call	City/State	Application	Ref. No.
35	WLWT	CINCINNATI OH	BLCDDT	-20050502ABC

Stations Potentially Affecting This Station

Chan	Call	City/State	Dist(km)	Status	Application	Ref. No.
34	WCET	CINCINNATI OH	0.0	LIC	BLEDT	-20061031AAR
34	WPBY-TV	HUNTINGTON WV	212.8	PLN	DTVPLN	-DTVP1271
35	WNIT	SOUTH BEND IN	310.6	LIC	BLEDT	-20110516ADN
35	WOUC-TV	CAMBRIDGE OH	297.0	LIC	BLEDT	-20050427AAB
36	WFFT-TV	FORT WAYNE IN	227.9	LIC	BLCDDT	-20090521AAQ
36	WKYT-TV	LEXINGTON KY	121.0	LIC	BLCDDT	-20100902ACB
36	WKYT-DR	LEXINGTON KY	121.0	APP	BPRM	-20090821AEA
36	WTTE	COLUMBUS OH	157.2	LIC	BLCDDT	-20050701ABA
34	WPBY-PRO	HUNTINGTON WV	212.8	APP	USERRECORD-01	

Proposal causes no interference

#####

Analysis of Interference to Affected Station 12

Analysis of current record

Channel	Call	City/State	Application	Ref. No.
34	WPBY-PRO	HUNTINGTON WV	USERRECORD-01	

Stations Potentially Affecting This Station

Chan	Call	City/State	Dist(km)	Status	Application	Ref. No.
33	WSTR-TV	CINCINNATI OH	215.7	LIC	BLCDDT	-20091117ACS
34	WSOC-TV	CHARLOTTE NC	382.5	LIC	BLCDDT	-20040526ANW
34	WCET	CINCINNATI OH	212.8	LIC	BLEDT	-20061031AAR
34	WQHS-DT	CLEVELAND OH	323.8	LIC	BLCDDT	-20031030AGJ
34	WQHS-DT	CLEVELAND OH	323.8	CP	BPCDDT	-20090629ACU
34	WJAC-TV	JOHNSTOWN PA	346.2	LIC	BLCDDT	-20051123AKN
34	WJAC-TV	JOHNSTOWN PA	346.2	CP	BPCDDT	-20080619ADU
34	WTNZ	KNOXVILLE TN	316.9	LIC	BMLCDDT	-20040706ABG
34	WTNZ	KNOXVILLE TN	316.9	CP	BPCDDT	-20080619ABZ
35	WOUC-TV	CAMBRIDGE OH	194.1	LIC	BLEDT	-20050427AAB
35	WLWT	CINCINNATI OH	212.8	LIC	BLCDDT	-20050502ABC

KESSLER AND GEHMAN ASSOCIATES, INC.

507 NW 60th St. Ste C, Gainesville, FL 32607

OET69 Allocation Study

WPBY-TV
Huntington, WV

Total scenarios = 4

Result key: 9
Scenario 1 Affected station 12
Before Analysis

Results for: 34A WV HUNTINGTON USERRECORD01 APP
HAAT 360.0 m, ATV ERP 76.3 kW

	POPULATION	AREA (sq km)
within Noise Limited Contour	782508	17742.8
not affected by terrain losses	745325	16928.9
lost to NTSC IX	0	0.0
lost to additional IX by ATV	6815	286.0
lost to ATV IX only	6815	286.0
lost to all IX	6815	286.0

Potential Interfering Stations Included in above Scenario 1

34A OH CINCINNATI	BLEDT	20061031AAR	LIC
34A OH CLEVELAND	BLCDT	20031030AGJ	LIC
34A PA JOHNSTOWN	BPCDT	20080619ADU	CP
34A TN KNOXVILLE	BMLCDT	20040706ABG	LIC

Result key: 10
Scenario 2 Affected station 12
Before Analysis

Results for: 34A WV HUNTINGTON USERRECORD01 APP
HAAT 360.0 m, ATV ERP 76.3 kW

	POPULATION	AREA (sq km)
within Noise Limited Contour	782508	17742.8
not affected by terrain losses	745325	16928.9
lost to NTSC IX	0	0.0
lost to additional IX by ATV	6960	298.1
lost to ATV IX only	6960	298.1
lost to all IX	6960	298.1

Potential Interfering Stations Included in above Scenario 2

34A OH CINCINNATI	BLEDT	20061031AAR	LIC
34A OH CLEVELAND	BLCDT	20031030AGJ	LIC
34A PA JOHNSTOWN	BPCDT	20080619ADU	CP
34A TN KNOXVILLE	BPCDT	20080619ABZ	CP

Result key: 11
Scenario 3 Affected station 12
Before Analysis

Results for: 34A WV HUNTINGTON USERRECORD01 APP
HAAT 360.0 m, ATV ERP 76.3 kW

	POPULATION	AREA (sq km)
within Noise Limited Contour	782508	17742.8
not affected by terrain losses	745325	16928.9
lost to NTSC IX	0	0.0
lost to additional IX by ATV	6815	286.0
lost to ATV IX only	6815	286.0
lost to all IX	6815	286.0

Potential Interfering Stations Included in above Scenario 3

34A OH CINCINNATI	BLEDT	20061031AAR	LIC
34A OH CLEVELAND	BPCDT	20090629ACU	CP
34A PA JOHNSTOWN	BPCDT	20080619ADU	CP
34A TN KNOXVILLE	BMLCDT	20040706ABG	LIC

KESSLER AND GEHMAN ASSOCIATES, INC.

507 NW 60th St. Ste C, Gainesville, FL 32607

OET69 Allocation Study

WPBY-TV
Huntington, WV

Result key: 12
Scenario 4 Affected station 12
Before Analysis

Results for: 34A WV HUNTINGTON USERRECORD01 APP

HAAT 360.0 m, ATV ERP 76.3 kW

	POPULATION	AREA (sq km)
within Noise Limited Contour	782508	17742.8
not affected by terrain losses	745325	16928.9
lost to NTSC IX	0	0.0
lost to additional IX by ATV	6960	298.1
lost to ATV IX only	6960	298.1
lost to all IX	6960	298.1

Potential Interfering Stations Included in above Scenario 4

34A OH CINCINNATI	BLEDT	20061031AAR	LIC
34A OH CLEVELAND	BPCDT	20090629ACU	CP
34A PA JOHNSTOWN	BPCDT	20080619ADU	CP
34A TN KNOXVILLE	BPCDT	20080619ABZ	CP

#####

FINISHED FINISHED FINISHED FINISHED FINISHED FINISHED

