

Surveyor's Declaration

I, W. Kayle Cowherd, subject to the penalties of perjury, do declare the following:

- 1.) I am a licensed surveyor in the state of: Georgia.
- 2.) I have provided professional services to Community Public Radio, Inc., permit tee of WNEE – FM, Patterson, Georgia, during the installation of the WNEE – FM directional antenna.
- 3.) I certify that the WNEE - FM directional antenna tower legs (A - B - C) have been oriented at the proper azimuth as detailed specifically in the "pattern certification" provided by SWR February 14, 2011, for the WNEE CP FCC File Number: BMPED-20100706GVQ.

Dated: March 3, 2011

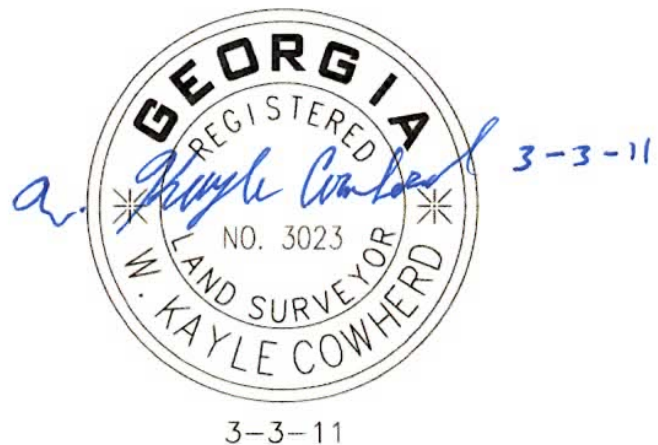

SURVEYOR SEAL STAMP, SIGN & DATE