

Channel Study

REFERENCE		CH# 294D - 106.7 MHz, Pwr= 0.25 kW, HAAT= 70.4 M, COR= 1242 M								DISPLAY DATES	
34 48 48.0 N.		Average Protected F(50-50)= 10.9 km								DATA 05-22-09	
102 23 42.0 W.										SEARCH 05-22-09	
CH CITY	CALL	TYPE ANT STATE	AZI. <--	DIST FILE #	LAT. LNG.	Pwr(kW) HAAT(M)	INT(km) COR(M)	PRO(km) LICENSEE	*IN* (Overlap in km)	*OUT*	
241D Hereford	K241AU	LIC C TX	0.0 0.0	0.00 BLFT20070504ACI	34 48 48.0 102 23 42.0	0.200	32.9	103.8 1242 Educational Media Foundati	9.5R	-9.5M	
292C2 Hereford	KPAN-FM	LIC CN TX	233.4 53.4	3.89 BLH19980930KA	34 47 33.0 102 25 45.0	30.000 67	4.1	39.3 1243 Kpan Broadcasters	-10.28*	-36.53*	
295C2 Plainview	KKYN-FM	LIC ZCN TX	132.7 313.1	89.97 BLH19990419KA	34 15 47.0 101 40 30.0	50.000 143	65.9	43.3 1172 Rhattigan Broadcasting (te	13.23	31.25	
296A Canyon	KPUR-FM	LIC CN TX	55.2 235.5	53.38 BLH19960722KB	35 05 09.0 101 54 48.0	6.000 96	2.6	26.5 1204 Cumulus Licensing Llc	38.23	25.78	
294D Clovis	638437	APP C NM	241.2 60.7	85.68 BNPFT20030317AGM	34 26 23.0 103 12 46.0	0.050	25.7	7.7 1377 Christina G. Benavides	49.84	43.81	
294A Borger	KQTY-FM	LIC C TX	43.1 223.7	133.30 BLH19990802KB	35 41 05.0 101 23 12.0	6.000 79	68.3	15.8 997 Zia Broadcasting Company	52.81	75.67	
293L1 Juilliard	KXZX-LP	LIC TX	41.4 221.7	77.78 BLL20041004AAR	35 20 14.0 101 49 42.0	0.082 33	4.3	3.0 1062 Comunidad Cristiana Of Ama	61.37	56.89	
293C2 Lubbock	KEJS	LIC CN TX	161.6 341.9	153.21 BLH19920323KC	33 30 08.0 101 52 20.0	34.000 179	76.7	52.0 1157 Barton Broadcasting Compan	65.56	85.72	

Terrain database is NGDC 30 SEC Distance + R = 73.215 or FCC spacings in KM, Distance + M = Margin in KM
Contour distances are on direct line to and from reference station. Reference Zone = 2. With 3rd Adj
Channels.

Ant Column: (D= DA Standard, Z= DA 73.215, N= Not DA 73.215, _= Omni), Polarization (C,H,V,E),
Beamtlt(Y,N,X)

***affixed to 'IN' or 'OUT' values = site inside protected contour. r.

Compliance with C.F.R. 74.1204

The proposed FM Translator is located within the protected 60 dBu contour of second adjacent channel station KPAN channel 292C2, Hereford, TX. The predicted F(50-50) field strength of KPAN at the proposed translator site is 100.9 dBu, (see Exhibit 12A-1). Therefore, the respective predicted interfering contour generated by the proposed FM Translator is 140.9 dBu. This interfering contour extends approximately 10 meters from the proposed transmit antenna, and the area of overlap does not reach the ground (the antenna will be mounted at the 82 meter level on a 98 meter tower).

To confirm the absence of population within the interference aperture, EMF has examined the attached topographic map (see Exhibit 12A-2), and site photo (see Exhibit 12A-3) which indicate a lack of structures near the proposed tower, and therefore no structure which could be tall enough to enter the 10 meter interference aperture.

Therefore, EMF respectfully requests a waiver of C.F.R 74.1204 based on no population within the area of predicted interference.

KPAN-FM

BLH19980930KA
Latitude: 34-47-33 N
Longitude: 102-25-45 W
ERP: 30.00 kW
Channel: 292
Frequency: 106.3 MHz
Pop Within 60 dBu
Contour: 17,472

K241AU

Latitude: 34-48-48 N
Longitude: 102-23-42 W
ERP: 0.25 kW
Channel: 294
Frequency: 106.7 MHz
AMSL Height: 1242.0 m
Elevation: 1160.0 m
Horiz. Pattern: Omni

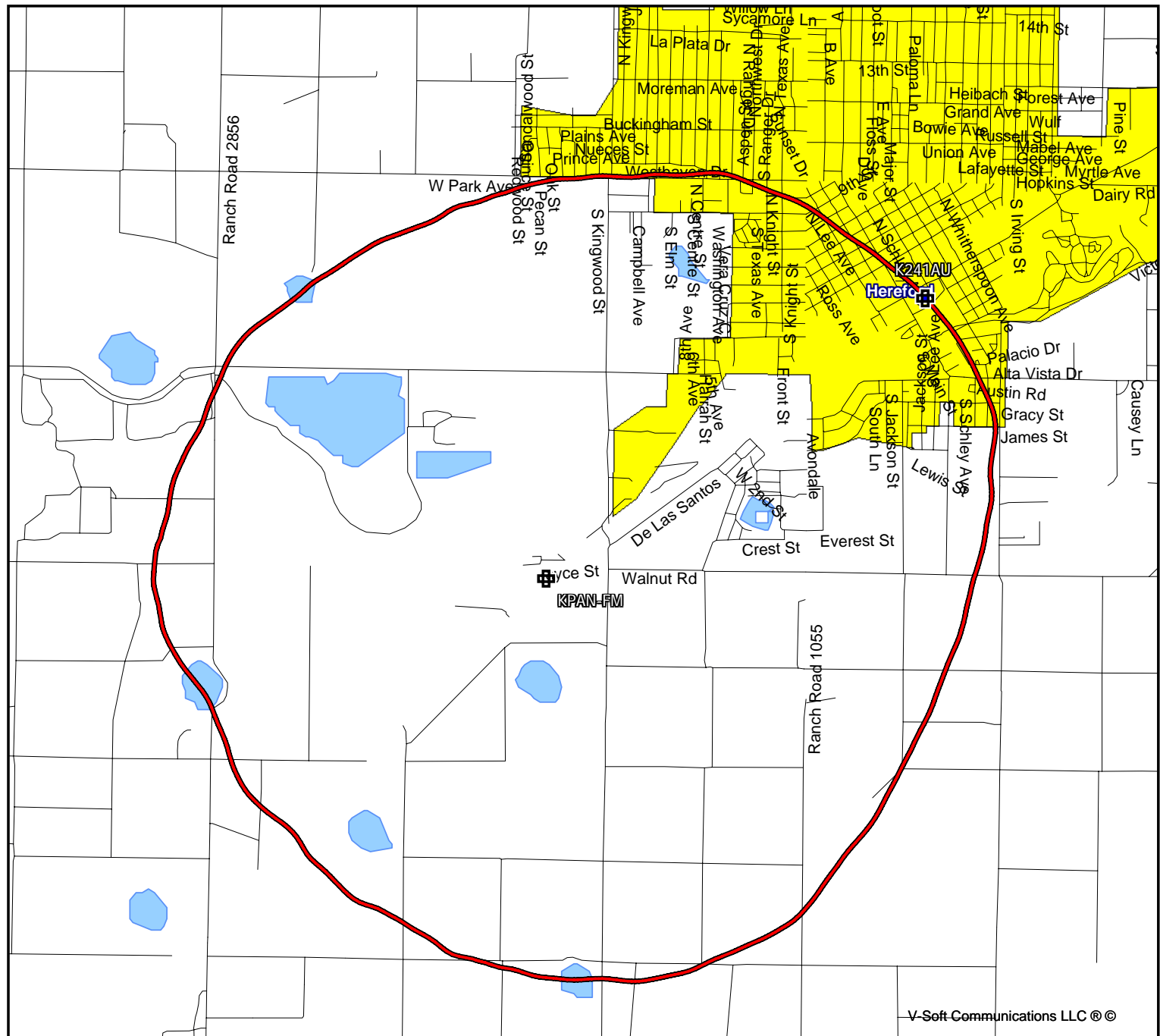

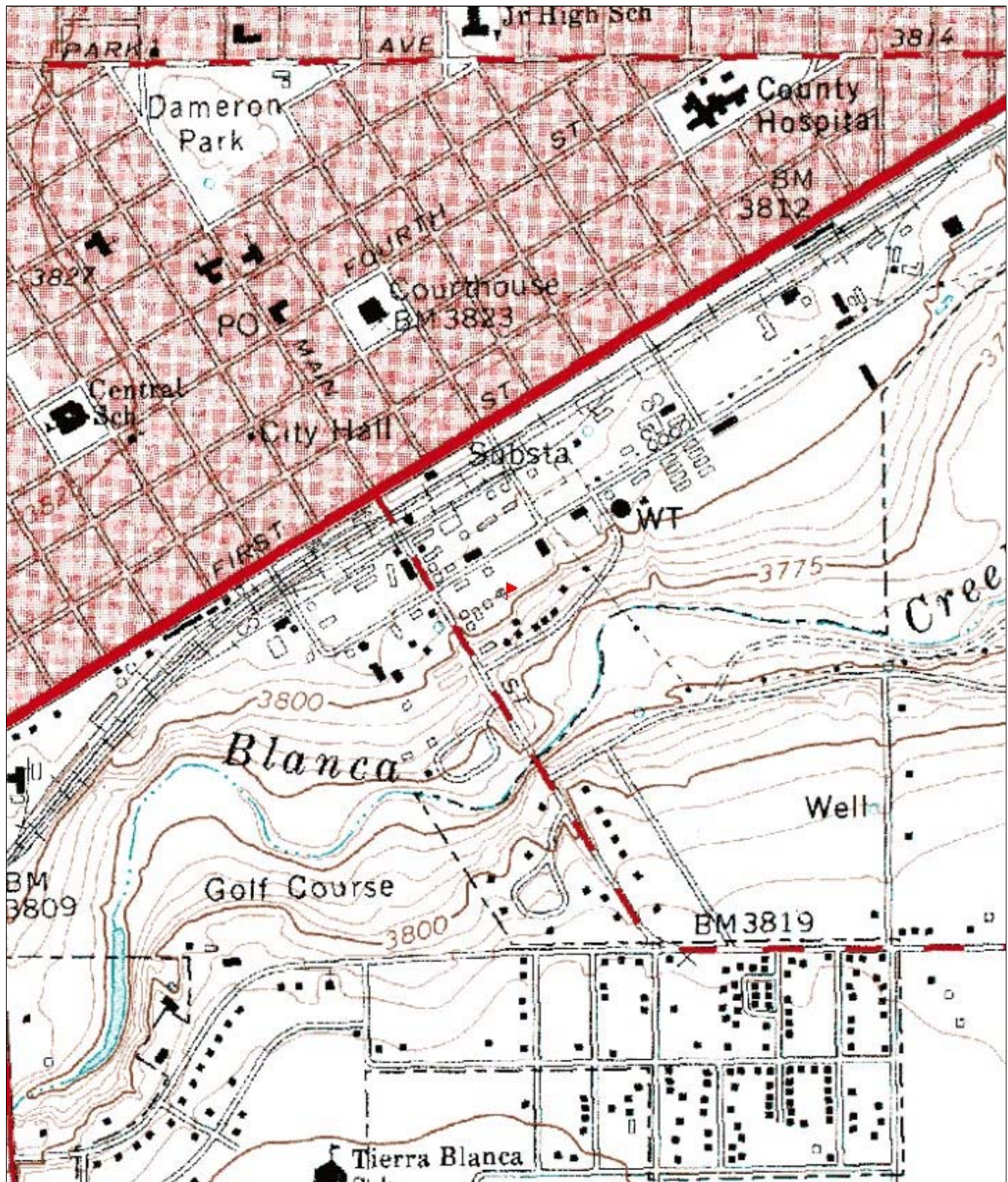

Tower ID: 1008259

Coordinates (NAD27): 34-48-47.78 N, 102-23-42.27 W

Coordinates (NAD83): 34-48-48 N, 102-23-44 W

