

Non-Interference Compliance

Regarding Facility id 154473

Channel 259

Description of Exhibit 12 Contents

This exhibit demonstrates that the proposed facility complies with contour overlap and interference protection provisions in all of the applicable rule sections and that this application for a construction permit is in full compliance with 47 C.F.R. § 74.1204.

Let it be noted that should any actual real world interference occur, the applicant acknowledges that it will promptly suspend operation of this translator in accordance with 47 C.F.R. § 74.1203.

Page 2 of this exhibit is an explanation of the method used to demonstrate compliance with contour overlap and interference provisions based on 47 C.F.R. § 74.1204(d), which states:

[A]n application otherwise precluded by this section will be accepted if it can be demonstrated that no actual interference will occur due to intervening terrain, lack of population or such other factors as may be applicable.

Page 3 of this exhibit contains the tabulated data from the interference analysis, which shows all stations whose protected contours come within 50 km of the 34 dBμ F(50,10) contour of the proposed translator. These tabulated values were calculated using data from the FCC's CDBS files and 30 arc second terrain data. The column labeled "Adj" shows the number of channels difference between the entry and the proposed translator. The column labeled "Dist" shows the distance in km. The column labeled "Overlap" shows the area of contour overlap in square kilometers.

Page 4 of this exhibit is a portion of a USGS 1:24,000 scale 7.5 minute quadrangle at full scale with the calculated area of interference overlaid. The sheet includes the quadrangle name and measurement scale at the bottom-left corner (note: "Mt" refers to meters). The area of interference was calculated using the free space equation and 120 radials.

Compliance with 47 C.F.R. § 74.1204(d)

All authorized second and third adjacent stations with which the proposed translator has contour overlap are tabulated below. Column four show the station's signal level at the proposed translator's tower site, and column five gives the minimum value within the entire standard interfering contour of the proposed translator (100 dBμ for most classes, 94 for class B, 97 for class B1). The minimum second or third adjacent F(50,50) contour within the proposed translator's standard interfering contour was used to calculate the proposed translator's actual "worst-case" interfering contour.

Application_id	File Number	Callsign	Contour at Tower	Min. Contour
596311	BLH20020313AAA	KTHX-FM	75.1	74.7
597618	BXMLH20020314AAG	KTHX-FM	66.2	66.1
93329	BLFT19861014TO	K257CW	66.4	66.3
Minimum F(50,50) Contour of Adjacent Station within Proposed Translator's Standard Interfering Contour				66.1

FCC 02-244 at Section II.A.5 states that "when demonstrating that 'no actual interference will occur due to . . . other factors,' pursuant to Section 74.1204(d), an applicant may use the undesired-to-desired signal ratio method." The undesired-to-desired ratio for second and third adjacent stations required by § 74.1204(a) is 40 dB. Since the minimum protected contour strength within the proposed translator's standard interference contour is **66.1 dBμ**, this makes the proposed translator's worst-case interfering contour **106.1 dBμ**. By the free-space equation, this contour is calculated to extend a maximum of **85.1 m** from the transmit antenna.

The interfering contour of the proposed translator was calculated for 120 radials and plotted on the pertinent portion of a USGS quadrangle (page 4 of this exhibit). As demonstrated on the quadrangle, there are no populated structures or highways within the area of interference (Note: FCC 02-244 at Section II.A.6 states that USGS quadrangles "have been recognized as acceptable to demonstrate lack of population"). Hence, in accordance with 47 C.F.R. § 74.1204(d) and the clarification provided by the FCC in the decision *Re: Living Way Ministries* (FCC 02-244), a lack of population has been demonstrated within the area of interference and this application is therefore in full compliance with 47 C.F.R. § 74.1204.

Antenna Manufacturer: JAMPRO
Antenna Model: J LLP-1
CORAGL: 21 m
Maximum ERP: 0.006 kW
Interfering Contour: 106.1 dBμ
Max Int. Contour Distance: 85.1 m

Adjacent Channel Study **For Station NEW, Facility_id: 154473**

Co-channel through third adjacent:

Application_id	Facility_id	Prefix	ARN	Call	Licensee	Class	City	State	Status	ERP	RCAMSL	Channel	Adj	Dist	Overlap
93329	203	BLFT	19861014TO	K257CW	AMERICOM LAS VEGAS LIMITED PARTNSHIP	D	VERDI	NV	LIC	0.021	2434	257	2	11.8	0.0358
597618	48685	BXMLH	20020314AAG	KTHX-FM	NM LICENSING, LLC	C2	DAYTON	NV	LIC	0.35	2988	261	2	31.2	0.0358
596311	48685	BLH	20020313AAA	KTHX-FM	NM LICENSING, LLC	C1	DAYTON	NV	LIC	12	2307	261	2	37	0.0358
504476	86398	BLFT	20000621AEW	K259AK	CALVARY CHAPEL OF TWIN FALLS, INC.	D	CARSON CITY	NV	LIC	0.019	1830	259	0	41.3	0
647685	154465	BNPFT	20030317IBA	NEW	EDGEWATER BROADCASTING, INC.	D	CARSON	NV	APP	0.01	2216	258	1	54.1	0
976688	86398	BPFT	20040120ABP	K259AK	CALVARY CHAPEL OF TWIN FALLS, INC.	D	CARSON CITY	NV	APP	0.01	2798	258	1	60.6	0
999668	9136	BPH	20040227ABC	KCMY	JERRY EVANS	C3	GARDNERVILLE-MINDEI	NV	CP	25	1620	256	3	69.5	0
269680	9136	BLH	19980612KA	KCMY	CARSON VALLEY RADIO, INC.	A	GARDNERVILLE-MINDEI	NV	LIC	3	1620	256	3	69.5	0
641407	148586	BNPFT	20030317GEB	NEW	EASTERN SIERRA BROADCASTING	D	SOUTH LAKE TAHOE	CA	APP	0.205	2015	258	1	81.9	0
148779	36244	BMLH	19900529KB	KVLV-FM	LAHONTAN VALLEY BROADCASTING CO.	A	FALLON	NV	LIC	3.7	1289	257	2	85.2	0
614220	70676	BLED	20021003ABA	KLVS	EDUCATIONAL MEDIA FOUNDATION	B1	GRASS VALLEY	CA	LIC	13	1160	257	2	100.1	0

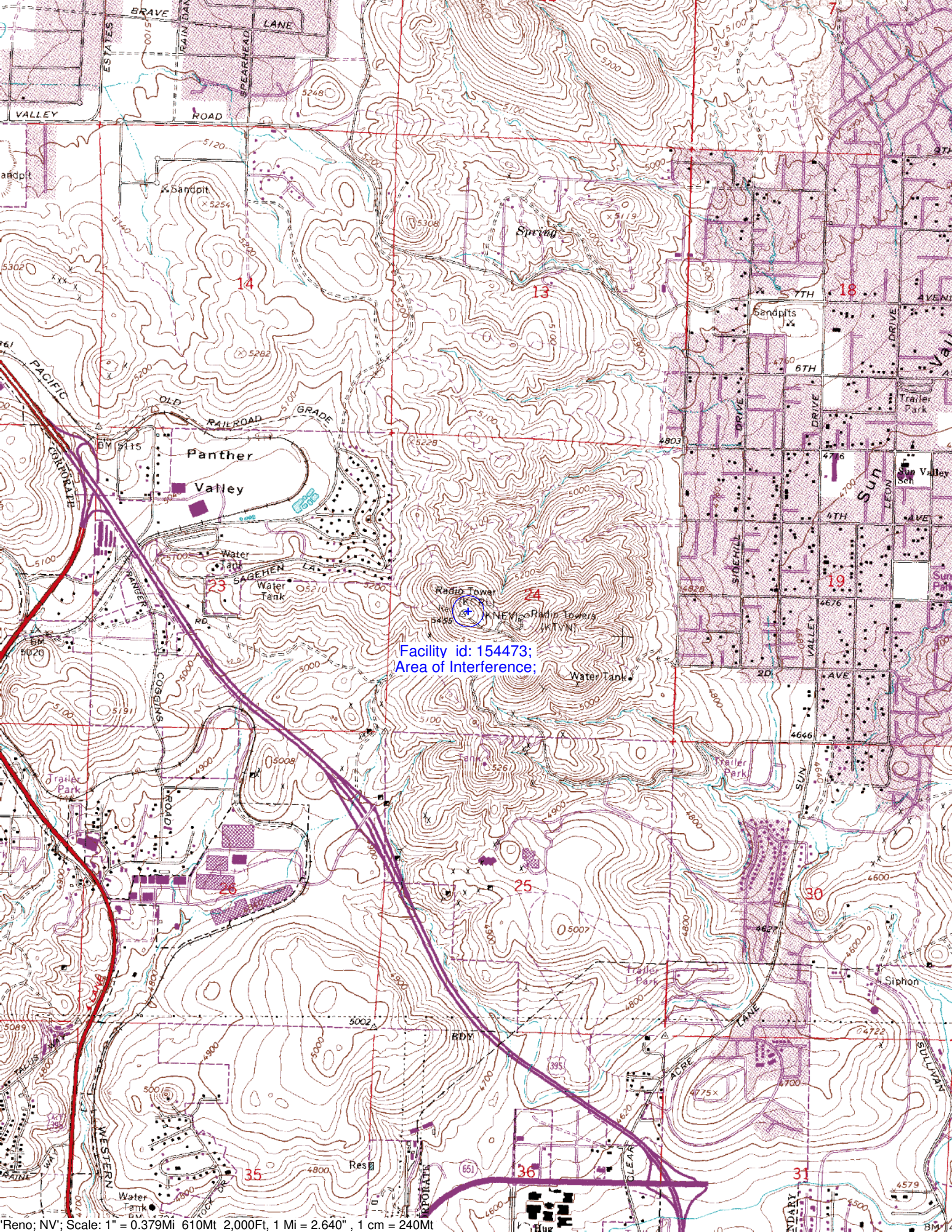

Facility id: 154473;
Area of Interference;