



ANALYSIS
PLANNING
SURVEYING
ENGINEERING

2952 Mendocino Avenue, Suite C
Santa Rosa, California 95403

(Office) 707-578-3433
(Fax) 707-526-3433

June 4, 2007

**Re: KRGP JENNER TOWER SITE
SITUATED NORTH FROM THE TOWN OF MONTE RIO
IN SONOMA COUNTY, CALIFORNIA**

On June 4, 2007, Dimensions 4 Engineering observed the orientation of the radio antenna in the field at the above referenced tower site at 21789 Siri Road, Monte Rio, California.

Dimensions 4 Engineering observed the direction of the radio antenna relative to the tower face on the tower. Dimensions 4 Engineering observed that the antenna was directed toward a true bearing of North 40° East (same direction being a north azimuth of 40°).

Please contact me at 707-578-3433 x 105 if I can further assist you.

I declare under penalty of perjury that to my knowledge that the foregoing is true and correct.

Douglas Lew Donmon
California Registered Professional Land Surveyor
No. 5111

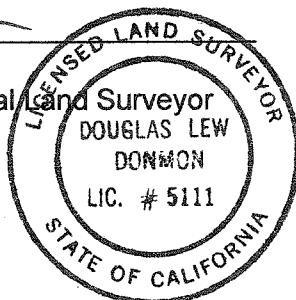

6/5/07
Date