

REFERENCE

33 52 04 N.

116 25 58 W.

CH# 270D

- 101.9 MHz,

Pwr= 0.01 kW,

HAAT=0.0 M,

COR= 496 M

DI SPLAY DATES

DATA 07-09-05

SEARCH 07-11-05

Exhibit 12

Cathedral City, CA

Average Protected F(50-50)= 3.15 km

Ave. F(50-10) 40 dBu= 10.2 54 dBu= 4.4 80 dBu= 1.6 100 dBu= .2

CH CITY	CALL	TYPE STATE	AZI. <--	DIST FILE #	LAT. LNG.	Pwr(kW) HAAT(M)	COR(M) INT(km)	PRO(km) LICENSEE	*IN* (Overlap in km)	*OUT*
270D Cathedral City	K270AI	APP DC CA	0.0 180.0	0.00 BPFT20050317ACK	33 52 04 116 25 58	0.010 358	496 37.2	11.0 Educational Media Foundati	-38.85*	-15.49*
270D Cathedral City	K270AI	LIC C CA	180.0 0.0	0.03 BLFT20050119AGF	33 52 03 116 25 58	0.010 -62	498 10.2	3.2 Educational Media Foundati	-20.10*	-36.89*
270A Twentynine Palms	AL270	VAC CA	46.1 226.1	47.19 RM10973	34 09 41 116 03 47	6.000 -127	844 68.3	15.8 Dana J. Puopolo	-22.68	26.55
272A Indio	KJJZ	LIC NCN CA	89.0 269.0	19.00 BLH19981124KE	33 52 14 116 13 39	2.600 507	820 3.3	49.4 R M Broadcasting L.L.C.	14.67	-30.41*
270B Mexicali	XHPFFM	OPE HN BN	145.9 325.9	163.68	32 38 37 115 27 09	14.800 47	43 92.4	33.6	65.92	98.58
270B Mexicali	ALLO	BN	145.9 325.9	163.68	32 38 37 115 27 09	50.000 162	158 139.3	66.6	19.02	65.67
267A Idyllwild	KATYFM	LIC CX CA	241.7 61.7	33.31 BLH20030115ABH	33 43 31 116 44 58	1.550 -370	1650 1.6	11.3 All Pro Broadcasting, Inc.	24.16	21.83
267D Palm Desert	AP267	APP DC CA	161.7 341.7	16.26 BNPFT20030317CTE	33 43 43 116 22 39	0.017 -69	66 0.3	3.6 Playa Del Sol Broadcasters	7.36	12.54
268D Palm Springs	K268AH	LIC VN CA	89.0 269.0	19.00 BLFT19970730TA	33 52 14 116 13 39	0.010 497	810 0.2	12.6 Family Stations, Inc.	17.71	6.44
269A Big Bear Lake	KXSB	LIC CN CA	314.0 134.0	55.41 BLH19951010KB	34 12 47 116 51 59	0.300 361	2616 39.1	25.8 Lazer Broadcasting Corpora	15.55	28.15
273A Hemet	AL273	VAC CA	255.2 75.2	53.10 RM	33 44 41 116 59 13	6.000 74	691 2.4	24.6	44.60	28.38
270B Glendale	KSCA	LIC CN CA	285.2 105.2	155.58 BLH19960228KA	34 13 26 118 03 45	4.800 856	1763 151.1	83.3 Uni vi si on Radio Li cense Co	2.21	57.74
271D Big Bear	AP271	APP C CA	316.6 136.6	59.23 BNPFT20030312ACB	34 15 15 116 52 32	0.013 -227	2176 4.8	3.4 Li vi ng Proof, Inc.	53.69	54.30
271B Encinitas	KPRI	LIC C CA	220.5 40.5	110.21 BLH19991101AFS	33 06 40 117 12 05	14.500 105	412 54.7	46.9 Compass Radio Of San Diego	45.08	41.44
272D Sunnymead	AP272	APP DC CA	276.9 96.9	62.89 BNPFT20030314ARV	33 56 03 117 06 29	0.013 -141	596 0.3	3.4 Fai th Pleases God Church C	58.54	59.47
272D Perris	AP272	APP V CA	264.9 84.9	81.73 BNPFT20030311ARZ	33 48 00 117 18 43	0.008 244	730 0.2	8.6 Penfold Communi cations, In	76.08	73.02
271B Encinitas	KPRI.A	APP CX CA	213.7 33.7	136.92 BPH20041013ABR	32 50 24 117 14 52	32.000 178	260 76.0	64.0 Compass Radio Of San Diego	51.18	52.44

ERP and HAAT are on direct line to and from reference station.

***affixed to 'IN' or 'Out' values = site inside protected contour.

Exhibit 12 (Compliance with CFR 74.1204)

The proposed FM Translator is located within the protected 60 dBu contour of second adjacent channel station KJJZ, channel 272A, Indio, CA. The predicted F(50-50) field strength of KJJZ at the proposed translator site is 77.6 dBu, see Exhibit 12A. Therefore, the respective predicted interfering contour generated by the proposed FM Translator is 117.6 dBu. This interfering contour extends less than 30 meters from the proposed transmit antenna, and the area of overlap is unpopulated.

Two factors have been investigated to determine this absence of population:

- 1) Computer software which uses the centroid method of determining population centers, based on the 2000 census data, has determined that there are no persons within the area of overlap.

- 2) Examination of the USGS topographic map reveals no regularly occupied structures within the area of overlap.

Therefore, EMF respectfully requests a waiver of C.F.R. 74.1204 based on no population within the area of predicted interference.

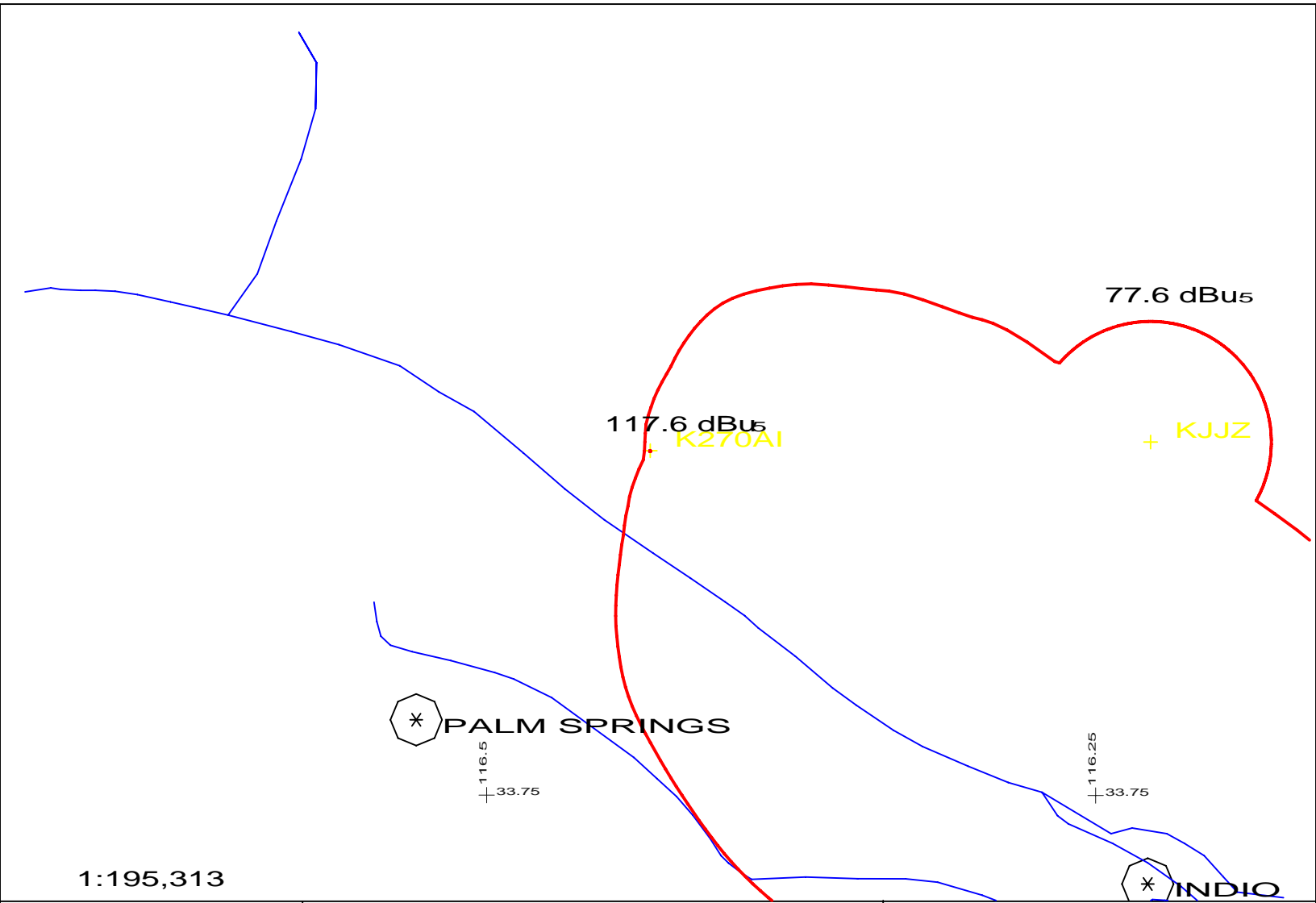

<p>Scale in km</p> <p>0 10</p>	<p>K270AI 270D .01kW 496M AMSL</p> <p>N. Lat. 33 52 04 W. Lng. 116 25 58</p>	<p>Exhibit 12A</p> <p>EMF - 07/05</p>
--------------------------------	--	---------------------------------------

03-03-2005
InterDLG (C)

Bearing	Field Value
000	0.202
010	0.234
020	0.250
030	0.260
040	0.250
050	0.234
060	0.202
070	0.142
080	0.065
090	0.046
100	0.037
110	0.032
120	0.030
130	0.045
140	0.187
150	0.388
160	0.570
170	0.715
180	0.829
190	0.920
200	0.979
210	1.000
220	0.979
230	0.920
240	0.829
250	0.715
260	0.570
270	0.388
280	0.187
290	0.045
300	0.030
310	0.032
320	0.037
330	0.046
340	0.065
350	0.142

