

Exhibit12
Lubbock, TX

REFERENCE CH# 256D - 99.1 MHz, Pwr= 0.25 kW, HAAT=58.0 M, COR= 1007 M DISPLAY DATES
33 35 53 N Average Protected F(50-50)= 10.02 km DATA 11-18-04
101 47 50 W Ave. F(50-10) 40 dBu= 33.5 54 dBu= 13.9 80 dBu= 3.1 100 dBu= 1.1 SEARCH 11-22-04

CH CITY	CALL	TYPE STATE	AZI. <--	DIST FILE #	LAT. LNG.	Pwr (kW) HAAT (M)	COR (M) INT (km)	PRO (km) LICENSEE	*IN* (Overlap in km)	*OUT*
258C1 Lubbock	KQBR	LIC CN TX	211.9 31.9	10.46 BLH19860127KF	33 31 05 101 51 25	100.000 259	1224 9.4	69.0 Capstar Tx Limited Partner	-6.38	-59.67*
256D Lubbock	K256AX	CP C TX	171.3 351.3	7.17 BNPFT20030818AEC	33 32 03 101 47 08	0.170 90	1062 38.1	11.2 Educational Media Foundati	-40.54*	-36.07*
203D Lubbock	K203CB	LIC DCN TX	177.4 357.4	14.28 BLFT19971113TC	33 28 10 101 47 25	0.060 65	1021 7.3	7.3 Christian Broadcasting Com	3.2R	11.1M
255A Floydada	AL255	VAC TX	44.1 224.1	64.73 RM10501	34 00 54 101 18 29	6.000 97	1059 43.1	27.9 Linda Crawford	14.07	26.07
254D Littlefield	K254AU	CP C TX	304.8 124.8	59.32 BNPFT20030812ADX	33 54 05 102 19 28	0.170 129	1174 0.9	13.2 Family Life Broadcasting,	51.31	44.98
203A Brownfield	KPBB	LIC CN TX	222.5 42.5	66.63 BLED19981013KB	33 09 18 102 16 51	4.500 112	1118 30.0	27.9 Paulino Bernal Evangelism	10.0R	56.6M
253D Plainview	AP253	APP C TX	3.6 183.6	65.45 BNPFT20030314CAV	34 11 13 101 45 08	0.250 65	1086 1.1	10.6 Family Life Broadcasting,	57.25	53.77
203A Plainview	KPMB	LIC C TX	6.3 186.3	69.47 BLED19991229AAV	34 13 14 101 42 52	3.000 96	1116 24.9	23.7 Paulino Bernal Evangelism	10.0R	59.5M
203A Plainview	KPMB.C	CP CN TX	6.3 186.3	69.47 BMPED19990525IC	34 13 14 101 42 52	3.000 96	1116 24.9	23.7 Paulino Bernal Evangelism	10.0R	59.5M
253D Plainview	AP253	APP C TX	6.8 186.8	67.93 BNPFT20030313BFE	34 12 22 101 42 33	0.250 65	1084 1.1	10.6 Educational Media Foundati	59.74	56.26

ERP and HAAT are on direct line to and from reference station.
***Affixed to 'IN' or 'Out' values = site inside protected contour.

Exhibit 12 (Compliance with CFR 74.1204)

The proposed FM Translator is located within the protected 60 dBu contour of second adjacent channel station KQBR, channel 222B, Cleveland Heights, OH. The predicted F(50-50) field strength of KQBR at the proposed translator site is 98.1 dBu, see Exhibit 12A. Therefore, the respective predicted interfering contour generated by the proposed FM Translator is 138.1 dBu. This interfering contour extends less than 14 meters from the proposed transmit antenna, and the area of overlap does not reach the ground (the antenna will be mounted at the 30 meter level on a 55 meter tower).

To confirm the absence of population within the interference aperture, EMF has examined the attached topographic map, which indicates a lack of structures near the proposed tower, and therefore no structure which could be tall enough to enter the 14-meter interference aperture.

Therefore, EMF respectfully requests a waiver of C.F.R. 74.1204 based on no population within the area of predicted interference.

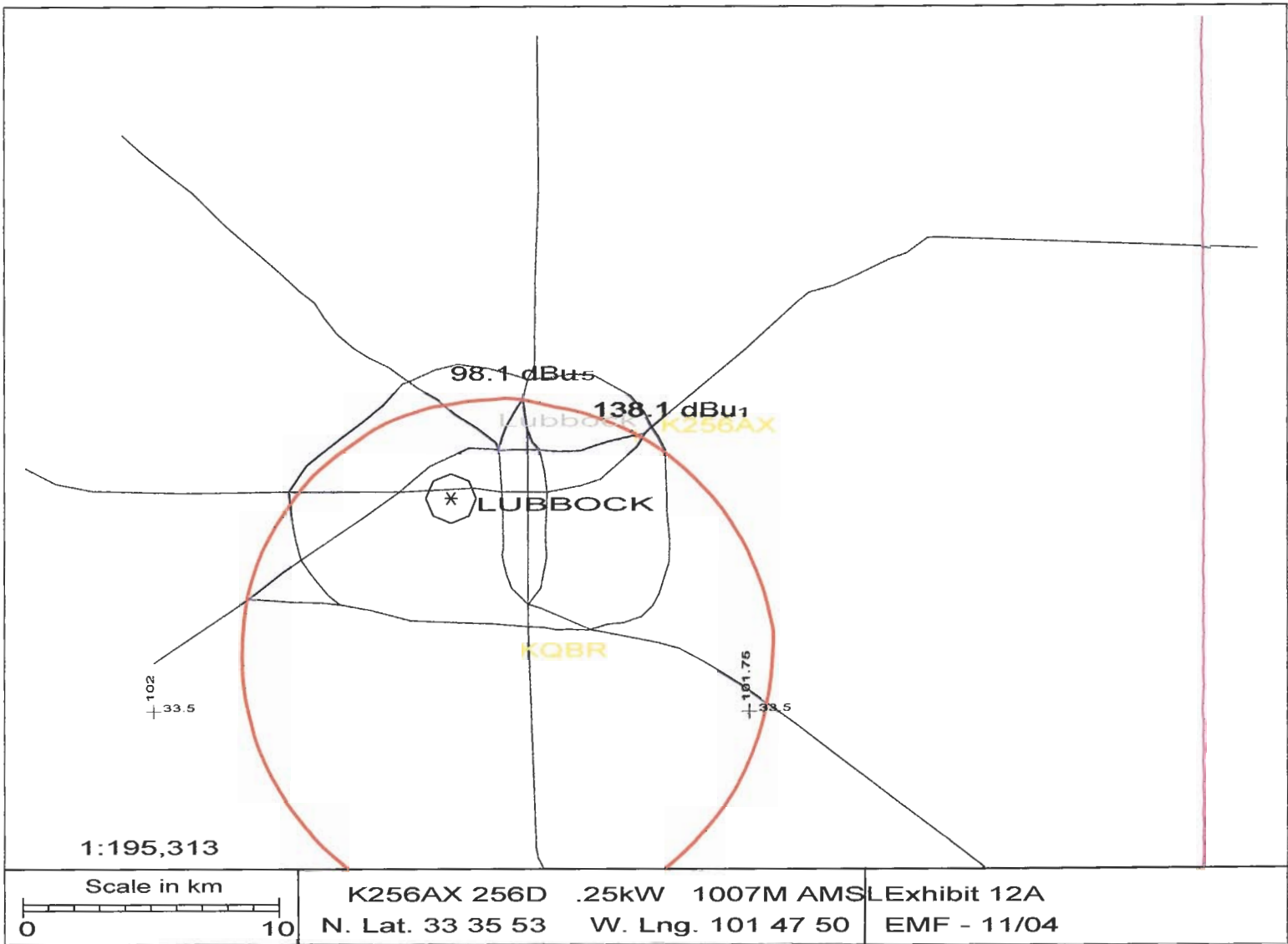

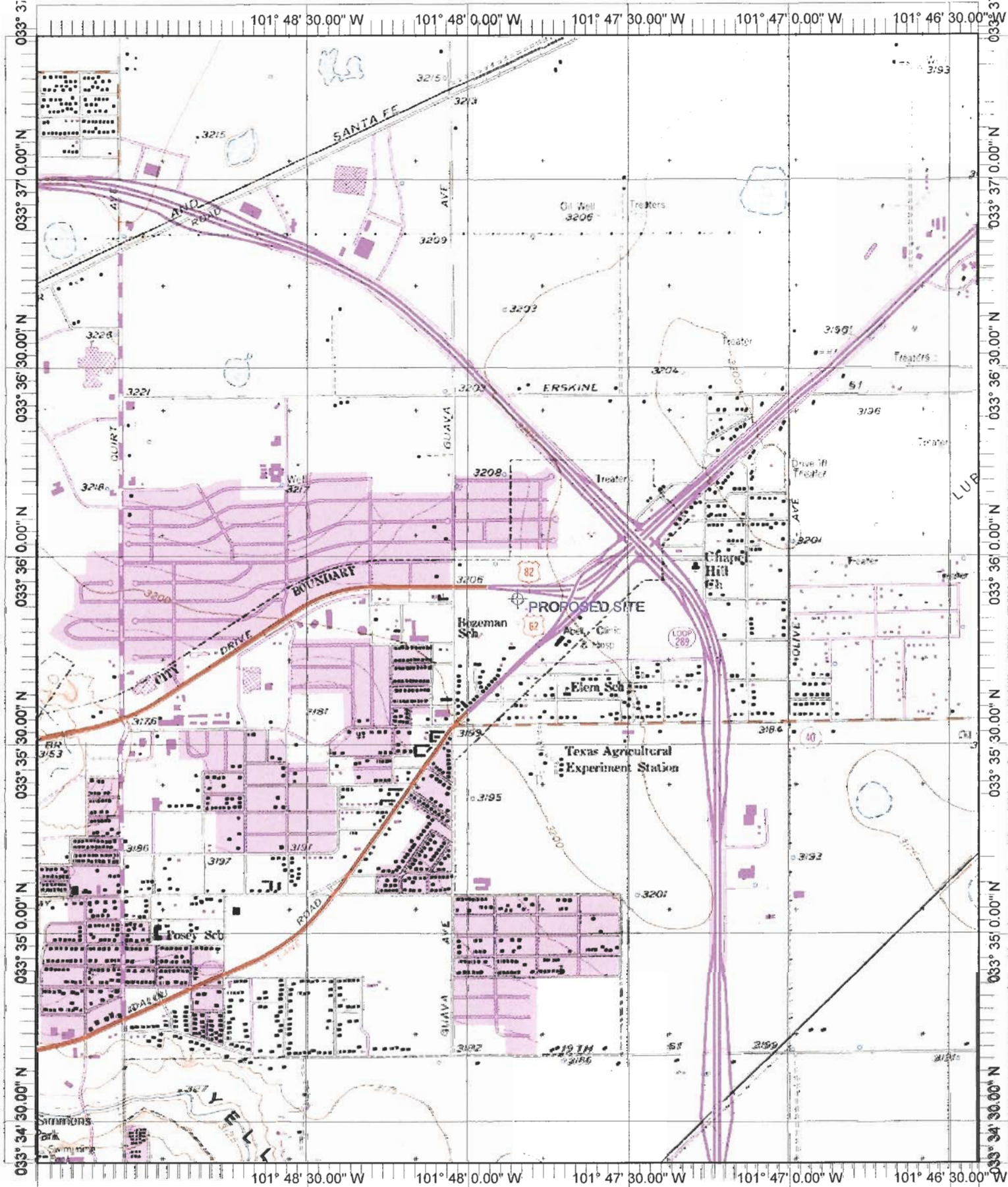

Name: LUBBOCK EAST
 Date: 11/22/2004
 Scale: 1 inch equals 2000 feet

Location: 033° 35' 53.1" N 101° 47' 52.6" W
 Caption: Exhibit 12
 Site 33-35-53 / 101-47-50