

[Exhibit 12]

Non-Interference Compliance

Regarding FCC File Number: BNPFT-20030317ENK

Channel: 261

Description of Exhibit 12 Contents

This exhibit demonstrates that the proposed facility complies with contour overlap and interference protection provisions in all the applicable rule sections and that this application for a construction permit is in full compliance with 47 CFR 74.1204.

Page 2 of this exhibit is an explanation of the tabulated data, which is included as evidence on page 4 of this exhibit.

Page 3 of this exhibit is an explanation of the method used to demonstrate compliance with contour overlap and interference protection provisions based on 47 CFR 74.1204(d), which states:

"an application otherwise precluded by this section will be accepted if it can be demonstrated that no actual interference will occur due to intervening terrain, lack of population or such other factors as may be applicable."

In addition, page 3 includes a tabulation of the second and third adjacent stations which this application is required to protect and the field strengths of those stations in the vicinity of the proposed translator. The field strengths given were based on contours predicted using FCC contour algorithms and 3 arc second terrain data.

Let it be noted that should any actual real world interference occur, the applicant certifies that it will promptly suspend operation of this translator in accordance with 47 CFR 74.1203.

Page 4 of this exhibit is the tabulated data from the interference analysis, which shows all stations that this application had to consider for contour protection. These tabulated values were generated using high resolution 3 arc second terrain data for the best possible accuracy.

Page 5 of this exhibit is a portion of a USGS 1:24,000 scale 7.5 min quadrangle at full scale with the calculated area of interference overlayed. The sheet includes the quadrangle name and measurement scale at the bottom-left corner (note: "Mt" refers to meters). The area of interference was calculated using a free-space calculation (see FCC 98-117, Appendix A, pg. 41 for reference to the equation used).

Explanation of Frequency Finder Results

The interference analysis for this application was performed using the "Frequency Finder" module in RadioSoft's Comstudy, version 2.2.

Frequency Finder analyzes data taken directly from the FCC's FM database and looks for prohibited overlap with contours of adjacent stations and prohibited proximity to stations 53 or 54 channels from the proposed station (IF) using 3 arc second terrain data and the FCC's contour algorithms. The results tabulated are the stations returned from that analysis. (Note: Because Comstudy was looking at the FCC's FM database, it took into account the proposed translator when doing the analysis and returned it in the tabulated results. For the sake of simplicity, that record has been deleted from all tabulated results.)

The first several columns of the table are self-explanatory. They give various data on the stations in question. The column labeled "Clr" gives the proposed translator's "clearance" with respect to the tabulated station, either in dB or km. The values listed with no units are given in km and are for stations located on an IF to the proposed site's channel.

A negative value in the "Clr" column does NOT necessarily represent prohibited contour overlap, as explained below.

A negative value listed in the "Clr" column would indicate either overlap of interference and protected contours or prohibited proximity to an IF station except in the following situations:

- Since the proposed station's Effective Radiated Power (ERP) is 99 watts, a negative value in km (no units listed in the table) does not represent a violation of the CFR, according to 47 CFR 1204(g), which states that "FM translator stations and booster stations operating with less than 100 watts ERP will be treated as class D stations and will not be subject to intermediate frequency separation requirements."

- A second or third adjacent LP100 station cannot represent a violation of the CFR, as 47 CFR 74.1204(a)(4) requires protection of only co-channel and first adjacent LP100 stations.

- 47 CFR 74.1204(a) requires only the protection of "AUTHORIZED commercial or noncommercial educational FM broadcast stations, FM translators, ..." Any entry with a status listed as "RSV," "USE" or "APP" does not represent an authorized station and therefore is not protected under 47 CFR 74.1204. The one exception is the case of LP100 applications. The note to 47 CFR 74.1204(a)(4) states that "LPFM applications and permits that have not yet been licensed must be considered as operating with the maximum permitted facilities." Therefore, any first adjacent or co-channel LP100 station, no matter the status, is protected.

- Entries highlighted in red are those stations where there is overlap of predicted contours and lack of population has been demonstrated within the area of interference.

Compliance with 47 CFR 74.1204(d)

The proposed translator's Maximum Effective Radiated Power (ERP) is 0.099kW at 116 meters above ground level. According to 47 CFR, 74.1204(a), the desired to undesired ratio between 2nd/3rd adjacent stations is 40dB, making the proposed translator's interfering contour 113.2dBu F(50,10).

Using a free-space calculation (equation referenced in FCC 98-117, Appendix A, pg. 41), this proposed translator's F(50,10) interference contour was calculated and plotted on the pertinent portion of a USGS quadrangle (page 5 of this exhibit). As demonstrated on the quadrangle, there are no populated structures or highways within the calculated area of interference (Note: FCC 02-244, II, A, 6 states that USGS quadrangles are sufficient for demonstrating lack of population). Hence, in accordance with 47 CFR 74.1204(d) and the clarification provided by the FCC in the decision Re: Living Way Ministries (FCC 02-244), a lack of population has been demonstrated within the area of interference and therefore this application is in full compliance with 47 CFR 74.1204.

CORAGL:	116m	Antenna Manufacturer:	SCA
Maximum ERP:	0.099kW	Antenna Model:	CL-FM
F(50,10) Interfering Contour:	113.2dBu	Antenna Rotation:	220
F(50,10) Max Distance:	152.9m		

The F(50,50) signal strength of all relevant second and third adjacent stations have been examined, and are tabulated below. Column three shows the station's signal level at the proposed translator's tower site, and column four gives the minimum value within the entire proposed translator's standard F(50,10) contour (100 dBu for most classes, 94 dBu for class B's, 97 dBu for class B1's). For signal levels too great to determine, 999 was entered. The minimum F(50,50) contour within the proposed translator's standard F(50,10) contour was used to calculate the proposed translator's interference contour, thereby assuring a minimum undesired-to-desired ratio of 40dB for all relevant adjacent stations, as required in 47 CFR, 74.1204(a).

FCC File Number	Call Sign	F(50,50) Contour at Tower	Min. F(50,50) Contour
BLH20000419ACN	KBEA-FM	73.49dBu	73.19dBu
BLH19821227AK	KKRQ	99.38dBu	98.41dBu
Minimum F(50,50) Protected Contour of Adjacent Station Within Proposed Translator's standard F(50,10) Contour:			73.19dBu

Callsign	State	City	Channel	ERP_w	Licensee	ARN	Class	Status	Distance_km	Clr	Facility_id
KKRQ	IA	IOWA CITY	264	100000	CITICASTERS LICENSES, L.P.	BLH19821227AK	C1	LIC	7.42	-40.09 dB	29076
KBEA-FM	IA	MUSCATINE	259	100000	CUMULUS LICENSING CORP.	BLH20000419ACN	C1	LIC	41.13	-13.58 dB	13666
K261CA	IA	CEDAR RAPIDS	261	205	POWER DU PREE BROADCASTING C	BLFT19880711TB	D	LIC	44.54	0.41 dB	53216
KKRQ	IA	IOWA CITY	264	0	CITICASTERS LICENSES, L.P.		C1	USE	7.42	3.76 dB	29076
NEW	IA	MOLINE	261	99	EDUCATIONAL MEDIA FOUNDATION	BNPFT20030313BKZ	D	APP	70.1	12.70 dB	140538
KRUU-LP	IA	FAIRFIELD	261	100	FAIRFIELD YOUTH ADVOCACY, INC.	BNPL20010611AEO	LP100	CP	87.69	15.09 dB	133984
NEW	IA	MUSCATINE	262	92	EDGEWATER BROADCASTING INC.	BNPFT20030317EOC	D	APP	47.2	15.98 dB	152478
KMXD	IA	DES MOINES	262	100000	CITICASTERS LICENSES, L.P.	BMLH19980410KB	C	LIC	178.85	24.94 dB	51332
NEW	MO	KAHOKA	261	115	EDGEWATER BROADCASTING INC.	BNPFT20030317FXP	D	APP	143.06	25.67 dB	149116
KCWN	IA	NEW SHARON	260	25000	CROWN BROADCASTING COMPANY	BLH19951025KA	C3	LIC	110.56	25.76 dB	14627
WCCI	IL	SAVANNA	262	9600	CARROLL COUNTY COMMUNICATION	BLH19901204KG	B1	LIC	119.88	29.64 dB	9119
NEW	MO	KAHOKA	261	40	EDGEWATER BROADCASTING INC.	BNPFT20030828BDN	D	APP	143.06	29.49 dB	149116
NEW	IA	BURLINGTON	262	250	AMERICAN FAMILY ASSOCIATION	BNPFT20030311AOD	D	APP	88.05	29.01 dB	142571
WKAI-FM	IL	MACOMB	261	11500	WPW BROADCASTING, INC.	BPH20030806ACM	B1	APP	153.43	31.30 dB	60016
WKAI-FM	IL	MACOMB	261	11500	WPW BROADCASTING, INC.	BPH20030806ACM	B1	APP	153.43	31.30 dB	60016
KBEA-FM	IA	MUSCATINE	259	0	CUMULUS LICENSING CORP.		C1	USE	43.64	35.19 dB	13666
KMEM-FM	MO	MEMPHIS	263	25000	BOYER BROADCASTING COMPANY,	BLH19951113KG	C3	LIC	146.16	37.00 dB	6584
NEW	IL	GALVA	261	13	EDGEWATER BROADCASTING INC.	BNPFT20030826AII	D	APP	135.57	36.18 dB	148784
NEW	IL	GALVA	261	13	EDGEWATER BROADCASTING INC.	BNPFT20030317ESZ	D	APP	135.57	36.18 dB	148784
WCOY	IL	QUINCY	258	100000	STARADIO CORPORATION	BLH20021125AAV	C1	LIC	196.12	37.64 dB	64844
KCTN	IA	GARNAVILLO	261	6000	DESIGN HOMES, INC.	BLH19970407KA	A	LIC	131.59	37.44 dB	16780
KCWN	IA	NEW SHARON	260	0	CROWN BROADCASTING COMPANY		C3	USE	109.5	39.04 dB	14627

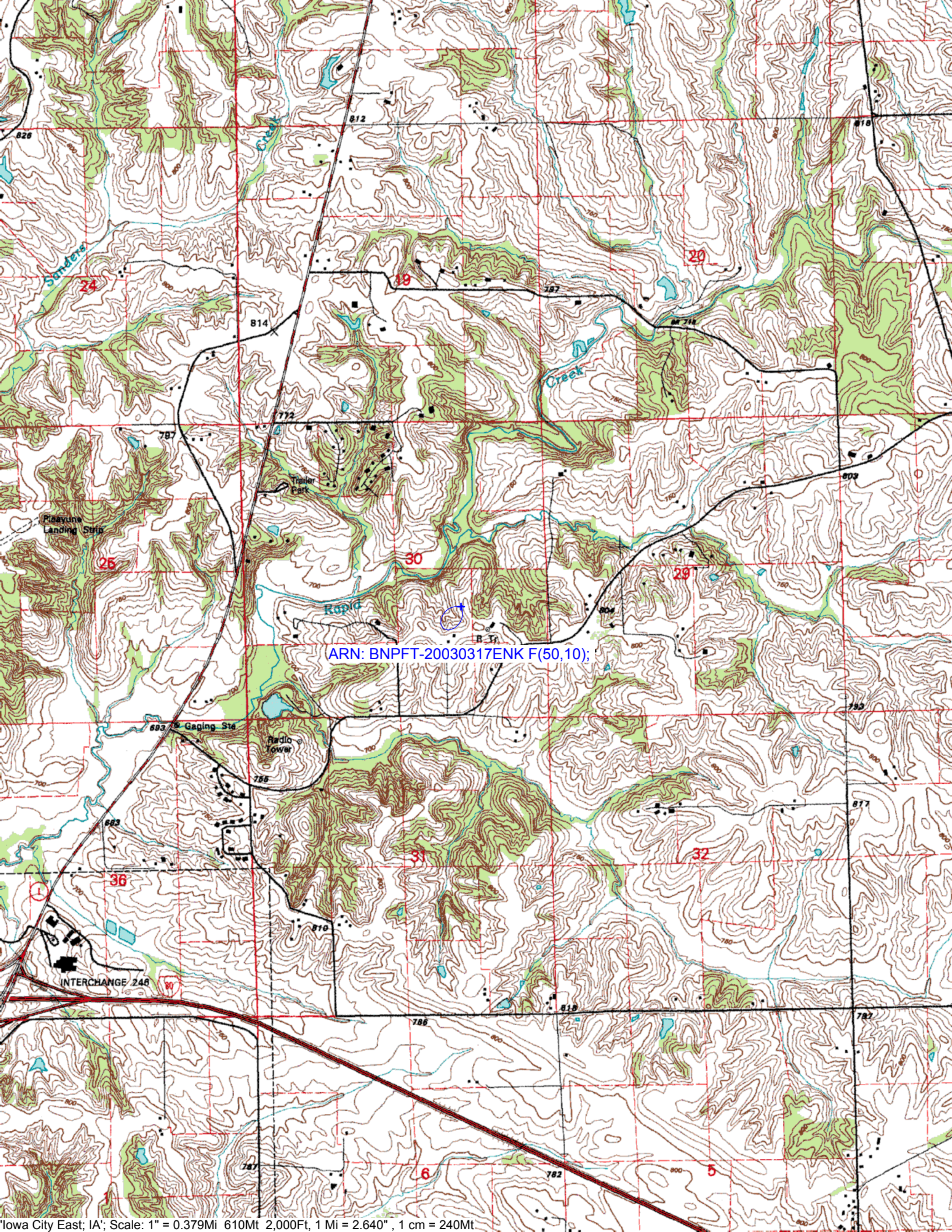

ARN: BNPFT-20030317ENK F(50,10);