

Exhibit 12
Richmond, OH

REFERENCE
39 50 13 N
84 52 27 W

CH# 269D - 101.7 MHz, Pwr= 0.027 kW, HAAT=70.9 M, COR= 355 M
Average Protected F(50-50)= 6.23 km
Ave. F(50-10) 40 dBu= 20.7 54 dBu= 8.9 80 dBu= 2.0 100 dBu= .4

DISPLAY DATES
DATA 04-02-05
SEARCH 04-11-05

CH CITY	CALL	TYPE STATE	AZI. <--	DIST FILE #	LAT. LNG.	Pwr (kW) HAAT (M)	COR (M) INT (km)	PRO (km) LICENSEE	*IN* (Overlap	*OUT* in km)
269D Richmond	W269BP	CP C IN	0.0 180.0	0.00 BNPFT20030801AXC	39 50 13 84 52 27	0.027 46	365 16.4	5.1 Educational Media Foundati	-20.43*	-17.97*
267B Richmond	RDEL	DEL IN	258.8 78.8	5.09	39 49 41 84 55 57	50.000 153	464 6.0	65.4 Rodgers Broadcasting Corp.	-6.23*	-61.07*
267B Richmond	WFMG	LIC CN IN	258.8 78.8	5.09 BLH19970826KC	39 49 41 84 55 57	50.000 83	394 4.4	53.5 Rodgers Broadcasting Corpo	-4.64*	-49.11*
267B1 Richmond	RADD	ADD IN	320.3 140.3	11.88	39 55 09 84 57 47	25.000 120	431 4.4	48.0 Rodgers Broadcasting Corp.	3.43	-36.59*
269D Muncie	W269BC	LIC C IN	307.2 127.2	59.61 BLFT20040311AAU	40 09 35 85 25 55	0.010 5	314 10.2	3.2 Indiana Community Radio Co	45.43	43.57
269A Elwood	WURK	LIC CN IN	300.4 120.4	97.38 BLH19920616KC	40 16 33 85 51 44	3.000 104	362 76.6	24.6 Indiana Sabrecom, Inc.	16.57	59.25
269A Elwood	WURK.A	APP DCX IN	300.4 120.4	97.38 BPH20050302ADT	40 16 33 85 51 44	6.000 104	362 87.3	28.8 Indiana Sabrecom, Inc.	5.87	55.12
269A Urbana	WKSW	LIC NCN OH	75.6 255.6	97.41 BLH19950324KD	40 02 57 83 46 06	3.200 129	453 81.8	27.5 Blue Chip Broadcasting Lic	11.59	57.06
270B Cincinnati	WKRQ	LIC C OH	158.1 338.1	86.17 BLH19991004ABU	39 06 59 84 30 07	16.000 254	483 75.5	64.2 Infinity Radio Inc.	6.66	13.87
266D West Chester	W266BB	CP DC OH	134.1 314.1	59.51 BNPFT20030828BHN	39 27 48 84 22 37	0.011 40	291 0.2	3.7 Citicasters Licenses, L.p.	55.26	55.45
268D Centerville	WCWTFM	LIC CN OH	110.4 290.4	66.44 BLED19880819KD	39 37 38 84 08 54	0.009 75	334 6.9	4.9 Centerville City Board Of	55.54	55.78
268D Beavercreek	W268AX	CP DC OH	98.6 278.6	67.27 BNPFT20030829AIC	39 44 39 84 05 53	0.001 61	311 3.6	2.6 Bradlee J Beer	59.64	58.96
268B Columbus	WKKG	LIC CN IN	232.3 52.3	117.36 BLH19890619KA	39 11 12 85 57 00	50.000 165	354 80.2	66.9 White River Broadcasting C	31.22	38.57
270D Dayton	W270AT	CP C OH	91.9 271.9	72.83 BNPFT20030828AVI	39 48 43 84 01 27	0.007 33	284 4.3	3.0 Spirit Communications, Inc	64.53	64.05
272D Greensburg	AP272	APP C IN	223.5 43.5	76.28 BNPFT20030311ABA	39 20 18 85 29 06	0.050 14	315 0.5	4.7 Indiana Community Radio Co	69.56	71.20
272D Greensburg	AP272	APP C IN	223.4 43.4	76.28 BNPFT20030317ENI	39 20 14 85 29 01	0.120	301 0.8	5.9 The Trustees Of Indiana Un	69.24	70.02
268D Upland	AP268	APP C IN	321.1 141.1	83.21 BNPFT20030314AYU	40 25 02 85 29 31	0.250 20	288 10.1	7.1 Taylor University Broadcas	69.04	70.38
271D Pendleton	AP271	APP C IN	285.8 105.8	77.71 BNPFT20030314AJR	40 01 25 85 45 01	0.055 35	318 0.5	5.2 Horizon Christian Fellowsh	72.44	72.13

ERP and HAAT are on direct line to and from reference station.
"*"Affixed to 'IN' or 'Out' values = site inside protected contour.

Protected zones report for W269BP on channel 269 04-11-2005
N. Lat. 40 01 25 W. Lng. 85 45 01, ERP= 0.027 kw, HAAT= 70.9M

Station must coordinate with Canada. Distance = 271.2122 km.
Facility okay with respect to Mexico.
Facility is okay with respect to AM station towers.
Facility is okay with respect to FCC monitoring stations.
Facility is okay toward West Virginia Quiet Zone.
Facility okay toward Table Mountain.

- Disclaimers:
- 1. Only valid for distant (far field) calculations
 - 2. Not to be used for co-located or near-by sites because this spreadsheet is contour based rather than free-s
 - 3. See FCC policies for clarification of valid non-pop proof

EMF Translator ERP	27	Watts
Other station F(50,50) contour at EMF translator	137.7	dBu

Distance to EMF interfering contour 4.7 meters
(from center of EMF antenna)

Exhibit 12 (Compliance with CFR 74.1204)

The proposed FM Translator is located within the protected 60 dBu contour of second adjacent channel station WFMG, channel 267B, Richmond, IN. The predicted F(50-50) field strength of WFMG at the proposed translator site is 97.7 dBu, see Exhibit 12A. Therefore, the respective predicted interfering contour generated by the proposed FM Translator is 137.7 dBu. This interfering contour extends less than 5 meters from the proposed transmit antenna, and the area of overlap does not reach the ground (the antenna will be mounted at the 52 meter level on a 92 meter tower).

To confirm the absence of population within the interference aperture, EMF has examined the attached topographic map, which indicates a lack of structures near the proposed tower, and therefore no structure which could be tall enough to enter the 5-meter interference aperture.

Therefore, EMF respectfully requests a waiver of C.F.R. 74.1204 based on no population within the area of predicted interference.

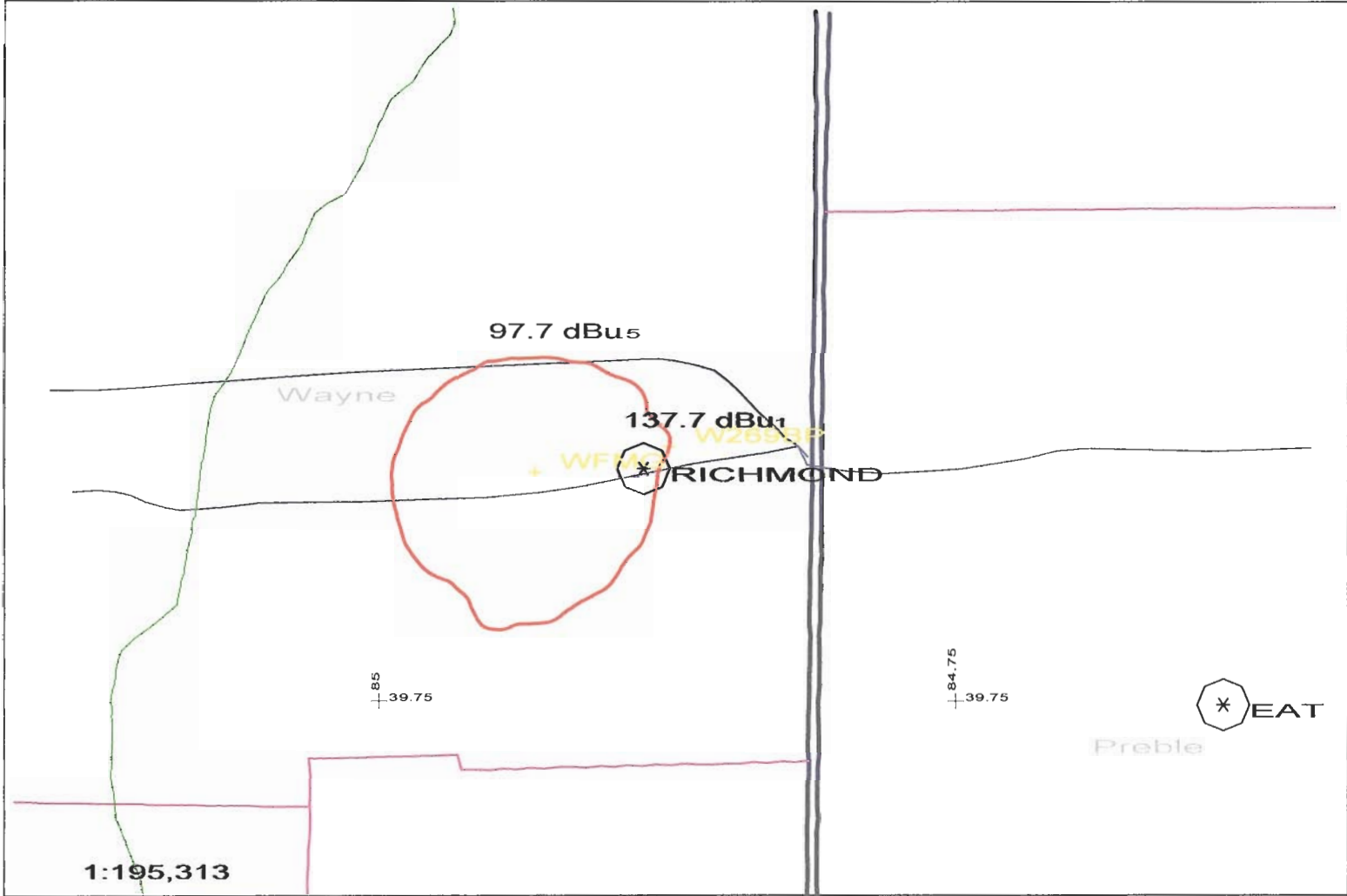

<p>Scale in km</p> <p>0 10</p>	<p>W269BP 269D .027kW 355M AMS</p> <p>N. Lat. 39 50 13 W. Lng. 84 52 27</p>	<p>Exhibit 12A</p> <p>EMF - 04/05</p>
--------------------------------	---	---------------------------------------

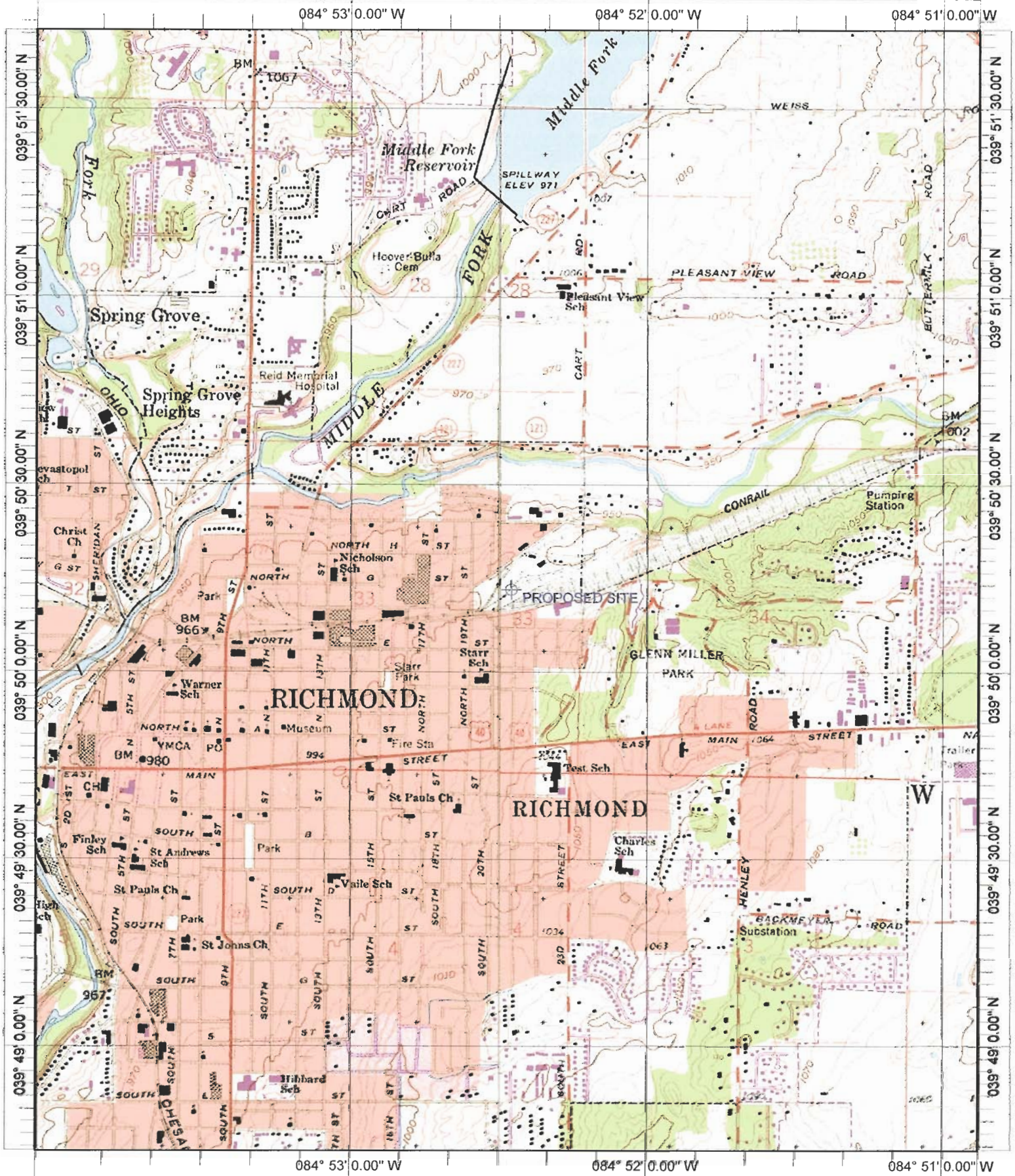

Name: NEW PARIS
 Date: 4/11/2005
 Scale: 1 inch equals 2000 feet

Location: 039° 50' 13.0" N 084° 52' 28.0" W
 Caption: Exhibit 12
 Site at 39-50-13 / 84-52-27