

**Standard Horizontal Pattern**  
Theoretical Pattern RMS = 2003.204  
Standard Pattern RMS = 2104.532  
RSS = 2671.1560 Q = 66.779

Radiation Nulls (Elevation = 0°)

Azimuth Theoretical Standard

359.1	24.339	75.375
28.6	2.985	70.188
156.6	35.748	79.333
289.3	3.921	70.239
351.9	38.489	88.842
272.4	28.992	76.985
304.9	69.827	101.438

Radiation Maxima (Elevation = 0°)

Azimuth Theoretical Standard

13.0	95.638	122.494
97.9	612.985	6419.818
183.6	325.087	579.914
221.3	188.935	128.716
252.8	272.718	284.814
287.1	161.011	183.825
335.3	198.601	220.804

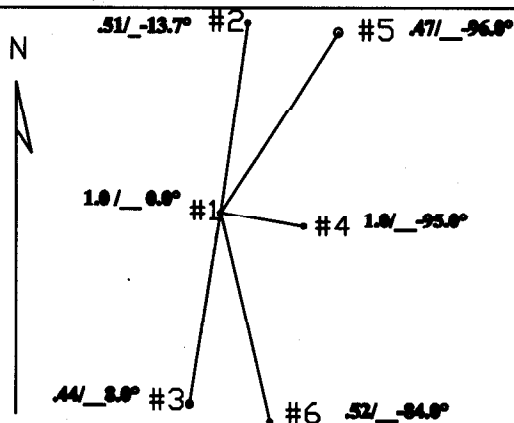

## Exhibit EE-5A

Proposed Standard Nighttime  
Horizontal Pattern

Proposed WIOJ  
1010 KHz DA-2-U 50/30 kW  
N.Lat 30° 17' 57"  
W.Lon 82° 00' 26"  
(NAD 1927)