

**Application for
Construction Permit for Minor
Changes to WSOH**

Channel 202, 88.3 MHz

New Washington, IN

Engineering Statement

Introduction

LifeTalk Radio, Inc., hereby applies for a Construciton Permit for minor changes to licensed facility WSOH, New Washington, IN. Specifically, we are applying to move the transmitter and antenna to new coordinates; and increase power. The change of coordinates is necessary because we have lost permission to use the property where our tower now sits. A new site has been located where we can move. This also affords us the opportunity to maximize the power output of our facility to get the most coverage possible of our station. All changes are considered minor under current FCC Rules and Regulations.

Interference Study

A detailed interference study was done to prove that the proposed minor changes to WSOH are permissible, and would not cause prohibited interference to any existing broadcast stations, Construction Permits, or Applications. Computer software by V-Soft Communications, written by Doug Vernier, and previously accepted by the FCC in matters of application, was used for this study. Exhibit 15A is a tabulated study of all affected allocations for this Application. This study shows that there would be no prohibited contour overlaps if this Application were granted. Further study was done on stations WNAS, New Albany, IN; WJIE, Okolona, KY; and applications for a new Class A station in Frankfort, KY. These results of these studies are included here, and are listed in the Exhibit Index on the next page.

Elevation & Contour Data

Exhibit 15B is a map showing the 60 dBu contour of the Proposed Modified facility, and the cardinal radials. Exhibit 15C shows the tabulated distances to the 60 dBu contour of the cardinal radials, and the average elevation along each radial, as well as the overall HAAT of the Proposed Facility.

List of Exhibits

1. 15 A: Interference Study

15 B: 60 dBu contour with cardinal radials.

15C: Tabulated Terrain and Contour Data

15D: Interference study of Proposed facility vs. WNAS, New Albany, IN.

15E: Interference study of Proposed facility vs WJIE, Okolona, KY

15F: Interference study of Proposed facility vs BPED19980409MA, Application for Class A station in Frankfort, KY.

15G: Interference study of Proposed facility vs BPED19980923MH, Application for Class A station in Frankfort, KY

15H: Expanded detail section of Exhibit 15G, showing interference contours of Proposed facility and BPED19980923MH.

15J: Expanded detail section of Exhibit 15F, showing interference contours of Proposed facility and BPED19980409MH.

15K: Expanded detail section of Exhibit 15E, showing interference contours of Proposed facility and WJIE, Okolona, KY.

WSOH Tower Move Exhibit 15A											
REFERENCE		CH#		202A - 88.3 MHz, Pwr= 1.2 kw, HAAT=78.0 M, COR= 285 M						DISPLAY DATES	
38 35 52 N				Average Protected F(50-50)= 16.99 km						DATA 05-07-03	
85 29 49 W		Ave. F(50-10)		40 dBu= 58.0 54 dBu= 25.1 80 dBu= 5.4 100 dBu= 1.6						SEARCH 05-14-03	
CH	CALL	TYPE		AZI.	DIST	LAT.	Pwr(kw)	COR(M)	PRO(km)	*IN*	*OUT*
CITY		STATE		<--	FILE #	LNG.	HAAT(M)	INT(km)	LICENSEE	(Overlap	in km)
202A	WSOH	LIC	CN	90.7	2.54	38 35 51	1.000	86	17.1	-71.79*	-72.26*
New	Washington	IN		270.7	BLED19941007KZ	85 28 04	86	57.7	Lifetalk	Radio, Inc.	
202A	980409	APP	DCN	128.6	68.46	38 12 44	0.045	57	6.4	28.33	0.77
Frankfort		KY		308.6	BPED19980409MA	84 53 07	57	61.3	American	Family Associatio	
202A	980923	APP	CN	129.2	69.88	38 11 57	0.300	-71	7.4	26.17	1.14
Frankfort		KY		309.2	BPED19980923MH	84 52 40	-71	61.3	Broadcasting	For The Chall	
203C2	WJIEFM	LIC	DEN	199.8	66.61	38 01 59	1.769	196	29.0	6.58	13.39
Okolona		KY		19.8	BLED19871208KE	85 45 16	196	24.2	Evangel	Schools, Inc.	
202B1	990311	APP	DEN	328.2	106.11	39 24 27	0.538	148	19.4	30.89	33.42
New Whiteland		IN		148.2	BPED19990311MS	86 08 52	148	53.3	Horizon	Christian F/ship O	
201A	WNAS	LIC	CN	219.7	43.12	38 17 56	2.850	44	15.8	1.42	0.52
New Albany		IN		39.7	BMLED19821217BN	85 48 45	44	26.8	New Albany-floyd	Cty.con.s	
202D	W202AZ	LIC	CN	128.6	68.46	38 12 44	0.019	44	4.5	35.44	2.64
Frankfort		KY		308.6	BLFT19970731TA	84 53 07	44	61.3	Bible	Broadcasting Network	
201A	WKRY	LIC	NVX	20.8	55.95	39 04 06	0.500	83	13.9	14.58	11.71
Versailles		IN		200.8	BLED20020830AAK	85 15 58	83	30.4	Good Shepherd	Radio Inc.	
202A	990310	APP	VN	328.6	104.81	39 24 03	4.000	50	18.6	21.13	33.25
Trafalgar		IN		148.6	BPED19990310MR	86 07 59	50	52.9	Broadcasting	For The Chall	
202A	980716	APP	VN	328.3	105.63	39 24 16	1.000	66	14.7	38.35	37.59
Trafalgar		IN		148.3	BPED19980716MS	86 08 37	66	53.3	Hoosier	Broadcasting Corpo	
202A	WAIF	LIC	CN	55.8	105.65	39 07 36	1.600	122	23.0	17.00	22.67
Cincinnati		OH		235.8	BMLED19920206KF	84 29 06	122	60.0	Stepchild	Radio Of Cincinn	
202B	WNINFM	CP	CX	246.7	169.46	37 59 01	16.000	266	52.1	24.75	57.16
Evansville		IN		66.7	BPED20011213ABP	87 16 13	266	60.2	Tri-state	Public Teleplex,	
202B	WNINFM	LIC	CN	249.2	175.10	38 01 27	45.000	154	51.7	21.11	63.31
Evansville		IN		69.2	BLED19930921KE	87 21 43	154	60.1	Tri-state	Public Teleplex,	
202A	WJVS	LIC	CN	50.3	121.24	39 17 21	0.175	25	6.5	83.39	58.29
Cincinnati		OH		230.3	BLED1525	84 24 52	25	56.5	Great Oaks	Joint Voc. Sch.	

203B WMUB Oxford	LIC OH	DCN	29.4 209.4	122.70 BLED19940407KB	39 33 26 84 47 35	2.205 153	153 25.6	27.2 The Pres.& Trustees Of Mia	64.22	69.90
205D W205BT New Albany	CP IN	DCN	229.2 49.2	40.71 BPFT19981021TF	38 21 30 85 51 01	0.000 329	329 1.7	0.7 Educational Media Foundati	21.82	38.30
201C3 980922 Lexington	APP KY	DCN	125.4 305.4	106.71 BPED19980922MF	38 02 19 84 30 16	7.900 107	107 26.0	31.2 University Of Kentucky	40.87	49.57
201A WMBL Mitchell	LIC IN	V	282.1 102.1	90.98 BLED20010904AAA	38 45 50 86 31 15	1.000 124	124 25.9	20.7 The Moody Bible Institute	42.80	44.30
255B WZKF Salem	LIC IN	CN	238.7 58.7	49.55 BLH19931119KG	38 21 56 85 58 55	50.000 127	127 27.7	61.7 Clear Channel Broadcasting	15.0R	34.6M
201A WRFL Lexington	LIC KY	CN	125.4 305.4	106.71 BLED19880329KC	38 02 19 84 30 16	0.250 108	108 26.0	13.4 Un Of Kentucky Bd of Trust	68.99	67.37
205B1 WXVW.C Oolitic	CP IN	VN	296.2 116.2	94.48 BPED19981203MB	38 58 04 86 28 34	8.000 26	26 1.6	17.1 Good Samaritan Educational	75.73	75.82
202A 990714 Muncie	APP IN	VX	2.9 182.9	165.33 BPED19990714ME	40 05 06 85 23 52	0.200 74	74 50.8	10.6 Hymn Time, Inc.	115.51	103.91
201A WDFBFM Danville	LIC KY	CN	152.4 332.4	125.28 BLED19921106KC	37 35 46 84 50 19	0.170 131	131 27.5	13.3 Alum Springs Educational C	86.50	84.41
205C1 WEKU Richmond	LIC KY	CN	127.6 307.6	129.90 BMLLED19990407KA	37 52 45 84 19 33	50.000 200	200 1.7	57.4 Eastern Kentucky Universit	104.59	70.85
201A WJCF.A Morristown	APP IN	DVN	357.8 177.8	128.05 BPED20001018ABP	39 45 01 85 33 19	3.292 59	59 20.9	19.3 Indiana Community Radio Co	85.75	87.82

CH CITY	CALL	TYPE STATE	AZI. <--	DIST FILE #	LAT. LNG.	Pwr(kw) HAAT(M)	COR(M) INT(km)	PRO(km) LICENSEE	*IN* (Overlap	*OUT* in km)
201A Morristown	WJCF.C	CP IN	VN	357.8 177.8	128.05 BPED19980716MT	39 45 01 85 33 19	2.700 59	59 20.9	18.4 Indiana Community Radio Co	87.12 88.78
202C3 Glasgow	WSGP	LIC KY	CX	185.0 5.0	198.27 BLED20021023AAT	36 49 05 85 41 30	13.000 68	68 59.9	28.1 Somerset Educational Broad	86.26 110.31
205A Elizabethtown	AP205	APP OH	CN	40.6 220.6	89.87 BNPED19991115AAR	39 12 35 84 49 07	0.100 54	54 1.6	7.6 Redwood Valley Broadcaster	71.85 80.69
204B Batavia	WOB0	LIC OH	DEN	66.5 246.5	132.02 BLED19880202KB	39 03 43 84 05 50	5.938 154	154 1.6	34.5 Wcne Educational Community	111.26 95.90
205D Bedford	W205BB	LIC IN	CN	289.9 109.9	91.11 BLFT19980702TG	38 52 18 86 29 05	0.027 52	52 1.6	5.4 Bible Broadcasting Network	73.74 84.16
205A Harrison	AP205	APP OH	CN	40.1 220.1	97.73 BNPED19991116AIW	39 16 04 84 45 57	3.000 -12	-12 1.6	13.2 Broadcasting For The Chall	78.43 82.88
205A Miamitown	990325	APP OH	CN	42.7 222.7	101.00 BPED19990325MC	39 15 45 84 42 06	0.400 96	96 1.6	14.2 Spryex Communications, Inc	82.81 85.25
06Z1C Indianapolis	WRTV	LI IN	HY	337.5 157.5	156.75 BLCT20011203CES	39 53 58 86 12 02	100.000 307	307 256.0	104.2 Mcgraw-hill Broadcasting C	To Grd B= 52.58

 "*"Affixed to 'IN' or 'Out' values = site inside protected contour.
 ERP and HAAT are on direct line to and from reference station.

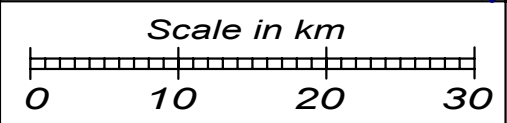
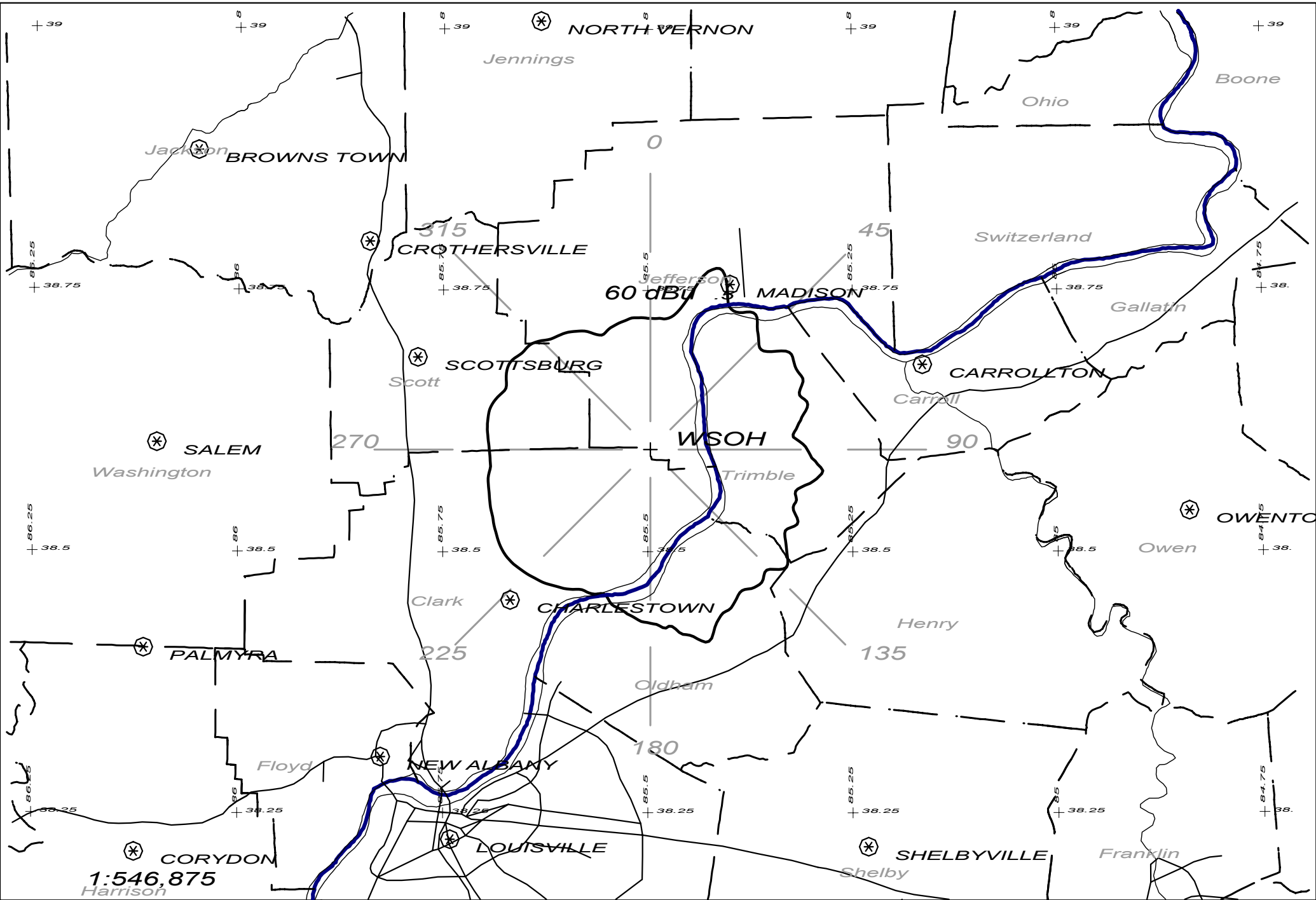

WSOH 202A 1.2kW 285M AMSL
N. Lat. 38 35 52 W. Lng. 85 29 49

WSOH
- 05/03
Exhibit 15B

TERRAIN AND CONTOUR DATA

WSOH
New Washington, IN

Exhibit 15C

ERP = 1.2 KW
FM – 2-6 Tables 30 Sec

Azimuth Deg T.	Ave. Elev. 3 to 16 km Meters AMSL	Effective Antenna Height Meters AAT	ERP (dBk)	F(50-50) Distance to 60 dBu Contour km
0	232.0	53.0	0.792	13.9
45	212.9	72.1	0.792	16.3
90	209.7	75.3	0.792	16.7
135	198.3	86.7	0.792	18.0
180	194.5	90.5	0.792	18.5
225	192.9	92.1	0.792	18.6
270	205.9	79.1	0.792	17.1
315	211.8	73.2	0.792	16.4

Ave. = 207.3 M

77.8 M

Antenna Radiation Center AMSL = 285.0 M

Geographic Coordinates:

North Latitude: 38 35 52

West Longitude: 85 29 49

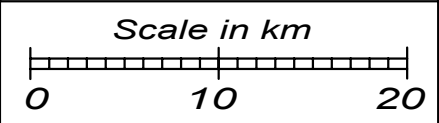
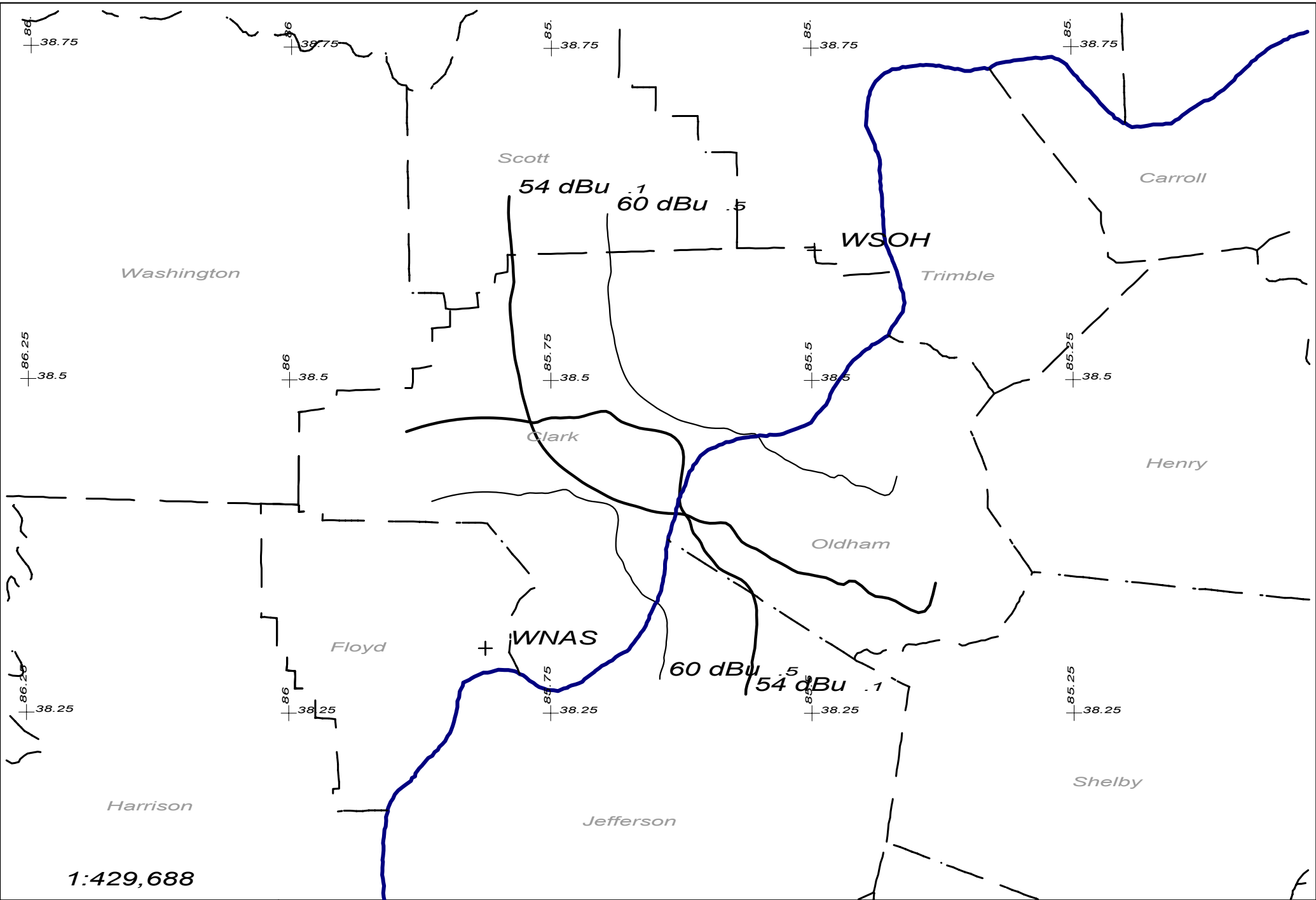

WSOH	202A	1.2kW	285M AMSL
WNAS	201A	2.85kW	178M AMSL

WSOH vs WNAS
- 05/03

Exhibit 15D

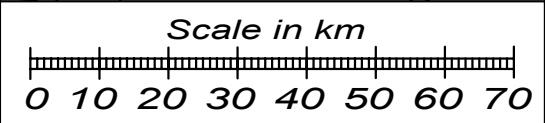
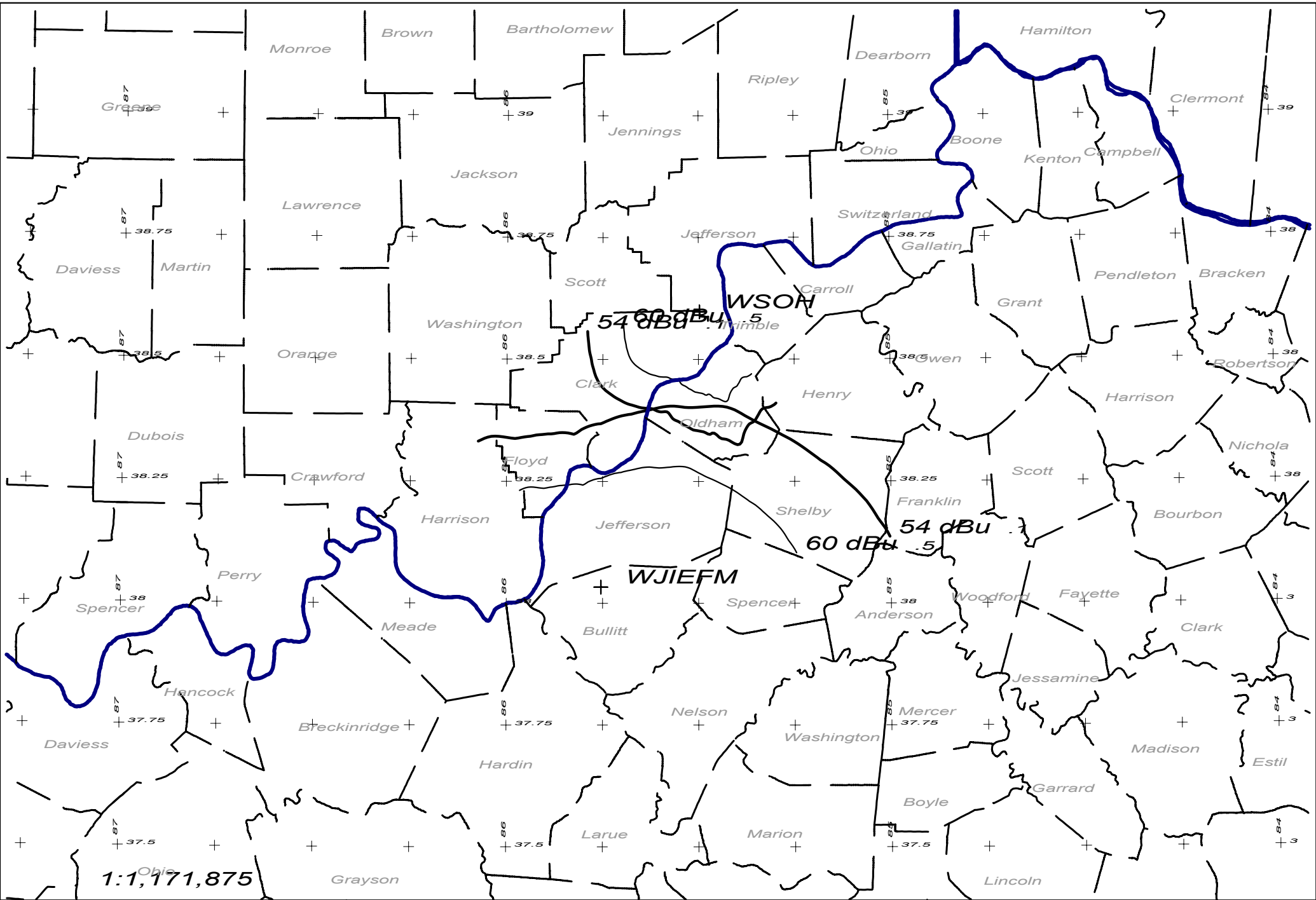

WSOH 202A 1.2kW 285M AMSL
WJIEFM 203C2 24.5kW 362M AMSL

WSOH vs WJIEFM
- 05/03 **Exhibit 15E**

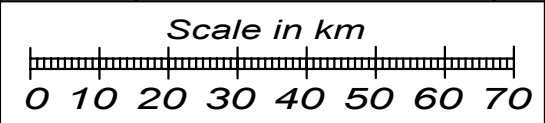
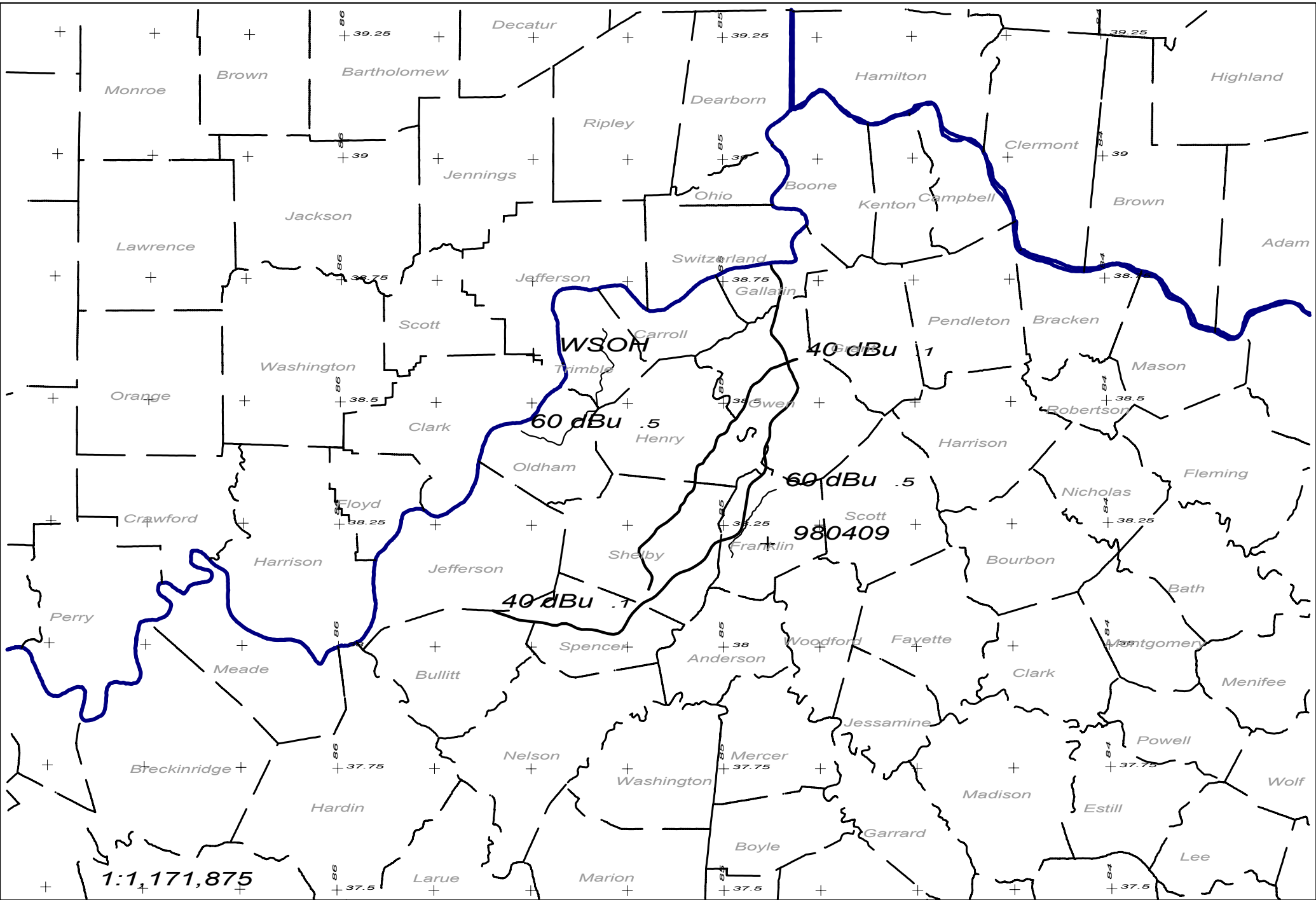

WSOH 202A 1.2kW 285M AMSL
980409 202A .35kW 303M AMSL

WSOH vs 980409
- 05/03 **Exhibit 15F**

85

38.25

Franklin

Exhibit 15H

85

38.25

Franklin

Exhibit 15J

A hand-drawn map on a white background. It features several wavy, irregular lines that define a geographical area. A single, straight diagonal line runs from the upper right towards the lower left, crossing the wavy boundaries. The word 'dham' is written in a large, italicized, gray font across the middle of the map. In the bottom right corner, there is a small rectangular box containing the text 'Exhibit 15K'.

dham

Exhibit 15K