

Surveyor's Statement

I, Damon Barrick on December 5, 2007 observed to the best of my ability the FM directional Antenna of KPNC is installed at a Bearing of 1° clockwise from Geodetic North.

The settings in degrees clockwise from Geodetic North were determined with the aid of a Topcon RTK surveyor grade Global Positioning System and observed with a Topcon GPT 3005 Total station.

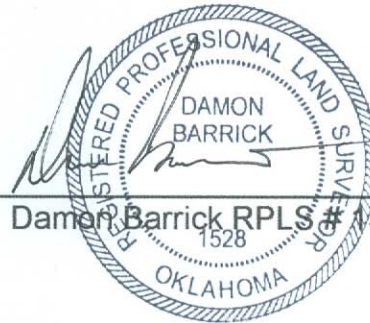

Damon Barrick RPLS # 1528

12/6/07