



Engineering Statement

This statement was prepared on behalf of Blessed Beginnings the licensee of WIOE-LP in Warsaw, IN. The instant proposal is to construct an auxiliary facility with an output power of 25 watts and an antenna height of 15 meters HAAT.

Figure 1 shows the present licensed facility and Figure 1A shows the proposed auxiliary facility. Figure 2 is an aerial view of both sites. The output power of the instant proposal was adjusted to keep the signal contour within the presently licensed facility 60 dBuV contour.

Figure 3 shows both the present and proposed 60 dBuV contour. As can be seen in this figure no increase in the 60 dBuV contour is proposed.

The signal contours were calculated for both the licensed site and the proposed site and are tabulated in Figure 4.

Respectfully Submitted,

Garrett G. Lysiak, P.E.

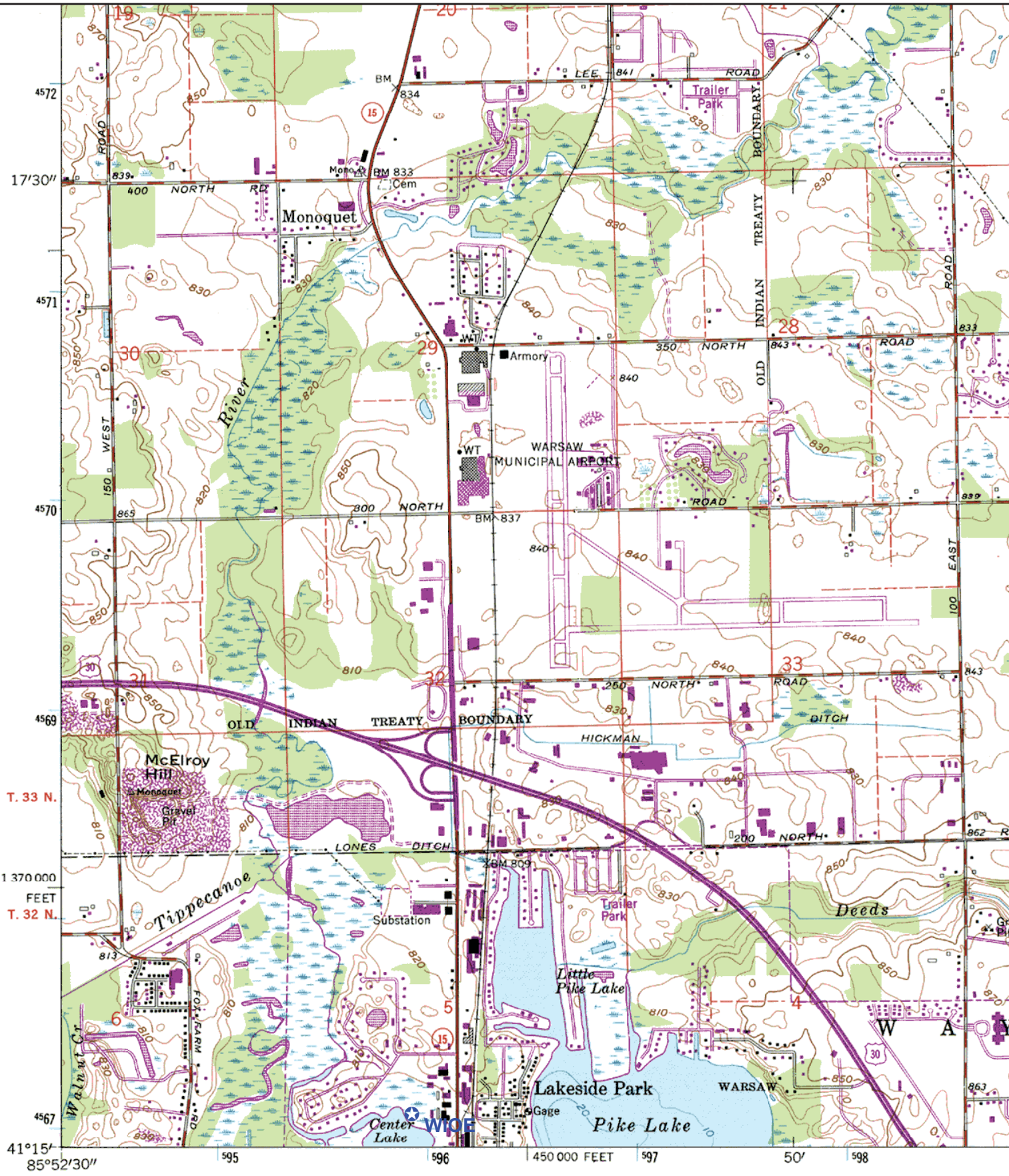

Produced by the United States Geological Survey

Planimetry by photogrammetric methods from imagery dated 1948
Topography by planetable surveys 1950. Revised 1962

Hydrography compiled from information furnished by
Indiana Department of Conservation

North American Datum of 1927 (NAD 27). Projection and
10 000-foot ticks: Indiana coordinate system, east zone
(transverse Mercator)

Blue 1000-meter Universal Transverse Mercator ticks, zone 16

North American Datum of 1983

FIGURE 1 - LICENSED SITE

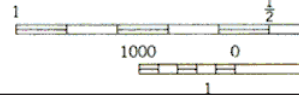

SCALE 1:24000

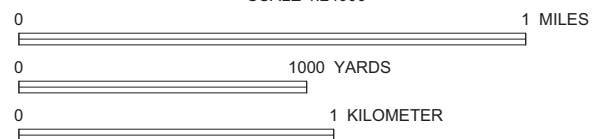

3866 IV SW
(ATWOOD)





FIGURE 2 - AERIAL VIEW

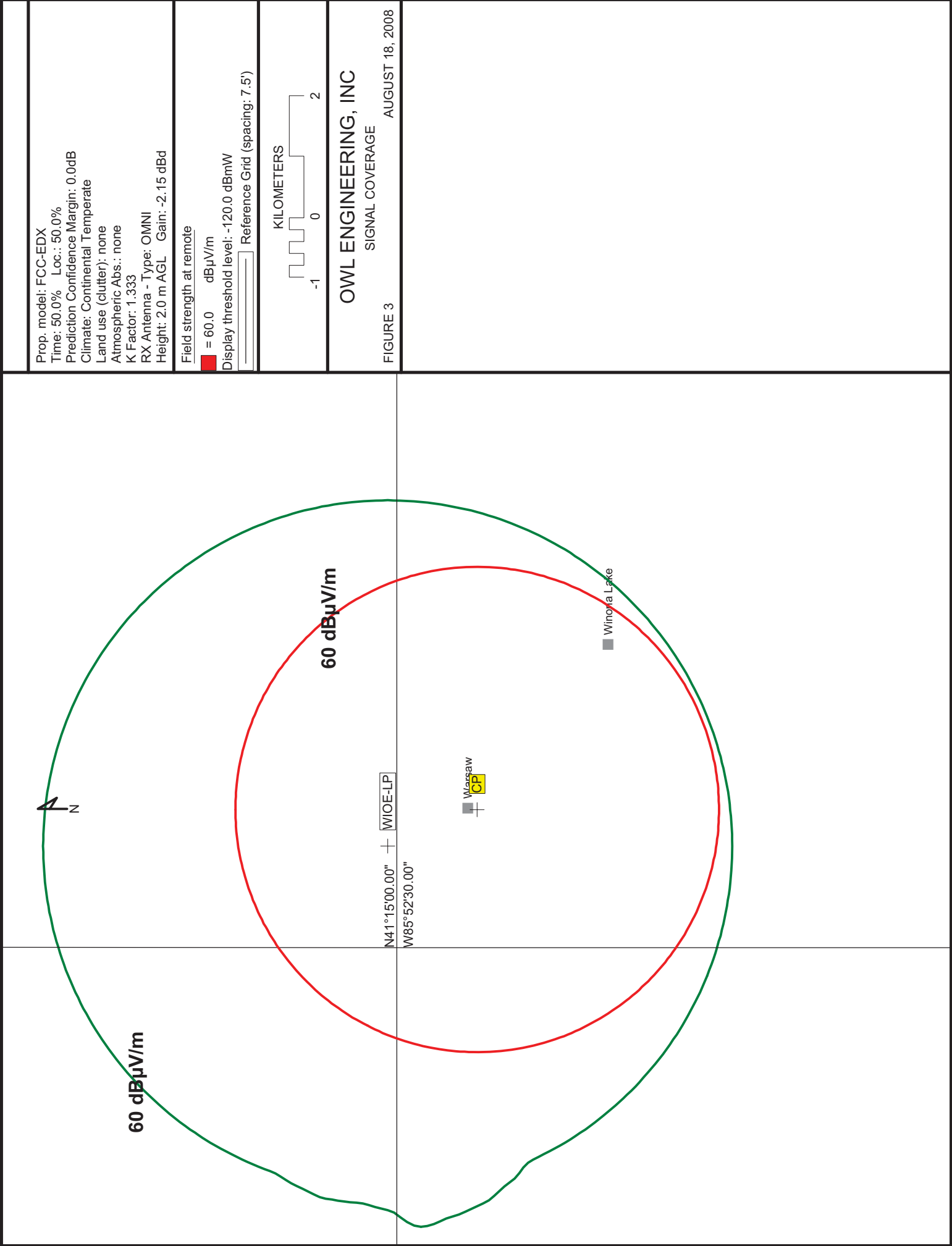



OWL ENGINEERING & EMC TEST LABS, INC.

CONSULTING COMMUNICATIONS ENGINEERS • EMC TEST LABORATORIES

5844 Hamline Avenue North, Shoreview, MN 55126
651-784-7445 • Fax 651-784-7541

Figure 4

WIOP-LP Licensed Facility

DISTANCES TO CONTOURS (Kilometers):

Antenna COR elevation (AMSL): 280 meters Average HAAT: 23 meters

Frequency: 98.3000 MHz

Coordinates: N 41 15 5 W 85 51 18

F(50,50) Curves Number of Contours: 1

AZ (degs)	HAAT (m)	ERPd (kW)	CONTOUR LEVELS (dBu): 60.0
--------------	-------------	--------------	-------------------------------

0.0	26	0.1000	5.7
5.0	26	0.1000	5.7
10.0	26	0.1000	5.7
15.0	24	0.1000	5.7
20.0	22	0.1000	5.7
25.0	17	0.1000	5.7
30.0	18	0.1000	5.7
35.0	19	0.1000	5.7
40.0	19	0.1000	5.7
45.0	19	0.1000	5.7
50.0	20	0.1000	5.7
55.0	22	0.1000	5.7
60.0	23	0.1000	5.7
65.0	20	0.1000	5.7
70.0	18	0.1000	5.7
75.0	17	0.1000	5.7
80.0	15	0.1000	5.7
85.0	15	0.1000	5.7
90.0	15	0.1000	5.7
95.0	13	0.1000	5.7
100.0	13	0.1000	5.7
105.0	13	0.1000	5.7
110.0	13	0.1000	5.7
115.0	14	0.1000	5.7
120.0	14	0.1000	5.7
125.0	15	0.1000	5.7
130.0	15	0.1000	5.7
135.0	16	0.1000	5.7
140.0	17	0.1000	5.7
145.0	18	0.1000	5.7
150.0	18	0.1000	5.7
155.0	20	0.1000	5.7
160.0	20	0.1000	5.7
165.0	21	0.1000	5.7
170.0	20	0.1000	5.7



OWL ENGINEERING & EMC TEST LABS, INC.

CONSULTING COMMUNICATIONS ENGINEERS • EMC TEST LABORATORIES

5844 Hamline Avenue North, Shoreview, MN 55126
651-784-7445 • Fax 651-784-7541

WIOP-LP Licensed Facility (Continued)

AZ (degs)	HAAT (m)	ERPd (kW)	CONTOUR LEVELS (dBu) : 60.0
175.0	20	0.1000	5.7
180.0	19	0.1000	5.7
185.0	18	0.1000	5.7
190.0	19	0.1000	5.7
195.0	21	0.1000	5.7
200.0	20	0.1000	5.7
205.0	21	0.1000	5.7
210.0	25	0.1000	5.7
215.0	27	0.1000	5.7
220.0	29	0.1000	5.7
225.0	27	0.1000	5.7
230.0	26	0.1000	5.7
235.0	25	0.1000	5.7
240.0	27	0.1000	5.7
245.0	31	0.1000	5.7
250.0	34	0.1000	5.9
255.0	35	0.1000	6.1
260.0	37	0.1000	6.2
265.0	37	0.1000	6.3
270.0	34	0.1000	6.0
275.0	33	0.1000	5.9
280.0	33	0.1000	5.9
285.0	32	0.1000	5.8
290.0	30	0.1000	5.7
295.0	28	0.1000	5.7
300.0	25	0.1000	5.7
305.0	24	0.1000	5.7
310.0	24	0.1000	5.7
315.0	24	0.1000	5.7
320.0	24	0.1000	5.7
325.0	24	0.1000	5.7
330.0	24	0.1000	5.7
335.0	24	0.1000	5.7
340.0	24	0.1000	5.7
345.0	25	0.1000	5.7
350.0	25	0.1000	5.7
355.0	26	0.1000	5.7



OWL ENGINEERING & EMC TEST LABS, INC.

CONSULTING COMMUNICATIONS ENGINEERS • EMC TEST LABORATORIES

5844 Hamline Avenue North, Shoreview, MN 55126
651-784-7445 • Fax 651-784-7541

Figure 4

Proposed Facility

DISTANCES TO CONTOURS (Kilometers):

Antenna COR elevation (AMSL): 274 meters Average HAAT: 15 meters

Frequency: 98.3000 MHz

Coordinates: N 41 14 17 W 85 50 52

F(50,50) Curves Number of Contours: 1

AZ (degs)	HAAT (m)	ERPd (kW)	CONTOUR LEVELS (dBu): 60.0
0.0	21	0.0250	4.0
5.0	21	0.0250	4.0
10.0	20	0.0250	4.0
15.0	18	0.0250	4.0
20.0	13	0.0250	4.0
25.0	13	0.0250	4.0
30.0	13	0.0250	4.0
35.0	13	0.0250	4.0
40.0	14	0.0250	4.0
45.0	15	0.0250	4.0
50.0	16	0.0250	4.0
55.0	14	0.0250	4.0
60.0	10	0.0250	4.0
65.0	11	0.0250	4.0
70.0	9	0.0250	4.0
75.0	7	0.0250	4.0
80.0	8	0.0250	4.0
85.0	9	0.0250	4.0
90.0	7	0.0250	4.0
95.0	6	0.0250	4.0
100.0	6	0.0250	4.0
105.0	6	0.0250	4.0
110.0	6	0.0250	4.0
115.0	5	0.0250	4.0
120.0	5	0.0250	4.0
125.0	6	0.0250	4.0
130.0	7	0.0250	4.0
135.0	8	0.0250	4.0
140.0	9	0.0250	4.0
145.0	7	0.0250	4.0
150.0	9	0.0250	4.0
155.0	10	0.0250	4.0
160.0	10	0.0250	4.0
165.0	11	0.0250	4.0
170.0	11	0.0250	4.0
175.0	11	0.0250	4.0



OWL ENGINEERING & EMC TEST LABS, INC.

CONSULTING COMMUNICATIONS ENGINEERS • EMC TEST LABORATORIES

5844 Hamline Avenue North, Shoreview, MN 55126
651-784-7445 • Fax 651-784-7541

Figure 4

Proposed Facility (Continued)

AZ (degs)	HAAT (m)	ERPd (kW)	CONTOUR LEVELS (dBu) : 60.0
180.0	10	0.0250	4.0
185.0	10	0.0250	4.0
190.0	10	0.0250	4.0
195.0	11	0.0250	4.0
200.0	13	0.0250	4.0
205.0	13	0.0250	4.0
210.0	13	0.0250	4.0
215.0	17	0.0250	4.0
220.0	19	0.0250	4.0
225.0	21	0.0250	4.0
230.0	21	0.0250	4.0
235.0	20	0.0250	4.0
240.0	19	0.0250	4.0
245.0	19	0.0250	4.0
250.0	22	0.0250	4.0
255.0	25	0.0250	4.0
260.0	27	0.0250	4.0
265.0	28	0.0250	4.0
270.0	30	0.0250	4.0
275.0	29	0.0250	4.0
280.0	29	0.0250	4.0
285.0	29	0.0250	4.0
290.0	27	0.0250	4.0
295.0	24	0.0250	4.0
300.0	21	0.0250	4.0
305.0	19	0.0250	4.0
310.0	19	0.0250	4.0
315.0	19	0.0250	4.0
320.0	19	0.0250	4.0
325.0	18	0.0250	4.0
330.0	18	0.0250	4.0
335.0	18	0.0250	4.0
340.0	19	0.0250	4.0
345.0	20	0.0250	4.0
350.0	21	0.0250	4.0
355.0	21	0.0250	4.0