

MINOR CHANGE APPLICATION
KWPT, INC.
K274AM FM TRANSLATOR STATION
CH 275D - 102.9 MHZ - 0.099 KW (DA)
EUREKA, CALIFORNIA
March 2008

EXHIBIT B

As indicated on Exhibit B1, the proposed operation of K274AM on Channel 275D with an effective radiated power of 0.099 kilowatt (99 watts) at 289.4 meters above average terrain will not cause interference to any existing, applied for, or proposed facility. It is noted that the proposed K274AM site is inside the 60 dBu contour of the proposed second adjacent KNHT (based on its change to Channel 273C2), Rio Dell, California and vacant and unapplied for Channel 277C3 at McKinleyville, California ("Channel 277C3").¹ The proposed K274AM translator on Channel 275D has an interfering contour ratio of 40 dB to the protected contours of both KNHT and Channel 277C3.

We have, therefore, calculated the signal level of both KNHT and Channel 277C3 at the K274AM site. The KNHT facility will deliver a 66.7 dBu (50/50) contour at the K274AM site. Channel 277C3 will deliver a 65.3 dBu (50/50) contour at the K274AM site. The corresponding interfering contour of the proposed K274AM facility is 106.7 dBu (50/10) to KNHT and 105.3 dBu (50/10) to Channel 277C3. As the interfering contour to KNHT is within the interfering contour of Channel 277C3, a review of the 105.3 dBu contour was conducted as a worst case

1) The use of Channel 273C2 by KNHT is assumed at the station's licensed power and height above average terrain on Channel 297C2. A maximum Class C3 facility for Channel 277 at McKinleyville, California was used for interference review.

scenario. The relative interfering contour of the proposed K274AM facility and the protected contours of KNHT and Channel 277C3 are shown on Exhibit B2.

The 105.3 dBu contour from the proposed K274AM translator extends in the main lobe of the directional antenna system a distance of 0.38 kilometer (1246 feet) from the tower. See Exhibit B3 for a tabulation. The proposed (existing) K274AM facility is located in a remote, unpopulated area. As indicated on Exhibit B4, the interfering contour does not encompass any structures nor cross any roads. Therefore, based on the foregoing, it is believed that the proposed K274AM facility is in compliance with §74.1204(d) of the Commission's rules. If a waiver of the rule is needed to address the KNHT and Channel 277C3 issues, one is respectfully requested.

MINOR CHANGE APPLICATION
KWPT, INC.
K274AM FM TRANSLATOR STATION
CH 275D - 102.9 MHZ - 0.099 KW (DA)
EUREKA, CALIFORNIA
March 2008

EXHIBIT B1

Interference Review for K274AM Eureka, California
Using Present/Proposed Site as Reference

REFERENCE CH# 275D - 102.9 MHz, Pwr= 0.099 kW, HAAT= 289.4 M, COR= 559 M DISPLAY DATES
40 49 32.0 N. Average Protected F(50-50)= 17.6 km DATA 03-20-08
124 00 05.0 W. SEARCH 03-20-08

CH CITY	CALL	TYPE ANT STATE	AZI. <--	DIST FILE #	LAT. LNG.	Pwr(kW) HAAT(M)	INT(km) COR(M)	PRO(km) LICENSEE	*IN* (Overlap in km)	*OUT*
274D Eureka	K274AM	LIC DCN CA	0.0 0.0	0.00 BLFT19970723TB	40 49 32.0 124 00 05.0	0.250 306	5.1 559	3.0 KWPT, Inc.	-20.33*	-25.77*
273C2 Rio Dell	KNHT	RSV CA	213.7 33.5	43.36 RMinv-19	40 30 03.0 124 17 10.0	50.000 150	7.2 341	59.2 St Of Or Actng By And Thru	34.14	-15.81*
277C3 Mckinleyville	AL2498	VAC CA	338.0 157.9	33.26 RM9995	41 06 11.0 124 09 00.0	25.000 100	4.6 196	43.1 Four Rivers Broadcasting	8.78	-10.44*
274C Cave Junction	KCNA	LIC CN OR	10.0 190.2	161.65 BLH19850513KH	42 15 30.0 123 39 38.0	100.000 602	141.5 1255	95.7 Opus Broadcasting Systems	9.94	51.72
272D Scotia, Etc.	K272CH	LIC DHN CA	214.1 33.9	43.72 BLFT19881004TA	40 29 58.0 124 17 28.0	0.140 520	0.7 724	25.3 Calvary Chapel Of Twin Falls	41.00	18.44
276C2 Weaverville	KHRD	LIC NCN CA	101.8 282.7	116.89 BLH19991103ABV	40 36 10.0 122 38 58.0	0.600 1095	69.1 1918	46.3 Results Radio Of Redding	40.69	60.24

Terrain database is NGDC 30 SEC Distance + R = 73.215 or FCC spacings in KM, Distance + M = Margin in KM
Contour distances are on direct line to and from reference station. Reference Zone = 2. With 3rd Adj Channels.
Ant Column: (D= DA Standard, Z= DA 73.215, N= Not DA 73.215, _= Omni), Polarization (C,H,V,E), Beamtilt(Y,N,X)
""affixed to 'IN' or 'OUT' values = site inside protected contour.

Graham Brock, Inc. - Broadcast Technical Consultants

K274AM

Latitude: 40-49-32 N
Longitude: 124-00-05 W
ERP: 0.099 kW
Channel: 275D
Frequency: 102.9 MHz
AMSL Height: 559.0 m

KNHT

BMLED-19991028AFZ
Latitude: 40-30-03 N
Longitude: 124-17-10 W
ERP: 3.30 kW
Channel: 273C2
Frequency: 102.5 MHz
AMSL Height: 780.0 m

Channel 277

Latitude: 41-06-11 N
Longitude: 124-09-00 W
ERP: 25.00 kW
Channel: 277C3
Frequency: 103.3 MHz
AMSL Height: 195.64 m

K274AM 105.3 dBu (50/10)

CHANNEL 277 65.3 dBu (50/50)

KNHT 66.7 dBu (50/50)

K274AM

EXHIBIT B2

MINOR CHANGE APPLICATION

KWPT, INC.

K274AM FM TRANSLATOR

CH 275D - 102.9 MHz - 0.099 kW (DA)

EUREKA, CALIFORNIA

March 2008

Scale 1:40,000

0 0.8 1.6 2.4 km

MINOR CHANGE APPLICATION
KWPT, INC.
K274AM FM TRANSLATOR STATION
CH 275D - 102.9 MHZ - 0.099 KW (DA)
EUREKA, CALIFORNIA
March 2008

EXHIBIT B3

Predicted contour:

N. Lat. = 40 49 32.0 - Tabulated Protected and Interfering Contour
W. Lng. = 124 00 05.0 - K274AM FM Translator - Eureka, California

HAAT and Distance to Contour - FCC Method - NGDC 30 Second terrain database

Azi.	HAAT	ERP kW	dBk	Field	60-F5	40-F1	54-F1	100-F1	105.3-F1	106.7-F1
000	382.6	0.0322	-14.93	0.570	15.18	51.23	22.81	0.40	0.22	0.18
010	247.4	0.0149	-18.27	0.388	10.17	33.90	14.17	0.27	0.15	0.13
020	283.1	0.0035	-24.61	0.187	7.30	25.09	10.68	0.13	0.07	0.06
030	279.5	0.0002	-36.98	0.045	2.67	11.63	4.46	0.03	0.02	0.01
040	359.1	0.0001	-40.50	0.030	1.95	10.72	3.52	0.02	0.01	0.01
050	141.2	0.0001	-39.94	0.032	1.76	6.91	2.79	0.02	0.01	0.01
060	-0.9	0.0001	-38.68	0.037	1.61	3.40	1.52	0.03	0.01	0.01
070	110.3	0.0002	-36.79	0.046	2.12	7.34	3.14	0.03	0.02	0.01
080	157.9	0.0004	-33.79	0.065	2.95	10.47	4.51	0.05	0.02	0.02
090	96.5	0.0020	-27.00	0.142	3.76	11.98	5.42	0.10	0.05	0.05
100	203.8	0.0040	-23.94	0.202	6.50	22.29	9.41	0.14	0.08	0.07
110	258.9	0.0054	-22.66	0.234	7.95	26.83	11.39	0.16	0.09	0.08
120	288.7	0.0062	-22.08	0.250	8.74	29.18	12.42	0.17	0.09	0.08
130	262.9	0.0067	-21.74	0.260	8.51	28.43	12.07	0.18	0.10	0.08
140	123.1	0.0062	-22.08	0.250	5.74	18.89	8.04	0.17	0.09	0.08
150	-50.2	0.0054	-22.66	0.234	2.73	8.69	3.81	0.16	0.09	0.08
160	-32.2	0.0040	-23.94	0.202	2.55	8.02	3.54	0.14	0.08	0.07
170	23.8	0.0020	-27.00	0.142	2.16	6.70	2.97	0.10	0.05	0.05
180	125.6	0.0004	-33.79	0.065	2.71	9.29	4.04	0.05	0.02	0.02
190	285.6	0.0002	-36.79	0.046	2.72	11.88	4.57	0.03	0.02	0.01
200	371.0	0.0001	-38.68	0.037	2.37	12.11	4.20	0.03	0.01	0.01
210	410.5	0.0001	-39.94	0.032	2.10	11.73	3.86	0.02	0.01	0.01
220	412.1	0.0001	-40.50	0.030	1.97	11.36	3.66	0.02	0.01	0.01
230	425.5	0.0002	-36.98	0.045	2.87	14.17	5.10	0.03	0.02	0.01
240	450.3	0.0035	-24.61	0.187	8.85	32.32	13.22	0.13	0.07	0.06
250	492.2	0.0149	-18.27	0.388	13.96	49.50	21.37	0.27	0.15	0.13
260	522.4	0.0322	-14.93	0.570	17.87	60.86	26.86	0.40	0.22	0.18
270	540.5	0.0506	-12.96	0.715	20.58	67.91	30.89	0.50	0.27	0.23
280	542.3	0.0680	-11.67	0.829	22.22	71.75	33.70	0.58	0.31	0.27
290	539.2	0.0838	-10.77	0.920	23.31	74.18	35.60	0.64	0.35	0.30
300	526.0	0.0949	-10.23	0.979	23.68	74.88	36.26	0.68	0.37	0.32
310	485.2	0.0990	-10.04	1.000	22.76	72.46	34.93	0.70	0.38	0.32
320	424.2	0.0949	-10.23	0.979	20.99	67.03	31.92	0.68	0.37	0.32
330	423.8	0.0838	-10.77	0.920	20.35	65.41	30.84	0.64	0.35	0.30
340	445.3	0.0680	-11.67	0.829	19.80	64.42	30.05	0.58	0.31	0.27
350	483.3	0.0506	-12.96	0.715	19.21	63.57	29.01	0.50	0.27	0.23

AMSL = 559.0

GRAHAM BROCK, INC.

BROADCAST TECHNICAL CONSULTANTS

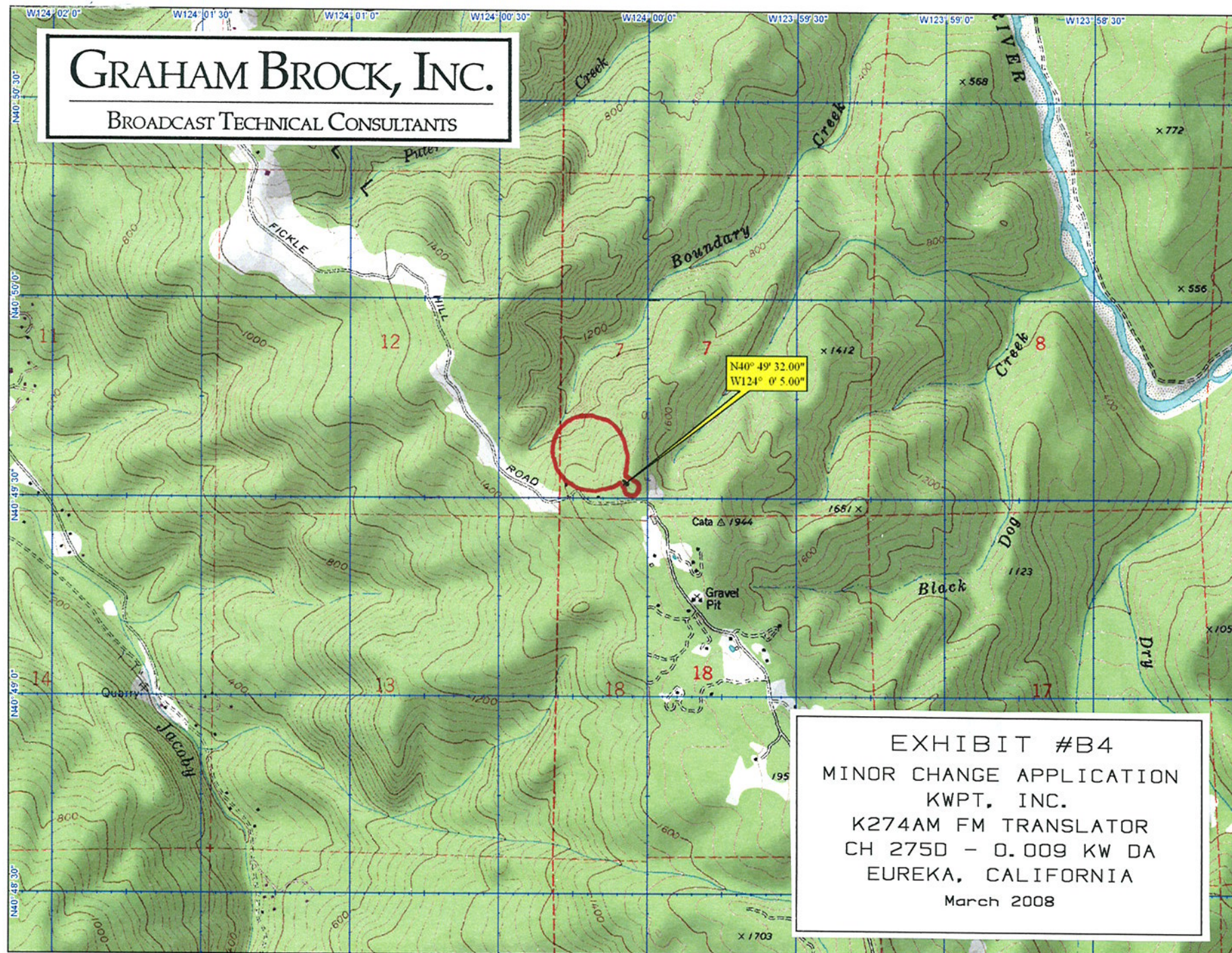

EXHIBIT #B4
MINOR CHANGE APPLICATION
KWPT, INC.
K274AM FM TRANSLATOR
CH 275D - 0.009 KW DA
EUREKA, CALIFORNIA
March 2008

