

Exhibit12 Hinckley, OH										
REFERENCE	CH#	215D	-	90.9 MHz, Pwr= 0.009 kW, HAAT=228.7 M, COR= 520 M				DISPLAY DATES		
41 14 39 N				Average Protected F(50-50)= 8.59 km				DATA 07-31-04		
81 41 54 W	Ave. F(50-10)	40	dBu= 28.7	54 dBu= 12.1	80	dBu= 1.9	100	dBu= .2	SEARCH 08-04-04	
CH	CALL	TYPE	AZI.	DIST	LAT.	Pwr(kW)	COR(M)	PRO(km)	*IN*	*OUT*
CITY	STATE		<--	FILE #	LNG.	HAAT(M)	INT(km)	LICENSEE	(Overlap	in km)
212B WCPN Cleveland	LIC DCN OH	355.0 175.0	14.22 BLED19961025KA	41 22 18 81 42 48	47.000 64	425 3.8	36.8 Ideastream	3.16	-22.84*	
215A WCWSFM Wooster	LIC C OH	197.4 17.4	48.43 BMLD20000505AAF	40 49 41 81 52 14	1.050 72	393 55.0	15.7 The College Of Wooster	-14.16	6.95	
216B1 WRUWFM Cleveland	LIC DC OH	17.2 197.2	32.15 BLED20010406AAQ	41 31 14 81 35 03	1.377 79	320 26.1	17.7 Case Western Reserve Unive	-1.69	3.41	
215D AP215 Snyder	APP C OH	155.2 335.2	56.09 BNPFT20000407AAT	40 47 08 81 25 08	0.010 101	442 19.3	5.9 Faith Pleases God Church C	28.61	22.84	
217A WAPS Akron	LIC DCX OH	154.1 334.1	22.15 BLED20021122AAD	41 03 53 81 34 59	1.330 117	424 1.9	21.6 Board Of Education, Akron	12.13	0.32	
215B1 WCVJ Jefferson	LIC C OH	60.9 240.9	89.40 BLED19980325KE	41 37 50 80 45 36	1.850 226	485 86.9	31.4 Agape School, Inc.	-5.89	29.78	
215B1 WCVJ.C Jefferson	CP CN OH	60.9 240.9	89.40 BMPED19980928IA	41 37 50 80 45 36	1.850 226	485 86.9	31.4 Agape School, Inc.	-5.89	29.78	
218A WKHR Bainbridge	LIC C OH	54.0 234.0	41.71 BLED20011116ABQ	41 27 49 81 17 38	0.750 161	480 1.6	21.8 Kenston Local School Distr	31.64	19.67	
218A WOBCFM Oberlin	CP CN OH	277.4 97.4	44.24 BPED19970710IA	41 17 38 82 13 20	0.900 44	278 1.6	11.8 Oberlin College Student Ne	34.88	32.21	
218A WOBCFM Oberlin	CP CX OH	277.4 97.4	44.24 BPED20011127ABM	41 17 38 82 13 20	1.000 44	278 1.6	12.1 Oberlin College Student Ne	34.88	31.92	
218A WOBCFM Oberlin	LIC CN OH	277.4 97.4	44.39 BLED19811218AW	41 17 39 82 13 26	0.440 44	278 1.5	10.0 Oberlin College Student Ne	35.16	34.23	
215D W215AX Carrollton	LIC CN OH	144.7 324.7	88.89 BLFT19981214TB	40 35 24 81 05 25	0.038 63	399 21.4	6.4 Carrollton Baptist Temple	59.45	55.44	
214A WNRK.C Norwalk	CP DCX OH	263.2 83.2	58.37 BPED19980512MW	41 10 50 82 23 21	4.000 138	399 45.3	29.7 Kent State University	5.38	17.66	
216A WRMUFM Alliance	LIC HN OH	127.4 307.4	62.03 BMLD19810611AA	40 54 16 81 06 45	2.800 70	411 29.4	20.1 Mount Union College	24.38	30.32	
216D AP216 Freedom	APP C OH	86.2 266.2	42.80 BNPFT20000407AAN	41 16 06 81 11 19	0.010 87	435 7.6	5.5 Faith Pleases God Church C	26.87	25.59	
216D AP216 Freedom	APP C OH	86.2 266.2	42.80 BNPFT20000407AAN	41 16 06 81 11 19	0.013 87	435 8.2	5.8 Faith Pleases God Church C	26.33	25.22	
213A WVML.C Millersburg	CP ZCX OH	183.0 3.0	71.38 BMPED20020314ABK	40 36 08 81 44 32	1.345 96	450 1.8	19.7 The Moody Bible Institute	61.95	51.51	
214B1 WKTL Struthers	LIC DCN OH	102.7 282.7	94.74 BLED1805	41 03 06 80 35 56	13.231 13	339 28.9	19.5 Bd. Of Ed.struthers,ohio C	57.31	63.31	
218D AP218 Snyder	APP C OH	155.2 335.2	56.10 BNPFT20000407AAT	40 47 08 81 25 07	0.013 97	438 0.3	6.1 Faith Pleases God Church C	47.70	49.75	
218A WKRJ New Philadelphia	LIC CN OH	168.6 348.6	77.06 BLED19940714KB	40 33 50 81 31 05	2.000 69	387 1.8	18.3 Kent State University	67.46	58.59	
216D W216AH Ashland	LIC C OH	228.5 48.5	65.26 BLFT20031020ABX	40 51 14 82 16 43	0.250 -2	342 10.1	7.1 Mansfield Christian School	47.15	46.86	
214A WVMCFM Mansfield	LIC VX OH	230.6 50.6	90.93 BLED20021021AAJ	40 43 21 82 31 52	0.170 99	459 17.0	11.7 Mansfield Christian School	65.92	67.94	
216A WOSE Coshocton	LIC DCN OH	192.7 12.7	102.73 BLED19960311KH	40 20 30 81 57 56	3.752 102	388 39.2	25.7 The Ohio State University	55.94	66.20	
06+1C WSYX Columbus	LI DCY OH	218.0 38.0	183.26 BLCT19931022KE	39 56 16 83 01 16	78.852 278	523	98.9 Wsyx Licensee, Inc.	To Grd B=	84.33	

ERP and HAAT are on direct line to and from reference station.  
 \*\*\*Affixed to 'IN' or 'Out' values = site inside protected contour.

## **Exhibit 12 (Compliance with CFR 74.1204)**

---

The proposed FM Translator is located within the protected 60 dBu contour of third adjacent channel station WCPN, channel 212B, Cleveland, OH. The predicted F(50-50) field strength of WCPN at the proposed translator site is 77 dBu, see Exhibit 12A. Therefore, the respective predicted interfering contour generated by the proposed FM Translator is 117 dBu. This interfering contour extends less than 30 meters from the proposed transmit antenna, and the area of overlap does not reach the ground (the antenna will be mounted at the 130 meter level on a 152 meter tower).

To confirm the absence of population within the interference aperture, EMF has examined the attached topographic map, which indicates a lack of structures near the proposed tower, and therefore no structure which could be tall enough to enter the 30-meter interference aperture.

Therefore, EMF respectfully requests a waiver of C.F.R. 74.1204 based on no population within the area of predicted interference.





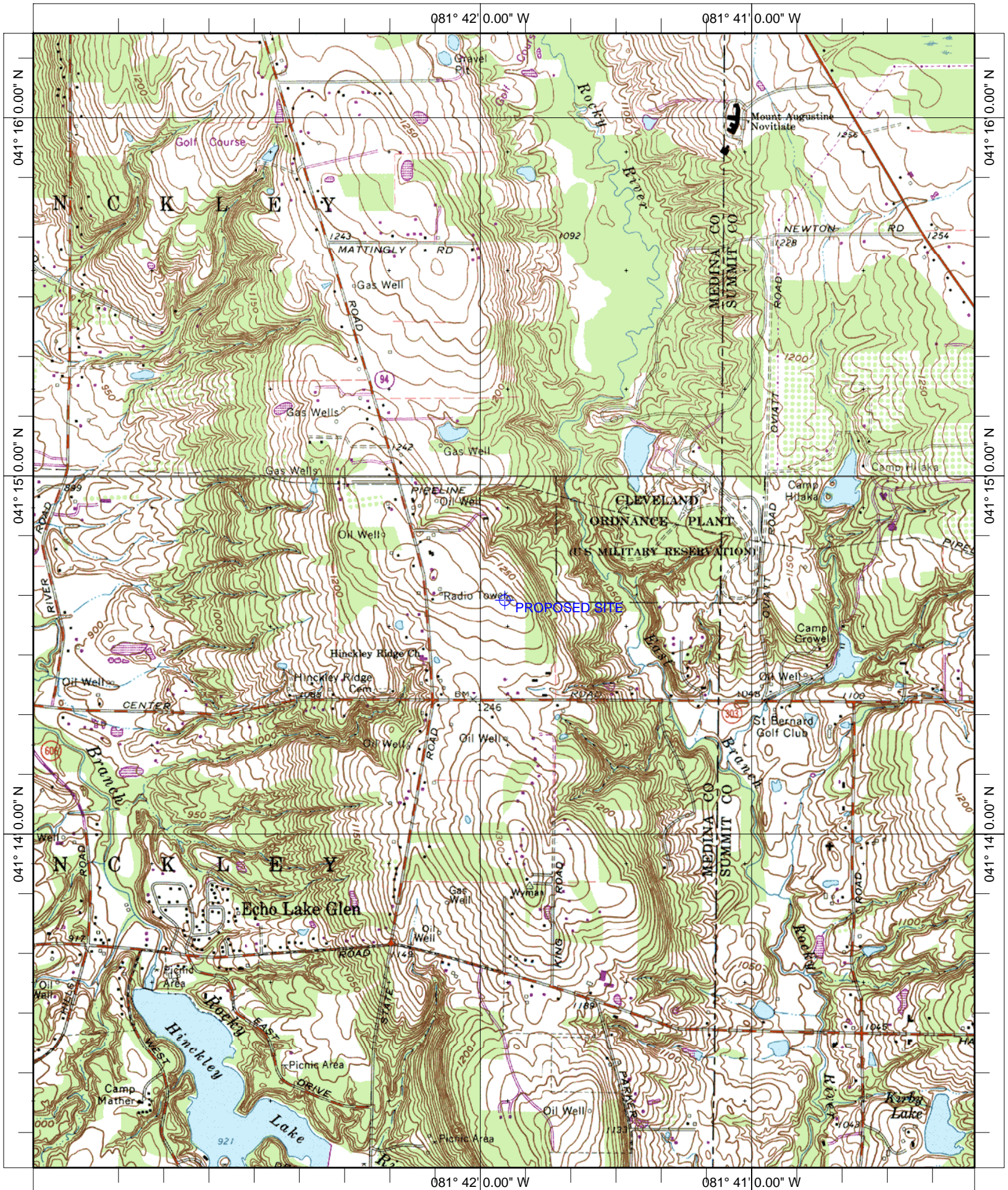

Name: WEST RICHFIELD  
 Date: 8/4/2004  
 Scale: 1 inch equals 2000 feet

Location: 041° 14' 39.1" N 081° 41' 54.7" W  
 Caption: Exhibit 12  
 Site 41-14-39 / 81-41-54