

FAA TOWER CERTIFICATION

Date: February 21, 2011

Mr. Rick Jesse  
Java Java Radio  
P.O. Box 347  
Hartville, MO 65667

RE: Antenna direction certification for Facility ID: 175203 Call Sign: KZLW, Location:  
ALLTEL-County Road K-13025

SAUNDERS COUNTY, NEBRASKA

I Hereby certify that on February 19 2011 that the field Survey was conducted under my direct supervision and confirming that the KZLW antenna has been mounted on the East leg of said tower at an Easterly direction with an Azimuth of North 90 Degrees, (+/- one degree) Per the plan created by **Shively Labs**, NE GRETNA, NE Code 26750, drawing 012210-BJR; Also referencing the survey from **Community Land Surveying** drawing 13025 (Job 13025).

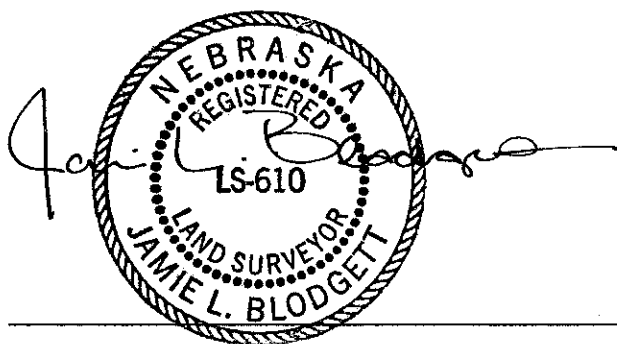

Jamie L. Blodgett, R.L.S.

2/24/2011

Date

