

SELLMEYER ENGINEERING

BROADCAST AND COMMUNICATION CONSULTING ENGINEERS

P.O. Box 356 McKinney, Texas 75070

MEMBER AFCCE

(214) 495-9764

=====

DAYTIME EXHIBITS

RADIO STATION KWAM

990 KHZ, 0.33 KW-N, 5.0 KW-CH, 10.0 KW-D, DA-2

MEMPHIS, TENNESSEE

=====

SELLMEYER ENGINEERING

BROADCAST AND COMMUNICATIONS CONSULTING ENGINEERS

P.O. Box 356 McKinney, Texas 75070

MEMBER AFCCE

(972) 542-2056

EXHIBIT E1-5A

MAP SHOWING PROPOSED DAYTIME SERVICE CONTOURS

RADIO STATION KWAM

990 KHZ, 0.33 KW, 10 KW-LS, DA-2

MEMPHIS, TENNESSEE

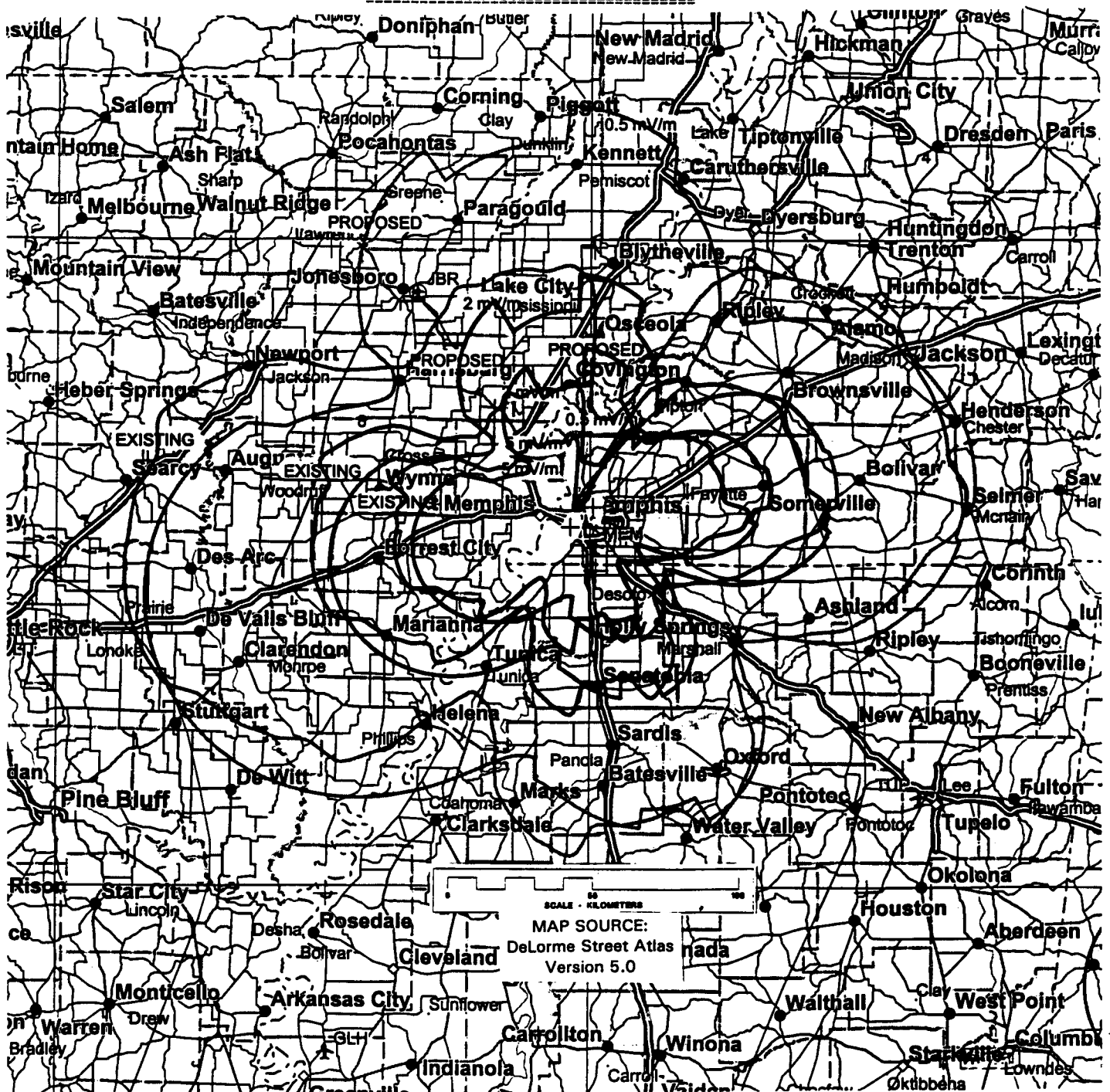

SELLMEYER ENGINEERING

BROADCAST AND COMMUNICATIONS CONSULTING ENGINEERS
P.O. Box 356 McKinney, Texas 75070
MEMBER AFCCE
(972) 542-2056

EXHIBIT E1-5B
MAP SHOWING PROPOSED 1000 MV/M DAYTIME CONTOUR
RADIO STATION KWAM
990 KHZ, 0.33 KW, 10 KW-LS, DA-2
MEMPHIS, TENNESSEE



SELLMEYER ENGINEERING

BROADCAST AND COMMUNICATIONS CONSULTING ENGINEERS
P.O. Box 356 McKinney, Texas 75070
MEMBER AFCCE
(972) 542-2056

EXHIBIT E1-5C
TABULATION OF DISTANCES TO CONTOURS
RADIO STATION KWAM
990 KHZ, 0.33 KW, 10 KW-LS, DA-2
MEMPHIS, TENNESSEE
=====

Call: KWAM
Coordinates: 35 11 45.00 90 00 32.00
Frequency: 990 kHz Number of contours: 5

Azimuth	Radiation (mV/m at one km)	Distances to Contours in Kilometers:				
		Contour levels in mV/m.				
		5.000	2.000	0.500	0.250	0.025
0.0	1362.76	54.09	79.59	137.06	177.19	362.37
5.0	1287.56	52.75	77.77	134.14	173.59	353.63
10.0	1184.57	50.81	75.16	129.94	168.42	345.79
15.0	1054.79	37.52	60.98	113.61	150.73	324.80
20.0	900.82	34.46	56.44	106.26	141.57	311.04
25.0	728.47	31.26	50.68	96.98	129.90	277.04
30.0	551.57	27.40	43.70	85.84	115.76	245.48
35.0	407.22	30.05	47.42	85.54	111.03	227.47
40.0	379.20	28.91	45.88	83.12	105.42	219.37
45.0	505.30	33.68	52.30	91.61	113.46	237.82
50.0	707.99	39.92	60.62	99.96	125.01	260.58
55.0	928.67	45.44	67.97	107.80	135.54	280.17
60.0	1140.05	49.94	73.99	114.37	144.28	295.45
65.0	1325.89	53.44	76.94	119.60	151.14	306.97
70.0	1474.49	56.01	78.94	123.49	156.19	315.22
75.0	1577.33	57.67	80.57	126.34	159.77	320.85
80.0	1628.94	60.44	82.93	129.28	163.07	325.03
85.0	1626.99	60.41	83.26	129.60	163.37	325.30
90.0	1572.43	59.55	82.97	128.68	162.08	323.06
95.0	1469.19	53.31	78.87	123.35	156.02	314.94
100.0	1323.90	53.40	78.66	121.92	153.44	308.85
105.0	1145.23	50.04	74.12	117.48	147.43	298.04
110.0	943.31	45.78	68.42	111.91	139.82	284.86
115.0	729.34	40.50	61.39	105.01	130.36	266.96
120.0	515.99	34.06	52.80	94.00	118.65	243.31
125.0	321.70	26.38	42.46	77.75	102.55	207.59
130.0	195.96	19.65	33.14	63.30	84.23	178.69
135.0	231.73	21.78	36.13	67.92	90.07	185.21
140.0	353.51	36.56	53.29	89.70	115.30	214.73
145.0	474.88	41.50	59.75	99.85	128.25	235.10
150.0	574.71	44.88	64.26	106.99	137.34	250.14
155.0	647.10	47.08	67.20	111.67	143.30	261.83
160.0	690.24	48.32	68.85	114.30	146.63	271.26
165.0	704.14	39.81	60.47	106.24	138.78	273.60
170.0	690.08	39.42	59.95	105.40	137.72	282.94
175.0	650.85	44.98	65.13	109.69	141.38	300.72
180.0	591.58	43.20	62.76	105.90	136.56	292.69
185.0	522.06	40.95	59.75	101.12	130.48	282.46
190.0	461.27	38.80	56.88	96.59	124.70	272.33
195.0	441.29	31.37	49.21	88.34	116.01	262.11
200.0	492.96	33.25	51.72	92.31	121.09	271.04
205.0	616.16	37.27	57.08	100.82	131.92	289.40
210.0	787.71	42.04	63.43	110.99	144.80	310.18
215.0	985.40	46.71	69.67	121.06	157.41	329.42
220.0	1192.76	50.97	75.37	130.28	168.84	332.49
225.0	1396.53	54.68	80.39	138.34	178.75	337.69
230.0	1584.96	57.79	84.60	145.12	184.03	345.24
235.0	1747.29	60.28	87.98	150.51	187.94	351.85
240.0	1873.89	62.11	90.46	154.50	190.82	356.72
245.0	1956.70	63.26	92.03	157.00	192.85	360.01
250.0	1989.85	63.71	92.65	157.97	193.98	361.59

SELLMEYER ENGINEERING
 BROADCAST AND COMMUNICATIONS CONSULTING ENGINEERS
 P.O. Box 356 McKinney, Texas 75070
 MEMBER AFCCE
 (972) 542-2056

EXHIBIT E1-5C, PAGE-2
 TABULATION OF DISTANCES TO CONTOURS
 RADIO STATION KWAM
 990 KHZ, 0.33 KW, 10 KW-LS, DA-2
 MEMPHIS, TENNESSEE
 =====

Call: KWAM
 Coordinates: 35 11 45.00 90 00 32.00
 Frequency: 990 kHz Number of contours: 5

Azimuth	Radiation (mV/m at one km)	Distances to Contours in Kilometers:				
		Contour levels in mV/m.				
		5.000	2.000	0.500	0.250	0.025
255.0	1970.13	63.44	92.28	157.39	194.40	361.75
260.0	1897.32	62.43	90.91	155.22	194.39	360.66
265.0	1774.29	60.68	88.52	151.38	194.52	363.63
270.0	1606.94	58.13	85.07	145.87	187.86	367.47
275.0	1403.92	54.81	80.57	138.61	179.08	365.58
280.0	1176.51	50.65	74.95	129.60	168.01	345.19
285.0	939.17	35.15	57.75	108.30	144.10	314.76
290.0	712.29	30.93	50.24	96.18	128.84	291.07
295.0	530.97	26.89	42.93	84.53	114.07	266.63
300.0	455.00	24.93	39.35	78.88	106.86	254.01
305.0	516.71	26.54	42.29	83.52	112.77	264.38
310.0	659.23	38.54	58.77	103.53	135.35	295.13
315.0	822.55	42.91	64.60	112.88	147.16	313.94
320.0	979.09	46.57	69.49	120.76	157.04	328.91
325.0	1117.42	49.49	73.38	127.06	164.87	340.65
330.0	1232.50	51.72	76.39	131.92	170.86	349.25
335.0	1322.04	53.37	78.61	135.49	175.25	355.46
340.0	1384.96	41.69	67.30	125.08	165.40	346.82
345.0	1420.78	42.27	68.14	126.42	167.02	349.14
350.0	1429.19	42.42	68.34	126.73	167.40	349.67
355.0	1409.93	42.09	67.89	126.02	166.53	351.07

SELLMEYER ENGINEERING
 BROADCAST AND COMMUNICATIONS CONSULTING ENGINEERS
 P.O. Box 356 McKinney, Texas 75070
 MEMBER AFCCE
 (972) 542-2056

EXHIBIT E1-5C, PAGE-3
 TABULATION OF DISTANCES TO CONTOURS
 RADIO STATION KWAM
 990 KHZ, 0.33 KW, 10 KW-LS, DA-2
 MEMPHIS, TENNESSEE
 =====

Call: KWAM
 Coordinates: 35 11 45.00 90 00 32.00
 Frequency: 990 kHz Number of contours: 1

Radiation			Distances to Contours in Kilometers:		
(mV/m at			Contour levels in mV/m.		
Azimuth	one km)	1000.000	Azimuth	one km)	1000.000
0.0	1362.76	1.27	255.0	1970.13	1.80
5.0	1287.56	1.21	260.0	1897.32	1.74
10.0	1184.57	1.11	265.0	1774.29	1.63
15.0	1054.79	1.00	270.0	1606.94	1.49
20.0	900.82	0.86	275.0	1403.92	1.31
25.0	728.47	0.70	280.0	1176.51	1.11
30.0	551.57	0.53	285.0	939.17	0.89
35.0	407.22	0.40	290.0	712.29	0.68
40.0	379.20	0.37	295.0	530.97	0.51
45.0	505.30	0.49	300.0	455.00	0.44
50.0	707.99	0.68	305.0	516.71	0.50
55.0	928.67	0.88	310.0	659.23	0.63
60.0	1140.05	1.07	315.0	822.55	0.78
65.0	1325.89	1.24	320.0	979.09	0.93
70.0	1474.49	1.37	325.0	1117.42	1.05
75.0	1577.33	1.46	330.0	1232.50	1.16
80.0	1628.94	1.51	335.0	1322.04	1.24
85.0	1626.99	1.50	340.0	1384.96	1.29
90.0	1572.43	1.46	345.0	1420.78	1.32
95.0	1469.19	1.37	350.0	1429.19	1.33
100.0	1323.90	1.24	355.0	1409.93	1.31
105.0	1145.23	1.08			
110.0	943.31	0.89			
115.0	729.34	0.70			
120.0	515.99	0.50			
125.0	321.70	0.31			
130.0	195.97	0.19			
135.0	231.73	0.23			
140.0	353.51	0.34			
145.0	474.88	0.46			
150.0	574.71	0.55			
155.0	647.10	0.62			
160.0	690.24	0.66			
165.0	704.14	0.67			
170.0	690.08	0.66			
175.0	650.85	0.63			
180.0	591.58	0.57			
185.0	522.06	0.50			
190.0	461.27	0.45			
195.0	441.29	0.43			
200.0	492.96	0.48			
205.0	616.16	0.59			
210.0	787.71	0.75			
215.0	985.40	0.93			
220.0	1192.76	1.12			
225.0	1396.53	1.30			
230.0	1584.96	1.47			
235.0	1747.29	1.61			
240.0	1873.89	1.72			
245.0	1956.70	1.79			
250.0	1989.86	1.82			

SELLMEYER ENGINEERING

BROADCAST AND COMMUNICATIONS CONSULTING ENGINEERS

P.O. Box 356 McKinney, Texas 75070

MEMBER AFCCE

(972) 542-2056

EXHIBIT E1-5D

TABULATION OF CONDUCTIVITIES

RADIO STATION KWAM

990 KHZ, 0.33 KW, 10 KW-LS, DA-2

MEMPHIS, TENNESSEE

=====

Call: KWAM

MEMPHIS, TX

Coordinates: 35 11 45.00 90 00 32.00

Frequency: 990 kHz

Azimuth	Radiation (mV/m at one km)	Ground Conductivity Data:							
		Region conductivity in mS/m followed by distance in km to the end of region. E - map data; M - measurement data.							
0.0	1362.76	8.0E	315.5	15.0E	545.1	8.0E	878.9	4.0E	1212.7
5.0	1287.56	8.0E	347.9	15.0E	606.0	8.0E	1055.8	4.0E	1212.7
10.0	1184.57	8.0E	400.2	15.0E	678.3	8.0E	897.2	15.0E	1035.0
15.0	1054.79	5.0M	35.4	8.0E	714.8	15.0E	754.6	8.0E	1212.7
20.0	900.82	5.0M	35.4	8.0E	779.5	2.0E	784.0	8.0E	907.6
25.0	728.47	5.0M	35.4	8.0E	160.8	4.0E	242.6	8.0E	792.8
30.0	551.57	5.0M	35.4	8.0E	124.8	4.0E	239.8	8.0E	629.3
35.0	407.22	8.0E	106.6	4.0E	230.8	8.0E	682.0	15.0E	778.6
40.0	379.20	8.0E	94.0	4.0E	225.7	8.0E	739.1	15.0E	939.8
45.0	505.30	8.0E	87.3	4.0E	235.0	8.0E	415.4	4.0E	509.3
50.0	707.99	8.0E	82.0	4.0E	283.6	8.0E	305.5	4.0E	527.5
55.0	928.67	8.0E	78.0	4.0E	580.3	8.0E	676.0	2.0E	912.8
60.0	1140.05	8.0M	37.0	8.0E	75.0	4.0E	557.3	8.0E	637.8
65.0	1325.89	8.0M	37.0	8.0E	72.8	4.0E	507.8	2.0E	1212.7
70.0	1474.49	8.0M	37.0	8.0E	71.2	4.0E	478.4	2.0E	1189.6
75.0	1577.33	8.0M	37.0	8.0E	71.2	4.0E	467.7	2.0E	630.9
80.0	1628.94	10.0M	22.5	8.0E	71.9	4.0E	428.1	2.0E	644.7
85.0	1626.99	10.0M	22.5	8.0E	73.1	4.0E	377.6	2.0E	851.5
90.0	1572.43	10.0M	22.5	8.0E	74.9	4.0E	345.5	2.0E	439.9
95.0	1469.19	7.0M	35.4	8.0E	77.4	4.0E	322.9	2.0E	420.9
100.0	1323.90	8.0E	80.8	4.0E	305.3	2.0E	405.8	4.0E	472.7
105.0	1145.23	8.0E	85.1	4.0E	292.2	2.0E	390.7	4.0E	439.1
110.0	943.31	8.0E	90.6	4.0E	284.0	2.0E	373.7	4.0E	420.4
115.0	729.34	8.0E	97.2	4.0E	290.1	2.0E	360.6	4.0E	411.1
120.0	515.99	8.0E	104.1	4.0E	413.6	2.0E	512.5	4.0E	924.4
125.0	321.70	8.0E	112.7	4.0E	180.7	2.0E	280.2	4.0E	729.5
130.0	195.96	8.0E	120.7	4.0E	153.3	2.0E	331.9	4.0E	472.9
135.0	231.73	8.0E	131.0	4.0E	137.5	2.0E	371.3	4.0E	443.8
140.0	353.51	15.0M	37.0	8.0E	139.7	2.0E	402.1	4.0E	415.4
145.0	474.88	15.0M	37.0	8.0E	147.9	2.0E	428.9	8.0E	536.2
150.0	574.71	15.0M	37.0	8.0E	156.5	2.0E	456.3	8.0E	501.8
155.0	647.10	15.0M	37.0	8.0E	167.4	2.0E	491.0	1.0E	584.0
160.0	690.24	15.0M	37.0	8.0E	181.9	2.0E	542.9	5000.0E	582.2
165.0	704.14	8.0E	202.0	2.0E	313.4	4.0E	377.0	2.0E	559.4
170.0	690.08	8.0E	236.5	2.0E	305.4	4.0E	427.2	2.0E	544.2
175.0	650.85	15.0M	30.0	8.0E	301.8	2.0E	304.1	4.0E	503.0
180.0	591.58	15.0M	30.0	8.0E	311.3	4.0E	538.7	15.0E	543.7
185.0	522.06	15.0M	30.0	8.0E	411.8	4.0E	534.5	15.0E	659.8
190.0	461.27	15.0M	30.0	8.0E	512.5	4.0E	554.0	8.0E	566.5
195.0	441.29	8.0E	585.7	15.0E	627.8	5000.0E	1212.7		
200.0	492.96	8.0E	602.3	15.0E	646.9	30.0E	666.1	5000.0E	1212.7
205.0	616.16	8.0E	539.7	15.0E	604.3	8.0E	610.3	30.0E	670.2
210.0	787.71	8.0E	405.6	4.0E	485.9	8.0E	506.8	15.0E	578.5
215.0	985.40	8.0E	329.1	4.0E	462.4	15.0E	536.0	8.0E	679.6
220.0	1192.76	8.0E	231.6	4.0E	422.1	15.0E	493.7	8.0E	716.5
225.0	1396.53	8.0E	187.1	4.0E	390.2	15.0E	469.6	8.0E	563.2
230.0	1584.96	8.0E	171.7	4.0E	371.9	15.0E	458.5	8.0E	570.5
235.0	1747.29	8.0E	164.4	4.0E	415.5	8.0E	619.7	4.0E	779.3
240.0	1873.89	8.0E	159.3	4.0E	427.2	8.0E	673.6	4.0E	675.9

SELLMEYER ENGINEERING

BROADCAST AND COMMUNICATIONS CONSULTING ENGINEERS

P.O. Box 356 McKinney, Texas 75070

MEMBER AFCCE

(972) 542-2056

EXHIBIT E1-5D, PAGE-2
TABULATION OF CONDUCTIVITIES
RADIO STATION KWAM
990 KHZ, 0.33 KW, 10 KW-LS, DA-2
MEMPHIS, TENNESSEE
=====

Call: KWAM
MEMPHIS, TX
Coordinates: 35 11 45.00 90 00 32.00
Frequency: 990 kHz

Azimuth	Radiation (mV/m at one km)	Ground Conductivity Data: Region conductivity in mS/m followed by distance in km to the end of region. E - map data; M - measurement data.							
245.0	1956.70	8.0E	157.2	4.0E	478.4	8.0E	591.0	30.0E	716.9
250.0	1989.85	8.0E	158.1	4.0E	531.0	30.0E	687.8	15.0E	936.4
255.0	1970.13	8.0E	162.9	4.0E	400.0	15.0E	434.3	4.0E	491.8
260.0	1897.32	8.0E	173.7	4.0E	365.7	15.0E	654.7	30.0E	1066.5
265.0	1774.29	8.0E	195.9	4.0E	335.2	15.0E	624.3	30.0E	772.7
270.0	1606.94	8.0E	240.9	4.0E	313.9	15.0E	625.6	30.0E	736.6
275.0	1403.92	8.0E	312.2	15.0E	383.9	8.0E	453.7	15.0E	578.7
280.0	1176.51	8.0E	480.5	15.0E	557.1	8.0E	639.9	30.0E	807.2
285.0	939.17	5.0M	35.0	8.0E	484.9	15.0E	559.2	8.0E	630.5
290.0	712.29	5.0M	35.0	8.0E	476.2	15.0E	532.0	30.0E	972.2
295.0	530.97	5.0M	35.0	8.0E	462.7	15.0E	525.7	30.0E	1018.1
300.0	455.00	5.0M	35.0	8.0E	462.4	15.0E	559.7	30.0E	1063.0
305.0	516.71	5.0M	35.0	8.0E	440.6	15.0E	591.2	30.0E	823.2
310.0	659.23	8.0E	443.7	15.0E	629.8	30.0E	770.7	15.0E	935.0
315.0	822.55	8.0E	448.6	15.0E	663.0	30.0E	743.3	15.0E	879.3
320.0	979.09	8.0E	447.7	15.0E	694.7	30.0E	761.8	15.0E	827.5
325.0	1117.42	8.0E	448.8	15.0E	729.7	30.0E	808.9	15.0E	1067.5
330.0	1232.50	8.0E	453.4	15.0E	1212.7				
335.0	1322.04	8.0E	464.3	15.0E	945.7	30.0E	1085.6	15.0E	1212.7
340.0	1384.96	5.0M	41.8	8.0E	489.2	15.0E	956.5	30.0E	1059.8
345.0	1420.78	5.0M	41.8	8.0E	526.7	15.0E	1090.6	4.0E	1212.7
350.0	1429.19	5.0M	41.8	8.0E	355.1	15.0E	402.7	8.0E	538.2
355.0	1409.93	5.0M	41.8	8.0E	319.5	15.0E	468.5	8.0E	813.8

AMW™: KWAMD980.am

Prop. method: Groundwave equivalent distance
Ground conduct. map type: US M3
Skywave departure angle method: median
Percent time for skywave field: 10%

Sites

Call sign: KCAB Power: 5,000 kW
Pattern: ND-U Frequency: 980 kHz
Coordinates: N35°12'20.00" W93°10'08.00"

Call sign: KMBZ Power: 5,000 kW
Pattern: ND-U Frequency: 980 kHz
Coordinates: N39°02'17.00" W94°36'55.00"

Call sign: KWAM Power: 10,000 kW
Pattern: DA-U Frequency: 990 kHz
Coordinates: N35°08'04.00" W90°05'38.00"

Call sign: KWAMA* Power: 10,000 kW
Pattern: DA-U Frequency: 990 kHz
Coordinates: N35°11'41.00" W90°00'3 : 00"

Call sign: KOKA Power: 5,000 kW
Pattern: ND-D Frequency: 980 kHz
Coordinates: N32°31'30.00" W93°48'30.00"

Reference Grid (spacing: 1 degree)

AM Allocation Map

Conductivity map

Existing station service contours

Existing station interference contours

Field strength at remote

= 0.500 mV/m
= 0.250 mV/m

Display threshold level: -120.0 dBmW

KILOMETERS



RADIO STATION KWAM

ALLOCATION STUDY-980 KHZ

E1-6A

20010824

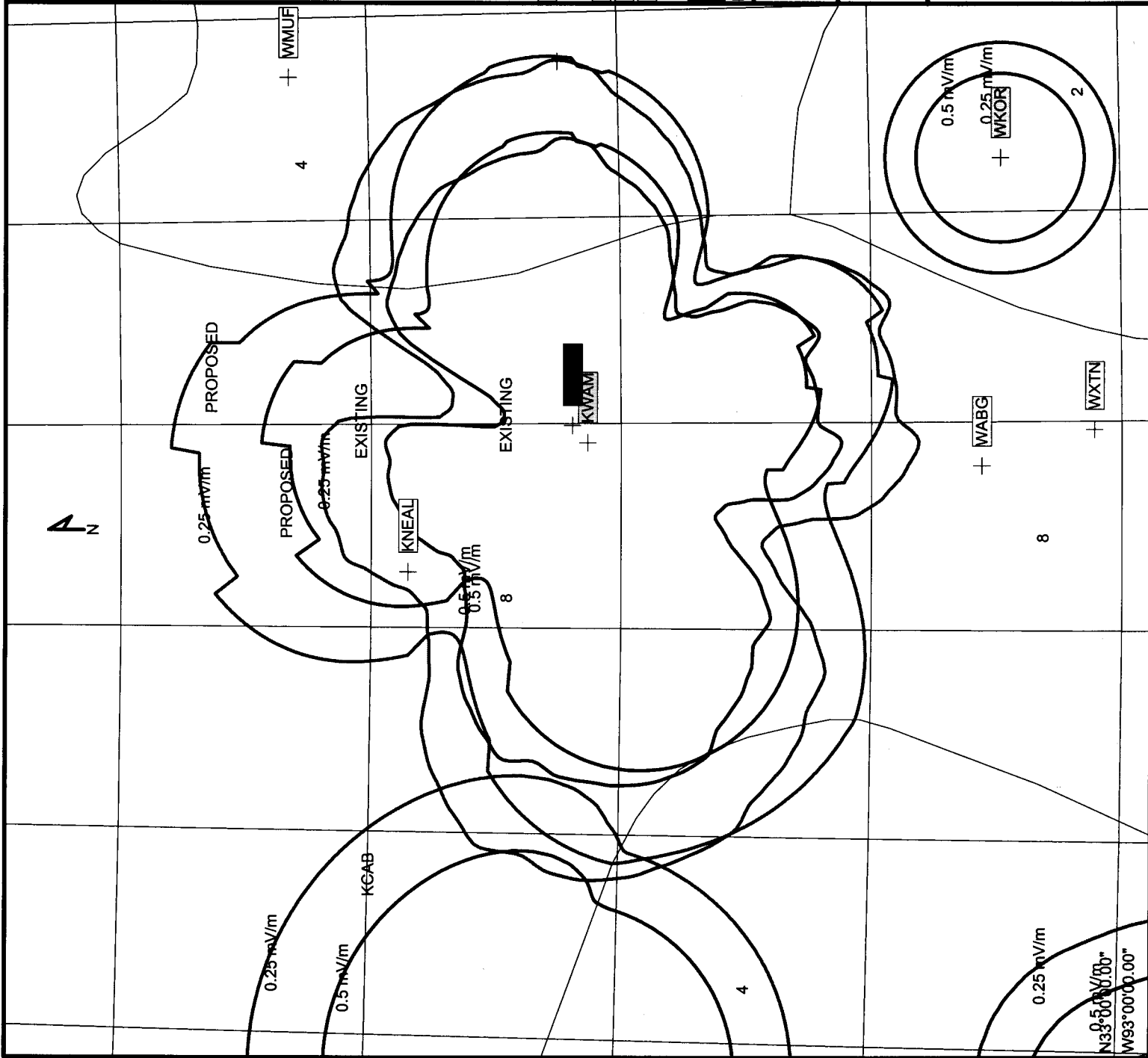

AMW™: KWAMD990.am

Prop. method: Groundwave equivalent distance
Ground conduct. map type: US M3
Skywave departure angle method: median
Percent time for skywave field: 10%

Sites

Call sign: WCAZ Power: 1,000 kW
Pattern: ND-U Frequency: 990 kHz
Coordinates: N40°24'30.00" W91°10'15.00"

Call sign: KRMO Power: 2,500 kW
Pattern: ND-U Frequency: 990 kHz
Coordinates: N36°56'15.00" W93°55'30.00"

Call sign: WEIS Power: 1,000 kW
Pattern: ND-U Frequency: 990 kHz
Coordinates: N34°09'10.00" W85°40'44.00"

Call sign: WLDX Power: 1,000 kW
Pattern: ND-U Frequency: 990 kHz
Coordinates: N33°41'06.00" W87°49'16.00"

Call sign: WITZL Power: 1,000 kW
Pattern: ND-U Frequency: 990 kHz
Coordinates: N38°21'02.00" W86°56'26.00"

Reference Grid (spacing: 1 degree)

AM Allocation Map

Conductivity map

Existing station service contours

Existing station interference contours

Field strength at remote

= 0.500 mV/m
= 0.025 mV/m

Display threshold level: -120.0 dBmW

KILOMETERS



RADIO STATION KWAM

ALLOCATION STUDY-990 KHZ

E1-6B

20010824

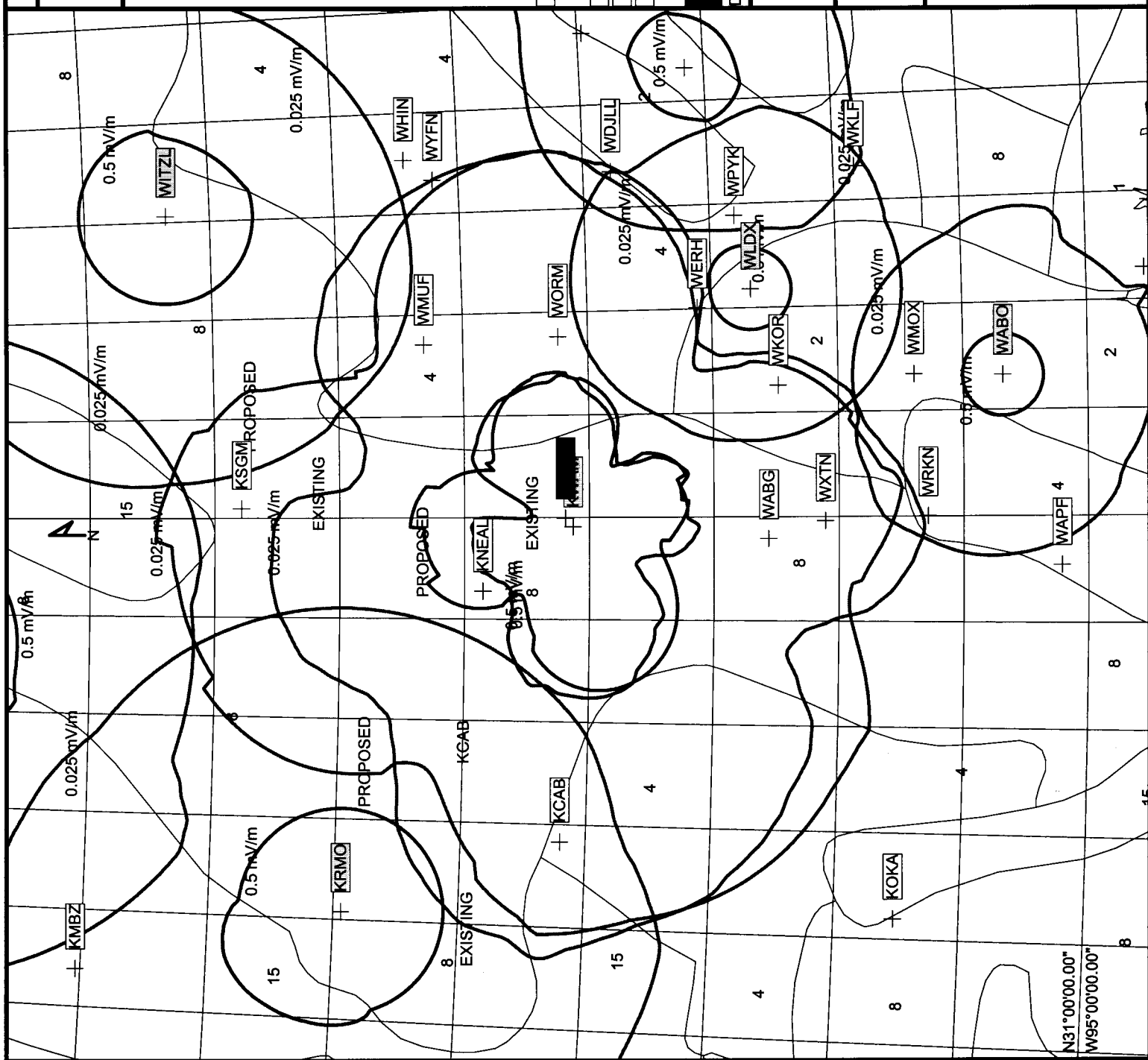

AMW™: KWAMD1000am.am

Prop. method: Groundwave equivalent distance
Ground conduct. map type: US M3
Skywave departure angle method: median
Percent time for skywave field: 10%

Sites

Call sign: WXTN Power: 5,000 kW
Pattern: ND-D Frequency: 1000 kHz
Coordinates: N33°06'39.00" W90°02'21.00"

Call sign: KWAM Power: 10,000 kW
Pattern: DA-U Frequency: 990 kHz
Coordinates: N35°08'04.00" W90°05'38.00"

Call sign: WMUF Power: 5,000 kW
Pattern: DA-D Frequency: 1000 kHz
Coordinates: N36°18'50.00" W88°17'33.00"

Call sign: KWAMA* Power: 10,000 kW
Pattern: DA-U Frequency: 990 kHz
Coordinates: N35°11'41.00" W90°00'30.00"

Reference Grid (spacing: 1 degree)

AM Allocation Map

Conductivity map

Existing station service contours

Existing station interference contours

Field strength at remote

= 0.500 mV/m
= 0.250 mV/m

Display threshold level: -120.0 dBmW

KILOMETERS



RADIO STATION KWAM

ALLOCATION STUDY-1000 KHZ

E1-6C

20010824

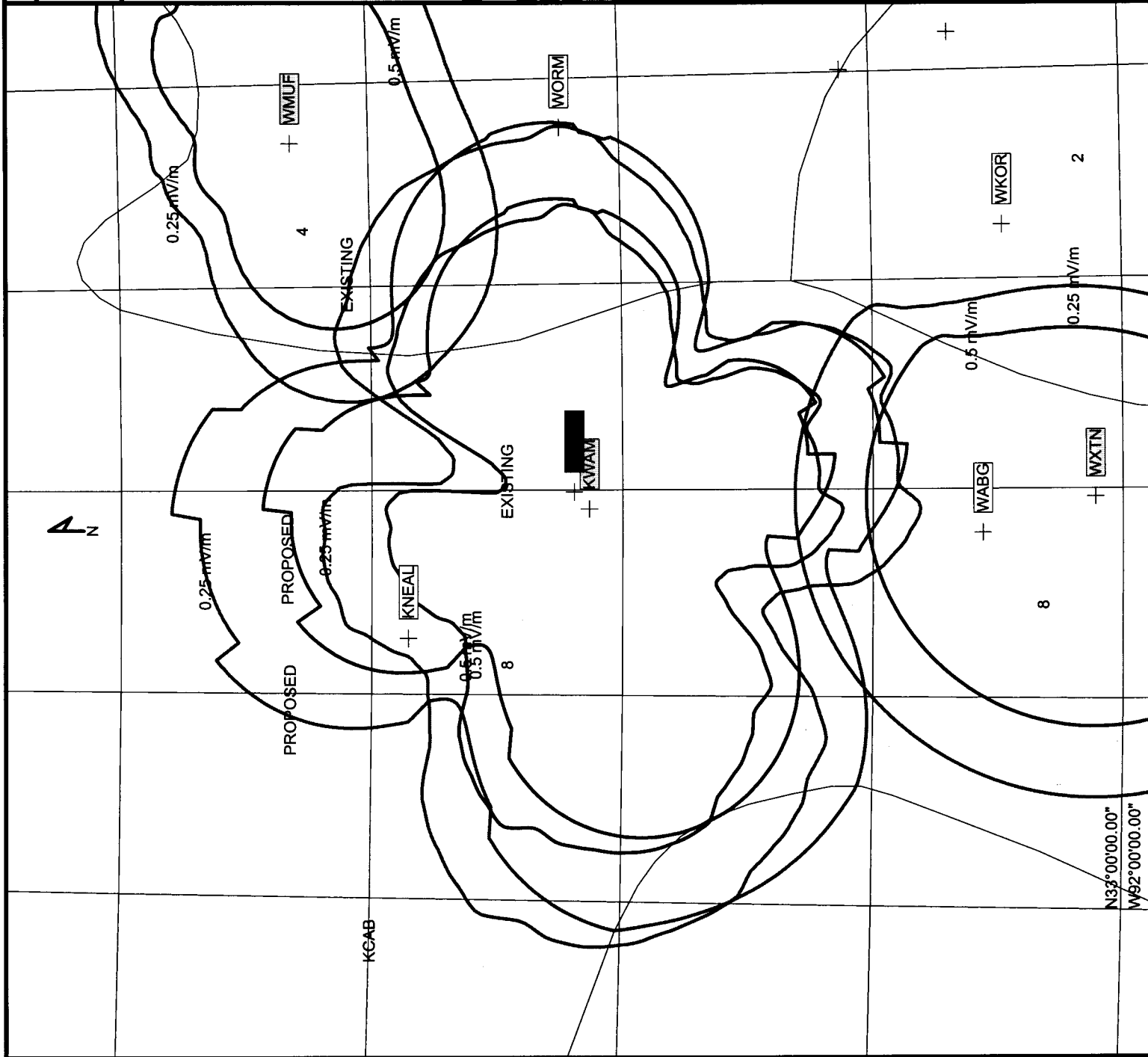

SELLMEYER ENGINEERING

BROADCAST AND COMMUNICATIONS CONSULTING ENGINEERS

P.O. Box 356 McKinney, Texas 75070

MEMBER AFCCE

(972) 542-2056

EXHIBIT E1-7A

TABULATION OF DISTANCES TO CONTOURS

RADIO STATION KWAM

990 KHZ, 0.33 KW, 10 KW-LS, DA-2

MEMPHIS, TENNESSEE

=====

DARDANELLE, AR

Call: KCAB

Coordinates: 35 12 20.00 93 10 08.00

Frequency: 980 kHz Number of contours: 2

Azimuth	Radiation (mV/m at one km)	Distances to Contours in Kilometers:	
		Contour levels in mV/m.	
		0.500	0.250
10.0	766.50	106.12	139.61
15.0	766.50	106.17	139.67
20.0	766.50	106.18	139.67
25.0	766.50	106.15	139.64
30.0	766.50	106.07	139.57
35.0	766.50	105.95	139.44
40.0	766.50	105.78	139.27
45.0	766.50	105.53	139.03
50.0	766.50	105.22	138.71
55.0	766.50	104.81	138.31
60.0	766.50	104.28	137.78
65.0	766.50	103.58	137.07
70.0	766.50	102.66	136.15
75.0	766.50	101.40	134.89
80.0	766.50	99.67	133.16
85.0	766.50	97.17	130.67
90.0	766.50	93.48	126.97
95.0	766.50	87.66	121.15
100.0	766.50	77.51	111.00
105.0	766.50	76.20	102.03
110.0	766.50	76.20	102.03
115.0	766.50	76.20	102.03
120.0	766.50	76.20	102.03
125.0	766.50	76.20	102.03
130.0	766.50	76.20	102.03
135.0	766.50	76.20	102.03
140.0	766.50	76.20	102.03
145.0	766.50	76.20	102.03
150.0	766.50	76.20	102.03
155.0	766.50	76.20	102.03
160.0	766.50	76.20	102.03
165.0	766.50	76.20	102.03
170.0	766.50	76.20	102.03

SELLMEYER ENGINEERING

BROADCAST AND COMMUNICATIONS CONSULTING ENGINEERS

P.O. Box 356 McKinney, Texas 75070

MEMBER AFCCE

(972) 542-2056

EXHIBIT E1-7A, PAGE-2
TABULATION OF DISTANCES TO CONTOURS
RADIO STATION KWAM
990 KHZ, 0.33 KW, 10 KW-LS, DA-2
MEMPHIS, TENNESSEE
=====

STARKVILLE, MS

Call: WKOR

Coordinates: 33 28 44.00 88 44 40.00

Frequency: 980 kHz Number of contours: 2

Azimuth	Radiation (mV/m at one km)	Distances to Contours in Kilometers:	
		Contour levels in mV/m.	
		0.500	0.250
270.0	326.70	37.26	50.97
275.0	326.70	37.26	50.97
280.0	326.70	37.26	50.97
285.0	326.70	37.26	50.97
290.0	326.70	37.26	50.97
295.0	326.70	37.26	50.97
300.0	326.70	37.26	50.97
305.0	326.70	37.26	50.97
310.0	326.70	37.26	50.97
315.0	326.70	37.26	50.97
320.0	326.70	37.26	50.97
325.0	326.70	37.26	50.97
330.0	326.70	37.26	50.97
335.0	326.70	37.26	50.97
340.0	326.70	37.26	50.97
345.0	326.70	37.26	50.97
350.0	326.70	37.26	50.97
355.0	326.70	37.26	50.97

CASSVILLE, MO

Call: KRMO

Coordinates: 36 56 15.00 93 55 30.00

Frequency: 990 kHz Number of contours: 2

Azimuth	Radiation (mV/m at one km)	Distances to Contours in Kilometers:	
		Contour levels in mV/m.	
		0.500	0.025
30.0	478.39	91.22	274.33
35.0	478.39	91.22	268.59
40.0	478.39	91.22	268.59
45.0	478.39	91.22	268.59
50.0	478.39	91.22	268.59
55.0	478.39	91.22	268.59
60.0	478.39	91.22	268.59
65.0	478.39	91.22	268.59
70.0	478.39	91.22	268.59
75.0	478.39	91.22	268.59
80.0	478.39	91.22	268.59
85.0	478.39	91.22	268.59
90.0	478.39	91.22	268.59
95.0	478.39	91.22	268.59
100.0	478.39	91.22	268.59
105.0	478.39	91.22	268.59
110.0	478.39	91.22	268.59
115.0	478.39	91.22	268.59
120.0	478.39	91.22	268.59
125.0	478.39	91.22	268.59
130.0	478.39	91.22	268.59
135.0	478.39	91.22	268.59
140.0	478.39	91.22	268.59

SELLMEYER ENGINEERING

BROADCAST AND COMMUNICATIONS CONSULTING ENGINEERS

P.O. Box 356 McKinney, Texas 75070

MEMBER AFCCE

(972) 542-2056

EXHIBIT E1-7A, PAGE-3
TABULATION OF DISTANCES TO CONTOURS
RADIO STATION KWAM
990 KHZ, 0.33 KW, 10 KW-LS, DA-2
MEMPHIS, TENNESSEE
=====

CASSVILLE, MO

Call: KRMO

Coordinates: 36 56 15.00 93 55 30.00

Frequency: 990 kHz Number of contours: 2

Azimuth	Radiation (mV/m at one km)	Distances to Contours in Kilometers:	
		Contour levels in mV/m.	
		0.500	0.025
145.0	478.39	91.22	266.20
150.0	478.39	91.22	262.42
155.0	478.39	91.22	259.26
160.0	478.39	91.22	256.63
165.0	478.39	91.22	258.53
170.0	478.39	91.22	265.85
175.0	478.39	91.22	272.87
180.0	478.39	91.22	280.38
185.0	478.39	91.22	285.91
190.0	478.39	91.22	284.40

JASPER, IN

Call: WITZ

Coordinates: 38 21 02.00 86 56 26.00

Frequency: 990 kHz Number of contours: 2

Azimuth	Radiation (mV/m at one km)	Distances to Contours in Kilometers:	
		Contour levels in mV/m.	
		0.500	0.025
130.6	317.04	67.59	193.26
135.6	317.04	68.18	193.84
140.6	317.04	68.92	194.59
145.6	317.04	69.88	195.55
150.6	317.04	71.13	196.79
155.6	317.04	72.77	198.44
160.6	317.04	74.85	200.51
165.6	317.04	77.28	203.16
170.6	317.04	77.28	205.58
175.6	317.04	77.28	208.62
180.6	317.04	77.28	212.54
185.6	317.04	77.28	216.41
190.6	317.04	77.28	220.60
195.6	317.04	77.28	224.74
200.6	317.04	77.28	228.81
205.6	317.04	77.28	231.39
210.6	317.04	77.28	233.01
215.6	317.04	77.28	233.75
220.6	317.04	77.28	232.90
225.6	317.04	77.28	232.05
230.6	317.04	77.28	232.01
235.6	317.04	77.28	236.36
240.6	317.04	77.28	236.36
245.6	317.04	77.28	236.36
250.6	317.04	77.28	236.36
255.6	317.04	77.28	236.36
260.6	317.04	77.28	236.36
265.6	317.04	77.28	236.36
270.6	317.04	77.28	236.63
275.6	317.04	77.28	239.16
280.6	317.04	77.28	241.13
285.6	317.04	77.28	242.39

SELLMEYER ENGINEERING
 BROADCAST AND COMMUNICATIONS CONSULTING ENGINEERS
 P.O. Box 356 McKinney, Texas 75070
 MEMBER AFCCE
 (972) 542-2056

EXHIBIT E1-7A, PAGE-4
 TABULATION OF DISTANCES TO CONTOURS
 RADIO STATION KWAM
 990 KHZ, 0.33 KW, 10 KW-LS, DA-2
 MEMPHIS, TENNESSEE
 =====

HUNTSVILLE, AL

Call: WDJL

Coordinates: 34 46 47.00 86 39 16.00

Frequency: 1000 kHz Number of contours: 2

Azimuth	Radiation (mV/m at one km)	Distances to Contours in Kilometers:	
		Contour levels in mV/m.	
		0.500	0.250
200.1	546.86	49.54	66.77
205.1	537.99	50.07	67.17
210.1	492.59	49.85	66.31
215.1	412.46	50.63	65.84
220.1	383.83	56.82	76.25
225.1	422.10	59.16	79.41
230.1	472.98	62.09	83.34
235.1	520.51	64.66	86.78
240.1	649.32	71.02	95.22
245.1	768.85	76.30	102.16
250.1	872.13	80.52	107.63
255.1	956.31	83.72	111.77
260.1	1020.72	86.06	114.79
265.1	1065.82	87.64	116.84
270.1	1133.18	89.93	119.77
275.1	1140.10	90.16	120.07
280.1	1105.81	89.01	118.59
285.1	1101.29	88.86	118.40
290.1	1059.20	87.41	116.55
295.1	986.23	84.82	113.19
300.1	897.50	81.51	108.91
305.1	804.08	77.77	104.07
310.1	707.92	73.67	98.71
315.1	602.60	68.81	92.29
320.1	474.39	62.17	83.45
325.1	394.95	57.51	77.18
330.1	392.31	57.35	76.96
335.1	450.62	60.82	81.65
340.1	520.35	64.66	86.77
345.1	551.16	66.25	88.89
350.1	555.18	66.46	89.16
355.1	546.38	66.01	88.57

SELLMEYER ENGINEERING

BROADCAST AND COMMUNICATIONS CONSULTING ENGINEERS

P.O. Box 356 McKinney, Texas 75070

MEMBER AFCCE

(972) 542-2056

EXHIBIT E1-7A, PAGE-5
TABULATION OF DISTANCES TO CONTOURS
RADIO STATION KWAM
990 KHZ, 0.33 KW, 10 KW-LS, DA-2
MEMPHIS, TENNESSEE
=====

FAYETTE, AL

Call: WLDX

Coordinates: 33 41 06.00 87 49 16.00

Frequency: 990 kHz Number of contours: 2

Azimuth	Radiation (mV/m at one km)	Distances to Contours in Kilometers:	
		Contour levels in mV/m.	
		0.500	0.025
0.0	302.56	36.32	160.00
5.0	302.56	37.20	160.87
10.0	302.56	37.90	161.57
15.0	302.56	38.45	162.13
20.0	302.56	38.89	162.57
25.0	302.56	39.23	162.90
30.0	302.56	39.57	163.25
35.0	302.56	39.88	163.56
40.0	302.56	40.11	163.78
45.0	302.56	40.25	149.90
50.0	302.56	40.32	147.19
200.0	302.56	35.99	133.66
205.0	302.56	35.99	133.66
210.0	302.56	35.99	133.66
215.0	302.56	35.99	133.66
220.0	302.56	35.99	133.66
225.0	302.56	35.99	133.66
230.0	302.56	35.99	133.66
235.0	302.56	35.99	133.66
240.0	302.56	35.99	133.66
245.0	302.56	35.99	133.66
250.0	302.56	35.99	133.66
255.0	302.56	35.99	133.66
260.0	302.56	35.99	133.66
265.0	302.56	35.99	133.66
270.0	302.56	35.99	133.66
275.0	302.56	35.99	133.66
280.0	302.56	35.99	134.99
285.0	302.56	35.99	136.12
290.0	302.56	35.99	136.83
295.0	302.56	35.99	137.10
300.0	302.56	35.99	136.19

SELLMEYER ENGINEERING

BROADCAST AND COMMUNICATIONS CONSULTING ENGINEERS

P.O. Box 356 McKinney, Texas 75070

MEMBER AFCCE

(972) 542-2056

EXHIBIT E1-7A, PAGE-6
TABULATION OF DISTANCES TO CONTOURS
RADIO STATION KWAM
990 KHZ, 0.33 KW, 10 KW-LS, DA-2
MEMPHIS, TENNESSEE
=====

FAYETTE, AL

Call: WLDX

Coordinates: 33 41 06.00 87 49 16.00

Frequency: 990 kHz Number of contours: 2

Azimuth	Radiation (mV/m at one km)	Distances to Contours in Kilometers:	
		Contour levels in mV/m.	
		0.500	0.025
305.0	302.56	35.99	136.52
310.0	302.56	35.99	139.34
315.0	302.56	35.99	142.33
320.0	302.56	35.99	145.52
325.0	302.56	35.99	148.39
330.0	302.56	35.99	150.67
335.0	302.56	35.99	152.77
340.0	302.56	35.99	154.80
345.0	302.56	35.99	156.32
350.0	302.56	35.99	157.52
355.0	302.56	35.99	158.90

WAYNESBORO, MS

Call: WABO

Coordinates: 31 40 48.00 88 40 34.00

Frequency: 990 kHz Number of contours: 2

Azimuth	Radiation (mV/m at one km)	Distances to Contours in Kilometers:	
		Contour levels in mV/m.	
		0.500	0.025
0.0	304.17	36.08	133.94
5.0	304.17	36.08	133.94
10.0	304.17	36.08	133.94
15.0	304.17	36.08	133.94
20.0	304.17	36.08	133.94
25.0	304.17	36.08	133.94
30.0	304.17	36.08	133.94
300.0	304.17	36.19	161.32
305.0	304.17	36.08	162.67
310.0	304.17	36.08	164.02
315.0	304.17	36.08	160.62
320.0	304.17	36.08	154.62
325.0	304.17	36.08	148.59

SELLMEYER ENGINEERING

BROADCAST AND COMMUNICATIONS CONSULTING ENGINEERS

P.O. Box 356 McKinney, Texas 75070

MEMBER AFCCE

(972) 542-2056

EXHIBIT E1-7A, PAGE-7
TABULATION OF DISTANCES TO CONTOURS
RADIO STATION KWAM
990 KHZ, 0.33 KW, 10 KW-LS, DA-2
MEMPHIS, TENNESSEE
=====

WAYNESBORO, MS

Call: WABO

Coordinates: 31 40 48.00 88 40 34.00

Frequency: 990 kHz Number of contours: 2

Azimuth	Radiation (mV/m at one km)	Distances to Contours in Kilometers:	
		Contour levels in mV/m.	
		0.500	0.025
330.0	304.17	36.08	146.32
335.0	304.17	36.08	143.79
340.0	304.17	36.08	139.82
345.0	304.17	36.08	133.94
350.0	304.17	36.08	133.94
355.0	304.17	36.08	133.94

PARIS, TN

Call: WMUF

Coordinates: 36 18 50.00 88 17 33.00

Frequency: 1000 kHz Number of contours: 2

Azimuth	Radiation (mV/m at one km)	Distances to Contours in Kilometers:	
		Contour levels in mV/m.	
		0.500	0.025
150.0	416.31	58.81	78.94
155.0	402.27	57.96	77.79
160.0	397.59	57.68	77.40
165.0	402.27	57.96	77.79
170.0	416.31	58.81	78.94
175.0	439.64	60.19	80.80
180.0	472.05	62.04	83.27
185.0	513.04	64.27	86.25
190.0	561.77	66.79	89.61
195.0	616.97	69.50	93.21
200.0	676.99	72.29	96.89
205.0	739.78	75.05	100.54
210.0	802.98	77.73	104.01
215.0	863.98	80.20	107.21
220.0	920.04	82.37	110.02
225.0	968.46	84.17	112.35
230.0	1006.66	85.56	114.14

SELLMEYER ENGINEERING

BROADCAST AND COMMUNICATIONS CONSULTING ENGINEERS

P.O. Box 356 McKinney, Texas 75070

MEMBER AFCCE

(972) 542-2056

EXHIBIT E1-7A, PAGE-8
TABULATION OF DISTANCES TO CONTOURS
RADIO STATION KWAM
990 KHZ, 0.33 KW, 10 KW-LS, DA-2
MEMPHIS, TENNESSEE
=====

PARIS, TN

Call: WMUF

Coordinates: 36 18 50.00 88 17 33.00

Frequency: 1000 kHz Number of contours: 2

Azimuth	Radiation (mV/m at one km)	Distances to Contours in Kilometers:	
		Contour levels in mV/m.	
		0.500	0.250
235.0	1032.40	86.47	115.82
240.0	1043.93	86.88	117.75
245.0	1040.11	86.75	118.87
250.0	1020.48	86.05	119.02
255.0	985.37	84.79	117.94
260.0	935.81	82.96	115.69
265.0	873.54	80.58	112.35
270.0	800.85	77.64	108.07
275.0	720.50	74.22	102.67
280.0	635.50	70.38	96.27
285.0	549.07	66.15	88.91
290.0	464.49	61.61	82.71
295.0	385.15	56.90	76.36
300.0	314.59	52.21	70.08
305.0	256.63	47.88	64.28
310.0	215.07	44.39	59.63
315.0	192.10	42.30	56.84
320.0	185.76	41.69	56.04
325.0	189.87	42.09	56.56
330.0	197.53	42.81	57.52

LEXINGTON, MS

Call: WXTN

Coordinates: 33 06 39.00 90 02 21.00

Frequency: 1000 kHz Number of contours: 2

Azimuth	Radiation (mV/m at one km)	Distances to Contours in Kilometers:	
		Contour levels in mV/m.	
		0.500	0.250
0.0	633.34	101.91	133.31
5.0	633.34	101.91	133.31
10.0	633.34	101.91	133.31
15.0	633.34	101.91	133.31
20.0	633.34	101.91	133.31

SELLMEYER ENGINEERING

BROADCAST AND COMMUNICATIONS CONSULTING ENGINEERS

P.O. Box 356 McKinney, Texas 75070

MEMBER AFCCE

(972) 542-2056

EXHIBIT E1-7A, PAGE-9
TABULATION OF DISTANCES TO CONTOURS
RADIO STATION KWAM
990 KHZ, 0.33 KW, 10 KW-LS, DA-2
MEMPHIS, TENNESSEE
=====

LEXINGTON, MS

Call: WXTN

Coordinates: 33 06 39.00 90 02 21.00

Frequency: 1000 kHz Number of contours: 2

Azimuth	Radiation (mV/m at one km)	Distances to Contours in Kilometers:	
		Contour levels in mV/m. 0.500	0.250
25.0	633.34	101.91	133.31
30.0	633.34	101.91	133.31
35.0	633.34	101.91	133.31
40.0	633.34	101.91	130.55
45.0	633.34	99.37	117.71
50.0	633.34	91.92	110.26
55.0	633.34	86.59	104.93
60.0	633.34	82.86	101.20
300.0	633.34	101.91	133.31
305.0	633.34	101.91	133.31
310.0	633.34	101.91	133.31
315.0	633.34	101.91	133.31
320.0	633.34	101.91	133.31
325.0	633.34	101.91	133.31
330.0	633.34	101.91	133.31
335.0	633.34	101.91	133.31
340.0	633.34	101.91	133.31
345.0	633.34	101.91	133.31
350.0	633.34	101.91	133.31
355.0	633.34	101.91	133.31

SELLMEYER ENGINEERING

BROADCAST AND COMMUNICATIONS CONSULTING ENGINEERS

P.O. Box 356 McKinney, Texas 75070

MEMBER AFCCE

(972) 542-2056

EXHIBIT E1-7B

TABULATION OF CONDUCTIVITIES

RADIO STATION KWAM

990 KHZ, 0.33 KW, 10 KW-LS, DA-2

MEMPHIS, TENNESSEE

=====

Call: KCAB

DARDANELLE, AR

Coordinates: 35 12 20.00 93 10 0-8.00

Frequency: 980 kHz

Azimuth	Radiation (mV/m at one km)	Ground Conductivity Data:							
		Region conductivity in mS/m followed by distance in km to the end of region. E - map data; M - measurement data.							
10.0	766.50	4.0E	11.0	8.0E	419.7	15.0E	663.3	8.0E	847.7
15.0	766.50	4.0E	10.9	8.0E	527.5	15.0E	645.0	8.0E	858.5
20.0	766.50	4.0E	10.9	8.0E	1551.9				
25.0	766.50	4.0E	10.9	8.0E	978.1	15.0E	1025.1	8.0E	1551.9
30.0	766.50	4.0E	11.1	8.0E	415.1	15.0E	833.5	8.0E	1085.1
35.0	766.50	4.0E	11.3	8.0E	406.0	15.0E	719.3	8.0E	971.0
40.0	766.50	4.0E	11.6	8.0E	411.1	15.0E	563.3	8.0E	955.7
45.0	766.50	4.0E	12.1	8.0E	809.7	15.0E	947.9	8.0E	1172.1
50.0	766.50	4.0E	12.7	8.0E	904.2	15.0E	1001.0	8.0E	1037.5
55.0	766.50	4.0E	13.5	8.0E	1551.9				
60.0	766.50	4.0E	14.5	8.0E	418.5	4.0E	449.0	8.0E	668.8
65.0	766.50	4.0E	15.7	8.0E	388.3	4.0E	458.4	8.0E	607.6
70.0	766.50	4.0E	17.4	8.0E	369.4	4.0E	802.2	8.0E	875.2
75.0	766.50	4.0E	19.6	8.0E	357.6	4.0E	759.0	2.0E	1018.1
80.0	766.50	4.0E	22.6	8.0E	353.1	4.0E	749.4	2.0E	918.8
85.0	766.50	4.0E	27.1	8.0E	354.3	4.0E	674.3	2.0E	1134.0
90.0	766.50	4.0E	33.9	8.0E	364.1	4.0E	620.9	2.0E	717.1
95.0	766.50	4.0E	46.0	8.0E	377.4	4.0E	583.1	2.0E	688.1
100.0	766.50	4.0E	72.2	8.0E	387.6	4.0E	561.5	2.0E	651.9
105.0	766.50	4.0E	119.3	8.0E	393.3	2.0E	528.0	4.0E	678.0
110.0	766.50	4.0E	145.6	8.0E	391.3	2.0E	581.7	4.0E	1166.8
115.0	766.50	4.0E	162.4	8.0E	391.3	2.0E	615.3	4.0E	698.8
120.0	766.50	4.0E	177.6	8.0E	396.0	2.0E	636.1	8.0E	769.5
125.0	766.50	4.0E	194.4	8.0E	408.1	2.0E	649.5	8.0E	743.6
130.0	766.50	4.0E	207.4	8.0E	430.1	2.0E	460.0	4.0E	523.9
135.0	766.50	4.0E	216.1	8.0E	430.5	4.0E	547.2	2.0E	696.3
140.0	766.50	4.0E	226.5	8.0E	430.5	4.0E	570.8	2.0E	693.2
145.0	766.50	4.0E	239.8	8.0E	469.0	4.0E	604.3	2.0E	655.1
150.0	766.50	4.0E	255.7	8.0E	502.0	4.0E	622.1	15.0E	632.5
155.0	766.50	4.0E	275.1	8.0E	532.6	4.0E	587.1	15.0E	687.1
160.0	766.50	4.0E	300.5	8.0E	595.5	15.0E	708.4	5000.0E	1551.9
165.0	766.50	4.0E	368.2	8.0E	586.7	15.0E	650.7	5000.0E	1551.9
170.0	766.50	4.0E	437.2	8.0E	519.8	15.0E	542.3	8.0E	577.3

SELLMEYER ENGINEERING

BROADCAST AND COMMUNICATIONS CONSULTING ENGINEERS

P.O. Box 356 McKinney, Texas 75070

MEMBER AFCCE

(972) 542-2056

EXHIBIT E1-7B, PAGE-2 TABULATION OF CONDUCTIVITIES RADIO STATION KWAM 990 KHZ, 0.33 KW, 10 KW-LS, DA-2 MEMPHIS, TENNESSEE

Call: WKOR
STARKVILLE, MS
Coordinates: 33 28 44.00 88 44 40.00
Frequency: 980 kHz

Azimuth	Radiation (mV/m at one km)	Ground Conductivity Data: Region conductivity in mS/m followed by distance in km to the end of region. E - map data; M - measurement data.							
270.0	326.70	2.0E	63.3	8.0E	272.3	4.0E	624.6	30.0E	765.8
275.0	326.70	2.0E	61.2	8.0E	264.1	4.0E	598.4	30.0E	650.0
280.0	326.70	2.0E	59.8	8.0E	258.3	4.0E	512.4	15.0E	751.5
285.0	326.70	2.0E	58.8	8.0E	256.1	4.0E	496.0	15.0E	766.6
290.0	326.70	2.0E	58.3	8.0E	265.1	4.0E	479.8	15.0E	731.6
295.0	326.70	2.0E	58.3	8.0E	281.9	4.0E	470.6	15.0E	545.1
300.0	326.70	2.0E	58.5	8.0E	667.3	15.0E	728.1	30.0E	1347.4
305.0	326.70	2.0E	59.1	8.0E	658.9	15.0E	718.0	30.0E	1347.4
310.0	326.70	2.0E	60.3	8.0E	667.0	15.0E	778.7	30.0E	1347.4
315.0	326.70	2.0E	61.9	8.0E	654.9	15.0E	838.4	30.0E	983.7
320.0	326.70	2.0E	64.1	8.0E	667.6	15.0E	890.9	30.0E	960.5
325.0	326.70	2.0E	67.0	8.0E	670.4	15.0E	937.8	30.0E	1347.4
330.0	326.70	2.0E	70.8	8.0E	676.4	15.0E	1347.4		
335.0	326.70	2.0E	75.6	8.0E	694.0	15.0E	1159.2	30.0E	1347.4
340.0	326.70	2.0E	82.5	8.0E	740.8	15.0E	1216.5	30.0E	1247.1
345.0	326.70	2.0E	93.9	8.0E	526.4	15.0E	644.8	8.0E	752.6
350.0	326.70	2.0E	94.4	4.0E	297.0	8.0E	532.4	15.0E	717.5
355.0	326.70	2.0E	92.7	4.0E	385.6	8.0E	574.4	15.0E	784.7

Call: KRMO
CASSVILLE, MO
Coordinates: 36 56 15.00 93 55 30.00
Frequency: 990 kHz

Azimuth	Radiation (mV/m at one km)	Ground Conductivity Data: Region conductivity in mS/m followed by distance in km to the end of region. E - map data; M - measurement data.							
30.0	478.39	8.0E	227.8	15.0E	485.5	8.0E	891.4	15.0E	975.0
35.0	478.39	8.0E	410.6	15.0E	462.4	8.0E	827.3	15.0E	857.6
40.0	478.39	8.0E	953.6	2.0E	1035.5	8.0E	1106.5		
45.0	478.39	8.0E	436.3	15.0E	723.0	8.0E	883.8	2.0E	950.5
50.0	478.39	8.0E	362.0	15.0E	621.1	8.0E	850.2	2.0E	941.5
55.0	478.39	8.0E	327.3	15.0E	558.3	8.0E	1088.2	20.0E	1106.5
60.0	478.39	8.0E	322.5	15.0E	497.6	8.0E	744.2	15.0E	923.9
65.0	478.39	8.0E	332.2	15.0E	427.3	8.0E	962.8	15.0E	1008.4
70.0	478.39	8.0E	1064.5	4.0E	1106.5				
75.0	478.39	8.0E	680.6	4.0E	726.8	8.0E	924.0	2.0E	1106.5
80.0	478.39	8.0E	645.0	4.0E	842.0	8.0E	908.1	2.0E	1106.5
85.0	478.39	8.0E	610.2	4.0E	817.4	2.0E	1080.2	4.0E	1094.8
90.0	478.39	8.0E	424.4	4.0E	486.9	8.0E	559.8	4.0E	798.7
95.0	478.39	8.0E	419.5	4.0E	803.1	2.0E	1106.5		
100.0	478.39	8.0E	420.2	4.0E	749.0	2.0E	1088.5	4.0E	1106.5
105.0	478.39	8.0E	427.6	4.0E	715.3	2.0E	802.7	4.0E	878.3
110.0	478.39	8.0E	447.4	4.0E	692.7	2.0E	786.5	4.0E	832.3
115.0	478.39	8.0E	483.9	4.0E	685.8	2.0E	762.6	4.0E	812.3
120.0	478.39	8.0E	521.1	4.0E	561.3	2.0E	687.3	4.0E	1106.5
125.0	478.39	8.0E	540.7	2.0E	767.5	4.0E	845.7	8.0E	921.8
130.0	478.39	8.0E	553.8	2.0E	807.2	8.0E	945.3	4.0E	996.6
135.0	478.39	8.0E	577.2	2.0E	836.9	8.0E	863.2	1.0E	991.3
140.0	478.39	8.0E	294.9	4.0E	334.5	8.0E	619.6	2.0E	635.0

SELLMEYER ENGINEERING

BROADCAST AND COMMUNICATIONS CONSULTING ENGINEERS

P.O. Box 356 McKinney, Texas 75070

MEMBER AFCCE

(972) 542-2058

EXHIBIT E1-7B, PAGE-3 TABULATION OF CONDUCTIVITIES

RADIO STATION KWAM
990 KHZ, 0.33 KW, 10 KW-LS, DA-2
MEMPHIS, TENNESSEE

=====

Call: KRMO

CASSVILLE, MO

Coordinates: 36 56 15.00 93 55 30.00

Frequency: 990 kHz

Azimuth	Radiation (mV/m at one km)	Ground Conductivity Data:							
		Region conductivity in mS/m followed by distance in km to the end of region. E - map data; M - measurement data.							
145.0	478.39	8.0E	251.0	4.0E	397.9	8.0E	618.5	4.0E	765.4
150.0	478.39	8.0E	225.6	4.0E	427.5	8.0E	677.2	4.0E	822.1
155.0	478.39	8.0E	206.3	4.0E	462.8	8.0E	724.8	4.0E	794.1
160.0	478.39	8.0E	191.3	4.0E	506.2	8.0E	801.5	15.0E	917.8
165.0	478.39	8.0E	178.8	15.0E	192.0	4.0E	638.6	8.0E	784.0
170.0	478.39	8.0E	168.9	15.0E	211.6	4.0E	437.4	15.0E	751.2
175.0	478.39	8.0E	164.4	15.0E	234.0	4.0E	436.3	15.0E	569.4
180.0	478.39	8.0E	163.2	15.0E	261.9	4.0E	415.8	8.0E	761.6
185.0	478.39	8.0E	164.5	15.0E	307.3	4.0E	410.4	8.0E	575.3
190.0	478.39	8.0E	171.6	15.0E	320.7	4.0E	411.8	8.0E	575.2

Call: WITZ

JASPER, IN

Coordinates: 38 21 02.00 86 56 26.00

Frequency: 990 kHz

Azimuth	Radiation (mV/m at one km)	Ground Conductivity Data:							
		Region conductivity in mS/m followed by distance in km to the end of region. E - map data; M - measurement data.							
130.0	317.04	8.0E	46.8	4.0E	241.5	2.0E	612.0	4.0E	687.9
135.0	317.04	8.0E	48.5	4.0E	253.5	2.0E	574.4	4.0E	686.2
140.0	317.04	8.0E	50.6	4.0E	271.7	2.0E	558.4	4.0E	692.3
145.0	317.04	8.0E	53.3	4.0E	313.3	2.0E	557.5	4.0E	910.5
150.0	317.04	8.0E	56.9	4.0E	317.0	2.0E	394.5	4.0E	450.0
155.0	317.04	8.0E	61.9	4.0E	321.8	2.0E	391.2	4.0E	476.0
160.0	317.04	8.0E	68.3	4.0E	331.1	2.0E	416.0	4.0E	481.2
165.0	317.04	8.0E	76.9	4.0E	345.3	2.0E	448.3	4.0E	500.3
170.0	317.04	8.0E	85.4	4.0E	366.0	2.0E	478.4	4.0E	534.1
175.0	317.04	8.0E	96.3	4.0E	394.4	2.0E	509.6	4.0E	666.7
180.0	317.04	8.0E	111.4	4.0E	431.9	2.0E	507.9	4.0E	672.2
185.0	317.04	8.0E	128.0	4.0E	531.0	2.0E	758.7	8.0E	788.0
190.0	317.04	8.0E	147.3	4.0E	487.5	2.0E	901.0	5000.0E	1333.1
195.0	317.04	8.0E	167.4	4.0E	474.9	2.0E	717.5	4.0E	720.5
200.0	317.04	8.0E	188.8	4.0E	477.4	2.0E	690.2	4.0E	932.6
205.0	317.04	8.0E	204.2	4.0E	448.5	8.0E	1003.3	15.0E	1333.1
210.0	317.04	8.0E	214.2	4.0E	406.1	8.0E	996.5	15.0E	1004.8
215.0	317.04	8.0E	220.2	4.0E	372.2	8.0E	859.1	4.0E	927.9
220.0	317.04	8.0E	215.2	4.0E	333.6	8.0E	671.2	4.0E	871.2
225.0	317.04	8.0E	210.0	4.0E	292.9	8.0E	593.5	4.0E	810.5
230.0	317.04	8.0E	208.9	4.0E	256.9	8.0E	582.5	4.0E	852.8
235.0	317.04	8.0E	606.3	4.0E	929.3	8.0E	1001.9	30.0E	1118.2
240.0	317.04	8.0E	644.6	4.0E	692.6	15.0E	935.5	30.0E	1077.9
245.0	317.04	8.0E	701.7	15.0E	1018.0	30.0E	1137.1	15.0E	1333.1
250.0	317.04	8.0E	792.4	15.0E	961.7	30.0E	1118.7	15.0E	1163.8
255.0	317.04	8.0E	767.0	15.0E	851.0	8.0E	946.9	15.0E	986.8
260.0	317.04	8.0E	696.4	15.0E	772.0	30.0E	1079.4	15.0E	1333.1
265.0	317.04	8.0E	259.2	15.0E	298.9	8.0E	614.4	15.0E	756.8
270.0	317.04	8.0E	236.6	15.0E	325.5	8.0E	563.8	15.0E	752.2
275.0	317.04	8.0E	219.7	15.0E	340.0	8.0E	507.4	15.0E	751.0
280.0	317.04	8.0E	207.3	15.0E	339.1	8.0E	468.1	15.0E	746.1
285.0	317.04	8.0E	199.5	15.0E	333.5	8.0E	448.1	15.0E	736.8

SELLMEYER ENGINEERING

BROADCAST AND COMMUNICATIONS CONSULTING ENGINEERS
P.O. Box 356 McKinney, Texas 75070
MEMBER AFCCE
(972) 542-2056

EXHIBIT E1-7B, PAGE-4
TABULATION OF CONDUCTIVITIES
RADIO STATION KWAM
990 KHZ, 0.33 KW, 10 KW-LS, DA-2
MEMPHIS, TENNESSEE
=====

Call: WDJL
HUNTSVILLE, AL
Coordinates: 34 46 47.00 86 39 16.00
Frequency: 1000 kHz

Azimuth	Radiation (mV/m at one km)	Ground Conductivity Data:							
		Region conductivity in mS/m followed by distance in km to the end of region. E - map data; M - measurement data.							
200.1	546.86	4.0E	9.0	2.0E	105.5	4.0E	174.5	2.0E	524.0
205.1	537.99	4.0E	11.6	2.0E	99.4	4.0E	158.0	2.0E	538.4
210.1	492.59	4.0E	16.2	2.0E	92.0	4.0E	148.6	2.0E	600.2
215.1	412.46	4.0E	29.2	2.0E	78.9	4.0E	141.6	2.0E	376.9
220.1	383.83	4.0E	138.3	2.0E	340.8	4.0E	647.6	8.0E	666.3
225.1	422.10	4.0E	136.4	2.0E	356.8	4.0E	496.3	8.0E	717.4
230.1	472.98	4.0E	137.3	2.0E	367.8	8.0E	400.5	4.0E	438.9
235.1	520.51	4.0E	139.3	2.0E	333.5	8.0E	691.2	15.0E	749.9
240.1	649.32	4.0E	145.2	2.0E	301.0	8.0E	598.8	4.0E	669.3
245.1	768.85	4.0E	154.1	2.0E	269.7	8.0E	565.2	4.0E	646.0
250.1	872.13	4.0E	169.1	2.0E	243.8	8.0E	515.1	4.0E	627.2
255.1	956.31	4.0E	198.0	2.0E	226.1	8.0E	476.1	4.0E	676.2
260.1	1020.72	4.0E	218.4	8.0E	448.3	4.0E	786.4	8.0E	840.0
265.1	1065.82	4.0E	215.5	8.0E	444.1	4.0E	787.8	30.0E	845.3
270.1	1133.18	4.0E	217.0	8.0E	454.0	4.0E	666.0	15.0E	932.0
275.1	1140.10	4.0E	222.1	8.0E	513.3	4.0E	625.3	15.0E	938.9
280.1	1105.81	4.0E	230.9	8.0E	785.2	15.0E	866.8	8.0E	954.9
285.1	1101.29	4.0E	242.3	8.0E	790.8	15.0E	860.0	30.0E	1474.5
290.1	1059.20	4.0E	254.0	8.0E	763.2	15.0E	822.9	30.0E	1474.5
295.1	986.23	4.0E	266.2	8.0E	730.8	15.0E	860.7	30.0E	1474.5
300.1	897.50	4.0E	277.8	8.0E	722.1	15.0E	894.9	30.0E	1089.4
305.1	804.08	4.0E	290.0	8.0E	706.5	15.0E	926.5	30.0E	1017.7
310.1	707.92	4.0E	302.9	8.0E	689.8	15.0E	950.1	30.0E	1011.3
315.1	602.60	4.0E	317.8	8.0E	682.3	15.0E	981.8	30.0E	1040.4
320.1	474.39	4.0E	332.8	8.0E	474.3	15.0E	566.7	8.0E	696.1
325.1	394.95	4.0E	264.5	8.0E	303.9	4.0E	312.3	8.0E	473.2
330.1	392.31	4.0E	243.6	8.0E	483.9	15.0E	631.2	8.0E	706.6
335.1	450.62	4.0E	237.0	8.0E	504.1	15.0E	666.5	8.0E	1144.7
340.1	520.35	4.0E	240.2	8.0E	536.4	15.0E	690.4	8.0E	931.2
345.1	551.16	4.0E	248.2	8.0E	598.9	15.0E	717.7	8.0E	993.5
350.1	555.18	4.0E	261.7	8.0E	687.0	15.0E	764.9	8.0E	1092.7
355.1	546.38	4.0E	287.7	8.0E	991.1	15.0E	1073.0	8.0E	1474.5

SELLMEYER ENGINEERING
 BROADCAST AND COMMUNICATIONS CONSULTING ENGINEERS
 P.O. Box 356 McKinney, Texas 75070
 MEMBER AFCCE
 (972) 542-2056

EXHIBIT E1-7B, PAGE-5
 TABULATION OF CONDUCTIVITIES
 RADIO STATION KWAM
 990 KHZ, 0.33 KW, 10 KW-LS, DA-2
 MEMPHIS, TENNESSEE
 =====

Call: WLDX
 FAYETTE, AL
 Coordinates: 33 41 06.00 87 49 16.00
 Frequency: 990 kHz

Azimuth	Radiation (mV/m at one km)	Ground Conductivity Data:							
		Region conductivity in mS/m followed by distance in km to the end of region. E - map data; M - measurement data.							
0.0	302.56	2.0E	35.0	4.0E	334.1	8.0E	850.5	15.0E	895.3
5.0	302.56	2.0E	32.5	4.0E	355.3	8.0E	1343.9		
10.0	302.56	2.0E	30.6	4.0E	401.5	8.0E	719.5	15.0E	748.0
15.0	302.56	2.0E	29.1	4.0E	544.1	8.0E	743.0	15.0E	842.0
20.0	302.56	2.0E	27.9	4.0E	545.3	8.0E	772.6	15.0E	838.2
25.0	302.56	2.0E	27.1	4.0E	546.2	8.0E	799.4	15.0E	960.8
30.0	302.56	2.0E	26.2	4.0E	568.3	8.0E	1116.2	10.0E	1170.6
35.0	302.56	2.0E	25.4	4.0E	471.1	2.0E	490.7	8.0E	632.3
40.0	302.56	2.0E	24.8	4.0E	393.3	2.0E	886.2	4.0E	1343.9
45.0	302.56	2.0E	24.5	4.0E	90.7	2.0E	893.1	4.0E	1343.9
50.0	302.56	2.0E	24.3	4.0E	78.5	2.0E	529.4	4.0E	556.1
200.0	302.56	2.0E	397.1	5000.0E	439.8	15.0E	448.5	5000.0E	452.6
205.0	302.56	2.0E	444.0	5000.0E	458.4	15.0E	510.1	5000.0E	515.7
210.0	302.56	2.0E	206.5	4.0E	424.2	15.0E	427.2	5000.0E	463.2
215.0	302.56	2.0E	181.0	4.0E	440.8	15.0E	575.5	5000.0E	1343.9
220.0	302.56	2.0E	179.9	4.0E	479.8	8.0E	515.7	15.0E	570.6
225.0	302.56	2.0E	188.7	4.0E	348.7	8.0E	551.8	15.0E	611.7
230.0	302.56	2.0E	205.3	4.0E	302.9	8.0E	540.1	15.0E	558.1
235.0	302.56	2.0E	213.2	8.0E	241.0	4.0E	273.6	8.0E	538.5
240.0	302.56	2.0E	194.4	8.0E	470.9	4.0E	503.2	8.0E	532.0
245.0	302.56	2.0E	183.1	8.0E	451.0	4.0E	518.0	15.0E	571.4
250.0	302.56	2.0E	171.7	8.0E	433.7	4.0E	505.3	15.0E	560.7
255.0	302.56	2.0E	161.5	8.0E	412.1	4.0E	495.2	15.0E	561.1
260.0	302.56	2.0E	153.2	8.0E	385.3	4.0E	489.7	15.0E	573.8
265.0	302.56	2.0E	145.4	8.0E	364.0	4.0E	552.9	8.0E	739.9
270.0	302.56	2.0E	139.3	8.0E	349.7	4.0E	700.8	30.0E	852.9
275.0	302.56	2.0E	134.3	8.0E	338.9	4.0E	679.8	15.0E	846.5
280.0	302.56	2.0E	130.5	8.0E	337.1	4.0E	580.3	15.0E	833.8
285.0	302.56	2.0E	127.8	8.0E	349.8	4.0E	555.4	15.0E	904.4
290.0	302.56	2.0E	126.1	8.0E	378.1	4.0E	540.0	15.0E	618.2
295.0	302.56	2.0E	125.5	8.0E	731.9	15.0E	799.0	30.0E	1343.9
300.0	302.56	2.0E	127.6	8.0E	718.9	15.0E	776.5	30.0E	1343.9

SELLMEYER ENGINEERING
 BROADCAST AND COMMUNICATIONS CONSULTING ENGINEERS
 P.O. Box 356 McKinney, Texas 75070
 MEMBER AFCCE
 (972) 542-2056

EXHIBIT E1-7B, PAGE-6
 TABULATION OF CONDUCTIVITIES
 RADIO STATION KWAM
 990 KHZ, 0.45 KW, 10 KW-LS, DA-2
 MEMPHIS, TENNESSEE

Call: WLDX
 FAYETTE, AL
 Coordinates: 33 41 06.00 87 49 16.00
 Frequency: 990 kHz

Azimuth	Radiation (mV/m at one km)	Ground Conductivity Data:							
		Region conductivity in mS/m followed by distance in km to the end of region. E - map data; M - measurement data.							
305.0	302.56	2.0E	123.0	4.0E	132.1	8.0E	719.9	15.0E	827.5
310.0	302.56	2.0E	107.2	4.0E	141.0	8.0E	703.9	15.0E	879.1
315.0	302.56	2.0E	94.9	4.0E	153.5	8.0E	709.5	15.0E	926.7
320.0	302.56	2.0E	82.7	4.0E	177.0	8.0E	704.5	15.0E	966.3
325.0	302.56	2.0E	72.0	4.0E	224.0	8.0E	705.0	15.0E	1343.9
330.0	302.56	2.0E	64.3	4.0E	272.6	8.0E	721.7	15.0E	1343.9
335.0	302.56	2.0E	57.4	4.0E	314.6	8.0E	551.6	15.0E	619.4
340.0	302.56	2.0E	50.9	4.0E	358.7	8.0E	526.9	15.0E	674.9
345.0	302.56	2.0E	46.1	4.0E	396.8	8.0E	553.9	15.0E	733.9
350.0	302.56	2.0E	42.4	4.0E	363.2	8.0E	597.3	15.0E	781.4
355.0	302.56	2.0E	38.2	4.0E	333.9	8.0E	686.0	15.0E	830.7

Call: WABO
 WAYNESBORO, MS
 Coordinates: 31 40 48.00 88 40 34.00
 Frequency: 990 kHz

Azimuth	Radiation (mV/m at one km)	Ground Conductivity Data:							
		Region conductivity in mS/m followed by distance in km to the end of region. E - map data; M - measurement data.							
0.0	304.17	2.0E	291.1	4.0E	599.4	8.0E	867.1	15.0E	1357.5
5.0	304.17	2.0E	287.4	4.0E	557.6	8.0E	1357.5		
10.0	304.17	2.0E	282.0	4.0E	581.6	8.0E	1357.5		
15.0	304.17	2.0E	274.5	4.0E	756.1	8.0E	1357.5		
20.0	304.17	2.0E	263.9	4.0E	781.0	8.0E	1357.5		
25.0	304.17	2.0E	251.5	4.0E	794.5	8.0E	1357.5		
30.0	304.17	2.0E	237.5	4.0E	292.1	2.0E	442.4	4.0E	675.8
300.0	304.17	2.0E	35.7	4.0E	153.4	8.0E	337.7	4.0E	587.0
305.0	304.17	2.0E	36.6	4.0E	144.7	8.0E	342.1	4.0E	585.3
310.0	304.17	2.0E	37.7	4.0E	135.6	8.0E	350.6	4.0E	585.2
315.0	304.17	2.0E	39.3	4.0E	126.0	2.0E	135.9	8.0E	362.8
320.0	304.17	2.0E	41.3	4.0E	117.6	2.0E	142.2	8.0E	403.2
325.0	304.17	2.0E	43.8	4.0E	109.3	2.0E	154.1	8.0E	814.2
330.0	304.17	2.0E	47.1	4.0E	102.3	2.0E	170.8	8.0E	838.9
335.0	304.17	2.0E	51.7	4.0E	95.5	2.0E	188.2	8.0E	853.1
340.0	304.17	2.0E	60.2	4.0E	86.6	2.0E	208.6	8.0E	880.4
345.0	304.17	2.0E	231.0	8.0E	938.4	15.0E	1357.5		
350.0	304.17	2.0E	258.6	8.0E	715.5	15.0E	879.0	8.0E	1357.5
355.0	304.17	2.0E	294.4	4.0E	554.6	8.0E	762.7	15.0E	1357.5

SELLMEYER ENGINEERING

BROADCAST AND COMMUNICATIONS CONSULTING ENGINEERS

P.O. Box 356 McKinney, Texas 75070

MEMBER AFCCE

(972) 542-2056

EXHIBIT E1-7B, PAGE-7 TABULATION OF CONDUCTIVITIES RADIO STATION KWAM 990 KHZ, 0.45 KW, 10 KW-LS, DA-2 MEMPHIS, TENNESSEE

Call: WMUF

PARIS, TN

Coordinates: 36 18 50.00 88 17 33.00

Frequency: 1000 kHz

Azimuth	Radiation (mV/m at one km)	Ground Conductivity Data:							
		Region conductivity in mS/m followed by distance in km to the end of region. E - map data; M - measurement data.							
150.0	416.31	4.0E	241.1	2.0E	329.0	4.0E	399.9	2.0E	420.0
155.0	402.27	4.0E	252.7	2.0E	319.2	4.0E	477.6	8.0E	532.9
160.0	397.59	4.0E	469.1	8.0E	577.7	4.0E	632.8	1.0E	709.8
165.0	402.27	4.0E	320.2	2.0E	394.3	4.0E	461.2	8.0E	589.7
170.0	416.31	4.0E	263.2	2.0E	485.4	8.0E	571.0	1.0E	650.7
175.0	439.64	4.0E	242.4	2.0E	561.4	1.0E	673.0	2.0E	677.4
180.0	472.05	4.0E	232.6	2.0E	659.2	5000.0E	1487.2		
185.0	513.04	4.0E	226.8	2.0E	656.2	5000.0E	658.4	2.0E	661.0
190.0	561.77	4.0E	227.0	2.0E	435.3	4.0E	589.7	2.0E	689.7
195.0	616.97	4.0E	229.7	2.0E	439.9	4.0E	679.9	15.0E	682.7
200.0	676.99	4.0E	192.8	8.0E	460.5	4.0E	705.6	15.0E	817.3
205.0	739.78	4.0E	169.9	8.0E	756.7	15.0E	803.6	5000.0E	1487.2
210.0	802.98	4.0E	155.6	8.0E	739.1	15.0E	751.6	8.0E	793.6
215.0	863.98	4.0E	144.5	8.0E	632.0	4.0E	667.1	8.0E	710.9
220.0	920.04	4.0E	135.9	8.0E	562.8	4.0E	662.8	15.0E	731.8
225.0	968.46	4.0E	127.2	8.0E	445.2	4.0E	613.0	15.0E	683.7
230.0	1006.66	4.0E	119.5	8.0E	377.1	4.0E	575.2	15.0E	660.2
235.0	1032.40	4.0E	113.4	8.0E	359.0	4.0E	612.8	8.0E	818.2
240.0	1043.93	4.0E	108.6	8.0E	351.7	4.0E	645.4	8.0E	843.3
245.0	1040.11	4.0E	103.5	8.0E	359.0	4.0E	735.4	30.0E	890.9
250.0	1020.48	4.0E	99.0	8.0E	386.0	4.0E	560.9	15.0E	648.8
255.0	985.37	4.0E	95.6	8.0E	430.0	4.0E	493.3	15.0E	823.8
260.0	935.81	4.0E	93.1	8.0E	486.4	15.0E	789.6	30.0E	942.5
265.0	873.54	4.0E	91.1	8.0E	625.3	15.0E	837.4	30.0E	838.2
270.0	800.85	4.0E	89.3	8.0E	624.2	15.0E	699.7	8.0E	783.9
275.0	720.50	4.0E	88.3	8.0E	598.0	15.0E	666.9	30.0E	995.5
280.0	635.50	4.0E	87.9	8.0E	573.3	15.0E	638.5	30.0E	1487.2
285.0	549.07	4.0E	88.2	8.0E	529.7	15.0E	658.1	30.0E	1487.2
290.0	464.49	4.0E	89.2	8.0E	516.3	15.0E	674.3	30.0E	1487.2
295.0	385.15	4.0E	90.8	8.0E	501.5	15.0E	695.6	30.0E	866.2
300.0	314.59	4.0E	92.5	8.0E	482.0	15.0E	711.0	30.0E	802.1
305.0	256.63	4.0E	95.0	8.0E	467.4	15.0E	724.4	30.0E	782.2
310.0	215.07	4.0E	98.4	8.0E	458.7	15.0E	739.6	30.0E	812.9
315.0	192.10	4.0E	102.9	8.0E	458.8	15.0E	1078.5	30.0E	1257.1
320.0	185.76	4.0E	106.7	8.0E	247.6	15.0E	344.1	8.0E	472.5
325.0	189.87	4.0E	108.8	8.0E	244.8	15.0E	365.6	8.0E	479.3
330.0	197.53	4.0E	108.8	8.0E	250.4	15.0E	386.2	8.0E	473.9

SELLMEYER ENGINEERING

BROADCAST AND COMMUNICATIONS CONSULTING ENGINEERS

P.O. Box 356 McKinney, Texas 75070

MEMBER AFCCE

(972) 542-2056

EXHIBIT E1-7B, PAGE-8
TABULATION OF CONDUCTIVITIES
RADIO STATION KWAM
990 KHZ, 0.45 KW, 10 KW-LS, DA-2
MEMPHIS, TENNESSEE

=====

Call: WXTN

LEXINGTON, MS

Coordinates: 33 06 39.00 90 02 21.00

Frequency: 1000 kHz

Azimuth	Radiation (mV/m at one km)	Ground Conductivity Data:							
		Region conductivity in mS/m followed by distance in km to the end of region. E - map data; M - measurement data.							
0.0	633.34	8.0E	545.8	15.0E	772.0	8.0E	1105.4	4.0E	1382.0
5.0	633.34	8.0E	603.2	15.0E	857.0	8.0E	1382.0		
10.0	633.34	8.0E	777.6	15.0E	970.8	8.0E	1031.5	15.0E	1060.4
15.0	633.34	8.0E	267.8	4.0E	459.0	8.0E	1169.2	2.0E	1345.2
20.0	633.34	8.0E	236.4	4.0E	431.2	8.0E	1010.7	2.0E	1132.2
25.0	633.34	8.0E	213.7	4.0E	439.6	8.0E	865.7	15.0E	976.7
30.0	633.34	8.0E	190.2	4.0E	689.4	8.0E	921.4	15.0E	987.8
35.0	633.34	8.0E	166.3	4.0E	699.4	8.0E	986.5	15.0E	1052.5
40.0	633.34	8.0E	126.5	2.0E	174.7	4.0E	738.6	8.0E	876.1
45.0	633.34	8.0E	96.1	2.0E	186.9	4.0E	669.3	2.0E	670.1
50.0	633.34	8.0E	79.7	2.0E	198.7	4.0E	589.3	2.0E	1091.1
55.0	633.34	8.0E	68.6	2.0E	210.6	4.0E	466.1	2.0E	733.3
60.0	633.34	8.0E	61.1	2.0E	221.3	4.0E	343.7	2.0E	725.1
300.0	633.34	8.0E	157.7	4.0E	389.0	15.0E	632.8	8.0E	716.4
305.0	633.34	8.0E	160.7	4.0E	387.1	15.0E	462.3	8.0E	574.6
310.0	633.34	8.0E	167.2	4.0E	390.5	15.0E	402.5	8.0E	594.2
315.0	633.34	8.0E	184.5	4.0E	322.1	8.0E	593.1	15.0E	677.4
320.0	633.34	8.0E	218.7	4.0E	265.0	8.0E	609.7	15.0E	749.7
325.0	633.34	8.0E	608.7	15.0E	825.8	30.0E	920.2	15.0E	1031.9
330.0	633.34	8.0E	631.9	15.0E	886.1	30.0E	966.7	15.0E	1272.9
335.0	633.34	8.0E	645.3	15.0E	977.2	30.0E	978.4	15.0E	1240.0
340.0	633.34	8.0E	662.4	15.0E	1157.8	30.0E	1308.3	15.0E	1382.0
345.0	633.34	8.0E	693.1	15.0E	1211.6	30.0E	1251.0	15.0E	1264.8
350.0	633.34	8.0E	754.0	15.0E	912.5	8.0E	955.8	15.0E	1045.1
355.0	633.34	8.0E	573.3	15.0E	659.0	8.0E	784.6	15.0E	826.9

Call sign: KWAMA
 Frequency: 990 kHz
 Power: 10.000 kW
 ERSS: 1270.19 mV/m at 1 km
 Q factor at zero degrees:
 31.80 mV/m at 1 km
 Theoretical pattern RMS:
 1075.67 mV/m at 1 km
 Standard pattern RMS:
 1129.95 mV/m at 1 km
 Modified pattern RMS:
 0.00 mV/m at 1 km

Coordinates:
 N35°11'45.00" W90°00'32.00"

No. of augmentations: 0

TOWER PARAMETERS

#	Field Ratio	Phase (degs.)	Spacing (degs.)	Bearing (degs.)	Tower Ref. Switch	Elec. Height (degs.)	Length Twr. A (degs.)	Length Twr. B (degs.)	Length Twr. C (degs.)	Length Twr. D (degs.)
1	1.000	360.0	0.0	0.0	0	156.7	149.9	6.8	0.0	0.0
2	0.520	190.0	148.5	204.0	0	156.7	149.9	6.8	0.0	0.0
3	0.996	335.0	222.0	167.0	0	90.6	0.0	0.0	0.0	0.0

EXHIBIT E1-8A
 PLOT OF PROPOSED
 DAYTIME STANDARD PATTERN
 RADIO STATION KWAM
 MEMPHIS, TENNESSEE
 JUNE, 2002

HORIZONTAL PLANE PATTERN

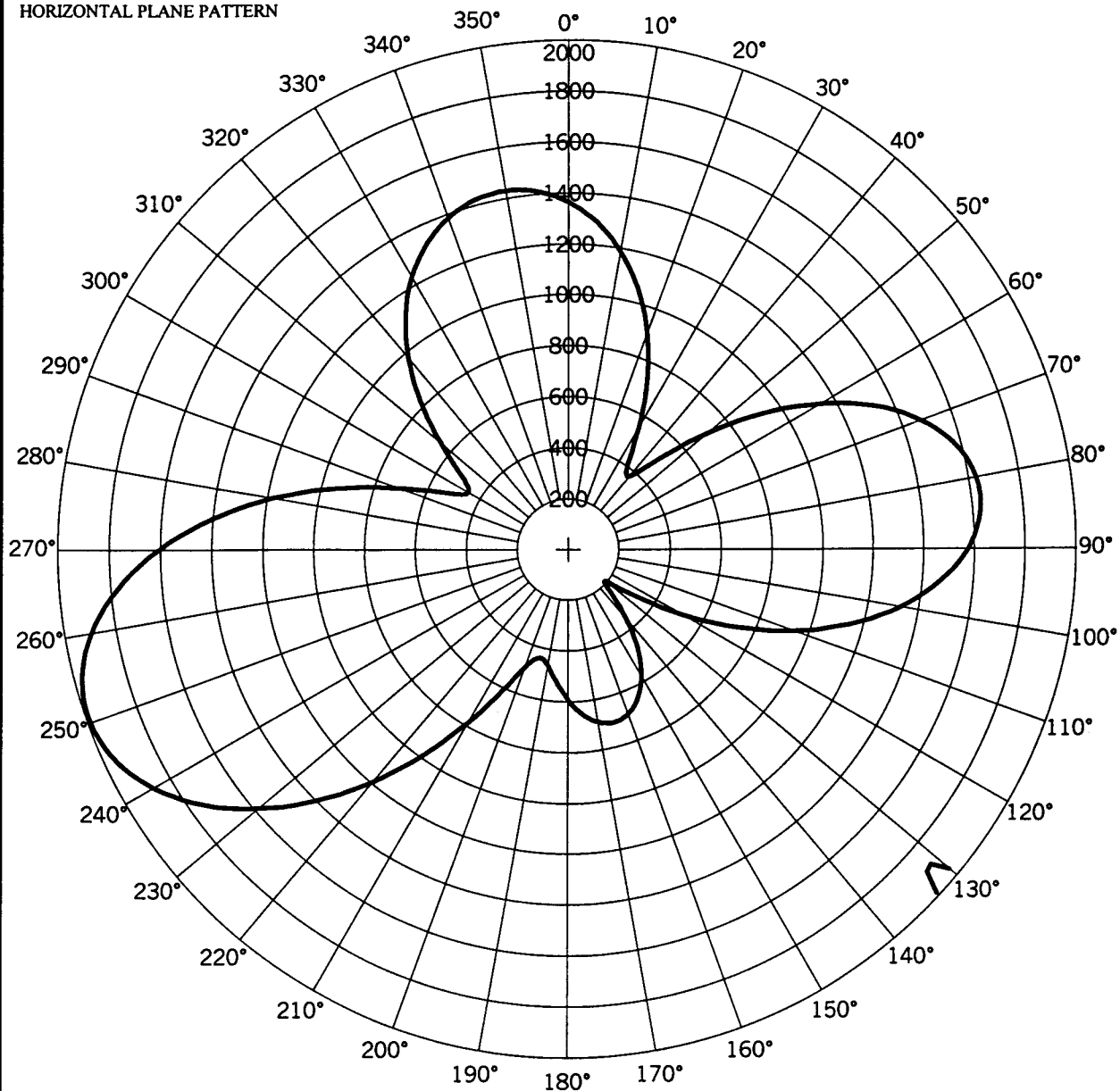

outer curve: x10 scale

Field in mV/m

SELLMEYER ENGINEERING

BROADCAST AND COMMUNICATION CONSULTING ENGINEERS

P.O. Box 356 McKinney, Texas 75070

MEMBER AFCCE

(214) 495-9764

EXHIBIT E1-8B

TABULATION OF PROPOSED DAYTIME STANDARD PATTERN

RADIO STATION KWAM

990 KHZ, 0.33 KW-N, 5.0 KW-CH, 10.0 KW-D, DA-2

MEMPHIS, TENNESSEE

=====

Power: 10.000 kW

ERSS: 1270.19 mV/m at 1 km

Multiplying Constant (K factor): 844.44 mV/m at 1 km

Q Factor (elevation angle = 0 degrees): 31.8

Theoretical Pattern RMS: 1075.67 mV/m at 1 km

Standard Pattern RMS: 1129.91 mV/m at 1 km

ANTENNA TOWER PARAMETERS:

#	Field Ratio	Phase (degs.)	Spac. (degs.)	Bear. (degs.)	TL SW	HT (degs.)	TLA (degs.)	TLB (degs.)	TLC (degs.)	TLD (degs.)
1	1.000	.0	.0	.0	1	149.9	6.8	.0	.0	.0
2	.520	-170.0	148.5	204.0	1	149.9	6.8	.0	.0	.0
3	.996	-25.0	222.0	167.0	0	90.0	.0	.0	.0	.0

CALCULATED STANDARD PATTERN DATA:

Azimuth (degs.)	Elevation Angle (degrees):	Azimuth (degs.)	Elevation Angle (degrees):
	.00		.00
.0	1362.76	180.0	591.58
5.0	1287.56	185.0	522.06
10.0	1184.57	190.0	461.27
15.0	1054.79	195.0	441.29
20.0	900.81	200.0	492.96
25.0	728.46	205.0	616.15
30.0	551.56	210.0	787.70
35.0	407.22	215.0	985.40
40.0	379.20	220.0	1192.76
45.0	505.30	225.0	1396.52
50.0	707.98	230.0	1584.96
55.0	928.67	235.0	1747.29
60.0	1140.05	240.0	1873.89
65.0	1325.89	245.0	1956.70
70.0	1474.49	250.0	1989.85
75.0	1577.33	255.0	1970.13
80.0	1628.93	260.0	1897.31
85.0	1626.99	265.0	1774.29
90.0	1572.42	270.0	1606.94
95.0	1469.19	275.0	1403.92
100.0	1323.90	280.0	1176.51
105.0	1145.22	285.0	939.16
110.0	943.31	290.0	712.29
115.0	729.34	295.0	530.97
120.0	515.99	300.0	455.00
125.0	321.69	305.0	516.71
130.0	195.96	310.0	659.23
135.0	231.72	315.0	822.55
140.0	353.51	320.0	979.09
145.0	474.88	325.0	1117.42
150.0	574.70	330.0	1232.50
155.0	647.10	335.0	1322.04
160.0	690.24	340.0	1384.96
165.0	704.13	345.0	1420.78
170.0	690.08	350.0	1429.19
175.0	650.85	355.0	1409.93