

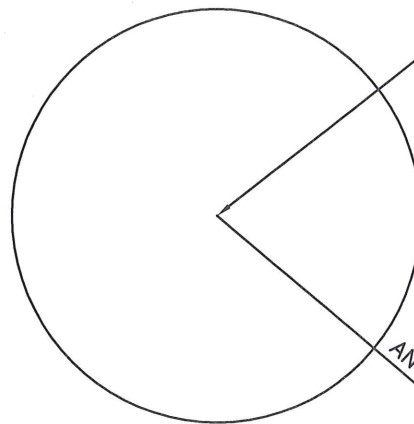

NOT TO SCALE



TOWER SITE
GROUND ELEV: 2160'
GRID N: 2015927.02
GRID E: 6131357.97
LATITUDE: 36°21'21"
LONGITUDE: 120°27'41"

ANTENNA @ 130°

TOWER ANTENNA IS ORIENTED AT AN AZIMUTH OF 130°; SITUATED APPROXIMATELY 10.5 MILES SOUTHWEST OF THREE ROCKS, CA

BEARINGS, DISTANCES AND COORDINATED ARE BASED ON THE CALIFORNIA STATE PLANE COORDINATE SYSTEM, NORTH AMERICAN DATUM OF 1983, ZONE 4. GEOGRAPHIC COORDINATED ARE BASED ON THE NORTH AMERICAN DATUM OF 1983.

MARTIN RANCH
FRESNO COUNTY CALIFORNIA

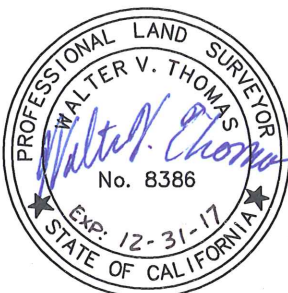

SURVEY UPDATED:
JUNE 30, 2017



**Yamabe & Horn
Engineering, Inc.**

CIVIL ENGINEERS • LAND SURVEYORS

2985 N. BURL AVENUE SUITE 101 FRESNO, CA 93727
TEL (559) 244-3123 WEBSITE YANDHENGRCOM