

## Exhibit12

Lima, OH

REFERENCE CH# 300D - 107.9 MHz, Pwr= 0.013 kW, HAAT=123.2 M, COR= 364 M DISPLAY DATES  
 40 42 35 N Average Protected F(50-50)= 6.89 km DATA 06-16-04  
 84 07 30 W Ave. F(50-10) 40 dBu= 23.0 54 dBu= 9.7 80 dBu= 1.9 100 dBu= .3 SEARCH 07-13-04

CH CITY	CALL	TYPE STATE	AZI. <--	DIST FILE #	LAT. LNG.	Pwr (kW) HAAT (M)	COR (M) INT (km)	PRO (km) LICENSEE	*IN* (Overlap in km)	*OUT*
300D Lima	AP300	APP C OH	119.6 299.6	1.75 BNPFT20030807AIN	40 42 07 84 06 25	0.038 73	320 23.0	6.9 Educational Media Foundati	-26.60*	-22.67*
300D Lima	AP300	APP C OH	119.6 299.6	1.75 BNPFT20030317DXI	40 42 07 84 06 25	0.027 73	320 21.1	6.3 Educational Media Foundati	-24.70*	-22.12*
298A Fort Shawnee	WZRXFM	CP CX OH	146.7 326.7	6.10 BPH20010515AAR	40 39 50 84 05 07	1.340 171	427 2.1	25.6 Jacor Broadcasting Corpora	-1.39	-19.74*
298A Fort Shawnee	WZRXFM	LIC CN OH	146.7 326.7	6.10 BMLH19990331KC	40 39 50 84 05 07	3.000 126	382 2.4	26.8 Jacor Broadcasting Corpora	-1.77	-20.94*
300A New Haven	WJFX«	LIC ZC IN	294.2 114.2	86.52 BLH20000802AAG	41 01 26 85 03 51	3.200 129	376 81.8	27.4 Fort Wayne Radio Corp.	-1.99	36.54
300A Delaware	WODB	LIC CN OH	116.7 296.7	113.70 BLH19980130KC	40 14 43 82 55 48	2.600 167	443 84.3	29.4 Franklin Communications, I	24.09	66.91
299A North Baltimore	WPFXFM	LIC CN OH	46.9 226.9	66.71 BLH19900515KD	41 07 04 83 32 38	3.000 92	334 34.9	23.2 Citicasters Licenses, L.p.	25.60	34.80
299B Dayton	WMMX	LIC CX OH	183.8 3.8	109.92 BLH20020823AAW	39 43 19 84 12 36	28.000 212	467 78.4	65.9 Citicasters Licenses, L.p.	25.65	32.29

ERP and HAAT are on direct line to and from reference station.

"\*"Affixed to 'IN' or 'Out' values = site inside protected contour.

"«" = Station meets FCC minimum distance spacing for its class.

## Exhibit 12 (Compliance with CFR 74.1204)

---

The proposed FM Translator is located within the protected 60 dBu contour of second adjacent channel station WZRX, channel 298A, Fort Shawnee, OH. The predicted F(50-50) field strength of WZRX at the proposed translator site is 86.0 dBu, see Exhibit 12A. Therefore, the respective predicted interfering contour generated by the proposed FM Translator is 126.0 dBu. This interfering contour extends less than 13 meters from the proposed transmit antenna, and the area of overlap does not reach the ground (the antenna will be mounted at the 100 meter level on a 112 meter tower).

To confirm the absence of population within the interference aperture, EMF has examined the attached topographic map, which indicates a lack of structures near the proposed tower, and therefore no structure which could be tall enough to enter the 13-meter interference aperture.

Therefore, EMF respectfully requests a waiver of C.F.R. 74.1204 based on no population within the area of predicted interference.

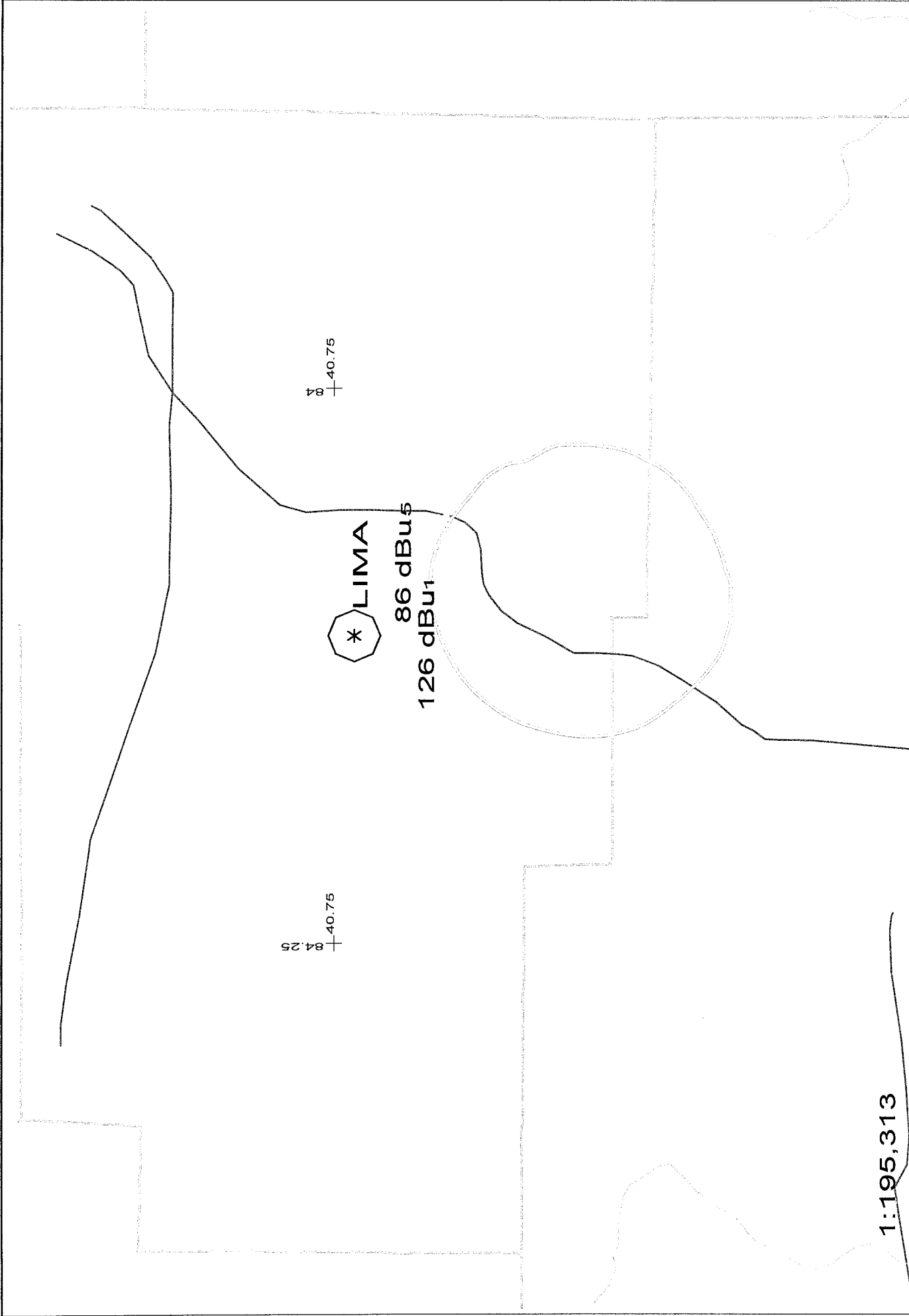

1:195,313

Scale in km



W300BB 300D	.013kW	364M AMS	Exhibit 12A
N. Lat. 40 42 35	W. Lng. 84 07 30	EMF - 07/04	



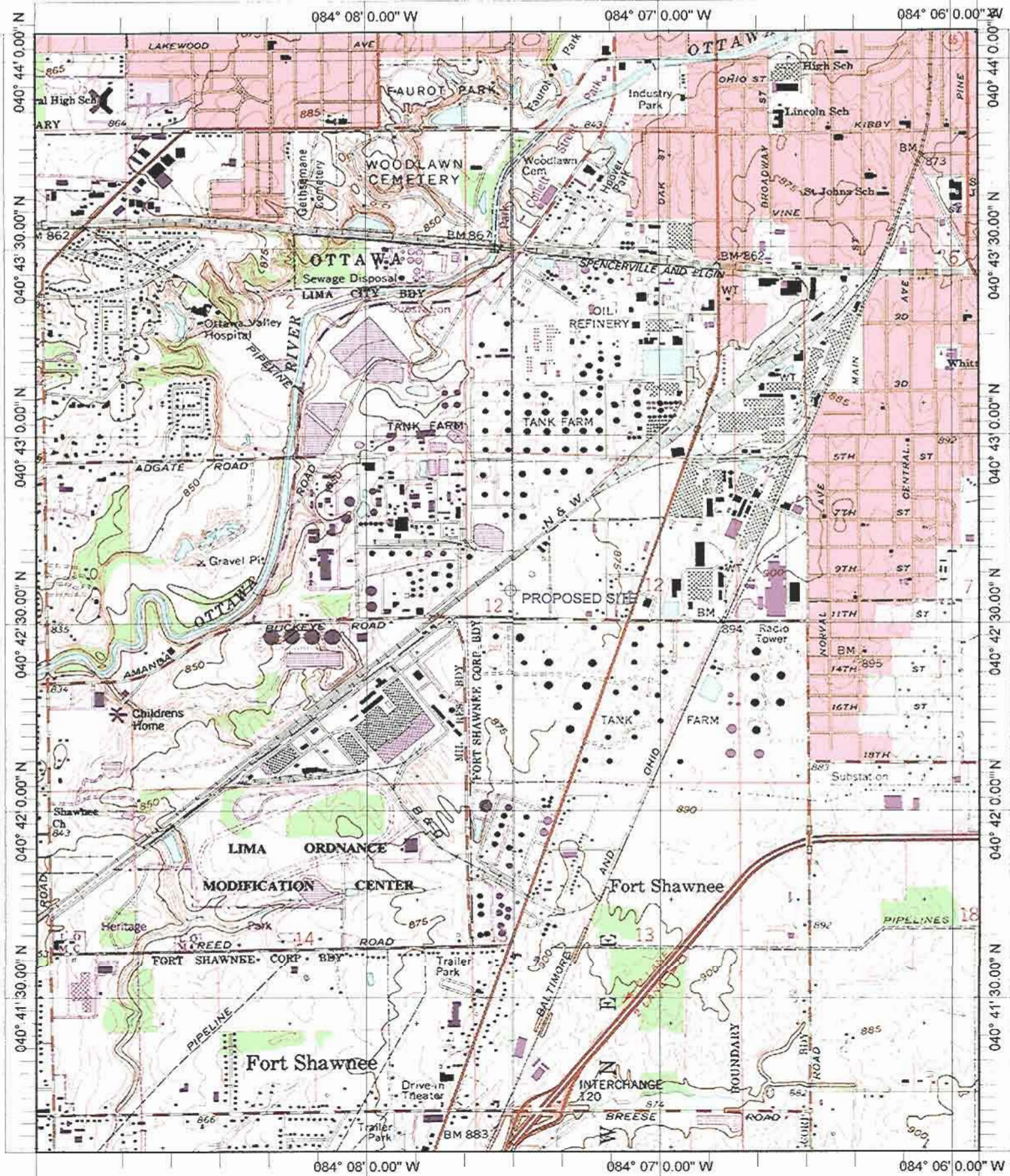

Name: LIMA  
 Date: 7/13/2004  
 Scale: 1 inch equals 2000 feet

Location: 040° 42' 35.0" N 084° 07' 31.0" W  
 Caption: Exhibit 12  
 Site 40-42-35 / 84-07-30