



BROWN CONSULTING ENGINEERS
CIVIL ENGINEERING • LAND SURVEYING • LAND PLANNING

Declaration

I, Kelly Schmutz, PLS, declare under penalty of perjury, that the foregoing is true and correct:

1. I am a licensed surveyor in the State of Arizona. I established that the directional antenna for FCC construction permit BMPED-20081114ACY, held by Dixie College, is oriented at the proper azimuth.
2. On May 6, 2009, I visited the Seegmiller Mountain radio tower site located at 36° 50' 49" North Latitude, 113° 29' 28" West Longitude. During this visit I established a base line in the direction of St. George, UT to allow the installers to orient the directional antennas.
3. After the antennas were fixed in position I observed the orientation. To the best of my knowledge, belief and information the directional antennas are oriented at or near the North Azimuth of 347.6°

Signature: _____

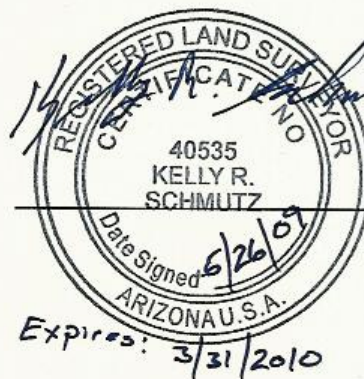

Subscribed and Sworn to
before me this 26th day
of May 2009

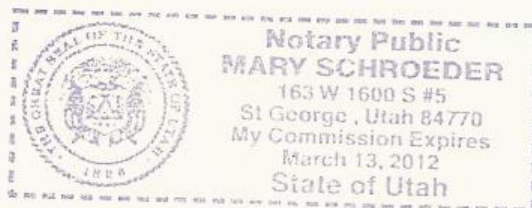

Notary Public

Mary Schroeder