

Compliance with Special Operating Conditions

The WLJV Construction Permit (File Number 0000088427) contains several Special Operating Conditions summarized as follows:

1. The permittee/licensee must reduce power or cease operation as necessary to protect persons having access to the site, tower or antenna from radiofrequency electromagnetic fields in excess of FCC guidelines.
2. BEFORE PROGRAM TESTS ARE AUTHORIZED, permittee shall submit the results of a complete proof-of-performance to establish the horizontal plane radiation patterns for both the horizontally and vertically polarized radiation components. This proof-of-performance may be accomplished using the complete full size antenna, or individual bays therefrom, mounted on a supporting structure of identical dimensions and configuration as the proposed structure, including all braces, ladders, conduits, coaxial lines, and other appurtenances; or using a carefully manufactured scale model of the entire antenna, or individual bays therefrom, mounted on an equally scaled model of the proposed supporting structure, including all appurtenances. Engineering exhibits should include a description of the antenna testing facilities and equipment employed, including appropriate photographs or sketches and a description of the testing procedures, including scale factor, measurements frequency, and equipment calibration.
3. BEFORE PROGRAM TESTS ARE AUTHORIZED, permittee/licensee shall submit an affidavit that the installation of the directional antenna system was overseen by a qualified engineer. This affidavit shall include a certification by the engineer that the antenna was installed pursuant to the manufacturer's instructions and list the qualifications of the certifying engineer.
4. BEFORE PROGRAM TESTS ARE AUTHORIZED, permittee must submit a certification executed by a licensed surveyor showing that the FM directional antenna system has been oriented at the azimuth(s) specified in the directional antenna proof of performance. This certification must include a description of the method used by the surveyor to determine the azimuth(s) of the installed directional antenna system and the accuracy of that determination.
5. BEFORE PROGRAM TESTS ARE AUTHORIZED, the permittee must submit an exhibit demonstrating that the measured directional antenna pattern complies with the appropriate community coverage provisions of 47 C.F.R. Sections 73.315 or 73.515 (See 47 C.F.R. Section 73.316(c)(2)(ix)(B)).
6. The relative field strength of neither the measured horizontally nor vertically polarized radiation component shall exceed at any azimuth the value indicated on the composite radiation pattern authorized by this construction permit. A relative field strength of 1.0 on the composite radiation pattern herein authorized corresponds to the following effective radiated power:
6.6 kilowatts
Principal minima and their associated field strength limits:
20 - 40 degrees True: 0.210 kilowatts
7. Upon commencement of program tests in accordance with 47 C.F.R. § 73.1620, the licensee must cease use of the auxiliary facility authorized by BXLED-20190308AAR due to a violation of 73.1675(a)(1). The licensee may seek modification of the auxiliary facility in accordance with § 73.1675(c)(1) to bring it into compliance with § 73.1675(a)(1).

EMF complies with, or agrees to, these conditions as follows:

1. EMF in coordination with other users of the site, agrees to reduce power or cease operation as necessary to protect persons having access to the site, tower, or antenna from radiofrequency electromagnetic fields in excess of FCC guidelines.
2. A complete Proof of Performance is contained in this license application.
3. The installation of the directional antenna system was done under the supervision of a qualified engineer with the signed affidavit certification in Exhibit 1-A.
4. The directional antenna system has been oriented at the correct azimuth as certified in Exhibit 1-B.
5. Community of License coverage using the measured directional pattern is seen in Exhibit 1-C.
6. The measured relative field strengths of the horizontal and vertical patterns are seen in the Antenna Test Report and abide by the principal minima values as listed. Specifically, the antenna pattern for the 20, 30, and 40 degree azimuths correspond to power levels of 0.189, 0.209, and 0.186 kilowatts respectively.
7. A request to cancel the auxiliary facility authorized in BXLED-20190308AAR has been filed per FCC file 0000203452. This auxiliary facility no longer physically exists. Therefore, this special operating condition has been fulfilled.



KLOVE



EDUCATIONAL MEDIA FOUNDATION

Certification for WLJV Spotsylvania VA Antenna Installation
Nov 11, 2022 Re: Construction Permit 0000088427

This is to certify that the installation of the ERI directional antenna for WLJV Spotsylvania VA, Model # 6810-2R-SS-EF-DA, was installed in complete accordance with the manufacturer's detailed instructions. All work was performed by qualified personnel using good engineering practices and under my direct and complete supervision. VTI inc. performed all work on site.

Certifying engineer and qualifications:

Robert Canfield
Regional Engineer
EMF Broadcasting
5700 West Oaks Bl
Rocklin CA 95765

7.5 years engineering experience in FM broadcasting.

Robert Allen Canfield
Field Engineer VA, MD, DC, DE
EMF Broadcasting



ENGINEERING
SURVEYING
LAND PLANNING
RIGHT-OF-WAY

SULLIVAN, DONAHOE & INGALLS
A PROFESSIONAL CORPORATION

ERIC V. SULLIVAN, L.S.
NOLAND C. DONAHOE
MICHAEL E. MOORE, P.E.
RICHARD H. FURNIVAL, P.E.
KEITH L. OSTER, P.E.

November 3, 2022

George Grimes

Site Development Specialist

5700 West Oaks Blvd.

Rocklin, CA 95765

RE: ATC site# 310337 Fredericksburg, VA

On November 3, 2022 we determined the orientation of the antenna on the above referenced tower to be a true north azimuth of 230 degrees. The azimuth was determined using GPS equipment (NAD83) and corrected to true north. The accuracy of this azimuth is plus or minus one half degree.

Please contact me if you have any questions.

Sincerely,

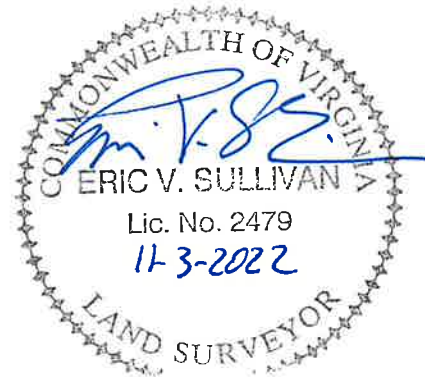

Eric. V. Sullivan
Sullivan, Donahoe & Ingalls, PC

Overlap Population Report
WLJV Proof (208) / Spotsylvania Courthouse, VA

Overlap Area Type: Intersection

Areas Included:

WLJV Proof (208): FCC F(50-50) 60.00 dBu (FCC HAAT)

PLST: Spotsylvania Courthouse, VA

Population Database: 2020 US Census (PL)

Total Population: 5,477

Overlap Area: 27.26 sq. km (Area determined using 0.014 km cells)

Area Description	Total Population	Total Area [sq. km]	Percent Population	Percent Area
WLJV Proof (208): FCC 60	209,874	1,363	2.6 %	2.0 %
PLST: Spotsylvania Courthouse	5,477	27.26	100.0 %	100.0 %

WLJV.C

0000088427

Latitude: 38-15-10.73 N

Longitude: 077-30-19.85 W

ERP: 6.60 kW

Channel: 208

Frequency: 89.5 MHz

AMSL Height: 156.0 m

Elevation: 81.0 m

Horiz. Pattern: Directional

Vert. Pattern: No

Prop Model: None

Community of License Coverage - Spotsylvania, VA

Note: 100% Of The Area And Population Are Contained Within The 60dbu(F50-50) Contour
Contour Drawn With Measured Proof Pattern

