

EXHIBIT 10.0
(Page 1 of 4)

DAYTIME TRANSMITTER
SITE INFORMATION
M-10 Broadcasting, Inc.
Pikesville, MD

The modified 1370 kHz daytime facilities proposed for WWLG in the attached application will operate from the 1370 kHz daytime transmitter site authorized for WWLG by construction permits BP-19990521AD and BMJP-20001023ACJ and will utilize the same six daytime towers authorized by these construction permits. The directional pattern proposed in the attached application will also be identical to that authorized by these construction permits except that the power has been increased from 21 kilowatts to 50 kilowatts and the three augmentations found to be necessary in the process of tuning this pattern at 21 kilowatts in implementing construction permit BP-19990521AD have been added.

This site is located at 612 Stans Road, in Joppa, Harford County, Maryland.. Figure 10.0.0 is a horizontal plan view showing the placement of these daytime towers on this site. Figure 10.0.1 is a topographic map showing the location of this site. It should be noted that site photographs for this transmitter site were included as part of the application for the original construction permit to relocate WWLG to this site. Thus, as this is a presently authorized transmitter site with the towers already in place, no additional site photographs are included as part of the attached application. It should be further noted that the attached application proposes no changes whatsoever to the nighttime facilities presently authorized by construction permit BMJP-20001023ACJ, which will operate from a totally different transmitter site.

There are no AM stations located within 3.2 kilometers of this site. Furthermore, there are no FM, TV, or nonbroadcast radio facilities located in the immediate vicinity of

EXHIBIT 10.0
(Page 2 of 4)

this site which would be impacted by the modifications proposed in the attached application.

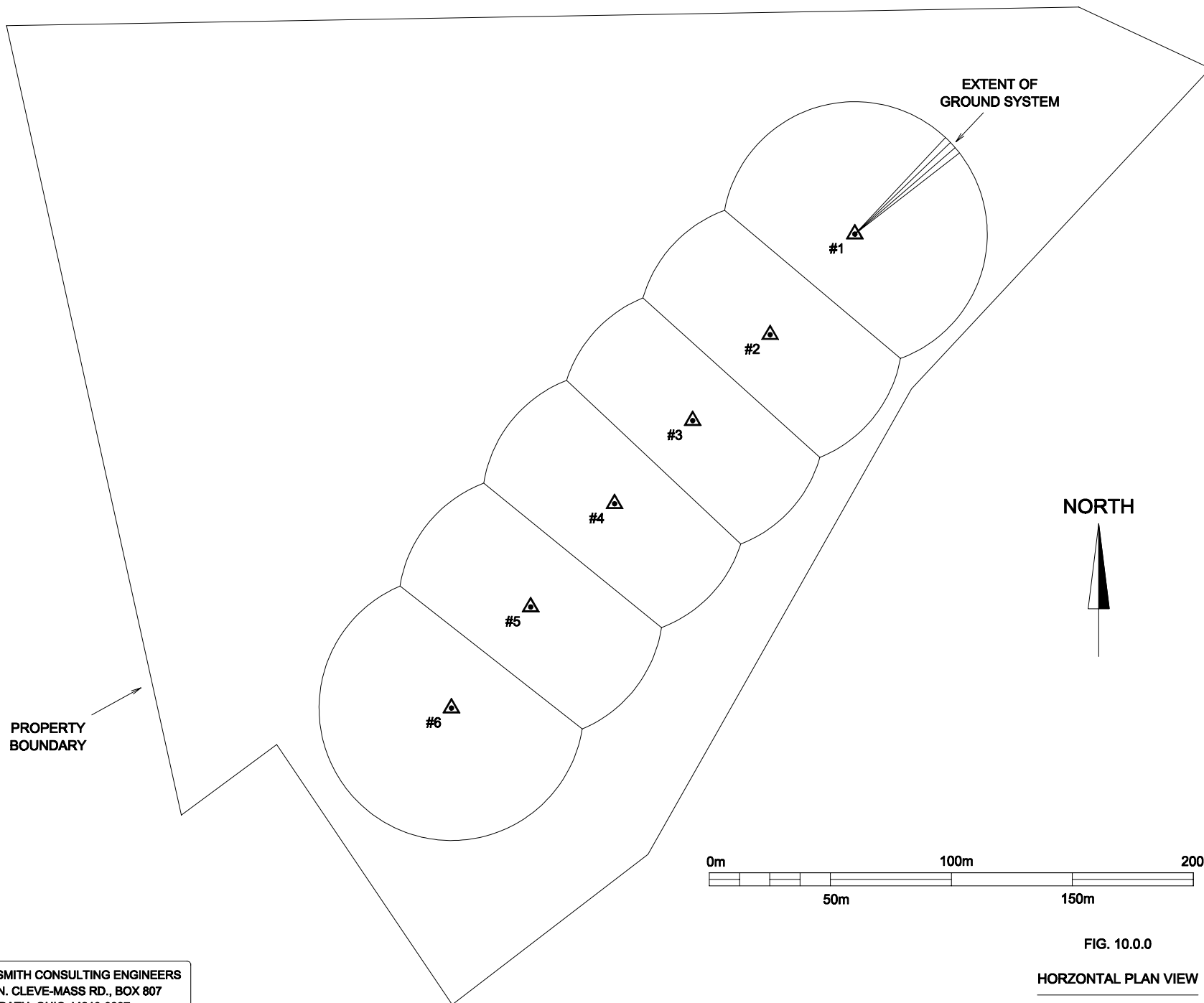

CARL E. SMITH CONSULTING ENGINEERS
2324 N. CLEVE-MASS RD., BOX 807
BATH, OHIO 44210-0807
(330) 659-4440

FIG. 10.0.0
HORIZONTAL PLAN VIEW
M-10 BROADCASTING, INC.
PIKESVILLE, MD

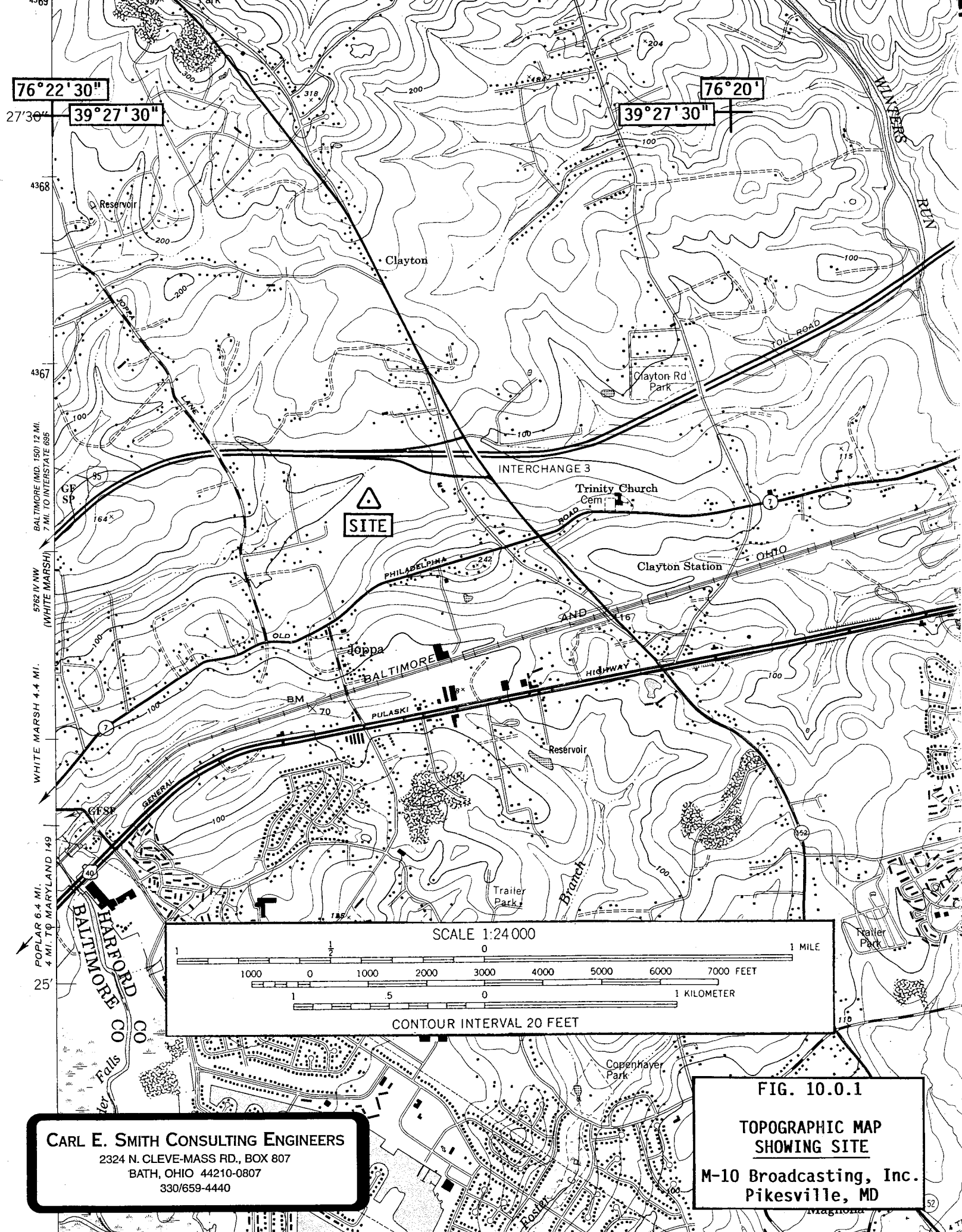

76°22'30"

76°20'

39°27'30"

39°27'30"

SITE

SCALE 1:24 000

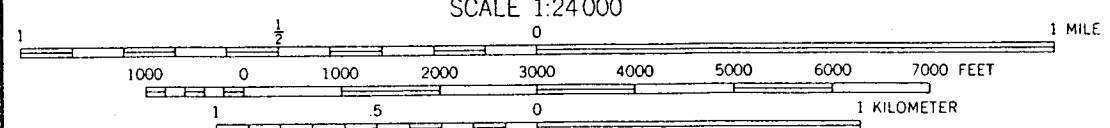

CONTOUR INTERVAL 20 FEET

CARL E. SMITH CONSULTING ENGINEERS
 2324 N. CLEVE-MASS RD., BOX 807
 BATH, OHIO 44210-0807
 330/659-4440

FIG. 10.0.1
TOPOGRAPHIC MAP
SHOWING SITE
M-10 Broadcasting, Inc.
Pikesville, MD