

Page #1, Waiver Request of Section 74.1204
BPFT-19990417TA, Arlington, FL 12 Watts ERP
Calvary Chapel of Twin Falls, Inc. 6/04

The proposed site is contained entirely inside the service contour of second-adjacent station WKTZ, Jacksonville, FL

WKTZ.LIC

The proposed site is contained entirely inside the service contour of second-adjacent Station WKTZ, Channel 215, Class C2, 50 kW, Jacksonville, FL. As shown by the map on **page #2** of this waiver request, the level of the second-adjacent station WKTZ arriving protected F(50,50) signal at the proposed transmitter site is in excess of 96-dBu. Using the Undesired-to-Desired method for calculating proposed interference (the basis of the FCC current contour overlap regulations and an acceptable method for the purposes of determining lack of interference for an FM Translator), the proposed interfering contour with respect to WKTZ is 136-dBu (free-space contour method employed). This means that the 136-dBu interfering signal would extend 4 meters from the center of radiation, which is existing at 80 meters. Since no population inhabits this interference area, Calvary Chapel of Twin Falls, Inc. respectfully requests a waiver of the FM translator contour overlap regulations with respect to second-adjacent channel station WKTZ.

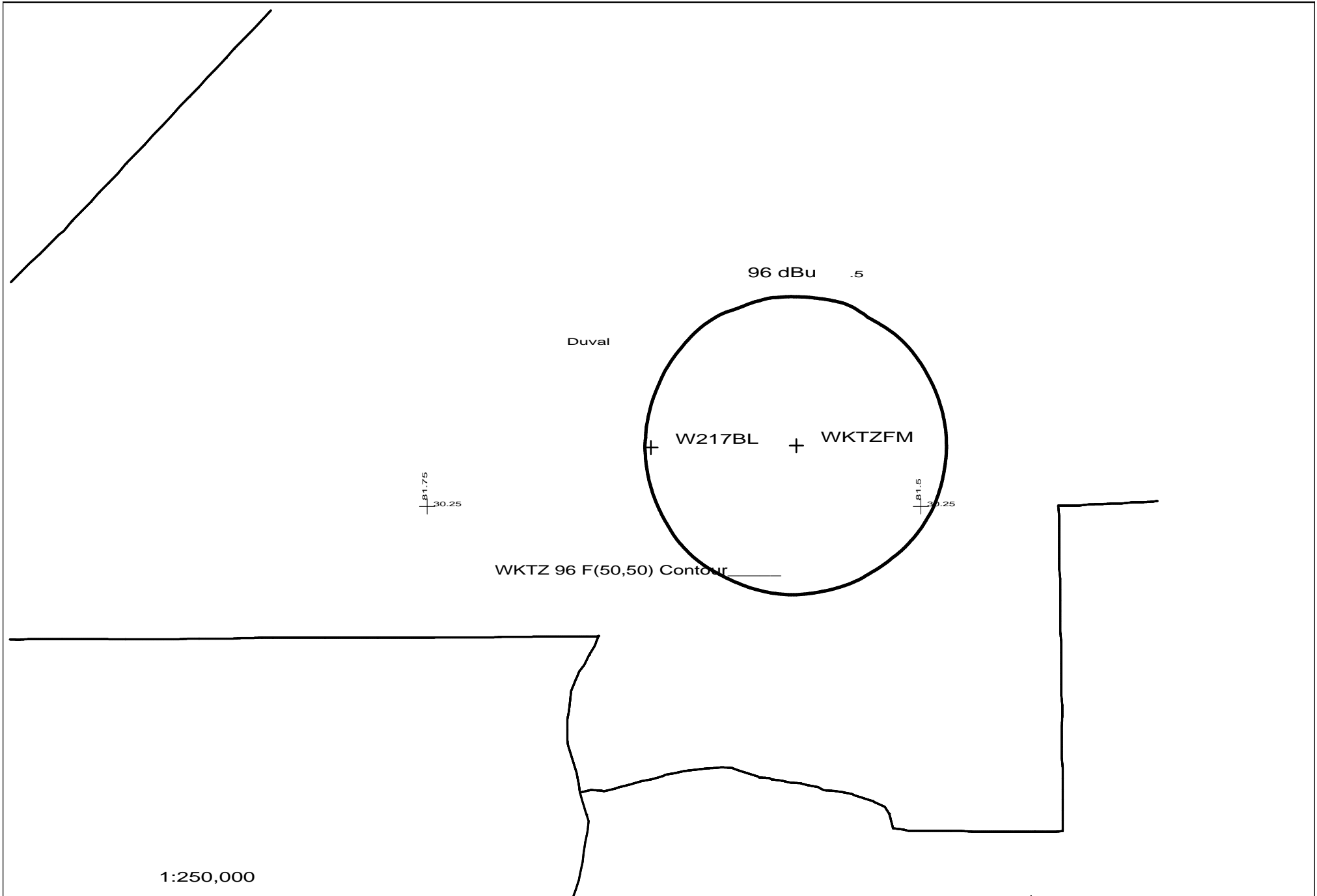

W217BL 217D .012kW 89M AMSL
N. Lat. 30 16 33 W. Lng. 81 38 12

W217BL
CCTF - 06/04

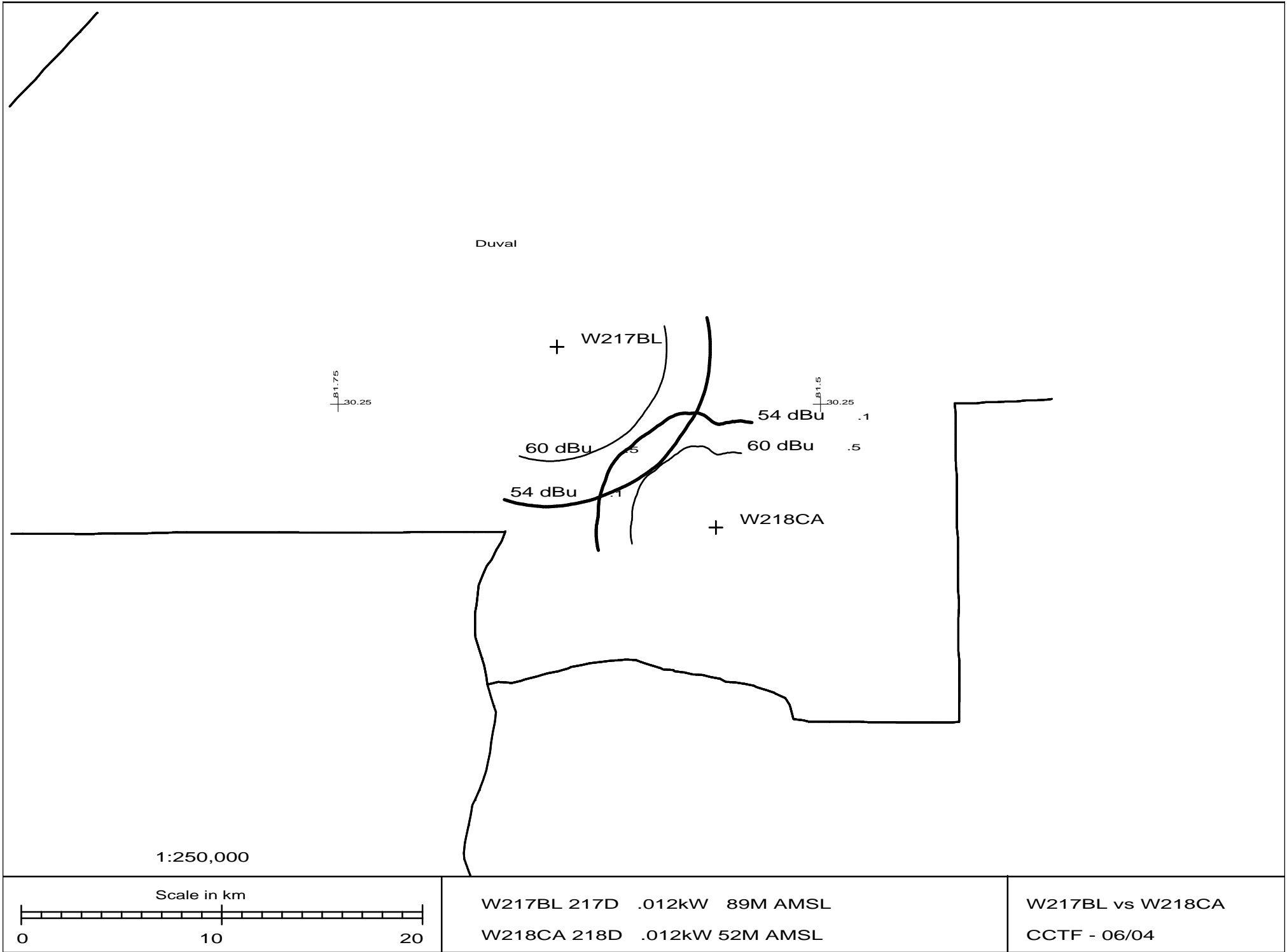

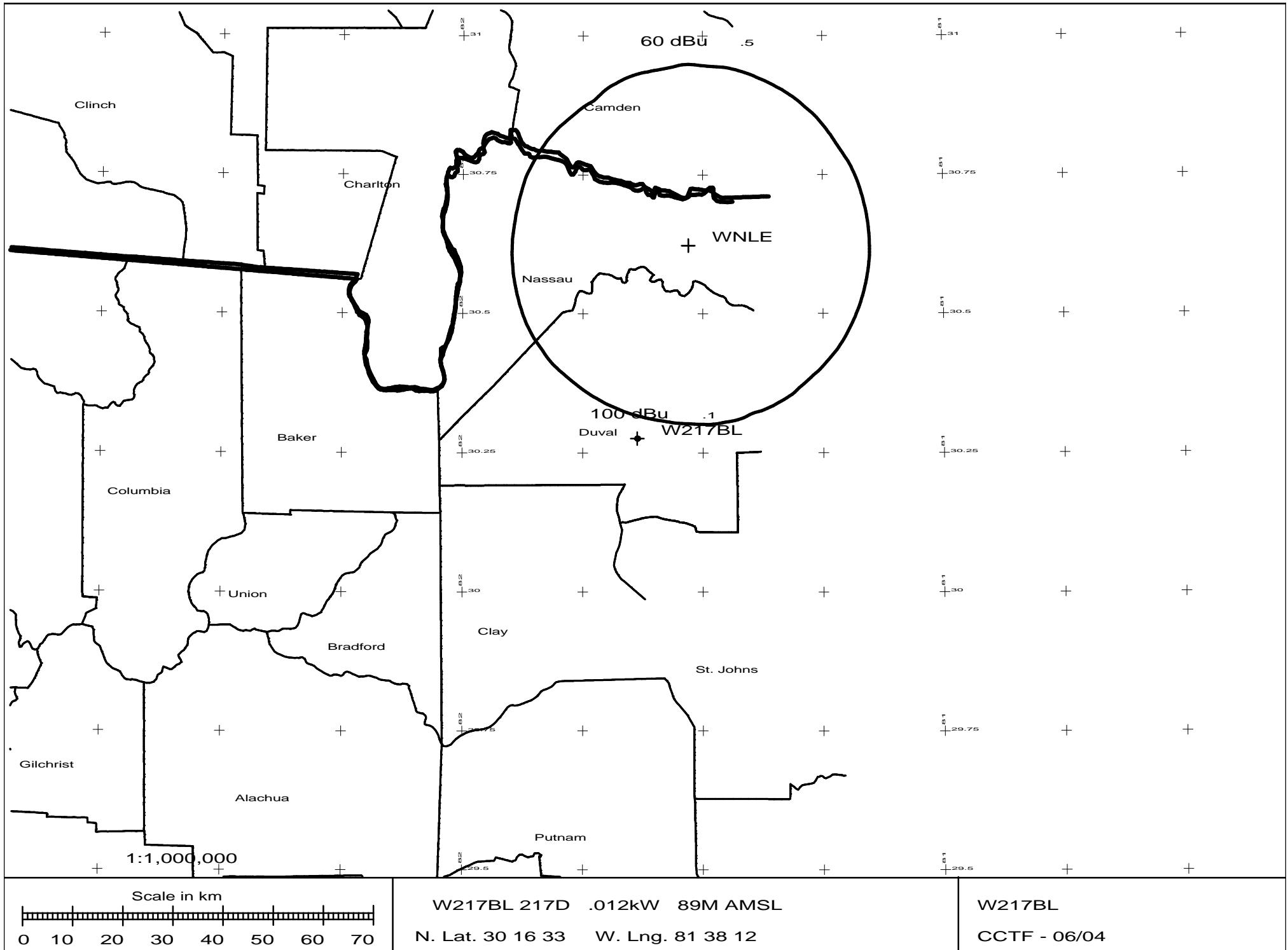

TERRAIN AND CONTOUR DATA

N. Lat. = 30 16 33 W. Lng. = 81 38 12
HAAT and Distance to Contour - FCC Method - 03 Arc Sec.

W217BL, Calvary Chapel Of Twin Falls,, BPFT19990419TA
Azi. AV EL HAAT ERP kW dBk Field 60-F5

000	2.2	86.8	0.0120	-19.21	1.000	5.68
030	5.6	83.4	0.0120	-19.21	1.000	5.56
060	9.9	79.1	0.0120	-19.21	1.000	5.41
090	8.3	80.7	0.0120	-19.21	1.000	5.47
120	8.8	80.2	0.0120	-19.21	1.000	5.45
150	6.6	82.4	0.0120	-19.21	1.000	5.53
180	2.2	86.8	0.0120	-19.21	1.000	5.68
210	1.0	88.0	0.0120	-19.21	1.000	5.72
240	4.1	84.9	0.0120	-19.21	1.000	5.62
270	7.2	81.8	0.0120	-19.21	1.000	5.50
300	4.7	84.3	0.0120	-19.21	1.000	5.59
330	3.9	85.1	0.0120	-19.21	1.000	5.62

Ave El= 5.38 M HAAT= 83.62 M AMSL= 89 M