

FEDERAL COMMUNICATIONS COMMISSION
445 12th Street, S.W.
WASHINGTON DC 20554

MEDIA BUREAU
AUDIO DIVISION
APPLICATION STATUS: (202) 418-2730
HOME PAGE: WWW.FCC.GOV/MB/AUDIO

PROCESSING ENGINEER: ROBERT GATES
TELEPHONE: (202) 418-2700
FACSIMILE: (202) 418-1410
INTERNET ADDRESS: Robert.Gates@fcc.gov

OCT 06 2014

Juan Alberto Ayala
13155 Noel Road
Suite 900
Dallas, TX 75240

In re: W252AW, Ridgefield, IL
BPFT-20140902ACO
Facility ID # 149046

Dear Applicant:

This refers to: (1) the above-captioned application for W252AW, Ridgefield, Illinois.

An engineering study has revealed the application violates 47 C.F.R. § 74.1204(a) with respect to WRLR-LP, Round Lake Heights, Illinois (BLL-20060110AAE). Section 74.1204(a) states that an application for a FM translator station will not be accepted if the proposed operation would involve prohibited overlap of predicted field strength contours with any other authorized station. The proposed 40 dBu interference contour overlaps with the 60 dBu protected contour of WRLR-LP. This violation was not addressed.

In light of the above, the application BPFT-20130520ADZ filed by Juan Alberto Ayala is unacceptable for filing pursuant to 47 C.F.R. § 73.3566(a) and IS HEREBY DISMISSED. This action is taken pursuant to 47 C.F.R. § 0.283.

Sincerely,

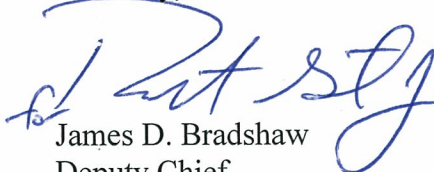

James D. Bradshaw
Deputy Chief
Audio Division
Media Bureau

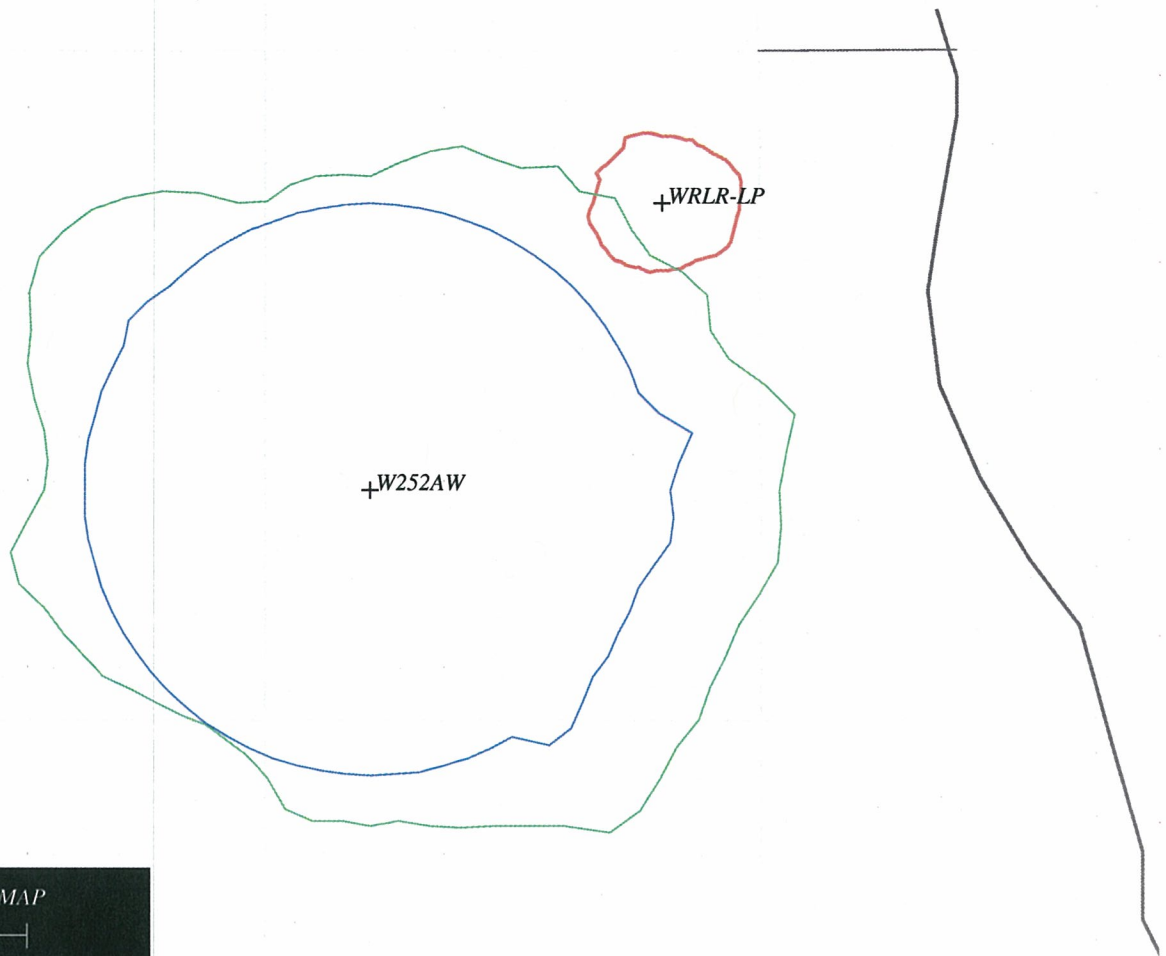

LAMBERT EQUAL AREA MAP

25 0

KILOMETERS

ENGINEER:

Robert_Gates

DATE:

10/06/14

THE FOLLOWING IS A LIST OF THE DATA WHICH APPEARS ON THE ABOVE MAP

BOTTOM LATITUDE: 41.73 TOP LATITUDE: 42.63 LEFT LONGITUDE: -88.96 RIGHT LONGITUDE: -87.76

MAP: ENLARGED CONUS MAP PROJECTION: Lambert Equal-area CENTER LAT: 42.18 LONG: -88.36 GRID SPACING: 0.50

KILOMETERS / INCH = 16.47

PLOT MADE ON : 6 October, 2014 13:26 HOURS

call	serv	city,state	application no.	contour	chan	erp	haat	rcamsl	coverage area	A1
WRLR-L	FL	ROUND,IL	BLL-20060110AAE	60.0 dBu (50,50)	252L1	0.096	30.2	268.7	112.3 sq km	0
W252AW	FX	RIDGEFIELD,IL	BPFT-20140902ACO	40.0 dBu (50,10)	252D	0.250	46.6	313.0	2823.8 sq km	0
W252AW	FX	RIDGEFIELD,IL	BLFT-20130813ABP	40.0 dBu (50,10)	252D	0.250	20.9	287.0	1813.2 sq km	0

No topographic data is available for this location.

A1 - Number of radials where free space equation was used for field strength calculations.

A7 - Number of radials where a HAAT less than 30 meters was adjusted to 30 meters.