



102 Albemarle Avenue, S.E.
Roanoke, Virginia 24013
Tel: (540) 345-0675
Fax: (540) 342-4456
E-mail: lmweng@lmwpc.net

October 26, 2015

Re: Mill Mountain Tower

I certify that the azimuths on the Tower located on Mill Mountain in Roanoke Virginia are correct as shown on drawing titled Tower Location Plan Located On Mill Mountain.

North was established using GPS and adjusted for True North. Each leg of the Tower were located to establish the azimuths on the legs and each face of the Tower. The accuracy of the azimuths is within 1 degree.

Sincerely,
L.M.W., P.C.

Douglas R. Meredith, Jr., P.E. L.L.S.
Licensed Land Surveyor

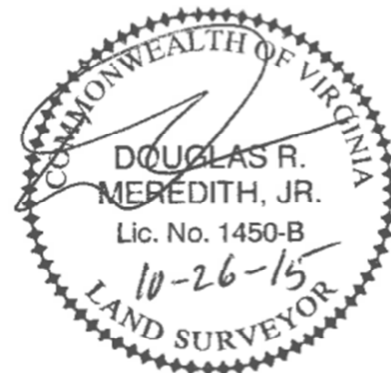

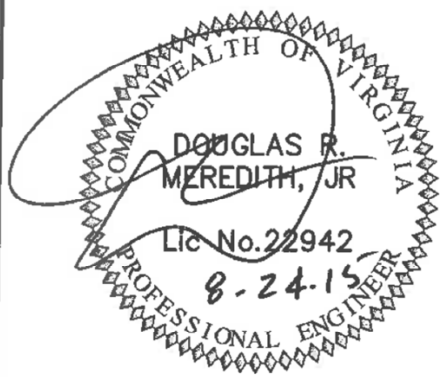

GRAPHIC SCALE



(IN FEET)

1 inch = 40' ft.

CITY BENCH MARK
(VIEW 27)

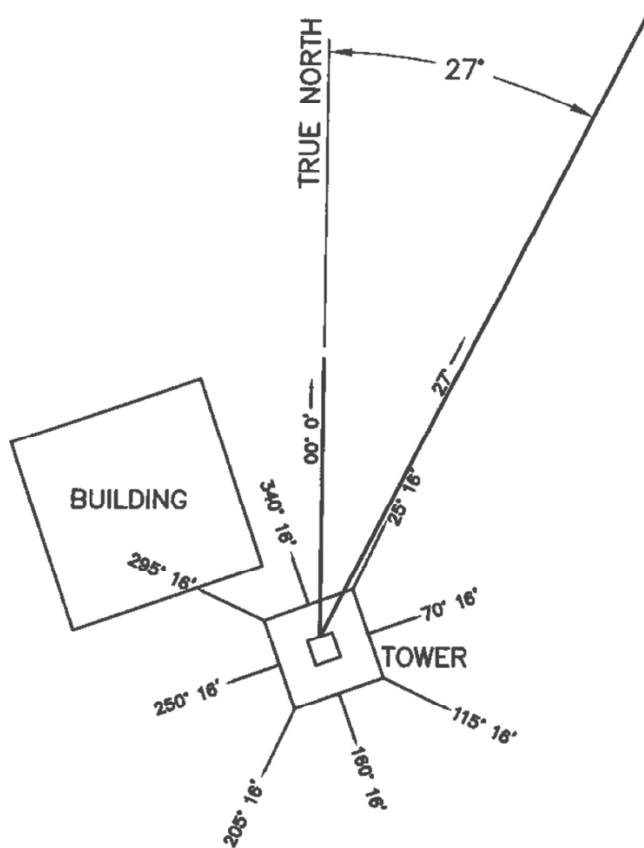

\\Join\PROJECTS\FOLDERS\4353\08-15 Eddle Area 30kVa Tower Survey-Direction of Antenna-Top of Mill Mountain\Survey\4353.dwg PLOTTED: 8/24/2015 8:42:32 AM

L M W P.C.

Engineering
Architecture
Surveying
Landscape Design

102 Albemarle Ave.
Roanoke, Virginia
24013

www.lmwpc.net
ph: 540.345.0675
fax: 540.342.4456
lmweng@lmwpc.net

TOWER LOCATION PLAN LOCATED ON MILL MOUNTAIN CITY OF ROANOKE, VIRGINIA

Designed By	DRM
Drawn By	SAC
Drawing	4353
Project Date	08/17/15
Scale	1" = 40'
Comm. No.	4353
Sheet	1 of 1