

Weichert.com Feedback - Ads by Google



PLACE SEARCH

Enter a community name:

State:

Indiana

Search

☐ Include former names
[Advanced search](#)

POPULATION OVERVIEW

[Indiana](#) > [All counties](#) > [La Porte County](#) > Wanatah
[Wanatah, IN](#)

Town

Population 2000: 1,013

Square miles: 1.37

Metro area: Michigan City-La Porte



Ads by Google

[WANATAH](#)[Population](#)[Map](#)[Travel](#)

2000 CENSUS DATA

	WANATAH		IN	US
POPULATION	Number		Number	Number
Total population	1,013			
Square miles (land)	1.37			
Population per square mile	739.18		169.53	79.56
GENDER	Number	Pct	Pct	Pct
Male	511	50.4	49.0	49.1
Female	502	49.6	51.0	50.9
AGE	Number	Pct	Pct	Pct
15 or younger	213	21.0	21.5	21.4
16-24	105	10.4	14.5	13.9
25-44	307	30.3	29.5	30.2
45-64	261	25.8	22.1	22.0
65+	127	12.5	12.4	12.4
	Number		Number	Number
Average age (years)	37.02		36.11	36.22
RACE AND ETHNICITY	Number	Pct	Pct	Pct
White	993	98.0	87.5	75.1

Black or African American	1	0.1	8.4	12.3
American Indian and Alaska native	3	0.3	0.3	0.9
Asian	2	0.2	1.0	3.6
Native Hawaiian and other Pacific islander	0	0.0	0.0	0.1
Some other race	1	0.1	1.6	5.5
Two or more races	13	1.3	1.2	2.4
Hispanic or Latino	21	2.1	3.5	12.5

Sources: U.S. Census Bureau, 2000 Census; ePodunk

Note: Hispanic ethnicity is a separate data category from race. This number should not be added to race totals.

More Wanatah data

[Population](#)
[Education](#)
[Homeowner costs by county](#)
[Housing](#)
[Income](#)
[Marital status](#)
[Place of birth](#)
[Residence in 1995](#)
[Single men & single women, by county](#)
[Transportation](#)
[La Porte County demographics](#)
[Fastest-growing counties in Indiana](#)

Wanatah guides

[Wanatah community profile](#)
[Business center](#)
[Genealogy guide](#)
[Health services](#)
[Moving guide](#)
[Nonprofit resources](#)
[Politics](#)
[Sports & rec](#)
[Travel guide](#)

Search Birth, Marriage, and Death Records:

powered by

Ancestry.com

First Name:

Last Name:

go

[CITIES](#) | [COUNTIES](#) | [AIRPORTS](#) | [CEMETERIES](#) | [COLLEGES](#) | [LIBRARIES](#) | [MUSEUMS](#) | [NEWSPAPERS](#)

[About us](#) | [Help](#) | [Sources](#) | [Contact](#) | [Advertise](#) | [Canada](#) | [Ireland](#) | [UK](#)

Powered by ePodunk (tm)

Copyright © 2007 ePodunk Inc. All rights reserved.

ePodunk is not affiliated with any entity represented in its databases. ePodunk also provides links to Web sites presented by government agencies, newspapers, ski areas, inns and other enterprises. The company is not affiliated with these sites, nor is it responsible for their content.

Post cards are vintage images from the early 1900s. They are not intended to depict current views. ePodunk does not sell electronic or paper copies of post cards appearing on this site, nor does it keep high-resolution copies of these images.

Welcome to
WANATAH



Home

About Wanatah

Businesses

Community Events

Recreation

Clubs & Organizations

Churches

Schools

Town Government

Chamber of Commerce

Contact Info

Area Businesses and Chamber Members -
Alphabetical

Click here [for a listing of members by category.](#)

Back Forty
109 S. Main St.
Wanatah, IN 46390

BJSS Storage
PO Box 278
Wanatah, IN 46390

Bonnie's Baskets
PO Box 118
Wanatah, IN 46390

Brian Pressel
1049 W. 1350 S.
Wanatah, IN 46390

Bunton Enterprises
9203 Twln Acre Dr.
Wanatah, IN 46390

CMS Design Studio, LLC
655 East 300 South
Valparaiso, IN 46383

Comfort Keepers
P.O. Box 1783
LaPorte, IN 46350

Division Acres
629 E Division Rd
Valparaiso, IN 46383

Egolf Christmas Trees
14594 S 700 W
Wanatah, IN 46390

Grieger's County Line Farm
Bernell Grieger
17171 S Couny Line Rd
LaCrosse, IN 46348

Lois Guse

Horizon Bank
113 W First St.
Wanatah, IN 46390

J-MART bp Food Shop
10300 US Hwy 30
Wanatah, IN 46390

Kaiser Construction
Dave Kaiser
PO Box 206
Wanatah, IN 46390

Lone Pine Liquors
10550 W US Hwy 30
Wanatah, IN 46390

Morton Builders
9705 W US Hwy 30
Wanatah, IN 46390

**Northern Indiana
Tent Rental**
Mark Brault
PO Box 165
Wanatah, IN 46390

Rice Farms
8502 W 1350 S
Wanatah, IN 46390

Rosalie Mack
PO Box 13
Wanatah, IN 46390

S & W Realty
PO Box 331
Wanatah, IN 46390

Shurco Enterprises
Eugene Shurte
12202 S 700 W
Wanatah, IN 46390

Tillinghast Insurance
PO Box 69
LaPorte, IN 46350

**Unity Foundation of
LaPorte County**
PO Box 527
Michigan City, IN
46361

W. Kendall & Sons
PO Box 9
Wanatah, IN 46390

**Wanatah Funeral
Chapel**
Martin Moeller
104 N Roosevelt Rd
Valparaiso, IN 46383

**Wanatah Historical
Society**
PO Box 156
Wanatah, IN 46390-
0156

PO Box 200 Wanatah, IN 46390	Wanatah, IN 46390-0156
Kankakee Valley REMC Dennis Weiss PO Box 157 Wanatah, IN 46390	Wanatah Lions Club PO Box 131 Wanatah, IN 46390
LaPorte County Solid Waste Management District 2354 N. U.S. Hwy. 35 LaPorte, IN 46350	Wanatah Mercantile James Czerwonke 11488 W 1350 S Wanatah, IN 46390
LaPorte County Visitors Convention Bureau Jane Daly 1503 S Meer Rd Michigan City, IN 46360	Wanatah Public Library 104 N Main St. Wanatah, IN 46390

Copyright 2007. All rights reserved.
site design and maintenance by umedia.org

Welcome to WANATAH



Home

About Wanatah

Businesses

Community Events

Recreation

Clubs & Organizations

Churches

Schools

Town Government

Chamber of Commerce

Contact Info

Chamber Information

The Wanatah area Chamber of Commerce seeks to promote the town of Wanatah and its businesses. Interested individuals are welcome to attend our meetings held at the Town Hall four times a year on the second Thursday of each month at 6:30 PM. Upcoming meeting dates are April 12, 2007; August 9, 2007; Nov. 10, 2007 and February 14, 2008 (Annual Meeting).

Membership

Membership is open to area businesses, organizations and interested individuals. Yearly dues are:

Businesses	Individuals & Families
1-10 employees	\$25
11-25	\$50
26-100	\$100

Joining is easy! Become a member or renew your membership today!

Download a Membership Application

Chamber History

The Wanatah Area Chamber of Commerce was organized in 1991 by a group of area business owners to promote the town of Wanatah. Its purpose is to advance the civic, commercial, industrial and professional welfare of Wanatah.

Meeting Schedule

The chamber meets bi-monthly on the second Thursday at 6:30 PM at the Town Hall with an Annual Dinner Meeting in January.

Chamber Officers

President - David Kaiser
Vice President - Gene Shurte
Secretary - Shirley Egolf
Treasurer - Mark Brault

Chamber Directors

Through 2005
Shirley Egolf
Marlene Mitzner
Eugene Shurte

Through 2006
Jim Czerwonke
Minie Parker
Kathy Lawrence

Through 2007
Bryan Brault

Brian Pressel
David Kaiser
Mark Brault

Copyright 2007. All rights reserved.
site design and maintenance by imgdesignstudio.com

Welcome to
WANATAH

**Home****About Wanatah****Businesses****Community Events****Recreation****Clubs & Organizations****Churches****Schools****Town Government****Chamber of Commerce****Contact Info****Clubs & Organizations**

There are a variety of clubs and organizations in the Wanatah area, including:

Lion's Club	Wanatah Area Chamber of Commerce
4-H - Cass MerryMakers/Cass Champions	Wanatah Conservation Club
Little League	Wanatah Railroad Museum
Red Hat Society	Farm Bureau
Crossroads Garden Club	Girl's Softball
American Legion Post 403	Wanatah Historical Society
American Legion Post 403 S.A.L. Squadron	Girl Scouts
American Legion Post 403 Auxilliary	Evening Bells Homemakers' Club
Knights of Columbus	Clinton Twp. Homemakers' Extension Club
St. Vincent of DePaul Society	Scarecrow Festival
Ladies of Sacred Heart	Cass-Clinton Volunteer Fire Department

Copyright 2007. All rights reserved
site design and maintenance by cms

Welcome to WANATAH



Home

About Wanatah

Businesses

Community Events

Recreation

Clubs & Organizations

Churches

Schools

Town Government

Chamber of Commerce

Contact Info

Town Government & Services

Wanatah is governed by a Town Council consisting of 5 members representing 5 wards.

- Ward 1 - Larry Sellers
- Ward 2 - Chuck Jonas
- Ward 3 - Harry Bernstein
- Ward 4 - Jeff Newburn
- Ward 5 - Cory Mack



The Town Council meets regularly on the first Thursday of the month at the Town Hall at 6 PM. Meetings are open to the public.

The Town Hall is located at 104 N. Main St. Hours are Monday through Friday from 8:30 AM to 5 PM. The phone number is (219) 733-2340. Contact information for the town is listed below.

Town Hall/Utilities

- Clerk-Treasurer - Stephen E. Mockler
- Clerk - Laurie Shoupe

Water/Streets/Wastewater

- Public Works Superintendent - Chuck Mack
- Public Works Asst. Superintendent - Chuck Jonas

Other

- Town Attorney - Alan Sirinek
- Building Commissioner - Lee Campbell

Regular garbage pickup is every Monday. Residents are allowed three 33-gallon containers each time. Recyclable materials are picked up every other Wednesday.

Dial 911 for Fire, Police or EMS

Town Ordinances

The complete code is available from the Town Hall, but below are a few selected ordinances which are in place to help keep our community attractive and comfortable.

Those found in violation of these ordinances are liable to fines and other sanctions.

Town Code: Chapter 7, Article II, Section 10

Before proceeding with the erection, construction, enlargement, alteration, moving, removal, demolition, conversion, electrical, plumbing of all buildings or structures in the incorporated area of the Town of Wanatah, a permit shall first be obtained by the owner from the Building Commissioner.

Town Code: Chapter 8, Article I, Section I

Animals are not permitted to run at large without restraint. They are subject to confinement and owners will be fined.

Town Code: Chapter 9, Article III-amended

Weeds or rank vegetation are not permitted to grow in excess of 12" in height. A charge will be assessed if it becomes necessary for the Town to cut and haul away unsightly vegetation.

Ordinance I-72

The keeping of motor vehicles without current license plates, or any junked or abandoned vehicles on private or public property exposed to public view, is prohibited. These vehicles are subject to towing and owners will be fined.

Wanatah Public Library

Also located in the Town Hall is the Wanatah Public Library. In addition to regular library services, two computers with internet access are available for patron use and a storyhour for children is held each Tuesday at 3:30.

Library hours are Monday through Friday from 11:00 AM - 7:00 PM and Saturday from 9:00 AM - noon. The library is closed on Sundays and major holidays. The phone number is (219) 733-9303.

Volunteer Fire Dept.

The Wanatah area is served by the Cass-Clinton Volunteer Fire Dept. The station is located at 118 W. 2nd St.

Emergency Medical Services

Wanatah is also home to the southern base of the LaPorte County EMS Dept.

Police

Police protection is provided by LaPorte County Sheriff's Dept.

REAL Services

Low-cost lunches served daily at the American Legion Post 403 for Senior Citizens. The Legion is located at the corner of W. Second St. & S. Washington St.
Call (219) 733-2945 for information.

Meals on Wheels

Meal delivered weekdays at noon to homebound, elderly or handicapped persons. Free. For information call (219) 326-7889.

Food Pantry

Welcome to

WANATAH

**Home****About Wanatah****Businesses****Community Events****Recreation****Clubs & Organizations****Churches****Schools****Town Government****Chamber of Commerce****Contact Info****About Wanatah**

Wanatah, Indiana is a town with a population of about 1,000 located in the northwestern corner of the state in southern LaPorte County. It is approximately 30 miles south of Lake Michigan at the intersection of US Hwy 30 and Hwy 421.

Map of the town**Town History**

Early settlers to the area found a huge marshland, but they persevered and they eventually turned the rich soil into good farmland. Game was also abundant, providing a steady food supply for these young families. Wanatah was founded in 1865 and included a hotel, flour mill, several stores and blacksmith shops, lumber, grain and agriculture businesses, physicians, churches, and telegraph offices. Its proximity to the two railroads which crossed in Wanatah was a strong contributor to its early growth.

Like many small towns, Wanatah has had its share of hardships and significant historical events. Among the more notable were the Yellowstone Trail going through Wanatah and the Abraham Lincoln Funeral Train making a stop in Wanatah.

The name 'Wanatah' has some debate surrounding its meaning and origin. One of the theories is that it was the name of a beautiful Indian girl, but the explanation which most people accept is that it was named after the Potawatomi Chief Wanatah and that the name means 'Knee Deep in Mud'.

Wanatah Today

Wanatah continues to enjoy growth while maintaining the closeness and friendliness of a small community. Those seeking the familiarity and pace of rural life while also enjoying the benefits of being near

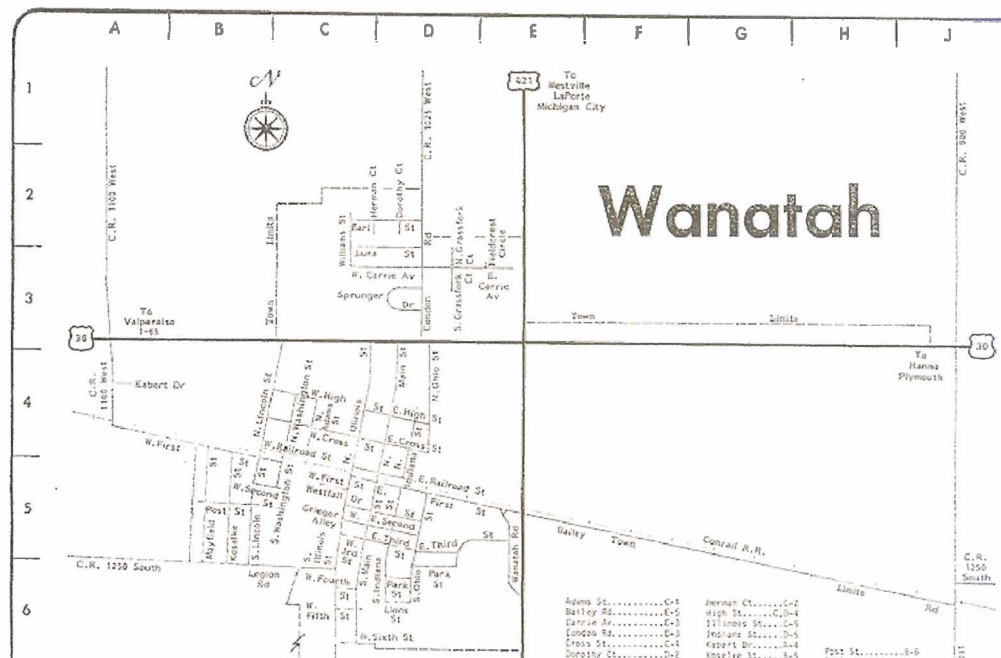

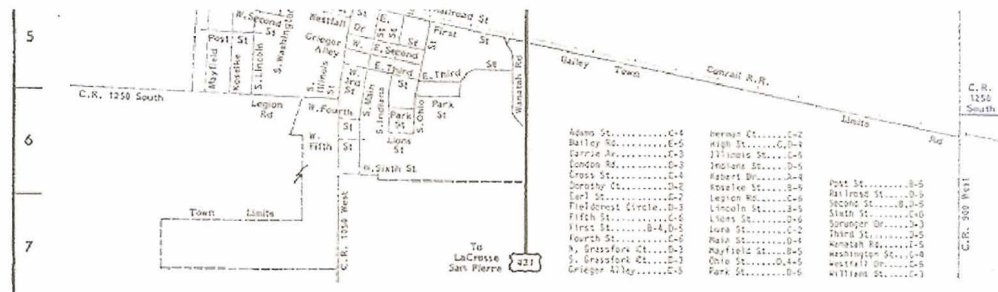

Copyright 2007. All rights reserved.
site design and maintenance by cmsdesignstudio.com