

ENGINEERING STATEMENT
IN SUPPORT OF
MODIFICATION TO BPH 20090811ACJ
APPLICATION FOR CONSTRUCTION PERMIT
KXXS (FM),
CHANNEL 223A
SUNSET VALLEY, TEXAS

August 19, 2009

Narrative

The following engineering exhibit is hereby being filed in support of a minor change application for KXXS (FM), Elgin, TX. In order to relocate to a new community of license, Sunset Valley, Texas, and change its tower site..

The proposed application seeks to change the channel of KBEY in Burnet, Texas from channel 223A to channel 280A at its current site. This engineering exhibit for KXXS will include the following:

A1 Allocation study from the proposed new allotment site for KXXS.

A2 Allocation study from the proposed new transmit site for KXXS.

A3 KBEY Allocation Study showing that this facility will be fully spaced at its current site on channel 280A with two reference coordinate modifications to vacant allotments.

A4 Contour maps showing 73.215 protection to station KLLR, 220A in Dripping Springs, TX.

A5 Map showing 70dBu contour of KXXS will cover 100% of the population and land area of Sunset Valley, TX. from the reference coordinates and from the new proposed tower site.

A6 Environmental Report

A7 Tower registration for American Tower ASR1013180.

EXHIBIT A1

Allocation Study to Reference Coordinates, 223A, Sunset Valley, Texas, 30-16-56 N, 97-42-35 W (NAD 27)

Callsign	State	City	Freq	Chan	ERP_w	Class	Status	Dist-km	Sep	Clr	
	TX	ELGIN	92.7	224	0	C3	RSV	50.39	89	-38.6	Delete
871124MX	TX	ELGIN	92.5	223	0	A	USE	34.43	115	-80.6	Delete
KBEY	TX	BURNET	92.5	223	0	A	USE	81.65	115	-33.3	To 280A
KBEY	TX	BURNET	92.5	223	1800	A	LIC	77.46	115	-37.5	To 280A
KIIZ-FM	TX	KILLEEN	92.3	222	450	A	LIC	87.32	72	15.3	
KIIZ-FM	TX	KILLEEN	92.3	222	6000	A	LIC	91.66	72	19.7	
KLLR	TX	DRIPPING SPR	91.9	220	1100	A	LIC	30.6	31	-0.4	
KXXS	TX	ELGIN	92.5	223	3400	A	LIC	30.55	115	-84.4	Delete
KYKM	TX	YOAKUM	92.5	223	3000	A	LIC	114.72	115	-0.3	
KYLR	TX	HUTTO	92.1	221	2500	A	LIC	30.57	31	-0.4	
NEW	TX	AUSTIN	92.3	222	3	D	APP	9.95	0	9.9	
NEW	TX	AUSTIN	92.3	222	125	D	APP	18.88	0	18.9	
NEW	TX	AUSTIN	92.3	222	250	D	APP	13.41	0	13.4	
NEW	TX	DEL VALLE	92.5	223	20	D	APP	4.88	0	4.9	
NEW	TX	GREENSHORES	92.3	222	150	D	APP	12.72	0	12.7	
NEW	TX	SAN MARCOS	92.5	223	100	LP100	CP	45	67	-22	Note 1

Note 1-Existing Short-spacing to KXXS, there will be no increase in interference from the operating location to KXXS from the LP100

Exhibit A2

Allocation Study to Transmit Site,

223A, Sunset Valley, Texas, 30-19-23 N, 97-47-58 W (NAD 27)

Callsign	State	City	Freq	Chan	ERP_w	Class	Status	Dist	Sep	Clr	
	TX	ELGIN	92.7	224	0	C3	RSV	59.82	89	-29.2	Delete
871124MX	TX	ELGIN	92.5	223	0	A	USE	42.67	115	-72.3	Delete
KBEY	TX	BURNET	92.5	223	0	A	USE	72.52	115	-42.5	to 280A
KBEY	TX	BURNET	92.5	223	1800	A	LIC	68.03	115	-47	to 280A
KIIZ-FM	TX	KILLEEN	92.3	222	0	A	USE	89.01	72	17	
KIIZ-FM	TX	KILLEEN	92.3	222	450	A	LIC	83.64	72	11.6	
KIIZ-FM	TX	KILLEEN	92.3	222	6000	A	LIC	87.99	72	16	
		DRIPPING									
KLLR	TX	SPRINGS	91.9	220	1100	A	LIC	24.75	31	-6.3	73.215
KRNH	TX	KERRVILLE	92.3	222	20000	C2	LIC	124.99	106	19	
KXXS	TX	ELGIN	92.5	223	3400	A	LIC	40.07	115	-74.9	Delete
KYKM	TX	YOAKUM	92.5	223	3000	A	LIC	122.71	115	7.7	
KYKM*	TX	YOAKUM	92.5	223	0	A	USE	121.15	115	6.2	
KYLR	TX	HUTTO	92.1	221	0	A	USE	31.03	31	0	
KYLR	TX	HUTTO	92.1	221	2500	A	LIC	31.45	31	0.5	
NEW	TX	AUSTIN	92.3	222	3	D	APP	0.22	0	0.2	
NEW	TX	AUSTIN	92.3	222	125	D	APP	12.82	0	12.8	
NEW	TX	AUSTIN	92.3	222	250	D	APP	14.15	0	14.2	
NEW	TX	BEE CAVE	92.5	223	10	D	APP	13.3	0	13.3	
NEW	TX	DEL VALLE	92.5	223	20	D	APP	6.18	0	6.2	
NEW	TX	GREENSHORES	92.3	222	150	D	APP	3.07	0	3.1	
NEW	TX	SAN MARCOS	92.5	223	100	LP100	CP	46.65	67	-20.4	Note 1

Note 1-Existing Short-spacing to KXXS, there will be no increase in interference from the operating location to KXXS from the LP100

EXHIBIT A3

**MINOR CHANGE APPLICATION/
ORDER TO SHOW CAUSE EXHIBIT
BMP AUSTIN LICENSE COMPANY, LP
KXXS RADIO STATION
ELGIN, TEXAS
August 2009**

TECHNICAL STATEMENT

This Technical Statement and attached exhibits were prepared on behalf of BMP Austin License Company, LP (“BMP”), licensee of KXXS, Channel 223A, Elgin, Texas. BMP is submitting an amendment to the pending minor change application for KXXS (BPH-20090811ACJ), seeking to relocate the station to another new transmitter site and change its community of license. The earlier proposal for KXXS that requires station KBEY, Channel 223A, Burnet, Texas be moved from Channel 223A to Channel 280A at the station’s currently licensed transmitter site remains in effect. Therefore, BMP again requests the Commission issue an Order to Show Cause to the licensee of KBEY as to why its license should not be modified to specify Channel 280A in lieu of Channel 223A.

It is noted that the licensee of KHLE, Channel 295A, Kempner, Texas filed an amendment to a pending application (BPH-20080625AAV) on August 14, 2009, seeking a non-adjacent channel change to Channel 280A at Kempner. This amendment failed to consider the earlier filed KXXS application and accompanying request to substitute Channel 280A for Channel 223A at Burnet, Texas, which was submitted three days earlier, on August 11, 2009 and served on the licensee. It is assumed that the licensee was in receipt of the KXXS application

amendment on August 14, 2009. As the KHLE amendment is late filed and defective, it should be dismissed by the Commission. Therefore, the Kempner request for Channel 280A is not considered herein.

The pending KXXS application requests that, in order to accommodate the use of Channel 280A at the KBEY site, it is necessary to adjust the allocation reference coordinates for two vacant and unapplied for FM allotments: Channel 281C2 at Mason, Texas and Channel 282A at Santa Anna, Texas. These proposed coordinates changes remain in effect. The showings are re-submitted so they will become part of the amendment as filed. The Mason allotment is relocated to allow for the allotment of Channel 280A at Burnet, Texas and the Santa Anna allotment is relocated to accommodate the change in allocation reference site for Mason, Texas. Neither of these allotments are involved in FM Auction 79.

CHANNEL 280A - BURNET, TEXAS

As indicated on Exhibit #1, Channel 280A meets the Commission's minimum distance separation requirements to all licensed, applied for or proposed facilities (domestic and international), provided the allotment for Channel 281C2 at Mason, Texas is changed, as detailed below. Based on a revised set of allocation coordinates at Mason, Texas, Channel 280A can be allotted to Burnet, Texas at the licensed KBEY transmitter site at geographic coordinates North Latitude 30° 44' 29" and West Longitude 98° 19' 05". As this is the KBEY operating site, a 70 dBu contour is provided to Burnet, Texas. Further, this is an existing tower site and, therefore, presumed to be an acceptable allocation location.

CHANNEL 281C2 - MASON, TEXAS

In order to accommodate the allocation of Channel 280A at Burnet, Texas, it is necessary to adjust the allocation reference coordinates of Channel 281C2 at Mason, Texas. As indicated on Exhibit #2, Channel 281C2 at Mason, Texas would meet the Commission's minimum distance separation requirements to all licensed, applied for or proposed facilities (domestic and international), provided the allotment of Channel 282A at Santa Anna, Texas is changed, as detailed below. Channel 281C2 can remain allotted to Mason, Texas at geographic coordinates North Latitude 30° 49' 09" and West Longitude 99° 25' 22". This represents a site restriction 20.0 kilometers west-northwest to avoid shortspacing Channel 280A at Burnet, Texas. From the proposed reference location, a 70 dBu contour is delivered over the community of Mason, Texas, as indicated on Exhibit #3. Further, the proposed allocation reference site for Mason, Texas is not located offshore or on airport property and is, therefore, suitable for tower construction. A portion of a 7.5 minute topographic map showing the proposed allocation site is attached as Exhibit # 4.

CHANNEL 282A - SANTA ANNA, TEXAS

In order to accommodate the adjustment of the allocation site for Channel 281C2 at Mason, Texas, it is necessary to adjust the allocation reference coordinates of Channel 282A at Santa Anna, Texas. As indicated on Exhibit #5, Channel 282A at Santa Anna, Texas meets the Commission's minimum distance separation requirements to all licensed, applied for or proposed facilities (domestic and international). Channel 282A can remain allotted to Santa Anna, Texas at geographic coordinates North Latitude 31° 46' 30" and West Longitude 99° 19' 33". This

represents a site restriction 3.7 kilometers north-northwest to avoid shortspacing Channel 281C2 at Mason, Texas. From the proposed reference location, a 70 dBu contour is delivered over the community of Santa Anna, Texas, as indicated on Exhibit #6. Further, the proposed allocation reference site for Santa Anna, Texas is not located offshore or on airport property and is, therefore, suitable for tower construction. A portion of a 7.5 minute topographic map showing the proposed allocation site is attached as Exhibit #7.

Based on the foregoing, BMP requests the Commission issue an Order to Show Cause to the licensee of KBEY regarding the proposed substitution of Channel 280A for Channel 223A at Burnet, Texas. BMP herein states that it will reimburse the licensee of KBEY for reasonable expenses for the implementation of the requested channel change. Further, to accommodate the allotment of the channel at Burnet, Texas, BMP requests the Commission make the above requested changes in the allocation reference sites for the respective channels at Mason, Texas and Santa Anna, Texas.

This statement and attachments were prepared on behalf of BMP Austin License Company, LP, by Graham Brock, Inc., its Technical Consultants. All information contained herein is true and accurate to the best of our belief and knowledge. All data regarding FM facilities was extracted from the FCC's CDBS database. We assume no liability for errors or omissions in that database.

**MINOR CHANGE APPLICATION/
ORDER TO SHOW CAUSE EXHIBIT
BMP AUSTIN LICENSE COMPANY, LP
KXXS RADIO STATION
ELGIN, TEXAS
August 2009**

EXHIBIT #1

Clearance Study for Channel 280A Burnet, Texas
Using KBEY Licensed Site as Reference

REFERENCE	CLASS = A Int = AA	DISPLAY DATES
30 44 29.0 N.		DATA 08-19-09
98 19 05.0 W.	Current Spacings to 3rd Adj.	SEARCH 08-19-09
----- Channel 280 - 103.9 MHz -----		

Call	Lat.	Channel	Lng.	Location	Ant	Azi Power	Dist HAAT	FCC	Margin
AD280	ADD	280A	Burnet		TX	0.0	0.0	115.0	-115.0
	30 44 29.0		98 19 05.0			6.000 kW	0 M		
	BMP Austin License Co, LP								
	> from Channel 223A - Reserved for KBEY Burnet, Texas								
* KHLE	RSV	280A	Kempner		TX	45.4	39.5	115.0	-75.5
	30 59 25.0		98 01 23.0			6.000 kW	100 M		
	Munbilla Fort Hood, Ltd.								
	> proposed non-adjacent channel substitution								
* KHLE	APP-Z	280A	Kempner		TX	42.9	54.5	115.0	-60.5
	31 05 59.0		97 55 41.0	ZCX		1.400 kW	199 M		
	Munbilla Fort Hood, Ltd. BPH-20080625AAV								
	> from Channel 295A - amendment filed August 14, 2009								
AD281	ADD	281C2	Mason		TX	275.0	106.1	106.0	0.10
	30 49 09.0		99 25 22.0			0.000 kW	0 M		
	BMP Austin License Co., LP								
	> adjusted reference coordinates.								
KBPA	LIC	278C0	San Marcos		TX	151.4	87.9	86.0	1.9
	30 02 42.0		97 52 50.0	CY		100.000 kW	383 M		
	Emmis Austin Radio Broadcast BLH-19880113KA								
KDHT	LIC	227C	Cedar Park		TX	93.0	31.5	29.0	2.5
	30 43 34.0		97 59 23.0	CX		100.000 kW	587 M		
	Emmis Austin Radio Broadcast BLH-20020404AAD								
AL5839	VAC	280A	Comanche		TX	348.2	131.0	115.0	16.0
	31 53 50.0		98 36 12.0			6.000 kW	100 M		
	Jeraldine Anderson RM-10210								
KJXJ	LIC	280C3	Franklin		TX	84.2	170.8	142.0	28.8
	30 53 05.0		96 32 29.0	CX		8.700 kW	168 M		
	Brazos Valley Communication BLH-20090528AJS								

* Note : The proposed use of Channel 280A at Kempner, Texas was filed as an amendment to a pending application on August 14, 2009, three days after the initial Order to Show Cause for Channel 280A at Burnet, Texas was submitted by BMP Austin License Co., LP. Therefore, the Kempner amendment did not protect the proposed Burnet change requested in the Order. The Kempner amendment is not considered herein and should be dismissed by the Commission for Failure to protect the proposed Burnet, Texas Channel 280A request.

**MINOR CHANGE APPLICATION/
ORDER TO SHOW CAUSE EXHIBIT
BMP AUSTIN LICENSE COMPANY, LP
KXXS RADIO STATION
ELGIN, TEXAS
August 2009**

EXHIBIT #2

Clearance Study for Channel 281C2 Mason, Texas
Using Updated Reference Site

REFERENCE	CLASS = C2 Int = AA	DISPLAY DATES
30 49 09.0 N.		DATA 08-19-09
99 25 22.0 W.	Current Spacings to 3rd Adj.	SEARCH 08-19-09
----- Channel 281 - 104.1 MHz -----		

Call	Channel	Location	Ant	Azi Power	Dist HAAT	FCC	Margin
Lat.	Lng.						
AD281	ADD 281C2	Mason	TX	0.0	0.0	190.0	-190.0
	30 49 09.0	99 25 22.0		0.000 kW	0 M		
	BMP Austin License Co., LP						
AD280	ADD 280A	Burnet	TX	94.4	106.1	106.0	0.10
	30 44 29.0	98 19 05.0		0.000 kW	0 M		
	BMP Austin License Co., LP						
	> from Channel 223A - Reserved for KBEY Burnet, Texas						
AD282	ADD 282A	Santa Anna	TX	4.9	106.4	106.0	0.38
	31 46 30.0	99 19 33.0		0.000 kW	0 M		
	BMP Austin License Co., LP.						
	> adjusted reference coordinates						
AL8445	VAC 284A	Junction	TX	209.1	55.5	55.0	0.48
	30 22 55.0	99 42 15.0		6.000 kW	100 M		
	Jeraldine Anderson		RM-10256				
KWTR	CP 281C1	Big Lake	TX	293.5	227.9	224.0	3.9
	31 37 05.0	101 37 35.0	CX	100.000 kW	299 M		
	Woodrow Michael Warren		BPB-20090206AAA				
KRIO-FM	LIC 281C1	Pearsall	TX	164.5	241.2	224.0	17.2
	28 43 16.0	98 45 43.0	CX	100.000 kW	299 M		
	BMP San Antonio License Co.		BLH-20020712AAC				
KBLT	LIC-N 282A	Leakey	TX	196.9	130.5	106.0	24.5
	29 41 34.0	99 48 56.0	NC	1.000 kW	181 M		
	Radio Cactus, Ltd.		BLH-19970612KB				
1327310	APP-N 284A	Kingsland	TX	100.0	82.9	55.0	27.9
	30 41 12.0	98 34 16.0	NCX	2.200 kW	165 M		
	Munbilla Broadcasting Prop.		BNPH-20090812AAL				
KHLE	RSV 280A	Kempner	TX	81.5	135.2	106.0	29.2
	30 59 25.0	98 01 23.0		6.000 kW	100 M		
	Munbilla Fort Hood, Ltd.						
KWTR	LIC 281A	Big Lake	TX	282.8	199.3	166.0	33.3
	31 11 54.0	101 27 45.0	C	0.500 kW	19 M		
	Woodrow Michael Warren		BLH-20010611AET				

Graham Brock, Inc. - Broadcast Technical Consultants

Mason, TX Ref

Latitude: 30-49-09 N
Longitude: 099-25-22 W
ERP: 50.00 kW
Channel: 281C2
Frequency: 104.1 MHz
AMSL Height: 709.555 m
Horiz. Pattern: Omni
Prop Model: None

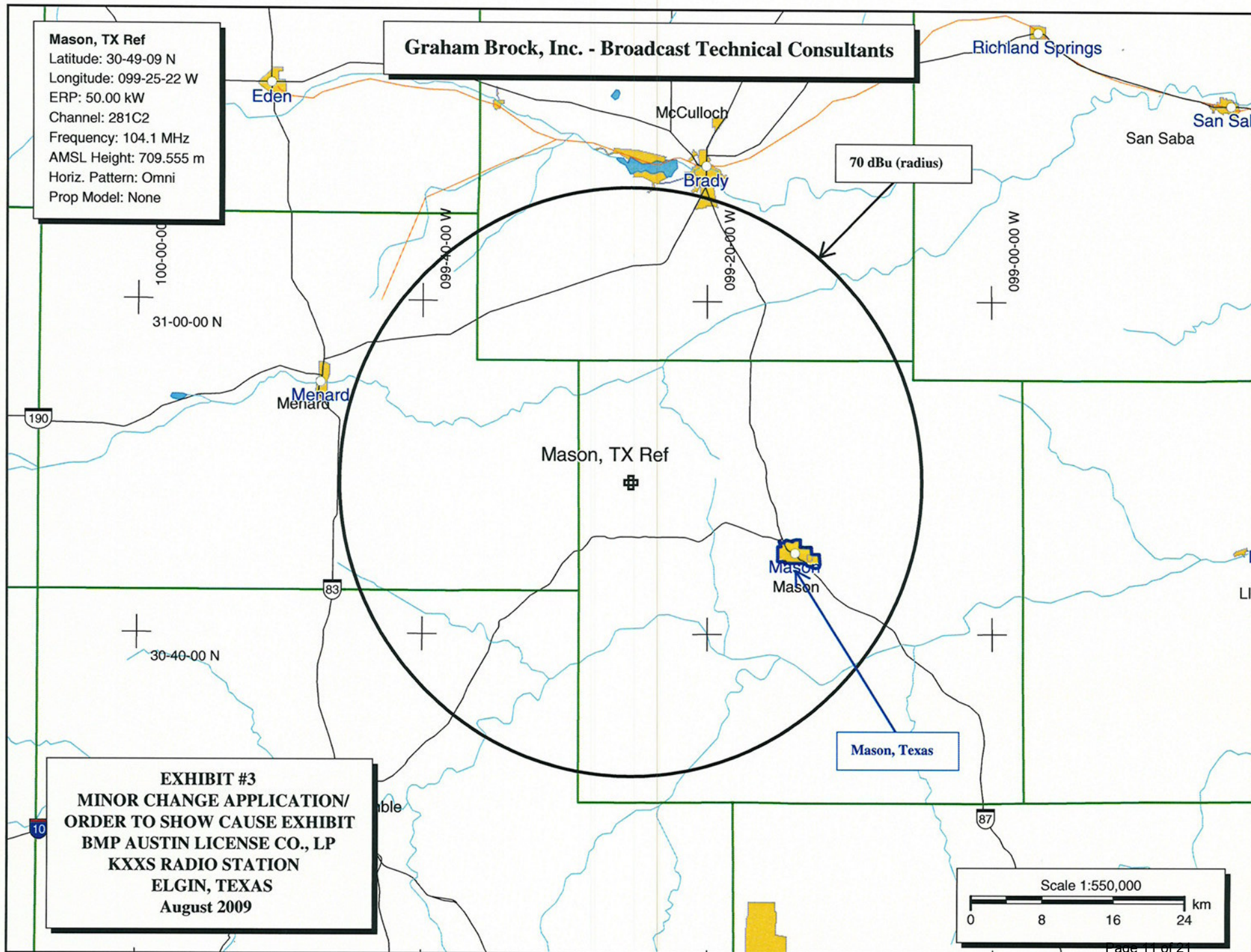
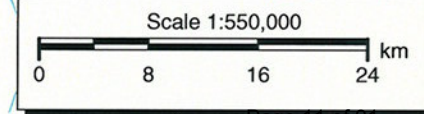

EXHIBIT #3
MINOR CHANGE APPLICATION/
ORDER TO SHOW CAUSE EXHIBIT
BMP AUSTIN LICENSE CO., LP
KXXS RADIO STATION
ELGIN, TEXAS
August 2009



GRAHAM BROCK, INC.

BROADCAST TECHNICAL CONSULTANTS

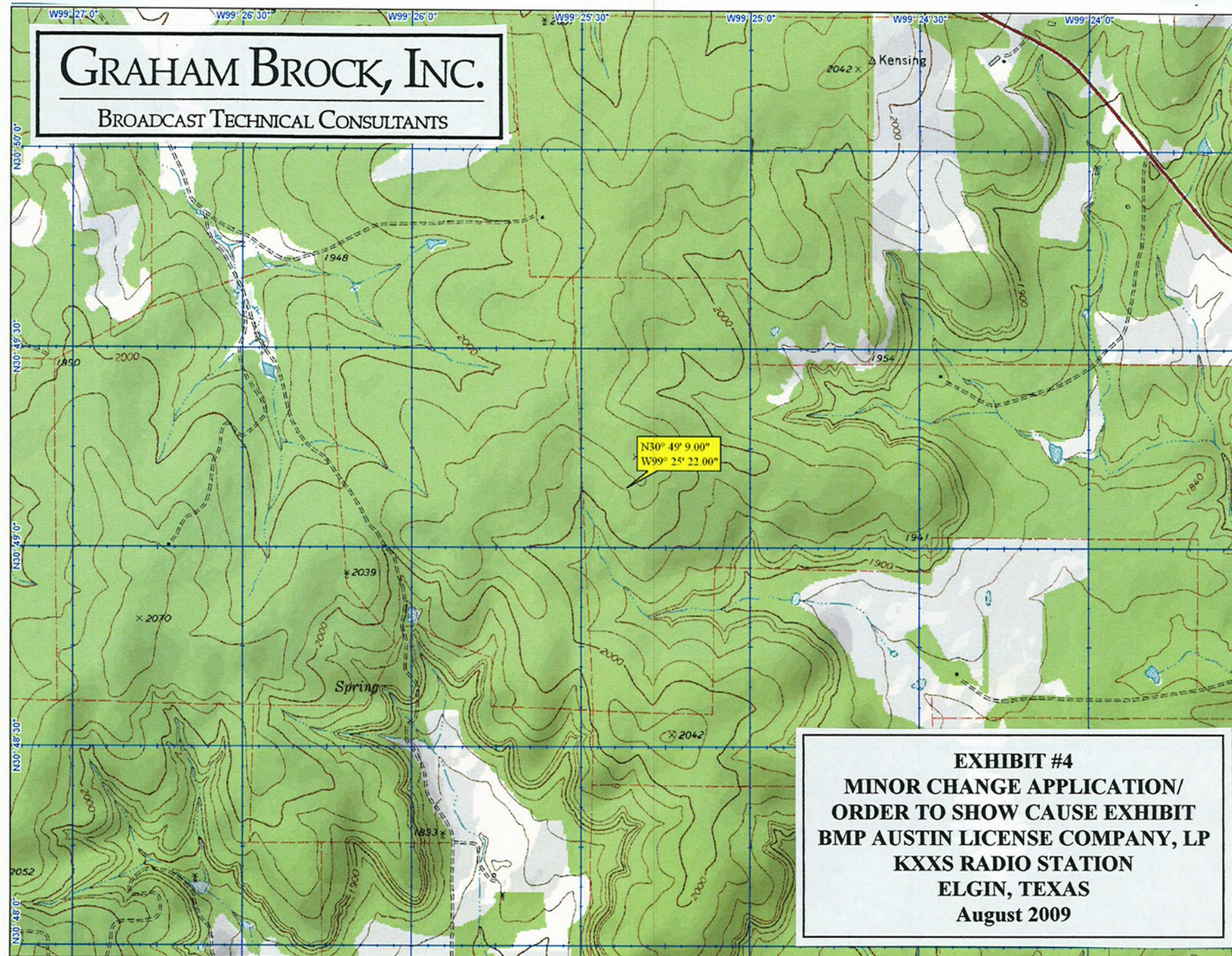
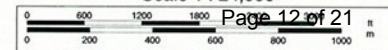

EXHIBIT #4
**MINOR CHANGE APPLICATION/
ORDER TO SHOW CAUSE EXHIBIT**
BMP AUSTIN LICENSE COMPANY, LP
KXXS RADIO STATION
ELGIN, TEXAS
August 2009



Scale 1 : 24,000



1" = 2,000.0 ft

Data Zoom 13-1

**MINOR CHANGE APPLICATION/
ORDER TO SHOW CAUSE EXHIBIT
BMP AUSTIN LICENSE COMPANY, LP
KXXS RADIO STATION
ELGIN, TEXAS
August 2009**

EXHIBIT #5

Clearance Study for Channel 282A Santa Anna, Texas
Using Updated Reference Site

REFERENCE	CLASS = A Int = AA	DISPLAY DATES
31 46 30.0 N.	Current Spacings to 3rd Adj.	DATA 08-19-09
99 19 33.0 W.	Channel 282 - 104.3 MHZ	SEARCH 08-19-09

Call	Channel	Location	Ant	Azi Power	Dist HAAT	FCC	Margin
Lat.	Lng.						
AD282	ADD 282A	Santa Anna	TX	0.0	0.0	115.0	-115.0
	31 46 30.0	99 19 33.0		0.000 kW	0 M		
	BMP Austin License Co., LP						
	> adjusted reference coordinates.						
AD281	ADD 281C2	Mason	TX	185.0	106.4	106.0	0.38
	30 49 09.0	99 25 22.0		0.000 kW	0 M		
	BMP Austin License Co., LP						
	> adjusted reference coordinates.						
AU3729935VAC	283A	Eden	TX	218.5	78.9	72.0	6.9
	31 13 06.0	99 50 36.0		6.000 Kw	100 M		
NEW	CP -Z 283C2	Grape Creek	TX	251.5	122.0	106.0	16.0
	31 25 16.4	100 32 35.7	ZCX	33.000 kW	183 M		
	James Falcon		BNPH-20050103ABC				
AL6070	VAC 284A	Blanket	TX	83.8	51.3	31.0	20.3
	31 49 24.0	98 47 12.0		6.000 kW	100 M		
	Robert Fabian		RM-10601				
KAHA	CP -Z 282C2	Olney	TX	19.4	190.1	166.0	24.1
	33 23 21.0	98 38 34.0	ZCX	50.000 kW	150 M		
	South Texas FM Investments		BMPH-20070202AEF				
KCDD	CP -N 279C	Hamlin	TX	326.6	126.7	95.0	31.7
	32 43 31.0	100 04 19.0	NCX	100.000 kW	453 M		
	Cumulus Licensing LLC		BPH-20090126AEB				
AL7921	ADD 283C2	Hamlin	TX	336.7	140.4	106.0	34.4
	32 56 07.0	99 55 19.0		50.000 kW	150 M		
	James Falcon		RM-coord-4				
AL5839	VAC 280A	Comanche	TX	78.5	69.7	31.0	38.7
	31 53 50.0	98 36 12.0		6.000 kW	100 M		
	Jeraldine Anderson		RM-10210				
KCDD	LIC 279C0	Hamlin	TX	326.6	126.7	86.0	40.7
	32 43 31.0	100 04 19.0	CY	100.000 kW	300 M		
	Cumulus Licensing LLC		BLH-19870206KC				

Santa Anna, TX Ref
Latitude: 31-46-30 N
Longitude: 099-19-33 W
ERP: 6.00 kW
Channel: 282A
Frequency: 104.3 MHz
AMSL Height: 592.39 m
Horiz. Pattern: Omni
Prop Model: None

Graham Brock, Inc. - Broadcast Technical Consultants

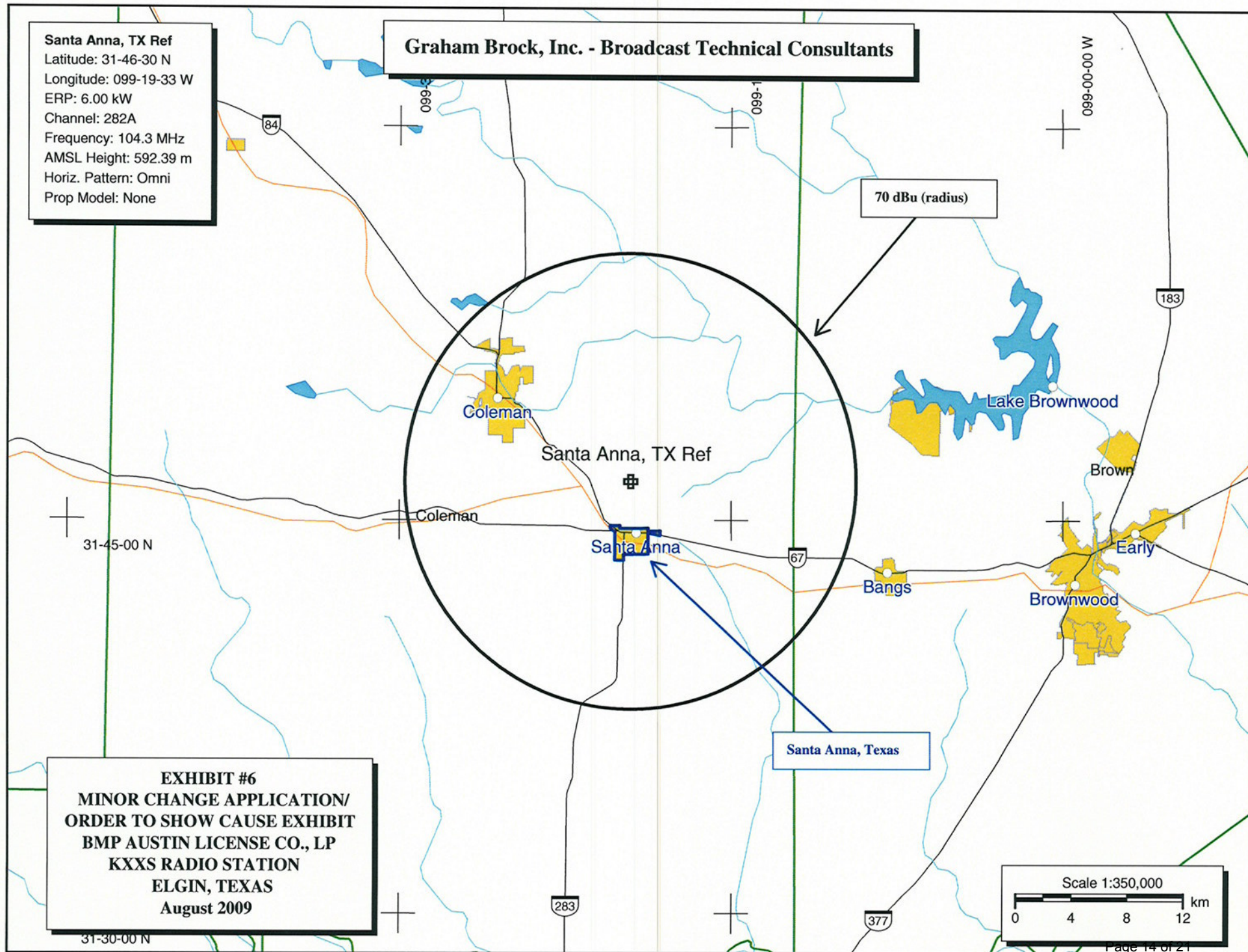

EXHIBIT #6
MINOR CHANGE APPLICATION/
ORDER TO SHOW CAUSE EXHIBIT
BMP AUSTIN LICENSE CO., LP
KXXS RADIO STATION
ELGIN, TEXAS
August 2009

GRAHAM BROCK, INC.

BROADCAST TECHNICAL CONSULTANTS

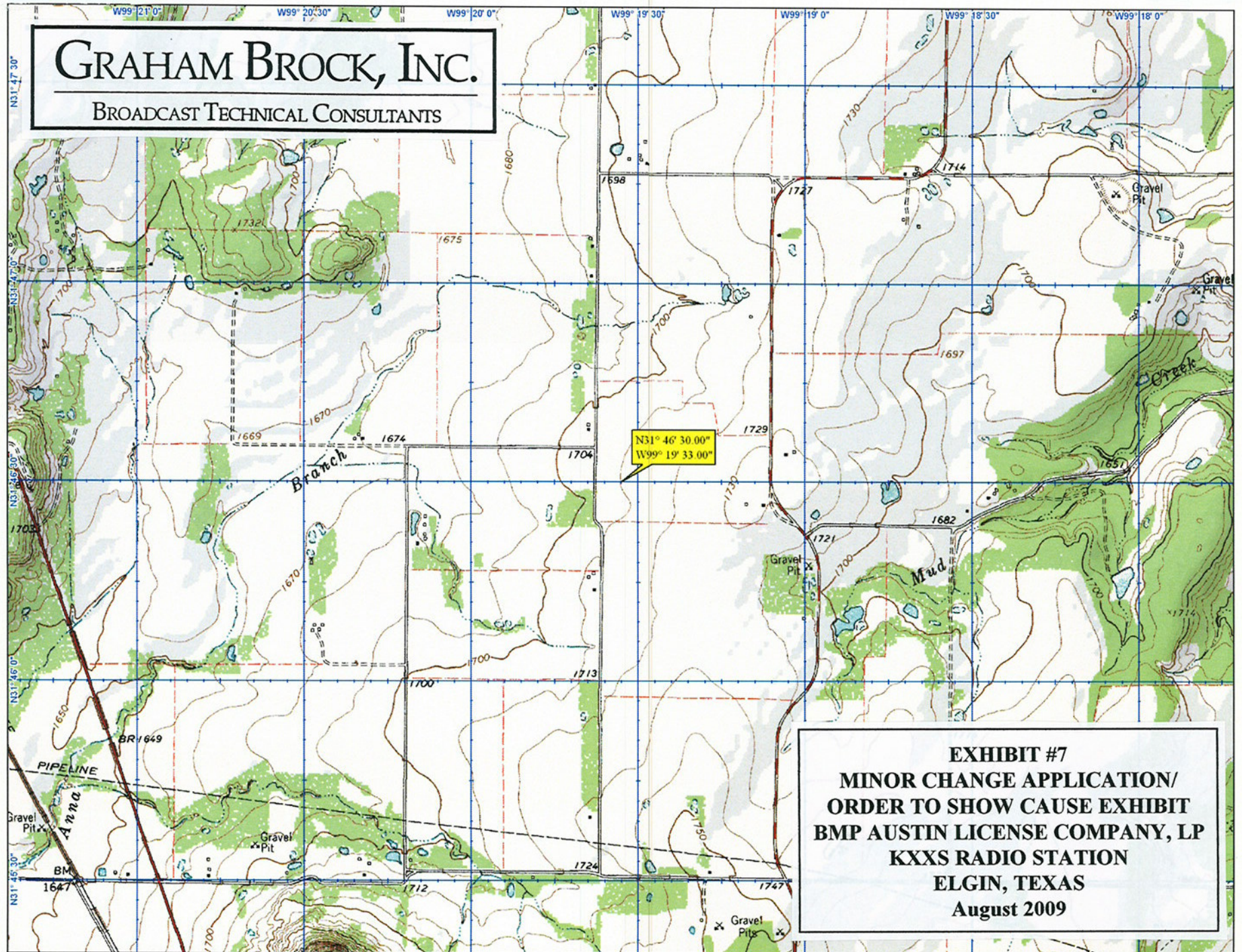
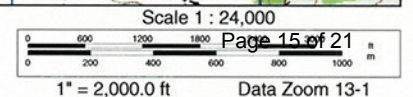
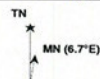

EXHIBIT #7
**MINOR CHANGE APPLICATION/
ORDER TO SHOW CAUSE EXHIBIT**
BMP AUSTIN LICENSE COMPANY, LP
KXXS RADIO STATION
ELGIN, TEXAS
August 2009



AFFIDAVIT AND QUALIFICATIONS OF CONSULTANT

State of Georgia)
St. Simons Island) ss:
County of Glynn)

JEFFERSON G. BROCK, being duly sworn, deposes and says that he is an officer of Graham Brock, Inc. Graham Brock has been engaged by BMP Austin License Company, LP, to prepare the attached Technical Exhibit.

His qualifications are a matter of record before the Federal Communications Commission. He has been active in Broadcast Engineering since 1979.

The attached report was either prepared by him or under his direction and all material and exhibits attached hereto are believed to be true and correct.

This the 19th day of August 2009.

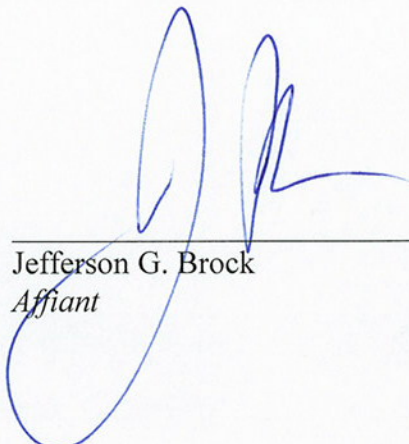

Jefferson G. Brock
Affiant

*Sworn to and subscribed before me
this the 19th day of August 2009*

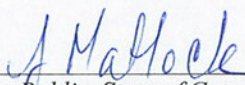

Notary Public, State of Georgia
My Commission Expires: June 16, 2012

Exhibit A4 Contour Protection between KXXS Transmit site and KLLR

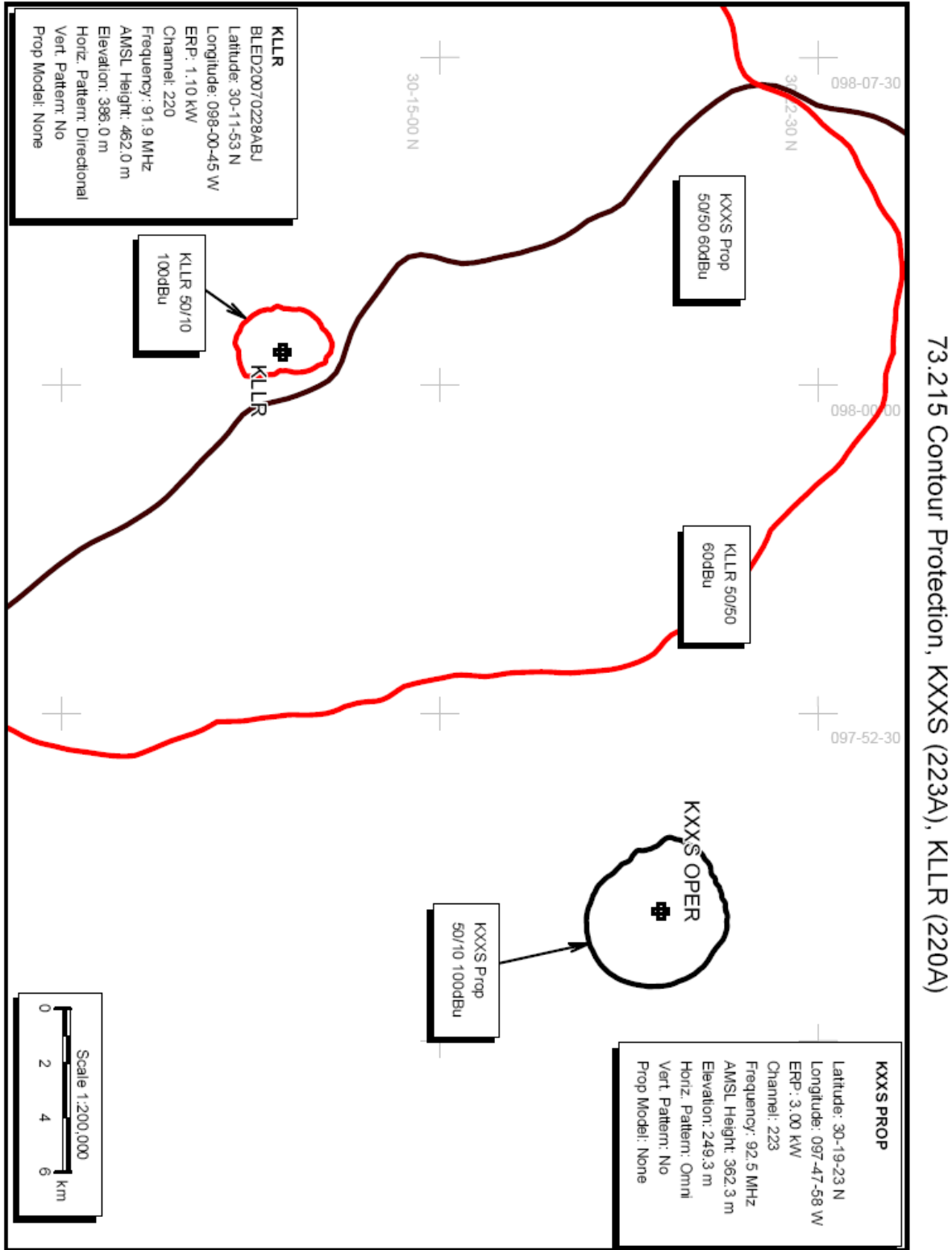

Exhibit A5, City of License Coverage (70dBu)

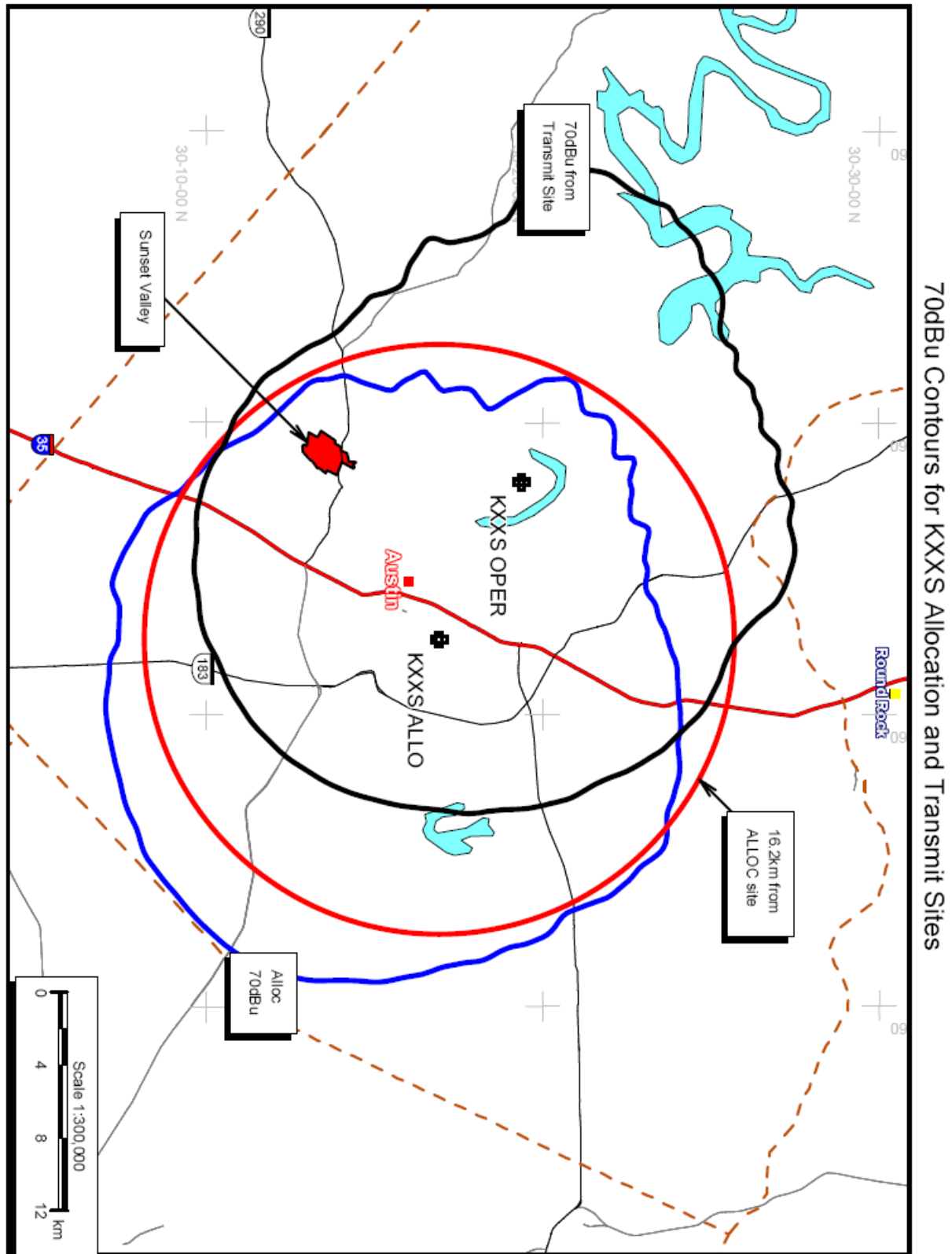

EXHIBIT A6

NONIONIZING RADIATION COMPLIANCE

KXXS (FM) from ASR 1013180

The proposed KXXS antenna system will operate on FM Channel 223A with a non-directional maximum effective radiated power of 3.0 kilowatts using a standard “rototiller” type antenna with its center of radiation located 113 meters above ground level. The tower that will support the KXXS antenna is also authorized to support the antennas for the following other stations:

KAMX, Luling, TX. Channel 234C0, 100Kw

KFMK, Round Rock, TX. Channel 290C2, 4.5Kw

KKMJ-FM, Austin, TX. Channel 238C1, 49Kw

KMFA, Austin, TX. Channel 208C1, 40Kw

KROX-FM, Buda, TX. Channel 268C2, 12.5Kw

KVET-FM, Austin, TX. Channel 251C1, 49.8Kw

With the exception of these six other stations, there are no other non-excluded RF sources located within 315 meters of the proposed KXXS site.

According to the FCC “FM Model for Windows” Power Density vs. distance calculator, The KXXS antenna will generate a maximum power density of $1.41 \mu\text{W}/\text{cm}^2$, or 0.7% of the permitted level for uncontrolled exposure at 2 meters above ground. Since this level is less than 5% of the permitted level for uncontrolled exposure, the proposed KXXS transmitter is considered to be an excluded RF source and need not be considered as a contributor at the shared tower site. The results of those calculations are shown below.

Based on the above information, the proposed KXXS facility will fully comply with the FCC standard with regard to uncontrolled exposure to nonionizing radiation.

When it is operating with the proposed antenna system, KXXS, in conjunction with the other co-located stations, will take appropriate steps to insure that workers that must be on this tower will not be exposed to levels of nonionizing radiation that are in excess of the permitted level for controlled exposure. These steps will include the cessation of operation or a reduction in power, as appropriate, by one or more of these stations when workers must be in the areas on this tower where the total power density levels are in excess of the permitted level for controlled exposure

KXXS Booster Power Density

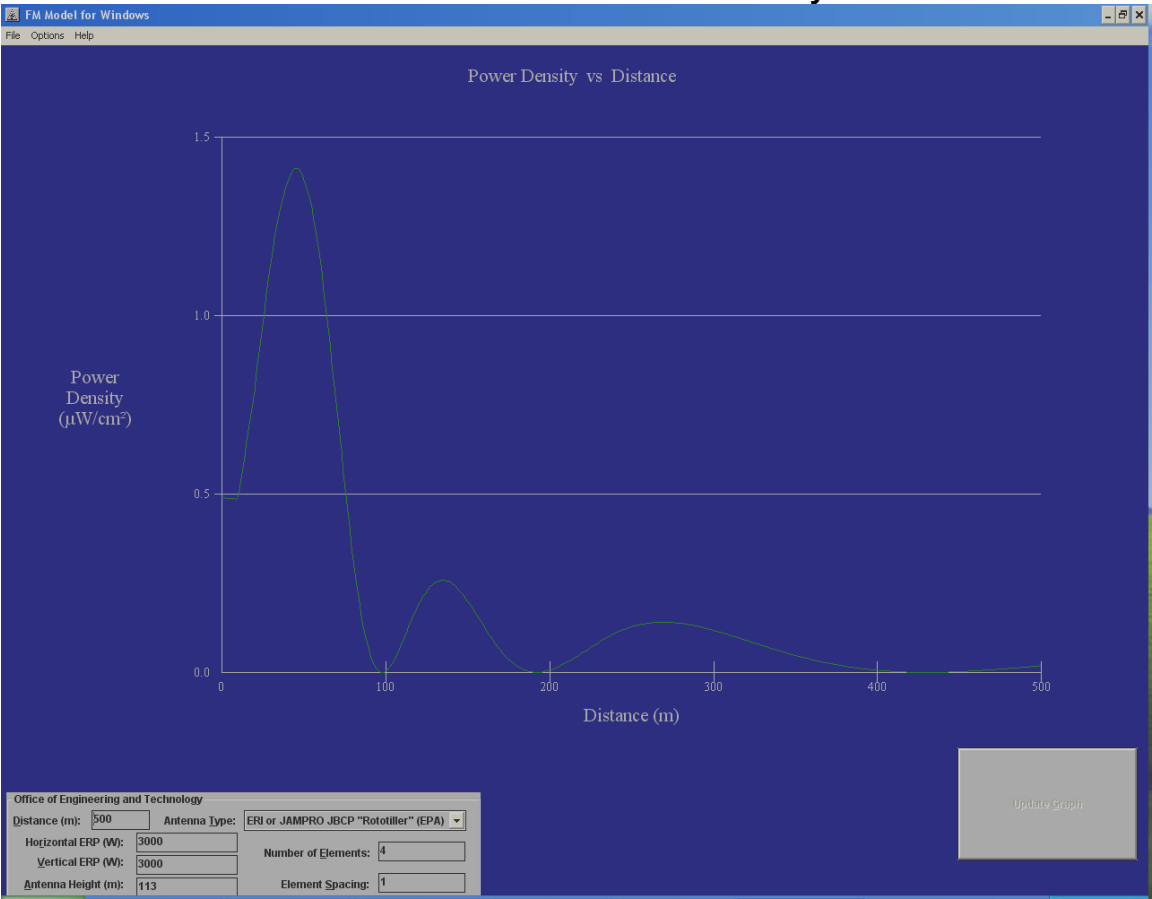

Exhibit A7, Proposed transmit site tower registration.

ASR Registration Search

Registration 1013180

 [Map Registration](#)

Registration Detail

Reg Number	1013180	Status	Constructed
File Number	A0610474	Constructed	10/08/1997
FAA Study	2008-ASW-4590-OE	EMI	No
FAA Issue Date	09/22/2008	NEPA	No

Antenna Structure

Structure Type TOWER - Free standing or Guyed Structure used for Communications Purposes

Location (in NAD83 Coordinates)

Lat/Long	30-19-23.8 N 097-47-59.5 W	5319 Buckman Mountain Road (Austin A #7000)
City, State	Austin , TX	
Center of AM Array		

Heights (meters)

Elevation of Site Above Mean Sea Level	Overall Height Above Ground (AGL)
249.3	374.6
Overall Height Above Mean Sea Level	Overall Height Above Ground w/o Appurtenances
623.9	351.1

Painting and Lighting Specifications

FAA Chapters 3, 4, 5, 13
Paint and Light in Accordance with FAA Circular Number 70/7460-1H

Owner & Contact Information

FRN	0011498342	Licensee ID	L00008376
-----	------------	-------------	-----------

Owner

American Towers, Inc.
Attention To: FAA/FCC Team
1898 Leland Drive
Marietta , GA 30067

P: (678)265-6770
E:

Contact

Team , Compliance
1898 Leland Drive
Marietta , GA 30067

P: (678)265-6770
E:

Last Action Status

Status	Constructed	Received	09/24/2008
Purpose	Notification	Entered	09/24/2008
Mode	Interactive		

Related Applications

09/24/2008	A0610473 - Modification (MD)
09/24/2008	A0610474 - Notification (NT)
08/04/2008	A0601418 - Admin Update (AU)
	Related applications (22)

* Reasonable assurance received by Vikki Amrine, American Tower Corporation,
August 17, 2009, contact vikki.amrine@americantower.com