

**Exhibit 13-B**  
**Section 74.1204**  
**WNTR Contour Protection**

W298BB Indianapolis, IN  
Contour map showing W298BB  
proposed operation on Channel 298D  
233 watts @ 266 m HAAT  
(non-directional antenna)  
Interfering contour with WNTR  
Channel 300B Indianapolis, IN  
does not reach the ground.

**WNTR F(50,50) 133.3 dBu contour**  
**(contour intersects W298BB**  
**proposed transmit site)**

**The proposed W298BB F(50,10)**  
**173.3 dBu contour is so small it**  
**cannot be calculated using the**  
**FCC FM TV Propagations Curves**  
**Calculations Program**

W298BB Proposed  
39-53-40 N ~ 86-12-21 W  
ERP: 0.233 kW HAAT: 266 m  
Frequency: 107.5 MHz  
Channel 298  
RC-AMSL: 518.5 m  
Horizontal Pattern: Omni

WNTR  
BLH19841009CB  
39-53-43.0 N ~ 86-12-04.0 W  
ERP: 22.0 kW HAAT: 232 m  
Frequency: 107.9 MHz  
Channel 300B  
RC-AMSL: 489 m  
Horizontal Pattern: Omni

**HORIZON**  
BROADCAST SOLUTIONS

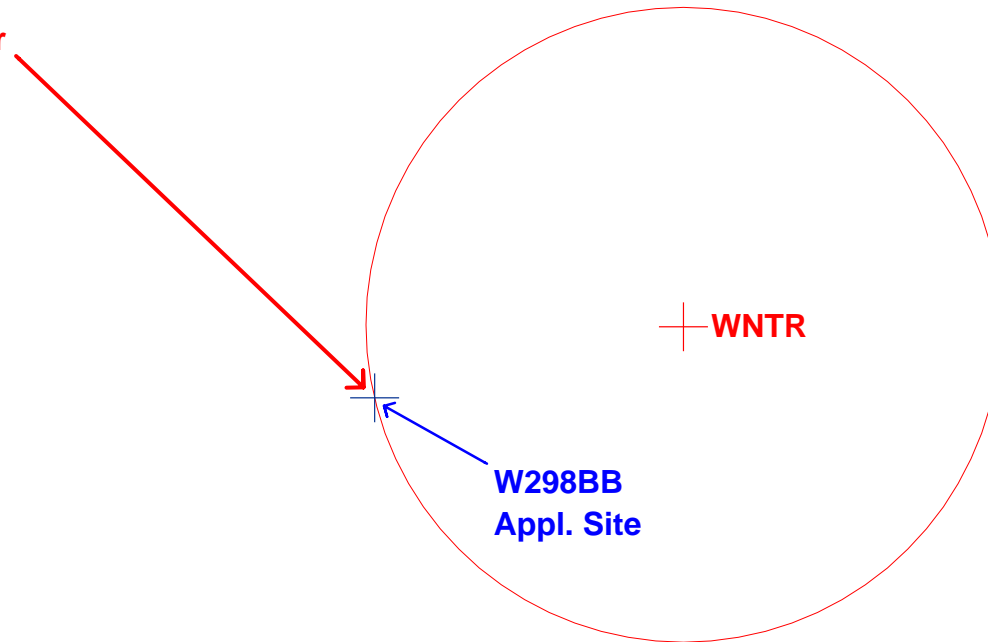

100 0 100 200 300 400 500  
Meters