

Exhibit 12 Bloomington, IN											
REFERENCE 39 11 44 N 86 33 28 W		CH# 276D - 103.1 MHz, Pwr= 0.019 kw, HAAT=100.3 M, COR= 300 M Average Protected F(50-50)= 6.84 km Ave. F(50-10) 40 dBu= 22.8 54 dBu= 9.7 80 dBu= 2.0 100 dBu= .3								DISPLAY DATES DATA 06-18-03 SEARCH 06-23-03	
CH CITY	CALL	TYPE STATE	AZI. <--	DIST FILE #	LAT. LNG.	Pwr(kw) HAAT(M)	COR(M) INT(km)	PRO(km) LICENSEE	*IN* (Overlap in km)	*OUT*	
276D Bloomington	AP276	APP C IN	0.0 180.0	0.00 BNPFT20030317AWS	39 11 44 86 33 28	0.019 77	300 22.8	6.0 Educational Media Foundati	-26.60*	-28.79*	
279B Bloomington	WFIU	LIC CN IN	137.7 317.7	8.01 BLH7418	39 08 32 86 29 43	34.000 159	397 0.6	62.4 Trustees Of Indiana Univer	-3.55	-55.02*	
279B Bloomington	WFIU.C	CP CX IN	137.9 317.9	8.04 BPH20020403AAD	39 08 31 86 29 43	29.000 175	413 0.6	62.7 Trustees Of Indiana Univer	-3.53	-55.29*	
275A Edinburgh	WYGB.A«	APP NCX IN	79.4 259.4	39.68 BPH20020206AAY	39 15 37 86 06 21	6.000 79	326 7.5	25.3 Edinburgh Radio	-4.61	6.84	
275A Edinburgh	WYGB	LIC DC IN	91.0 271.0	51.82 BLH20000929AEX	39 11 10 85 57 29	3.000 61	301 8.4	19.1 Edinburgh Radio	17.85	24.25	
277B Indianapolis	WRZX«	LIC CN IN	21.3 201.3	83.52 BLH19811015AN	39 53 43 86 12 04	18.000 287	515 12.2	68.0 Capstar Tx Limited Partner	-2.73	3.36	
276A Lawrenceville	WAKOFM	LIC CN IL	241.3 61.3	108.51 BLH19970425KA	38 43 23 87 39 13	6.000 108	231 16.3	29.3 Lawrenceville Broadcasting	15.49	62.87	
276A Versailles	WXCH	LIC CN IN	90.7 270.7	110.13 BLH19850715KA	39 10 38 85 17 00	3.000 111	387 19.8	25.4 Columbus Radio, Inc.	26.26	64.91	
274B Terre Haute	WLEZ	LIC CN IN	281.6 101.6	80.00 BLH19930817KC	39 20 13 87 28 00	28.000 176	357 0.6	62.5 Crossroads Investments, LI	68.65	16.86	
273A Mitchell	WWEG	LIC CN IN	171.7 351.7	62.58 BLH19910826KA	38 38 16 86 27 11	6.000 89	289 0.3	26.7 Mitchell Community Broadca	54.11	35.56	
276A St. Matthews	WRKA	LIC ZCN KY	143.9 323.9	127.29 BLH19920214KA	38 16 03 85 41 53	4.450 104	247 20.3	27.0 Cxr Holdings, Inc.	38.45	80.04	
276A Covington	WKZS	LIC CN IN	324.3 144.3	130.59 BLH19820610AN	40 08 46 87 27 15	3.000 105	281 20.3	24.8 Benton-weatherford Broadca	47.59	85.47	
273D Coatsville	AP273	APP C IN	347.4 167.4	56.11 BNPFT20030313BCP	39 41 19 86 42 03	0.050 76	314 0.3	7.5 Hoosier Broadcasting Corpo	48.98	48.33	
276A Covington	WKZS.C	CP CX IN	320.5 140.5	135.79 BPH20011001ABP	40 08 02 87 34 22	6.000 108	293 20.5	29.3 Benton-weatherford Broadca	41.67	85.98	
273D Danville	AP273	APP C IN	3.0 183.0	61.83 BNPFT20030310BDS	39 45 06 86 31 10	0.010 47	305 0.3	4.0 Indiana Community Radio Co	54.89	57.54	
273D Norristown	AP273	APP C IN	74.3 254.3	71.86 BNPFT20030312AYD	39 22 04 85 45 18	0.010 50	259 0.3	4.1 Indiana Community Radio Co	66.54	67.46	
275D Zionsville	AP275	APP C IN	15.9 195.9	87.40 BNPFT20030317GXD	39 57 07 86 16 33	0.250 49	301 8.8	9.2 Kaspar Broadcasting Co, In	68.36	69.45	

"*"Affixed to 'IN' or 'Out' values = site inside protected contour.
 ERP and HAAT are on direct line to and from reference station.
 "«" = Station meets FCC minimum distance spacing for its class.

Exhibit 12 (Compliance with CFR 74.1204)

The proposed FM Translator is located within the protected 60 dBu contour of third adjacent channel station WFIU, channel 279B, Bloomington, IN. The predicted F(50-50) field strength of WFIU at the proposed translator site is 93.7 dBu, see Exhibit 12A. Therefore, the respective predicted interfering contour generated by the proposed FM Translator is greater than 133.7 dBu. This interfering contour extends less than 7 meters from the proposed transmit antenna, and the area of overlap does not reach the ground.

Therefore, EMF respectfully requests a waiver of C.F.R. 74.1204 based on no population within the area of predicted interference.

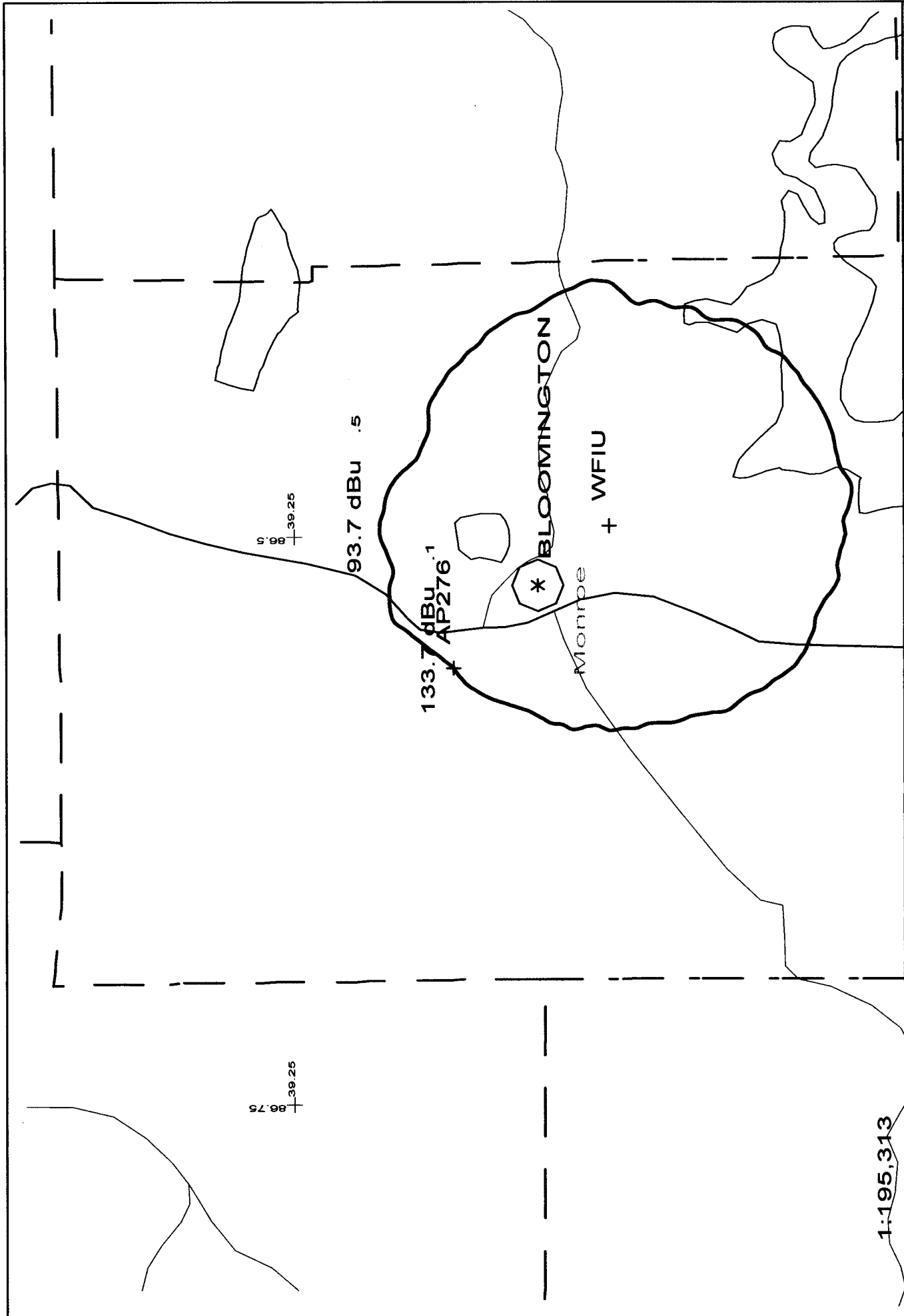

1:195,313

Scale in km



AP276 276D .019kW 300M AMSL

N. Lat. 39 11 44 W. Lng. 86 33 28

Exhibit 12A

- 05/03