

## **EXHIBIT 13**

### **Waiver Request of Section 74.1204**

Perrysburg, OH 250 Watts ERP

Fill-in Service

Calvary Chapel of Twin Falls, Inc. 7/10

The proposed site is contained entirely inside the service contour of second-adjacent station WKKO, Toledo, OH

### **WKKO**

The proposed site is contained entirely inside the service contour of second-adjacent station WKKO, Channel 260, Class B, 50kW, Toledo, OH. The level of least arriving protected F(50,50) signal at the proposed transmitter site is 83.5-dBu. Using the Undesired-to-Desired method for calculating proposed interference, the interfering contour with respect to WQMG-FM is 123.5-dBu (free-space contour method employed). The interfering signal would, in the worst case at the maximum radial, extend 76 meters, or 250 feet, from the base of the tower. This is a single AM Tower that operate WWYC Toledo. This proposal is for fill-in service. Attached is a portion of the USGS Ross (NC) Quadrangle, showing the tower has population around it, including homes and places of business. However, the buildings are no higher than two story within the 216.5 foot radius. There are no buildings tall enough and close enough to intersect the interfering contour, located 66 meters or 216.5 feet above the ground. Because there are no residences, businesses or major roadways that are located within the interfering contour, Calvary Chapel of Twin Falls, Inc. respectfully requests a waiver of the FM translator contour overlap regulations with respect to second-adjacent channel station WQMG-FM, Greensboro, NC.



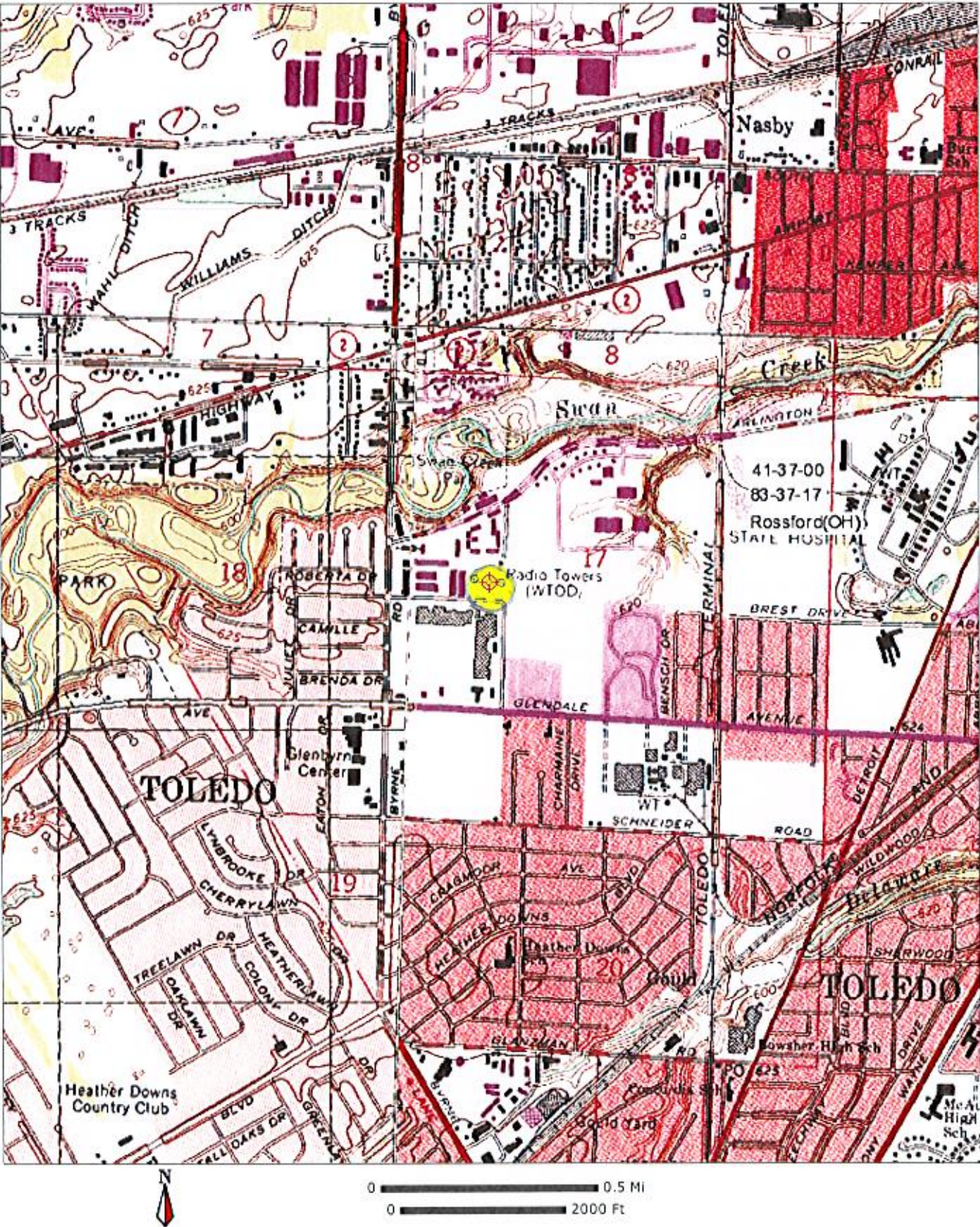



Map Header

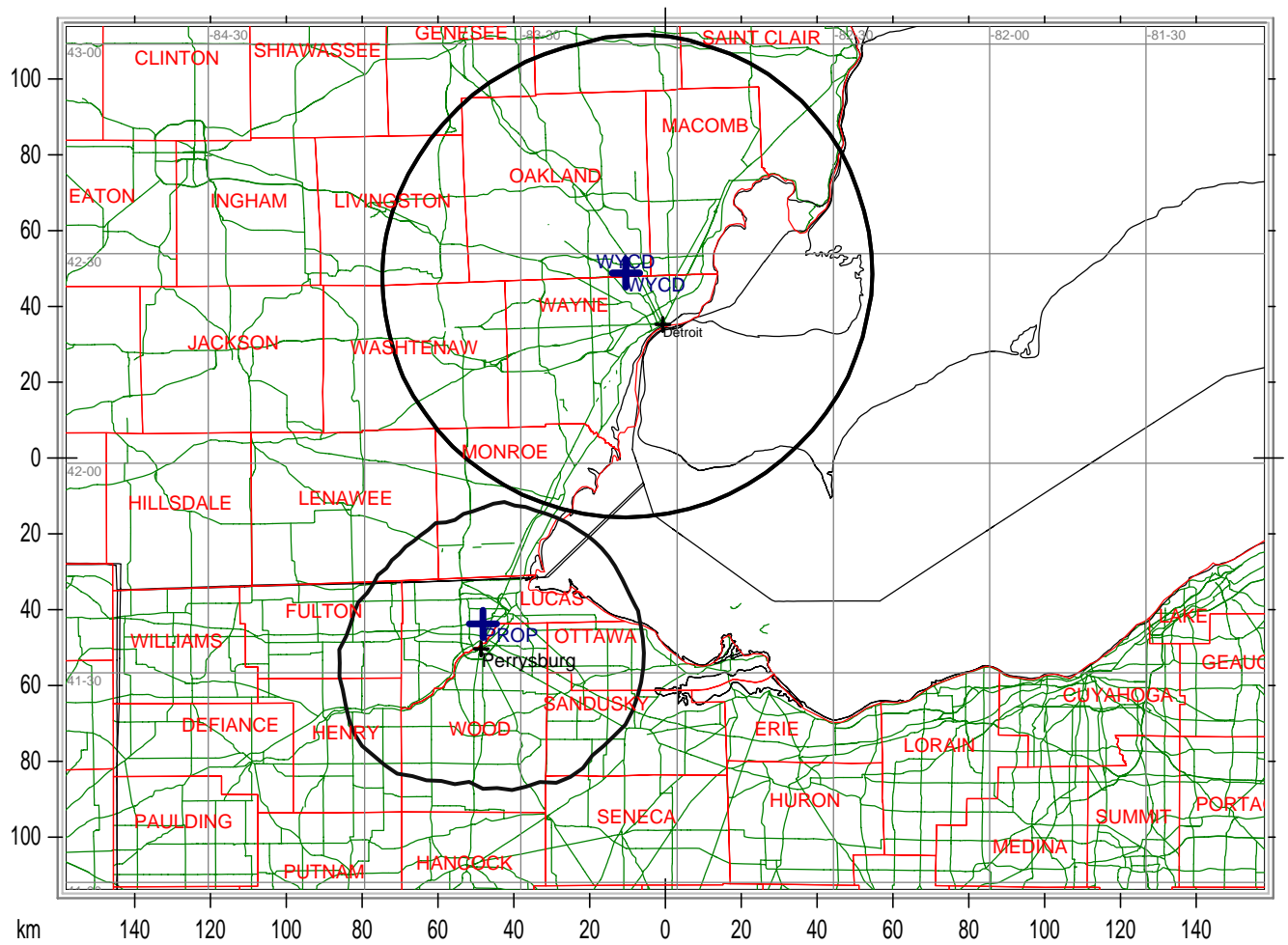

Map Footer

— County Borders   
 — State Borders   
 — Highways   
 — Lat/Lon Grid

## Map Header

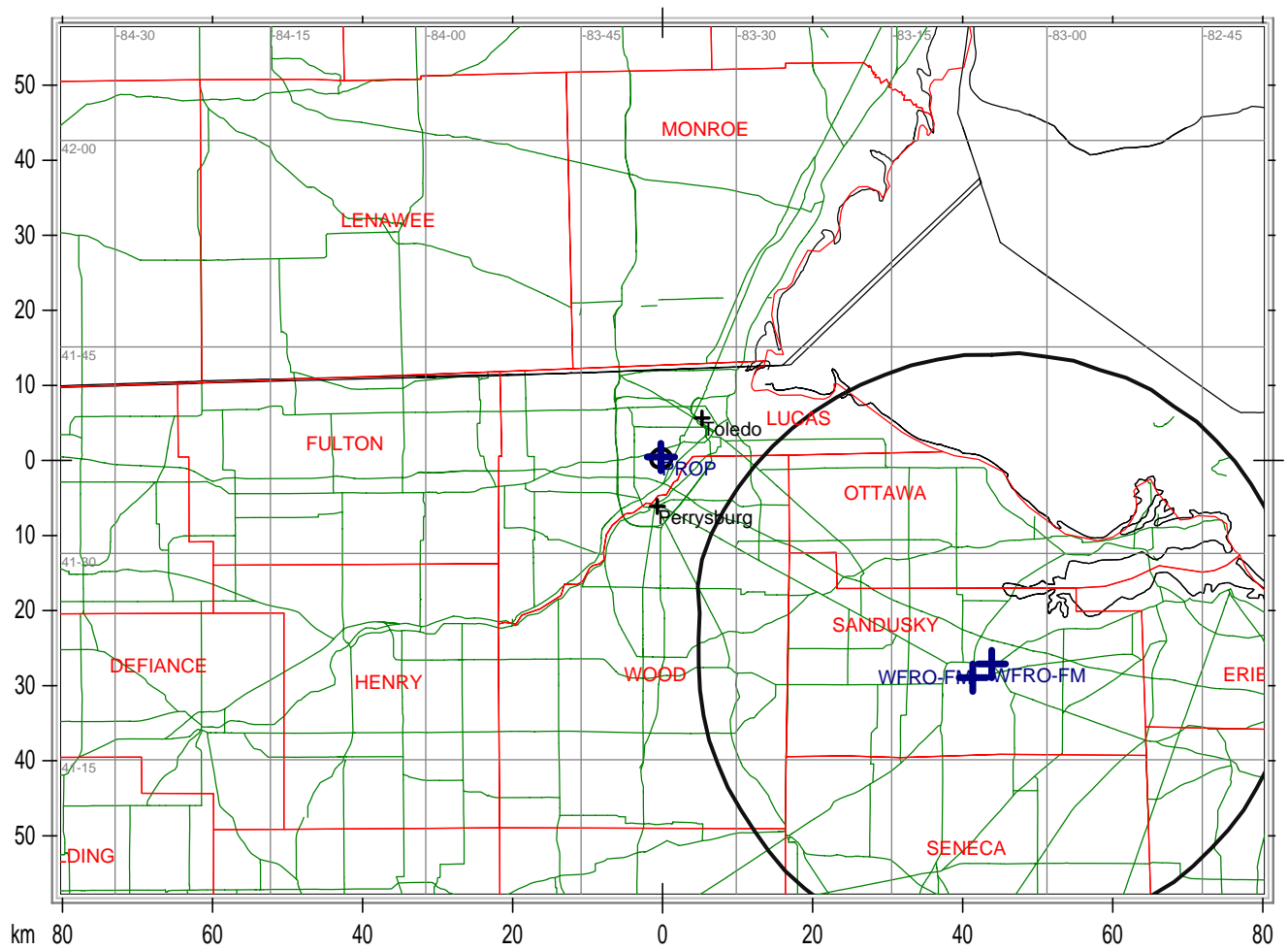

## Map Footer

County Borders    State Borders    Highways    Lat/Lon Grid

Map Header

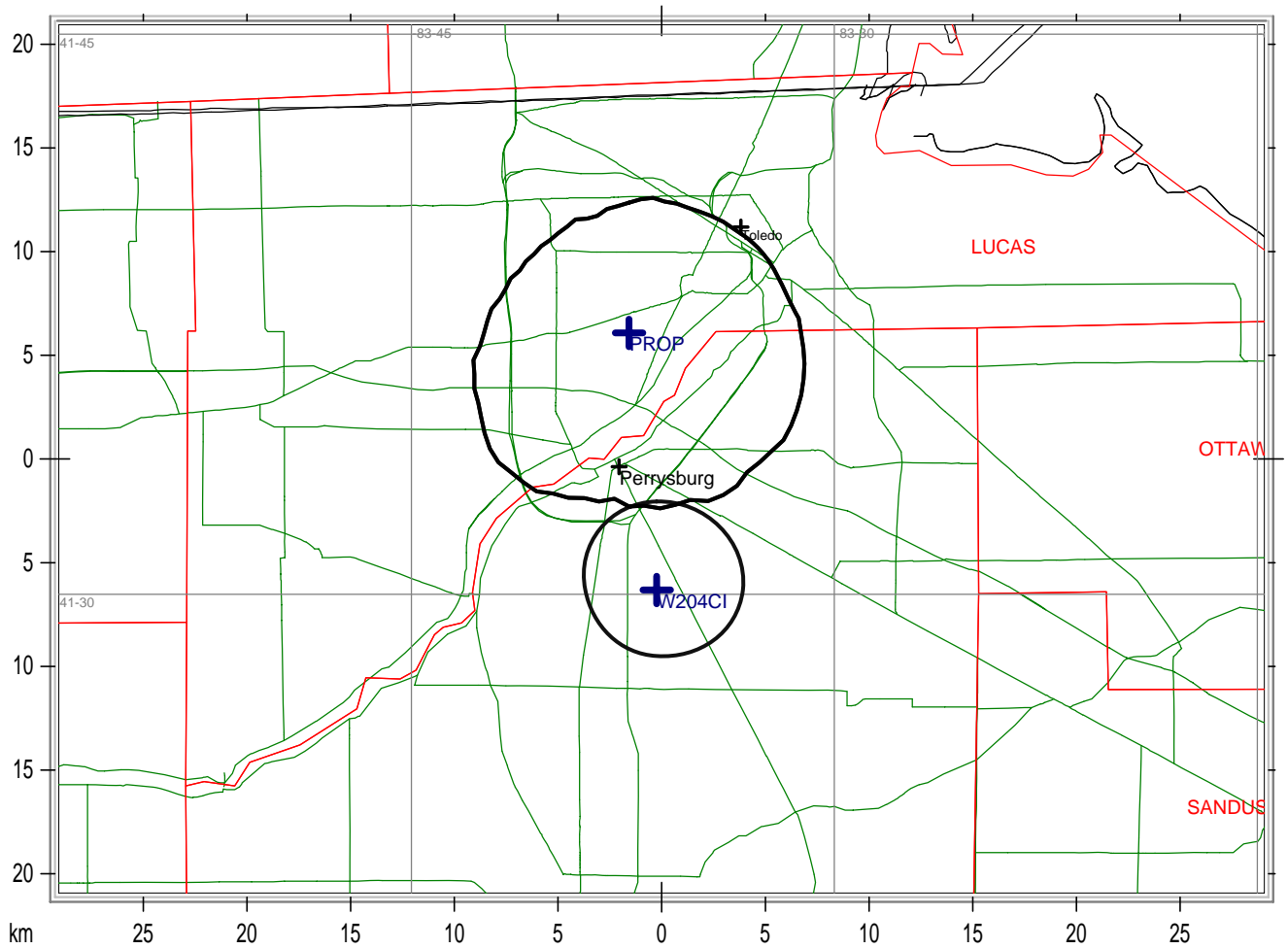

Map Footer

County Borders State Borders Highways Lat/Lon Grid